

F.A.P. RTE.	SECTION	COUNTY	TOTAL SHEETS	SHEET NO.
307	130 R-2	DUPAGE, KANE	647	601
STA. TO STA.		ILLINOIS FED. AID PROJECT		
FED. ROAD DIST. NO.		62410		

CROSS SECTION HATCHING LEGEND:

- STRUCTURE EXCAVATION
- SELECT BACKFILL

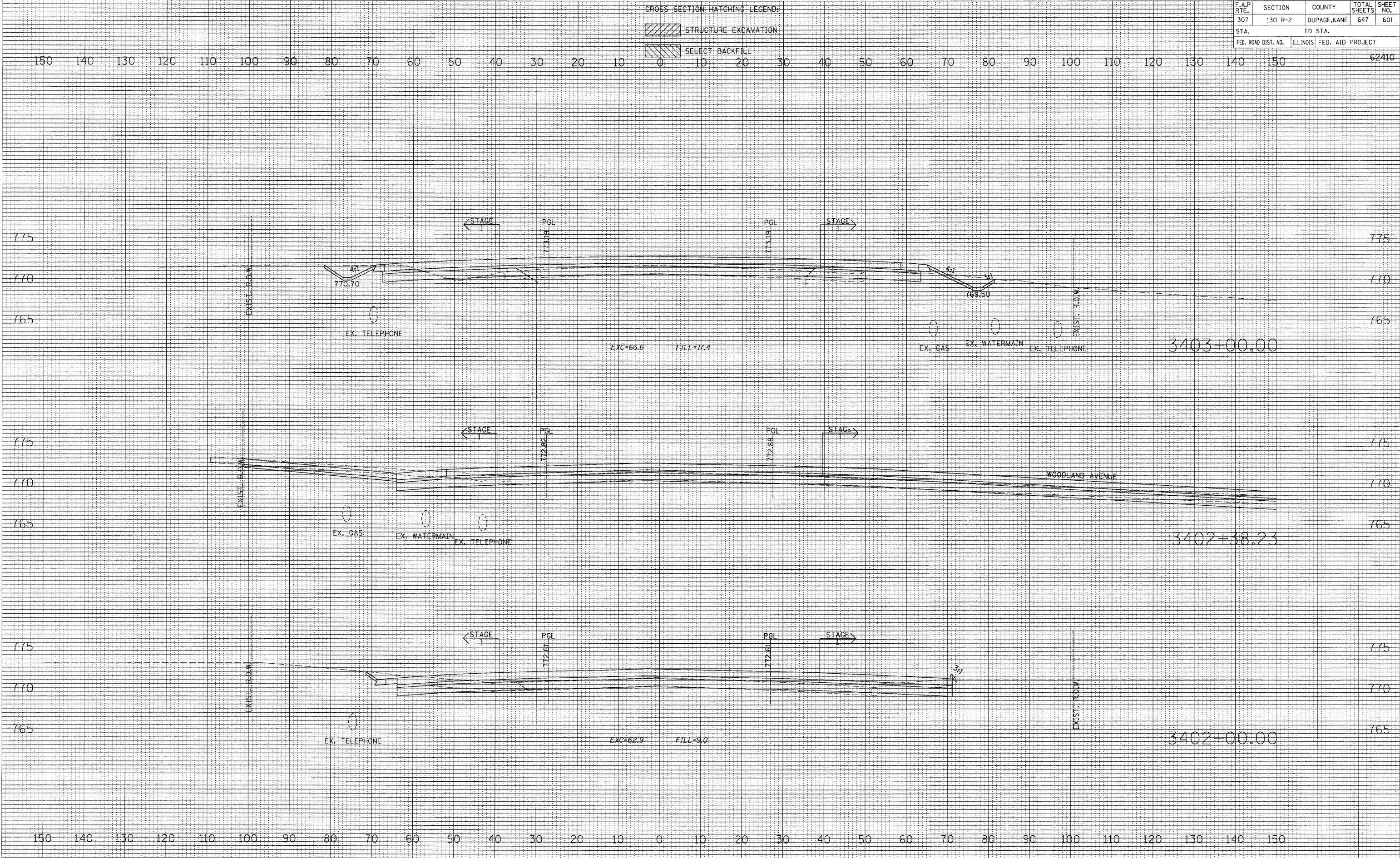

DATE: \_\_\_\_\_  
 BY: \_\_\_\_\_  
 SURVEYED: \_\_\_\_\_  
 PLOTTED: \_\_\_\_\_  
 NO. TO BOOK: \_\_\_\_\_  
 DATE: \_\_\_\_\_  
 AREAS CHECKED: \_\_\_\_\_  
 NO.:

DATE: \_\_\_\_\_  
 BY: \_\_\_\_\_  
 SURVEYED: \_\_\_\_\_  
 PLOTTED: \_\_\_\_\_  
 NO. TO BOOK: \_\_\_\_\_  
 DATE: \_\_\_\_\_  
 AREAS CHECKED: \_\_\_\_\_  
 NO.:





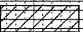
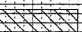

F.A.P. RTE.	SECTION	COUNTY	TOTAL SHEETS	SHEET NO.
307	130 R-2	DUPAGE, KANE	647	603
STA.		TO STA.		
FED. ROAD DIST. NO.		ILLINOIS FED. AID PROJECT		

CROSS SECTION HATCHING LEGEND:  
 STRUCTURE EXCAVATION  
 SELECT BACKFILL

BY \_\_\_\_\_ DATE \_\_\_\_\_  
 SURVEYED \_\_\_\_\_  
 PLOTTED \_\_\_\_\_  
 NOTE BOOK \_\_\_\_\_  
 AREAS \_\_\_\_\_  
 AREAS CHECKED \_\_\_\_\_  
 NO. \_\_\_\_\_

BY \_\_\_\_\_ DATE \_\_\_\_\_  
 SURVEYED \_\_\_\_\_  
 PLOTTED \_\_\_\_\_  
 NOTE BOOK \_\_\_\_\_  
 AREAS \_\_\_\_\_  
 AREAS CHECKED \_\_\_\_\_  
 NO. \_\_\_\_\_

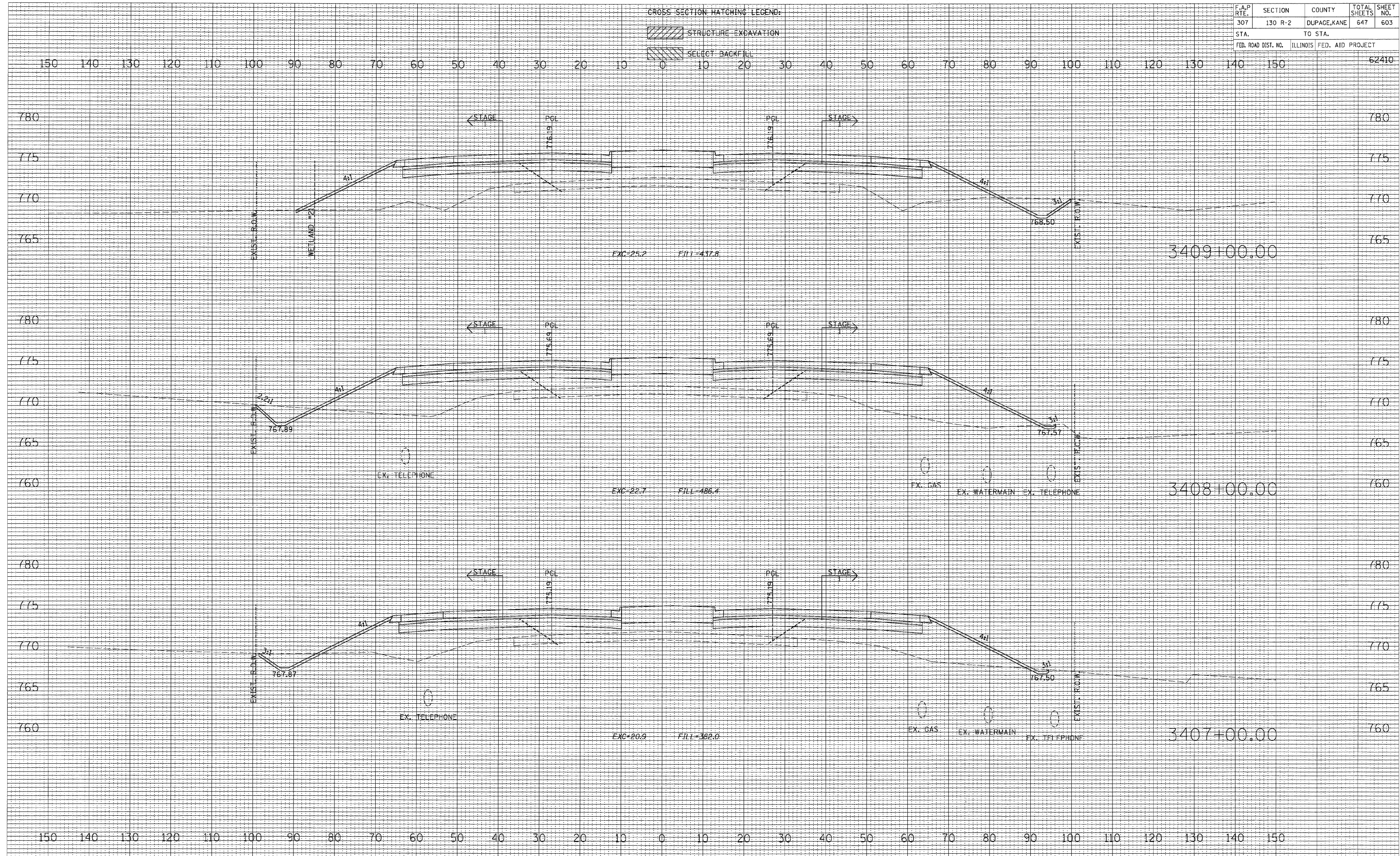

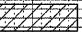
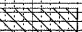

F.A.P. RTE.	SECTION	COUNTY	TOTAL SHEETS	SHEET NO.
307	130 R-2	DUPAGE, KANE	647	604
STA.		TO STA.		
FED. ROAD DIST. NO.		ILLINOIS FED. AID PROJECT		

CROSS SECTION HATCHING LEGEND:  
 STRUCTURE EXCAVATION  
 SELECT BACKFILL

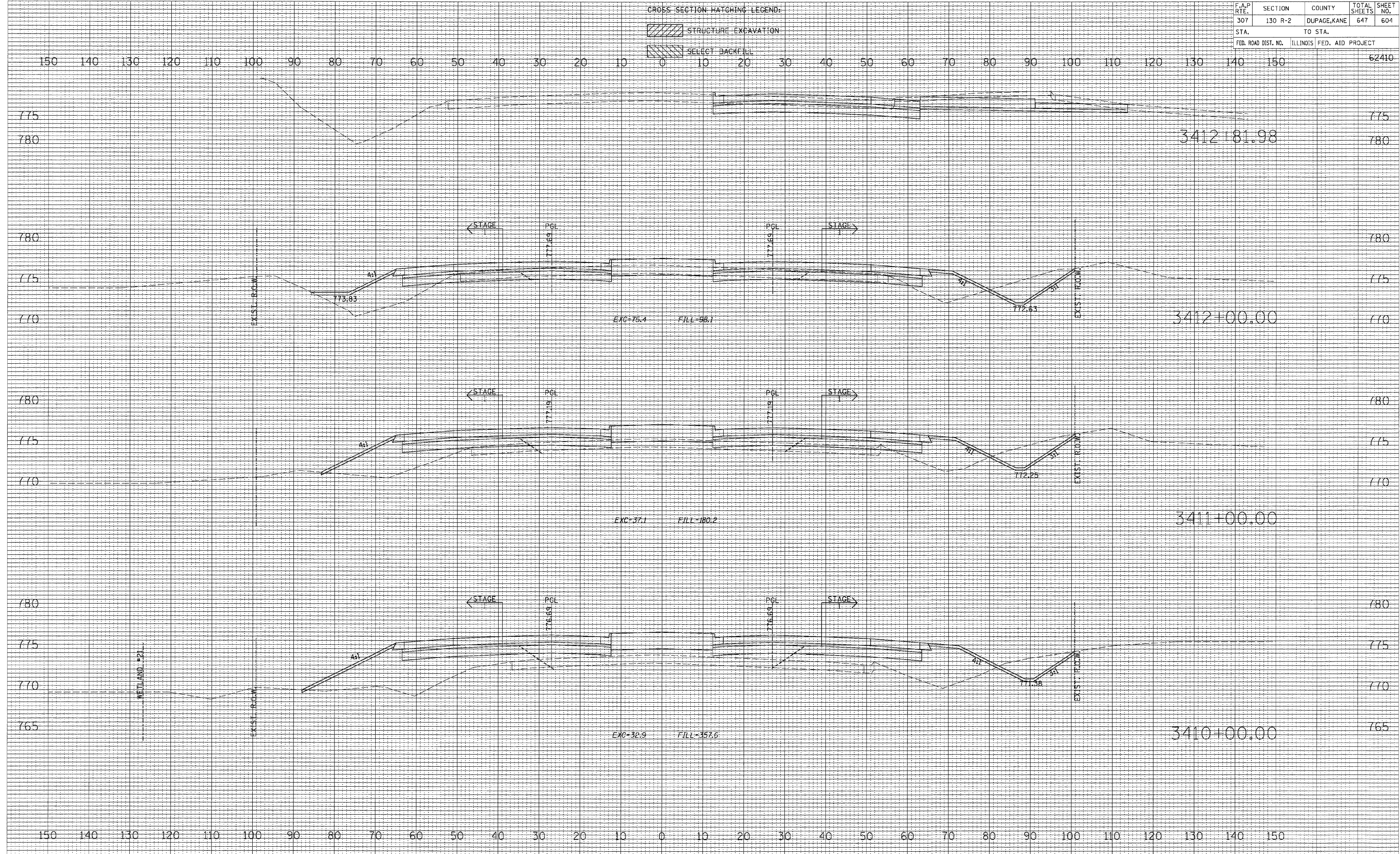

DATE \_\_\_\_\_ BY \_\_\_\_\_  
 SURVEYED \_\_\_\_\_  
 PLOTTED \_\_\_\_\_  
 NO. OF BOOKS \_\_\_\_\_  
 AREAS CHECKED \_\_\_\_\_  
 NO. \_\_\_\_\_

DATE \_\_\_\_\_ BY \_\_\_\_\_  
 SURVEYED \_\_\_\_\_  
 PLOTTED \_\_\_\_\_  
 NO. OF BOOKS \_\_\_\_\_  
 AREAS CHECKED \_\_\_\_\_  
 NO. \_\_\_\_\_

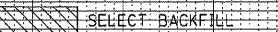

F.A.P. RTE.	SECTION	COUNTY	TOTAL SHEETS	SHEET NO.
307	130 R-2	DUPAGE, KANE	647	605
STA.		TO STA.		
FED. ROAD DIST. NO.		ILLINOIS FED. AID PROJECT		

CROSS SECTION HATCHING LEGEND:  
 STRUCTURE EXCAVATION  
 SELECT BACKFILL

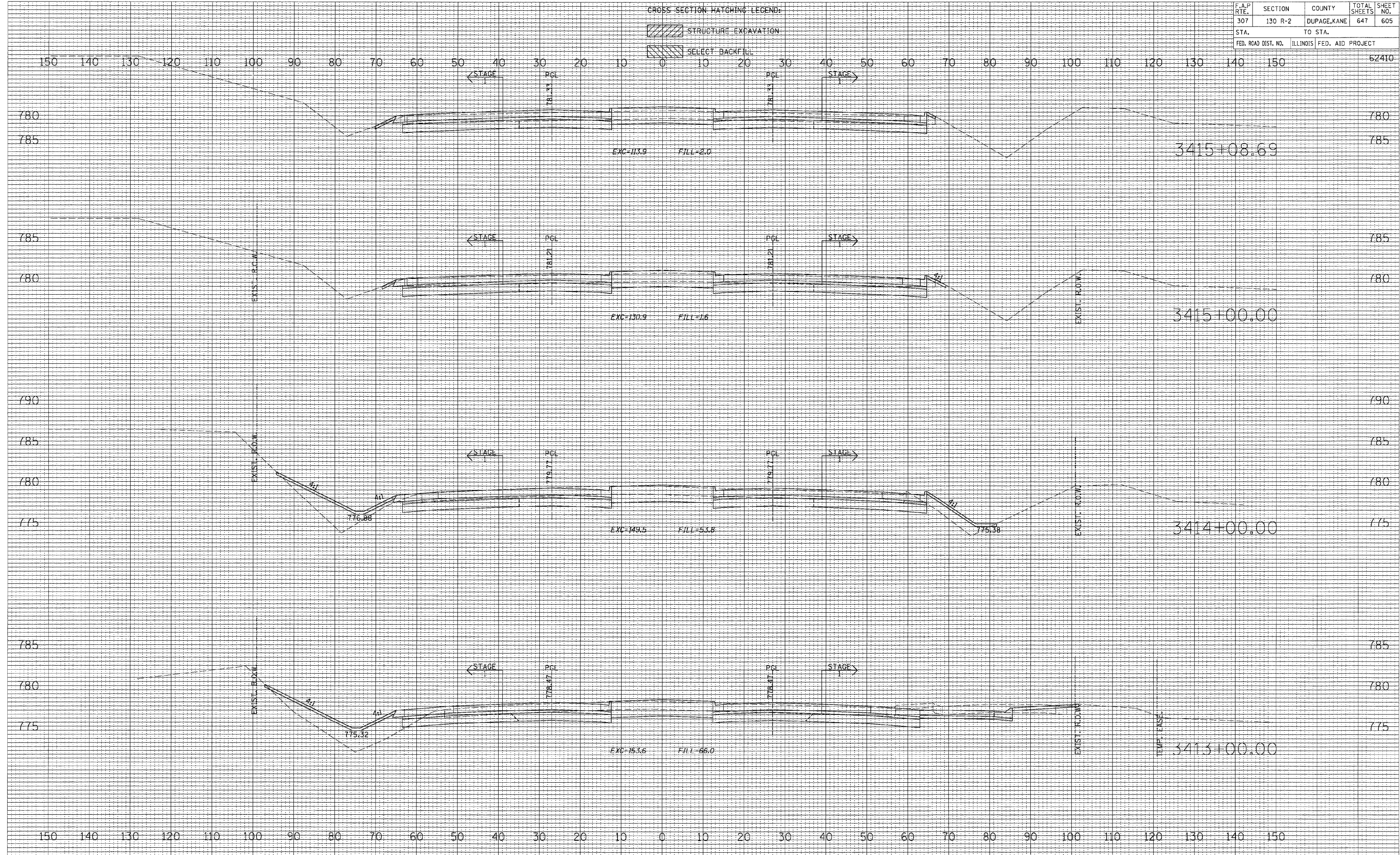

FINAL SURVEY PLOTTED DATE AREAS CHECKED NO.

ORIGINAL SURVEY PLOTTED DATE AREAS CHECKED NO.



F.A.P. RTE.	SECTION	COUNTY	TOTAL SHEETS	SHEET NO.
307	130 R-2	DUPAGE, KANE	647	606
STA.		TO STA.		
FED. ROAD DIST. NO.		ILLINOIS FED. AID PROJECT		

CROSS SECTION HATCHING LEGEND:

- STRUCTURE EXCAVATION
- SELECT BACKFILL

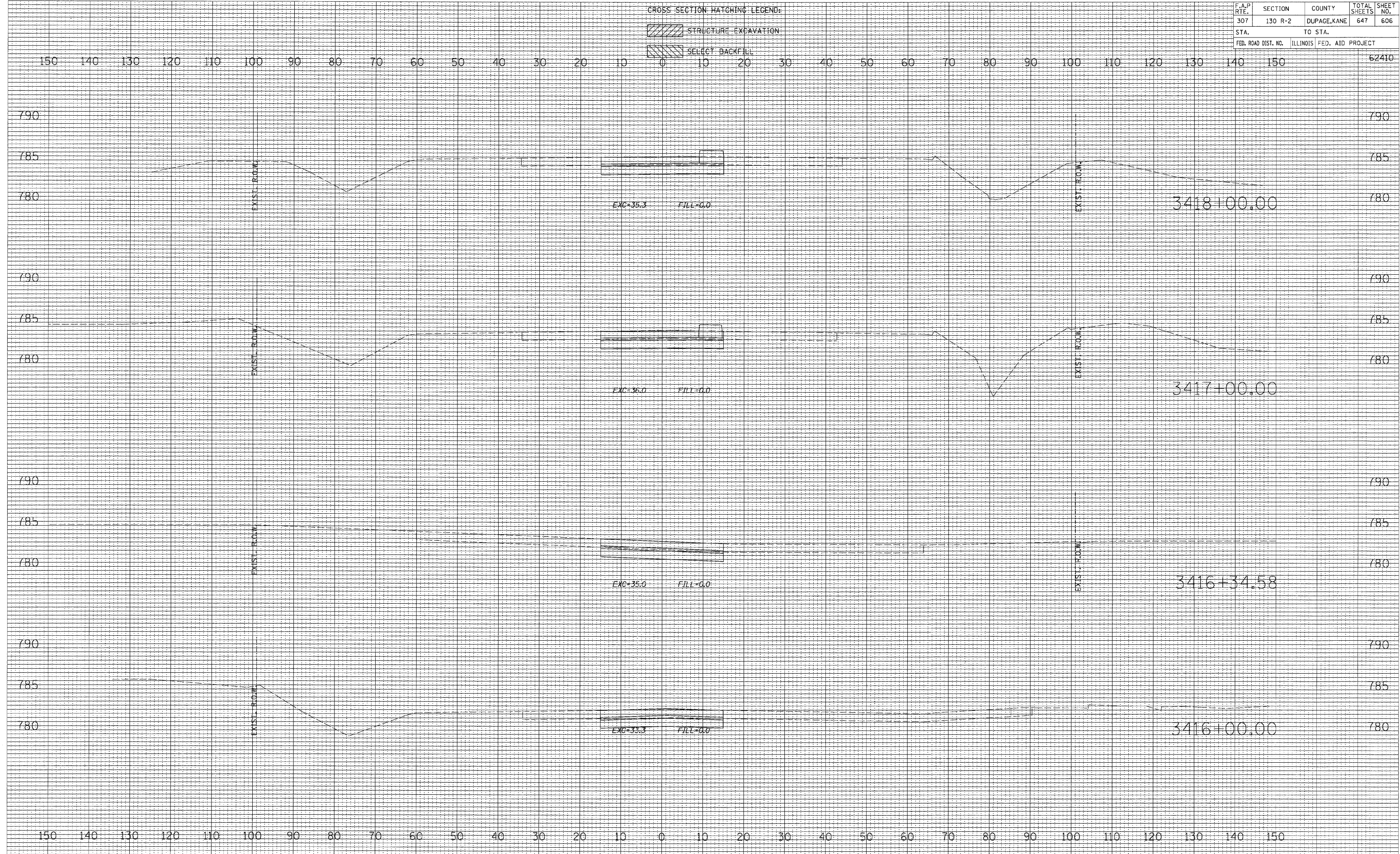

BY: \_\_\_\_\_ DATE: \_\_\_\_\_  
 SURVEYED: \_\_\_\_\_  
 PLOTTED: \_\_\_\_\_  
 FINAL SURVEY: \_\_\_\_\_  
 NOTE BOOK: \_\_\_\_\_  
 NO. \_\_\_\_\_  
 AREAS CHECKED: \_\_\_\_\_

BY: \_\_\_\_\_ DATE: \_\_\_\_\_  
 SURVEYED: \_\_\_\_\_  
 PLOTTED: \_\_\_\_\_  
 ORIGINAL SURVEY: \_\_\_\_\_  
 NOTE BOOK: \_\_\_\_\_  
 NO. \_\_\_\_\_  
 AREAS CHECKED: \_\_\_\_\_



F.A.P. RTE.	SECTION	COUNTY	TOTAL SHEETS	SHEET NO.
307	130 R-2	DUPAGE, KANE	647	607
STA.		TO STA.		
FED. ROAD DIST. NO.		ILLINOIS FED. AID PROJECT		

CROSS SECTION HATCHING LEGEND:

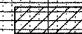
 STRUCTURE EXCAVATION

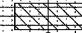
 SELECT BACKFILL

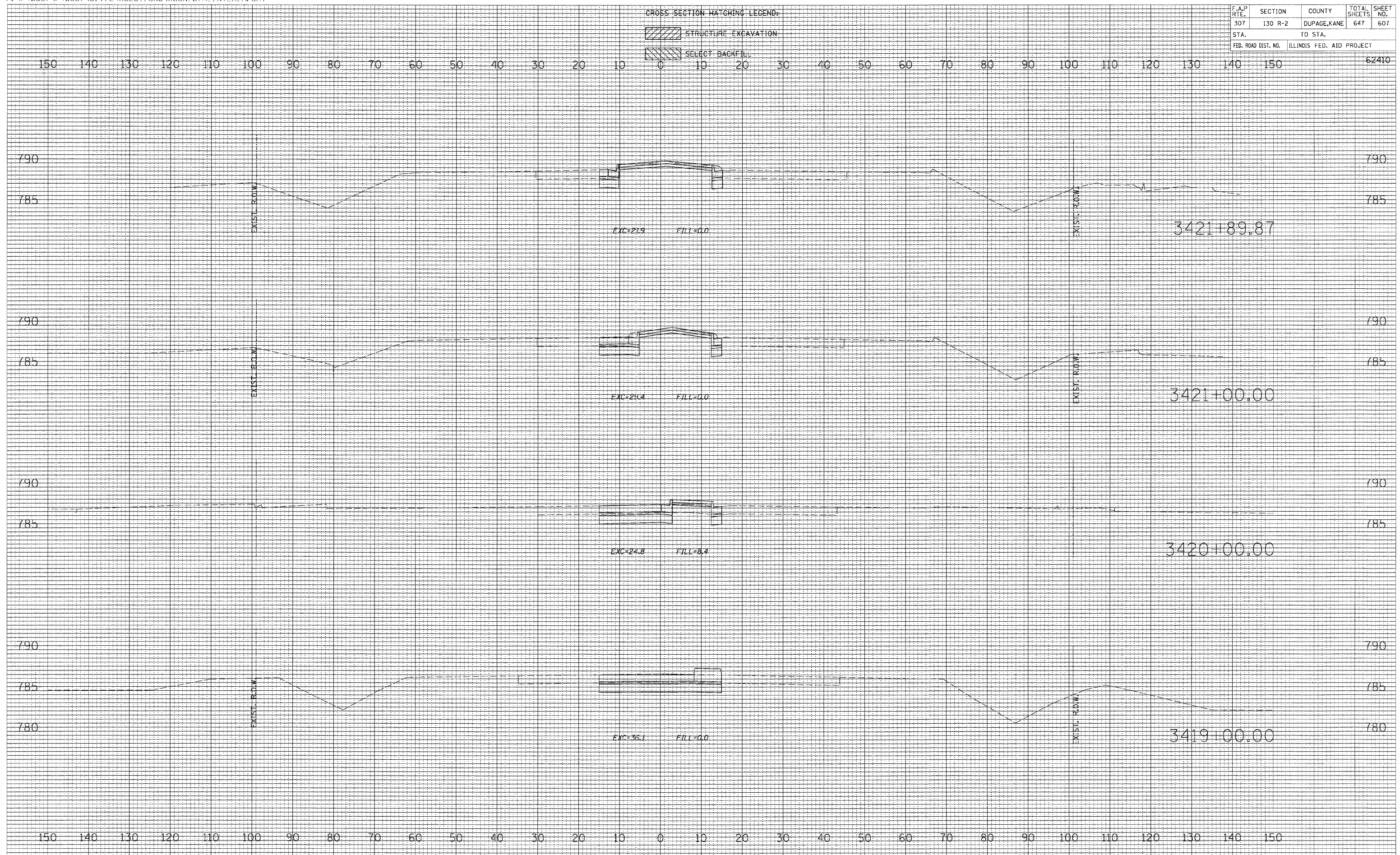

FINAL SURVEY	BY	DATE
NOTE BOOK		
AREAS CHECKED		
NO.		

ORIGINAL SURVEY	BY	DATE
NOTE BOOK		
AREAS CHECKED		
NO.		



F.A.P. RTE.	SECTION	COUNTY	TOTAL SHEETS	SHEET NO.
307	130 R-2	DUPAGE, KANE	647	629
STA.		TO STA.		
FED. ROAD DIST. NO.		ILLINOIS FED. AID PROJECT		

62410

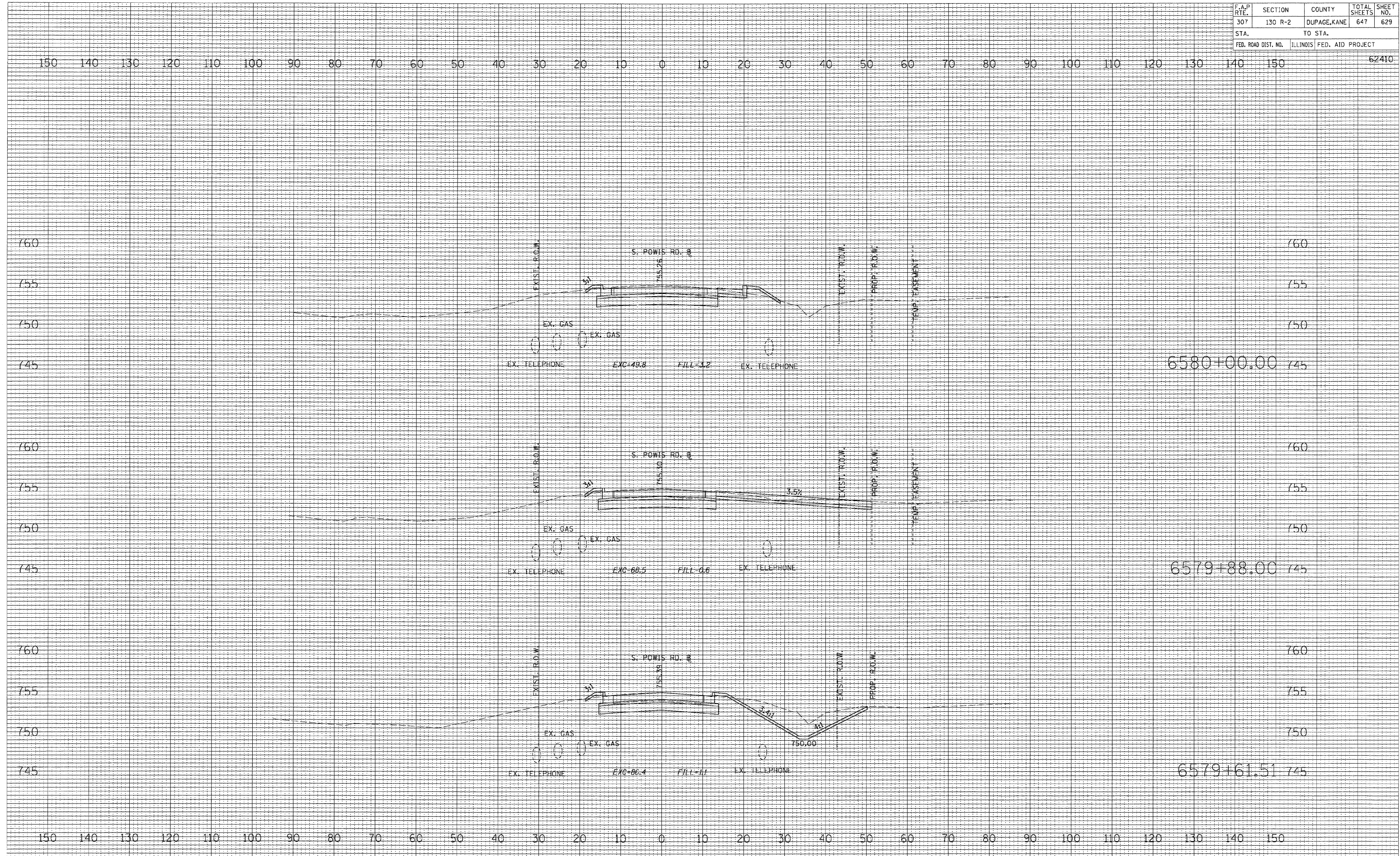

FINAL SURVEY  
 SURVEYED BY  
 DATE  
 NOTE BOOK NO.  
 TEMP. AREAS CHECKED

ORIGINAL SURVEY  
 SURVEYED BY  
 DATE  
 NOTE BOOK NO.  
 TEMP. AREAS CHECKED



F.A.P. RTE.	SECTION	COUNTY	TOTAL SHEETS	SHEET NO.
307	130 R-2	DUPAGE, KANE	647	630
STA.		TO STA.		
FED. ROAD DIST. NO.		ILLINOIS FED. AID PROJECT		

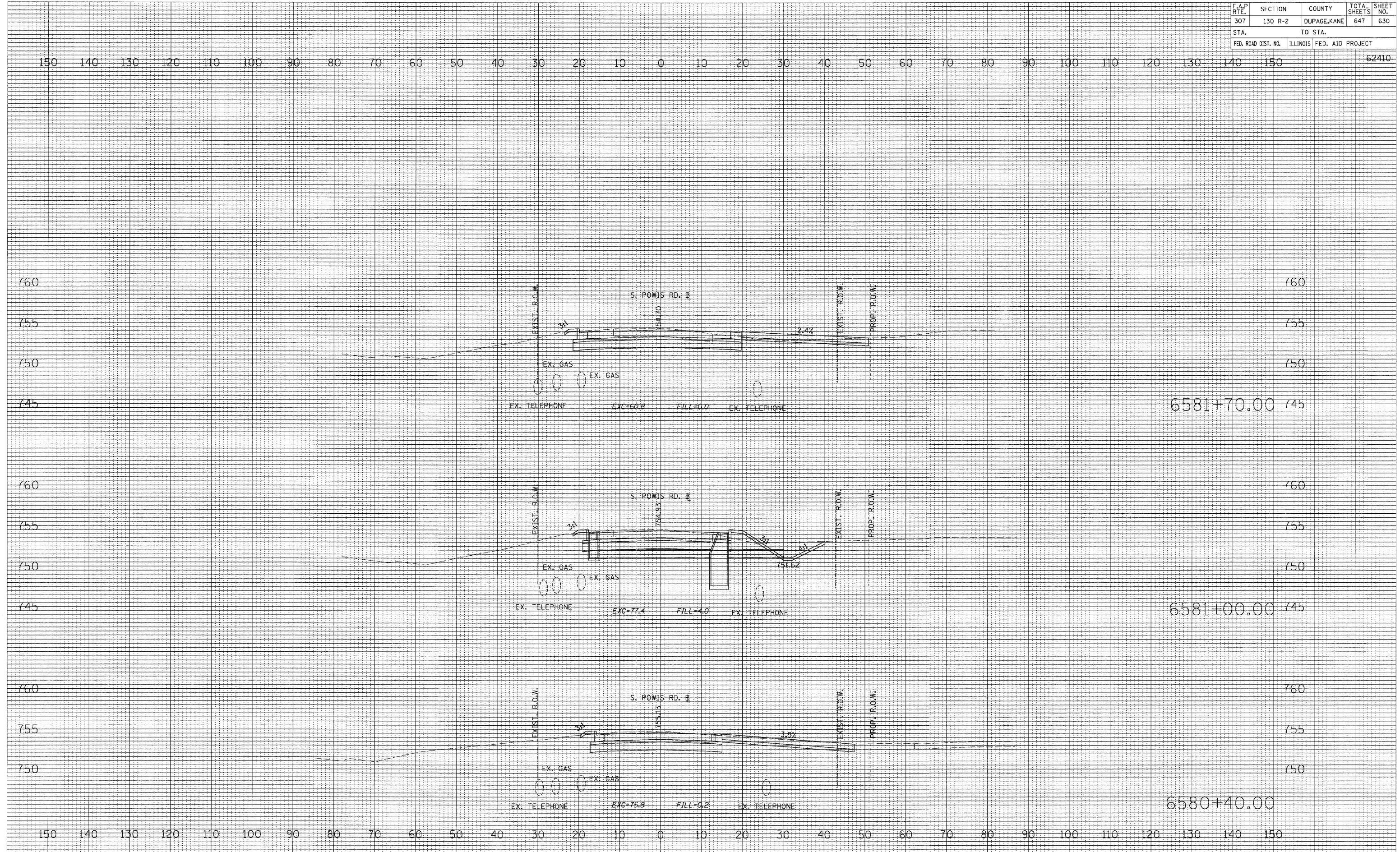

DATE	BY
DATE	BY

SURVEYED  
 SURVEY  
 NOTE BOOK  
 NO.

DATE	BY
DATE	BY

ORIGINAL  
 SURVEY  
 NOTE BOOK  
 NO.



F.A.P. RTE.	SECTION	COUNTY	TOTAL SHEETS	SHEET NO.
307	130 R-2	DUPAGE, KANE	647	631
STA.	TO STA.			
FED. ROAD DIST. NO.	ILLINOIS FED. AID PROJECT			

62410

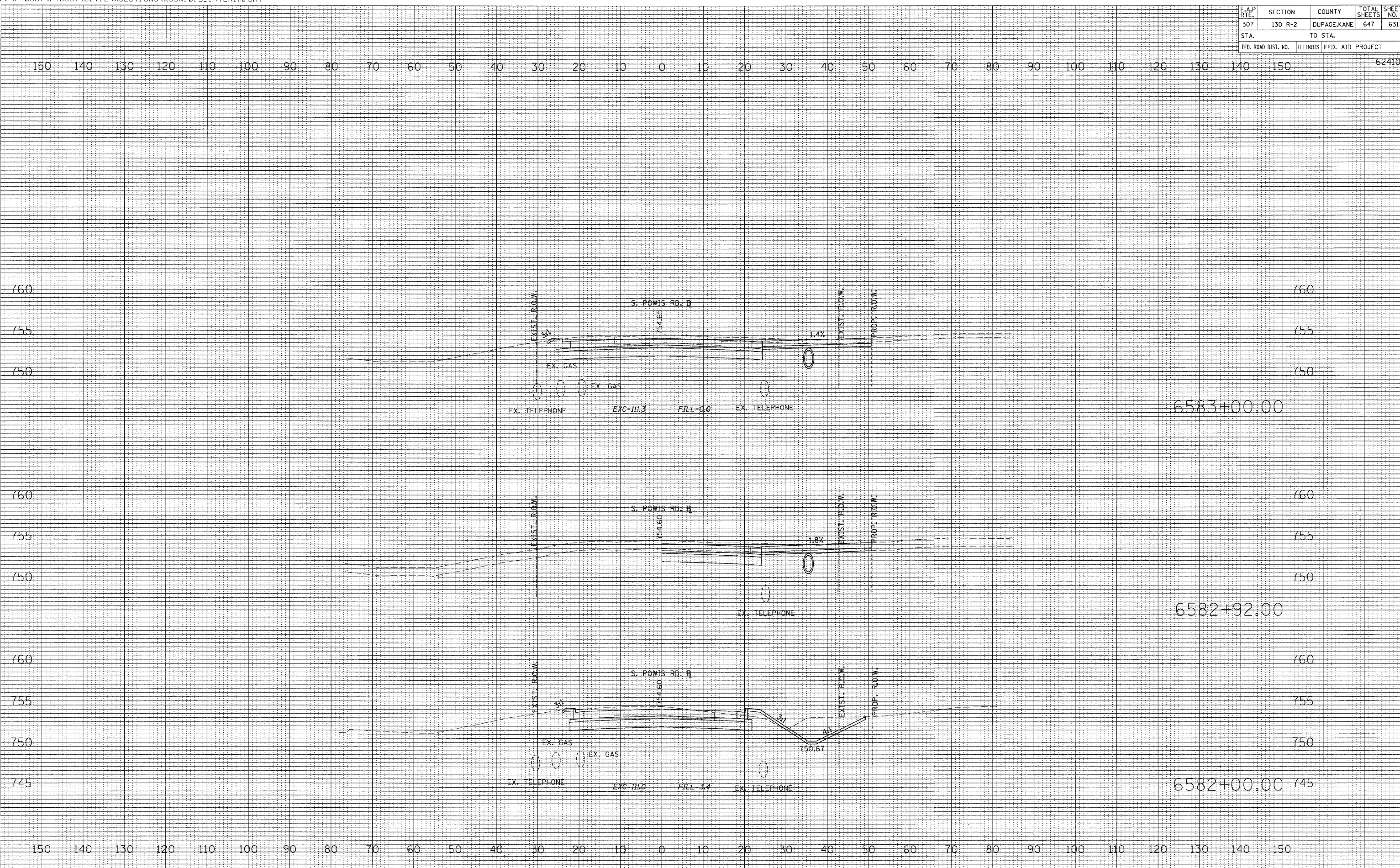

DATE	BY

NO.	AREAS CHECKED	TEMPLATE	DATE	NO.	NOTE BOOK	NO.	ORIGINAL SURVEY

DATE	BY

NO.	AREAS CHECKED	TEMPLATE	DATE	NO.	NOTE BOOK	NO.	ORIGINAL SURVEY



F.A.P. RTE.	SECTION	COUNTY	TOTAL SHEETS	SHEET NO.
307	130 R-2	DUPAGE, KANE	647	632
STA.		TO STA.		
FED. ROAD DIST. NO.		ILLINOIS FED. AID PROJECT		

62410

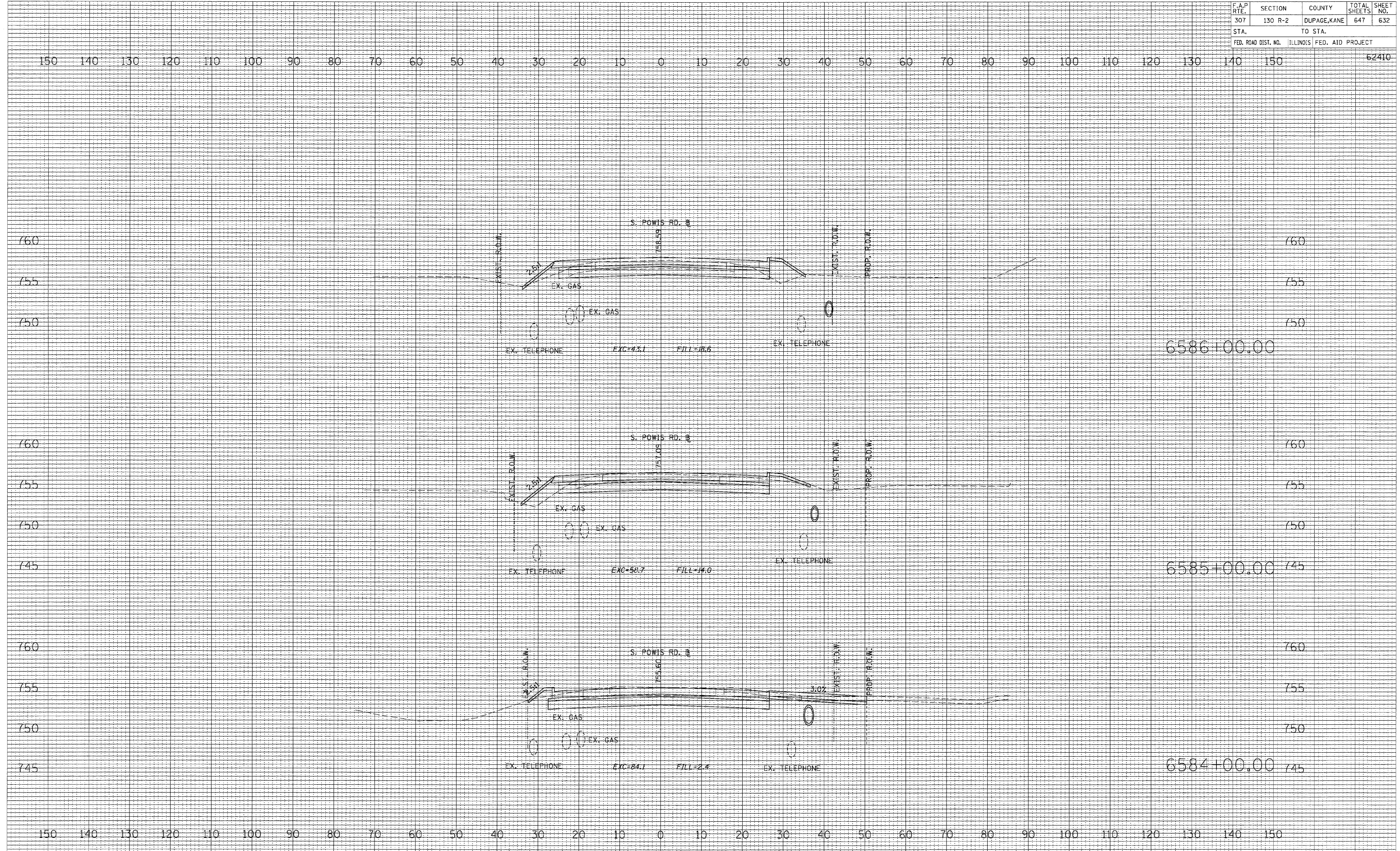

DATE	BY

FINAL SURVEY  
 SURVEYED  
 PLOTTED  
 NOTE BOOK  
 NO.

DATE	BY

ORIGINAL SURVEY  
 SURVEYED  
 PLOTTED  
 NOTE BOOK  
 NO.



F.A.P. R/L	SECTION	COUNTY	TOTAL SHEETS	SHEET NO.
307	130 R-2	DUPAGE, KANE	647	633
STA. TO STA.		ILLINOIS FED. AID PROJECT		
FED. ROAD DIST. NO.		62410		

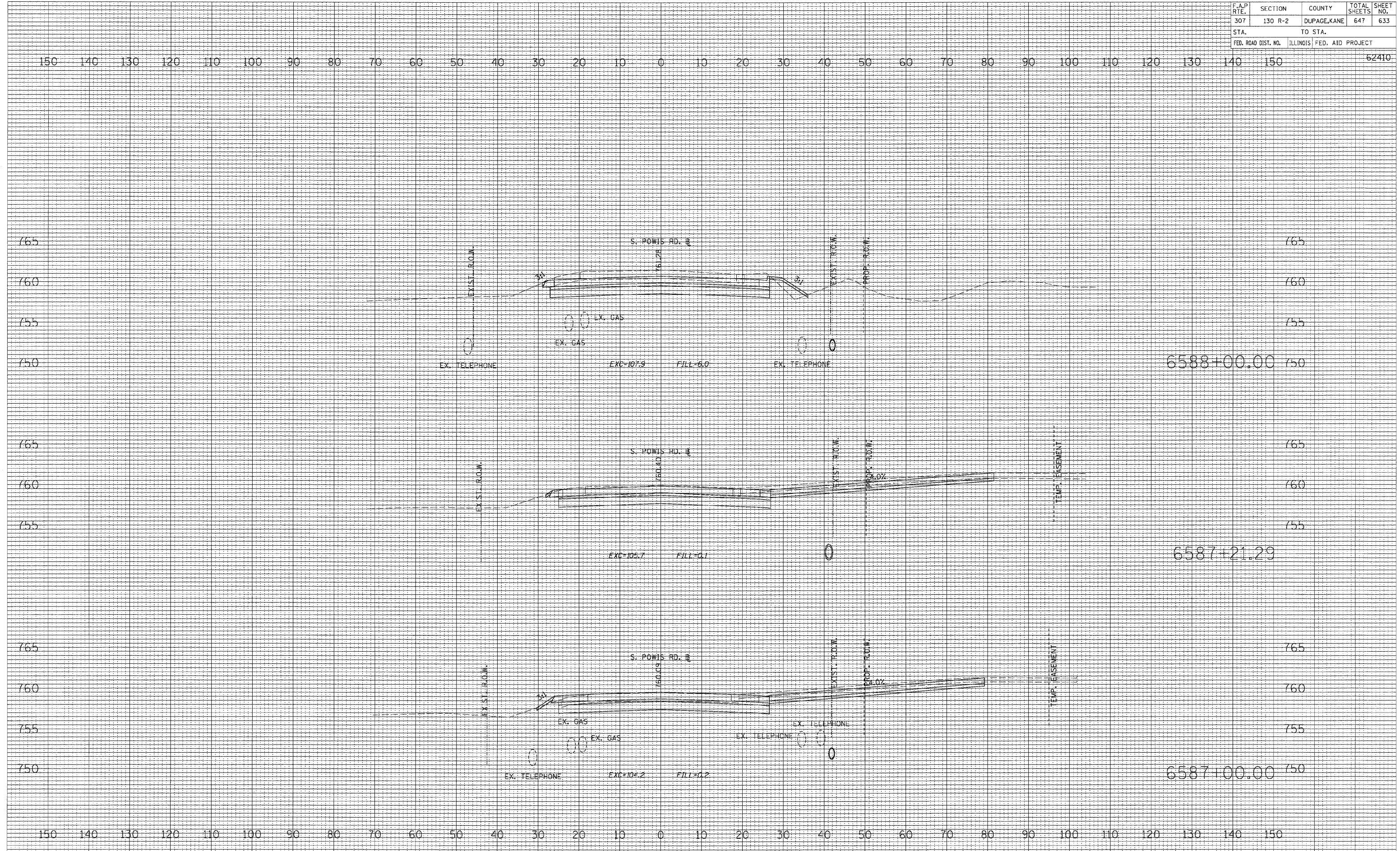

FINAL SURVEY  
 SURVEYED  
 PLOTTED  
 NOTE BOOK  
 NO. \_\_\_\_\_

ORIGINAL SURVEY  
 SURVEYED  
 PLOTTED  
 NOTE BOOK  
 NO. \_\_\_\_\_

BY \_\_\_\_\_  
 DATE \_\_\_\_\_

BY \_\_\_\_\_  
 DATE \_\_\_\_\_



F.A.P. RTE.	SECTION	COUNTY	TOTAL SHEETS	SHEET NO.
307	130 R-2	DUPAGE, KANE	647	634
STA.		TO STA.		
FED. ROAD DIST. NO.		ILLINOIS FED. AID PROJECT		62410

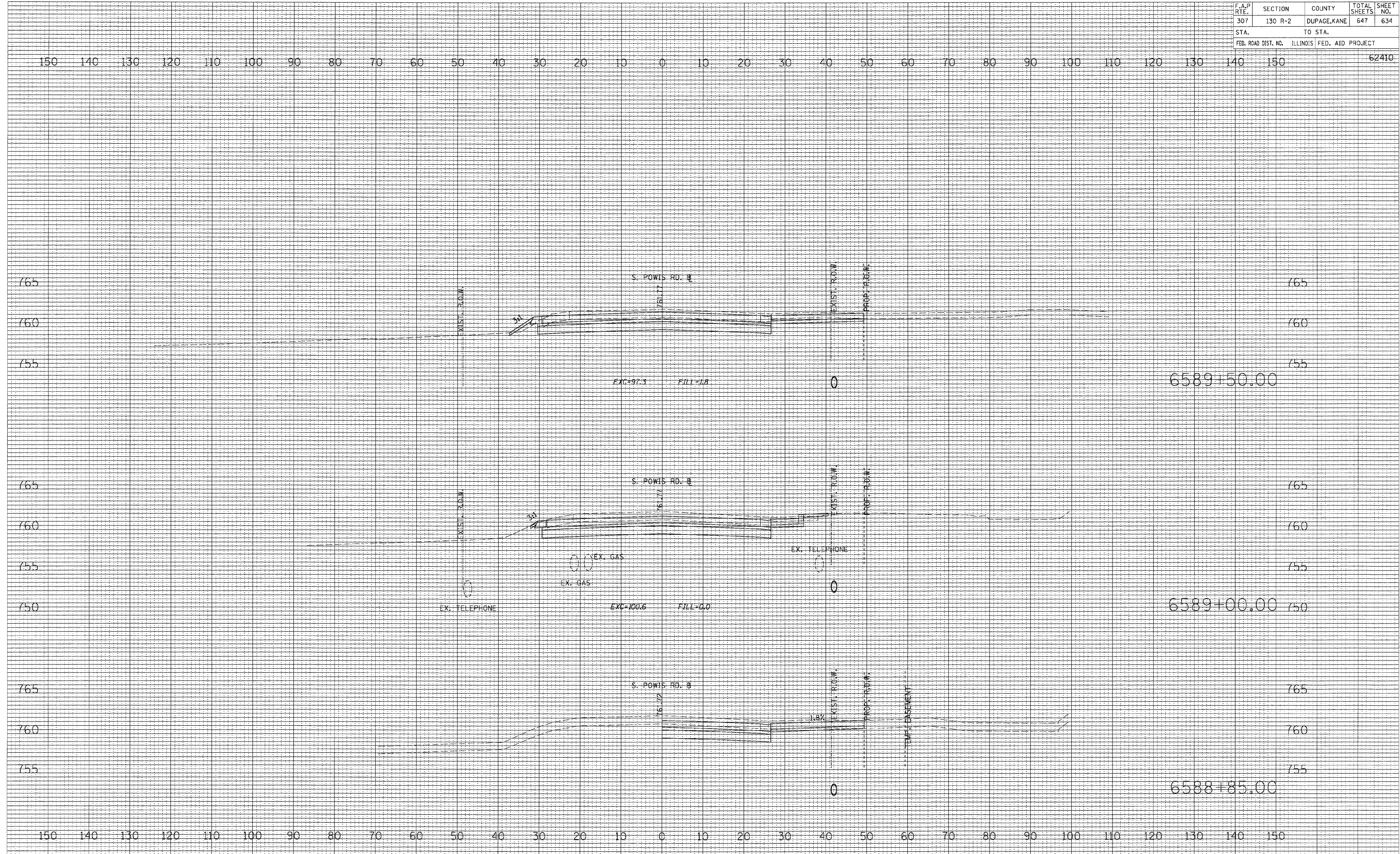

DATE	BY
SURVEYED	PLANNED
NO. DATE	NO. DATE
AREAS CHECKED	AREAS CHECKED
NO.	NO.

DATE	BY
SURVEYED	PLANNED
NO. DATE	NO. DATE
AREAS CHECKED	AREAS CHECKED
NO.	NO.



F.A.P. RTE.	SECTION	COUNTY	TOTAL SHEETS	SHEET NO.
307	130 R-2	DUPAGE, KANE	647	635
STA.		TO STA.		
FED. ROAD DIST. NO.		ILLINOIS FED. AID PROJECT		

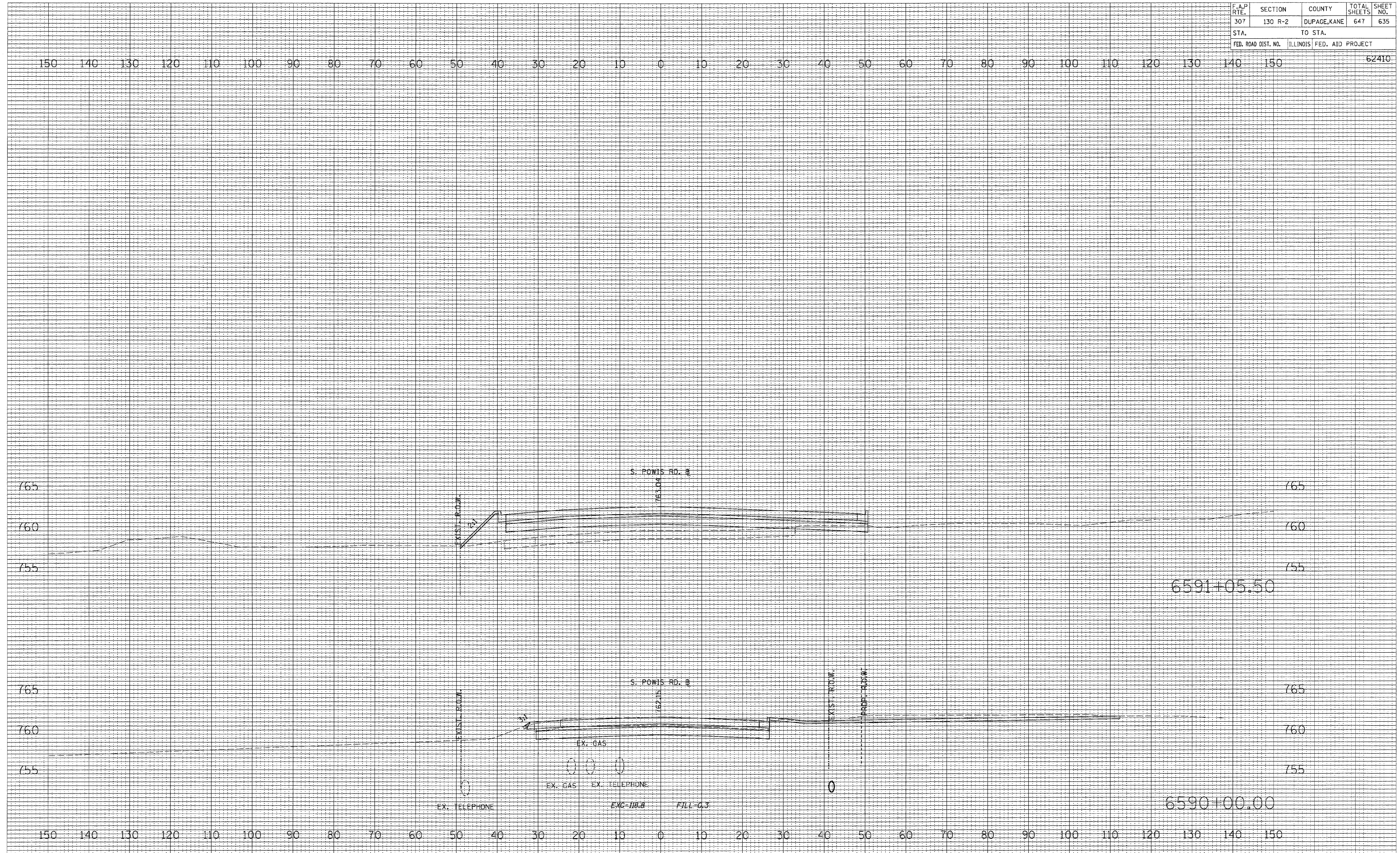

DATE	BY
DATE	BY
DATE	BY

DATE	BY
DATE	BY
DATE	BY



F.A.P. RTE.	SECTION	COUNTY	TOTAL SHEETS	SHEET NO.
307	130 R-2	DUPAGE, KANE	647	636
STA.	TO STA.			
FED. ROAD DIST. NO.	ILLINOIS FED. AID PROJECT			

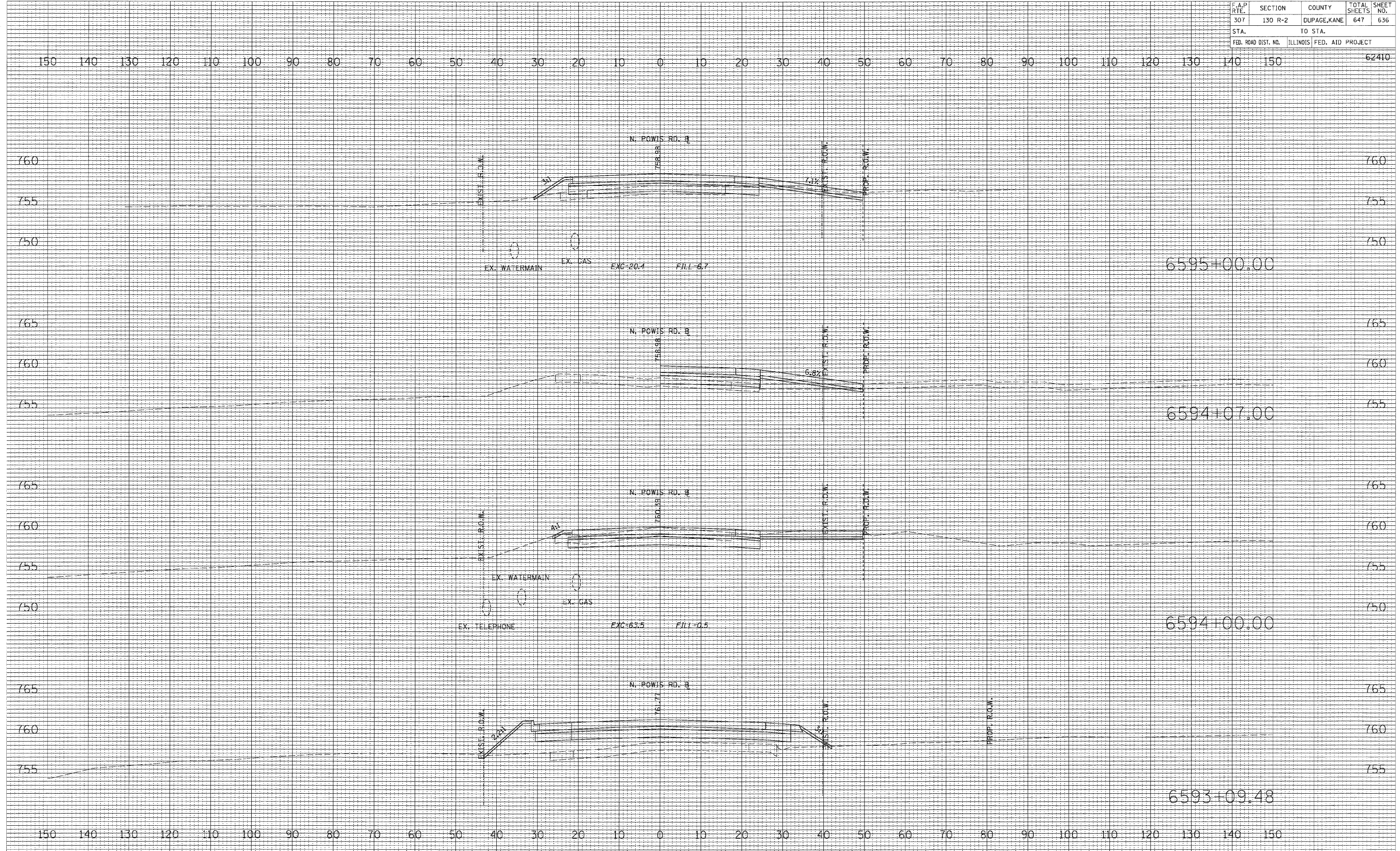

DATE	BY
SURVEYED	DATE
NO. BOOK	NO.
AREAS CHECKED	

DATE	BY
SURVEYED	DATE
NO. BOOK	NO.
AREAS CHECKED	



F.A.P. RTE.	SECTION	COUNTY	TOTAL SHEETS	SHEET NO.
307	130 R-2	DUPAGE, KANE	647	637
STA.		TO STA.		
FED. ROAD DIST. NO.		ILLINOIS FED. AID PROJECT		

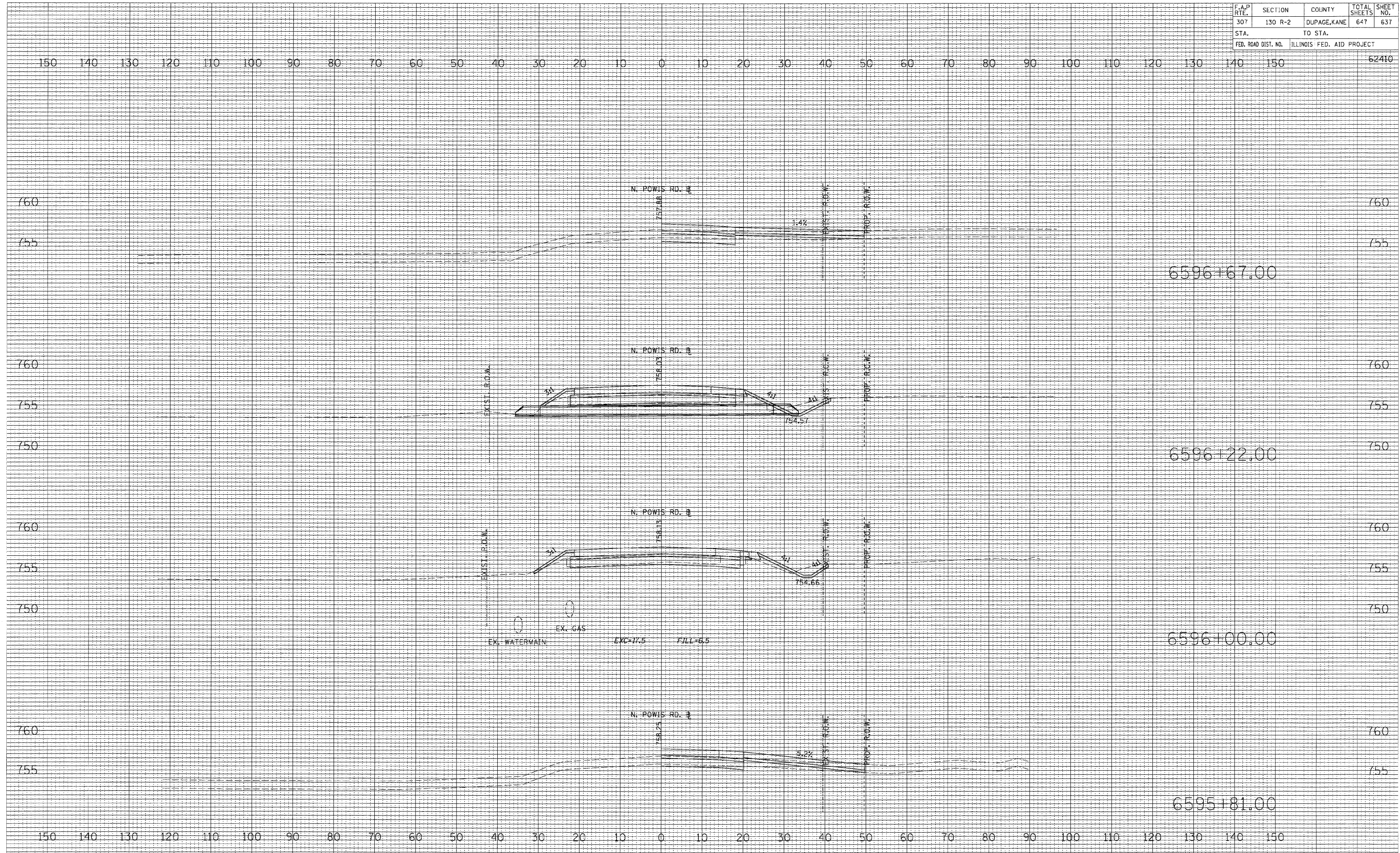

DATE	BY

FINAL SURVEY NOTE BOOK NO. \_\_\_\_\_

SURVEYED BY: \_\_\_\_\_

DATE: \_\_\_\_\_

TEMPERATURE: \_\_\_\_\_

AREAS CHECKED: \_\_\_\_\_

DATE	BY

ORIGINAL SURVEY NOTE BOOK NO. \_\_\_\_\_

SURVEYED BY: \_\_\_\_\_

DATE: \_\_\_\_\_

TEMPERATURE: \_\_\_\_\_

AREAS CHECKED: \_\_\_\_\_



F.A.P. RTE.	SECTION	COUNTY	TOTAL SHEETS	SHEET NO.
307	130 R-2	DUPAGE, KANE	647	638
STA.		TO STA.		
FED. ROAD DIST. NO.		ILLINOIS FED. AID PROJECT		

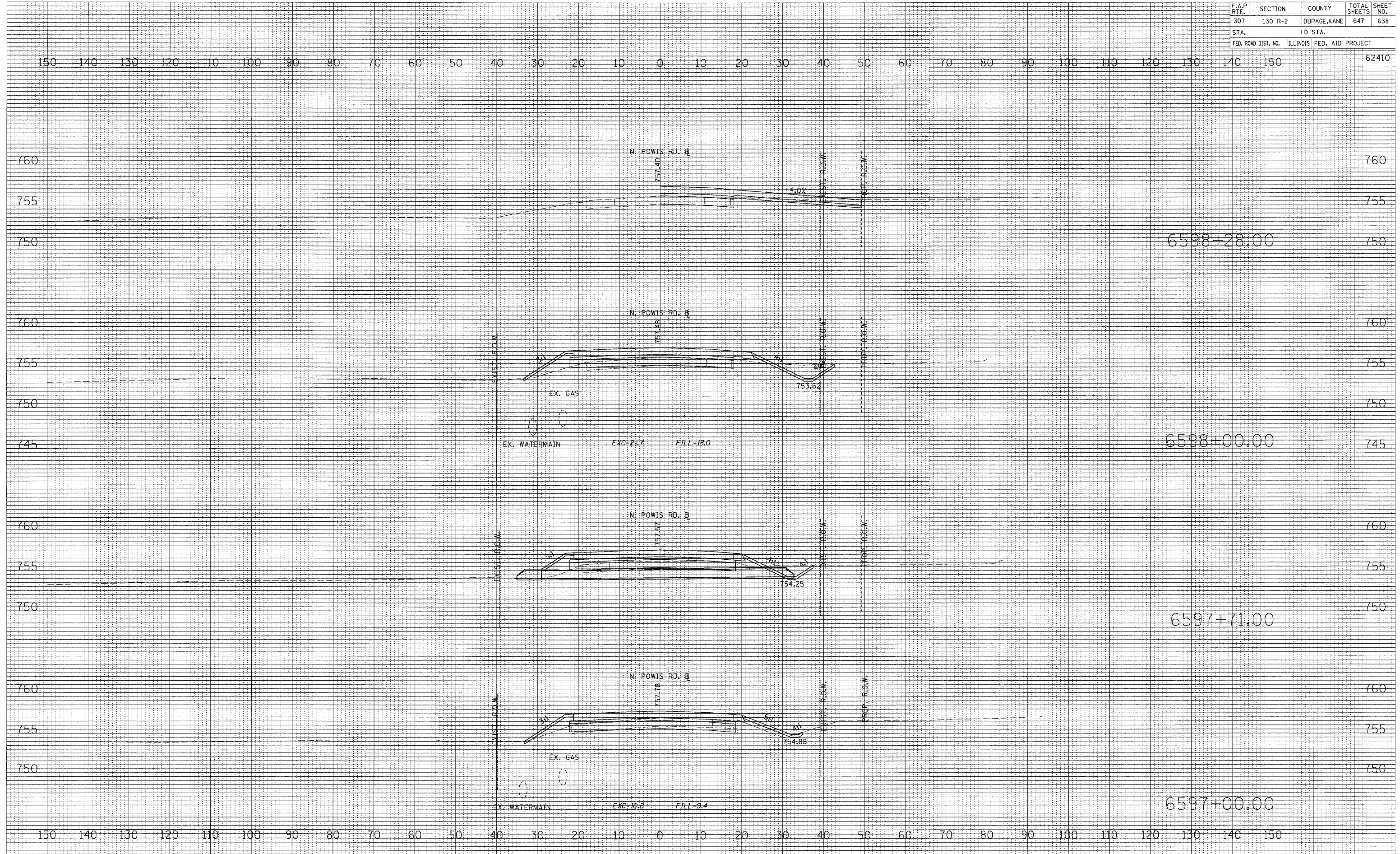















F.A.P. RTE.	SECTION	COUNTY	TOTAL SHEETS	SHEET NO.
307	130 R-2	DUPAGE, KANE	647	642
STA. 9843+00.00		TO STA. 9845+00.00		
FED. ROAD DIST. NO.		ILLINOIS FED. AID PROJECT		

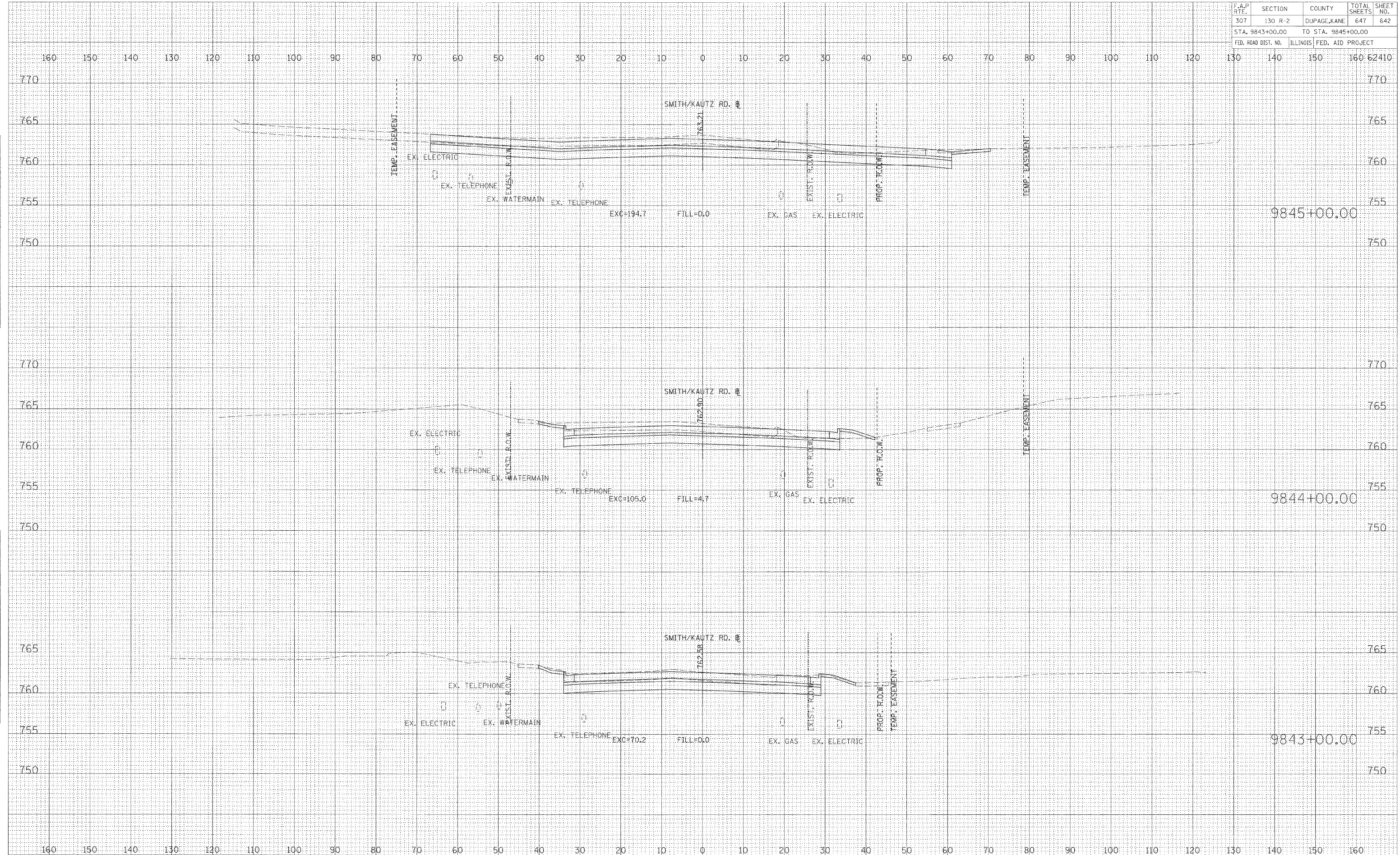

CROSS SECTIONS - SMITH AND KAUTZ ROAD

BY	DATE
SURVEYED	
PLOTTED	
NOTE BOOK	
AREAS CHECKED	

BY	DATE
SURVEYED	
PLOTTED	
NOTE BOOK	
AREAS CHECKED	



F.A.P. RTE.	SECTION	COUNTY	TOTAL SHEETS	SHEET NO.
307	130 R-2	DUPAGE, KANE	647	643
STA. 9845+17.00		TO STA. 9846+00.00		
FED. ROAD DIST. NO.		ILLINOIS		FED. AID PROJECT

DATE	
BY	
NO.	
FINAL SURVEY	SURVEYED
NOTE BOOK	PLOTTED
	DATE
	AREAS CHECKED

DATE	
BY	
NO.	
ORIGINAL SURVEY	SURVEYED
NOTE BOOK	PLOTTED
	DATE
	AREAS CHECKED

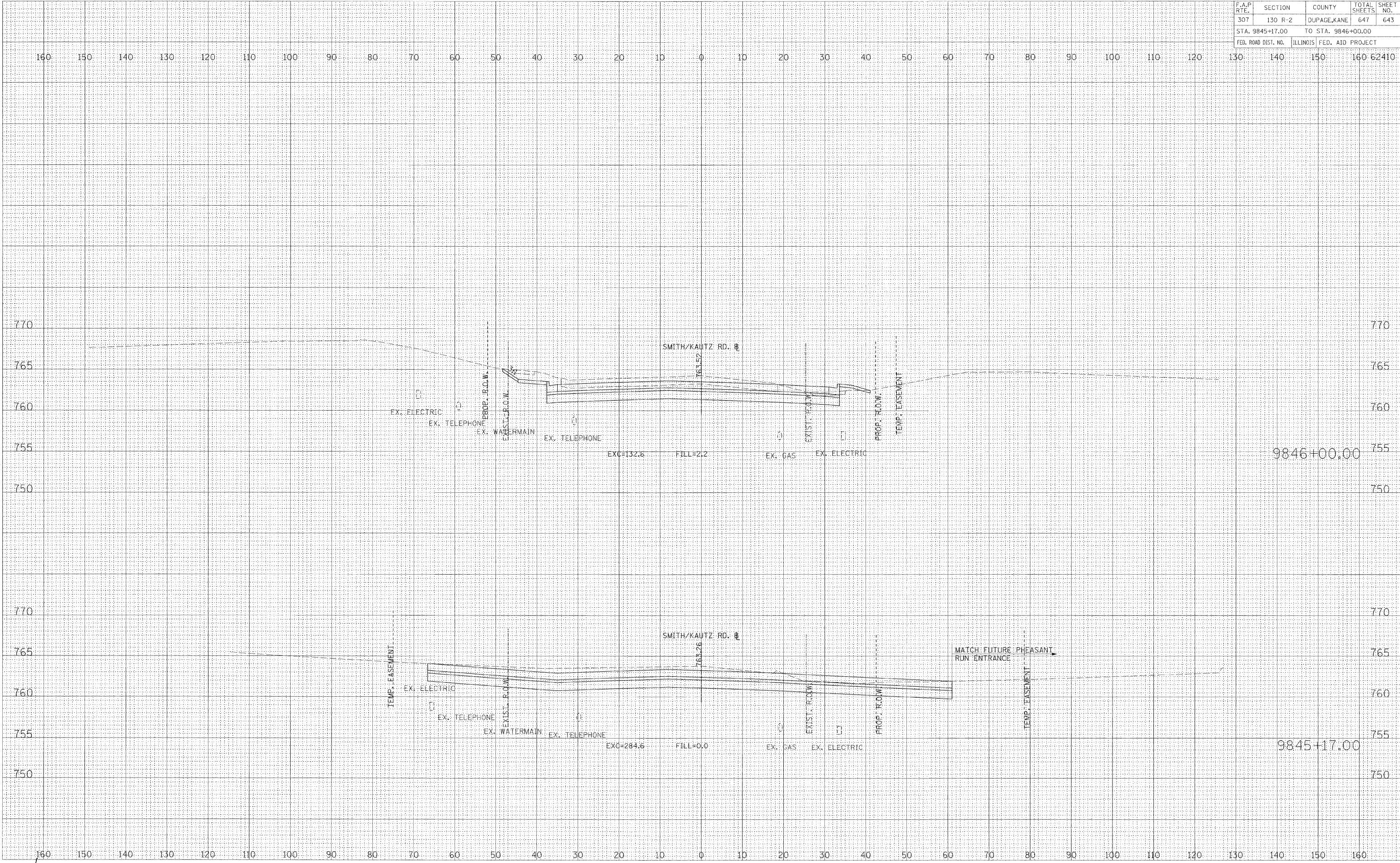

CROSS SECTIONS - SMITH AND KAUTZ ROAD









F.A.P. RTE.	SECTION	COUNTY	TOTAL SHEETS	SHEET NO.
307	130 R-2	DUPAGE, KANE	647	645
STA. 9852+00.00		TO STA. 9853+15.00		
FED. ROAD DIST. NO.	ILLINOIS	FED. AID PROJECT		

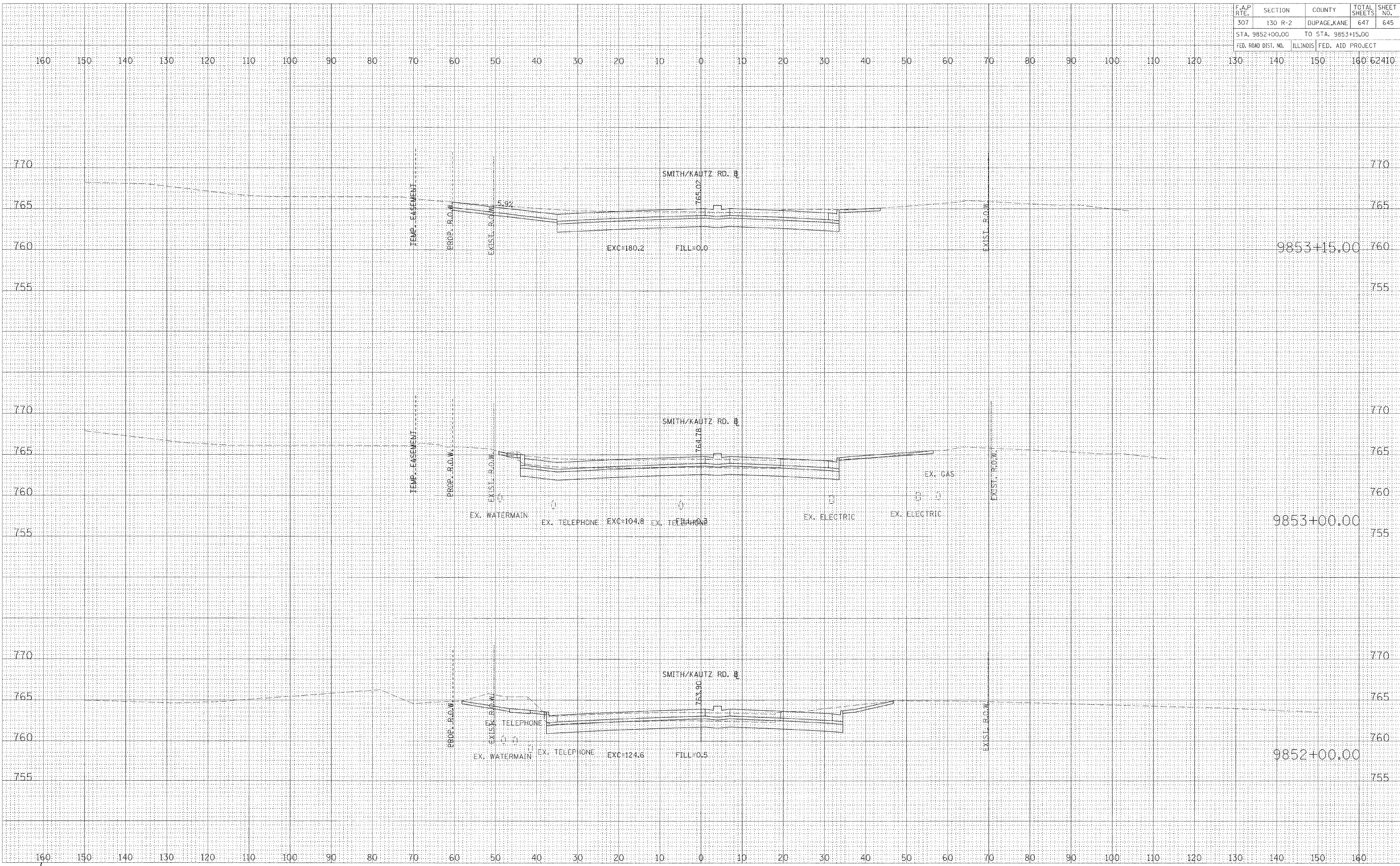

CROSS SECTIONS - SMITH AND KAUTZ ROAD

BY	DATE

BY	DATE







