

**PROJECT BEGINS
STA. 885+06.93**

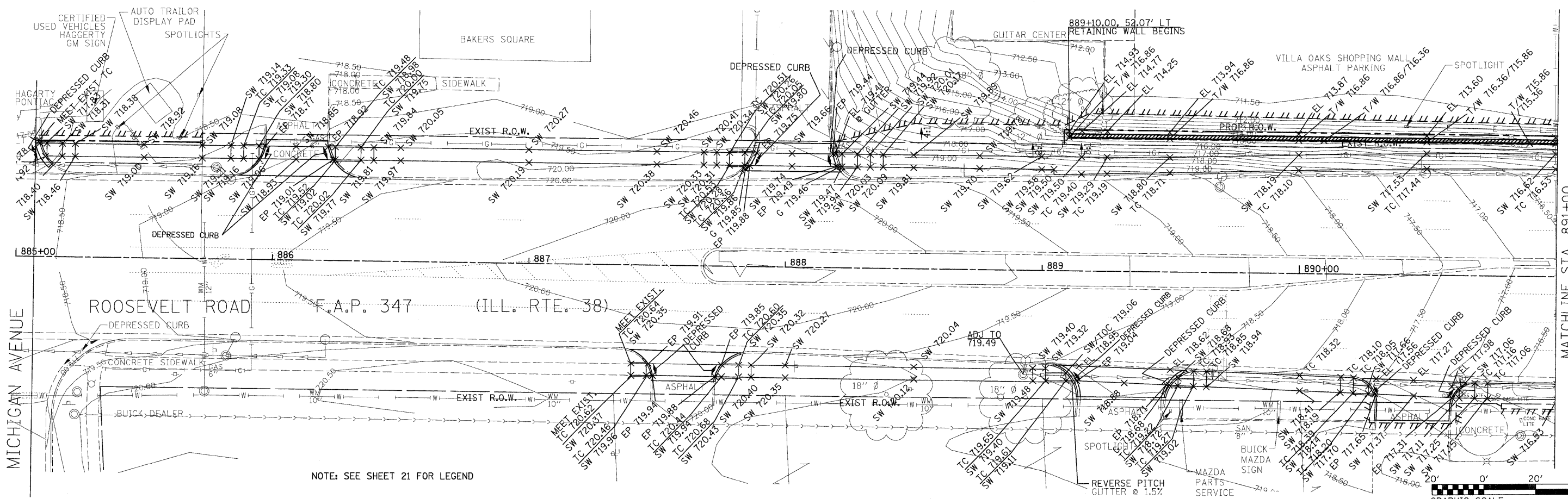
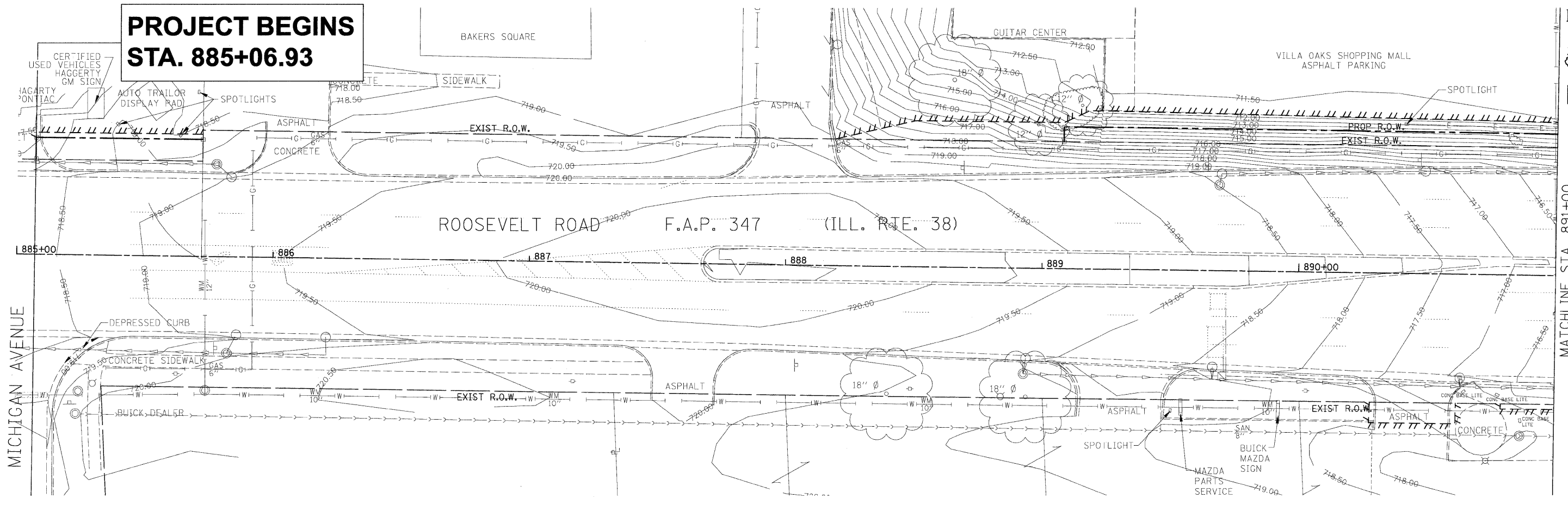

NOTE: SEE SHEET 21 FOR LEGEND

FILE NAME =
D163197-ah-01.dgn

USER NAME ID0T
PLOT SCALE 28,0000' / IN.
PLOT DATE 10/25/2011

DESIGNED DA/SC
DRAWN BM/CC/BB
CHECKED DA
DATE 06/08/2011

REVISED 10/24/2011
REVISED
REVISED
REVISED

**STATE OF ILLINOIS
DEPARTMENT OF TRANSPORTATION**

**EXISTING AND PROPOSED GRADING PLAN
FROM STA 885+06.93 TO STA 891+00**

SCALE: AS SHOWN SHEET NO. 1 OF 4 SHEETS STA. 885+07 TO STA. 891+00

F.A.P. RTE.	SECTION	COUNTY	TOTAL SHEETS	SHEET NO.
347	02-00077-00-SW	DUPAGE	73	20
CONTRACT NO. 63197				
FED. ROAD DIST. NO.		ILLINOIS FED. AID PROJECT		