

IMPROVEMENT BEGINS
STA. 89+00.00

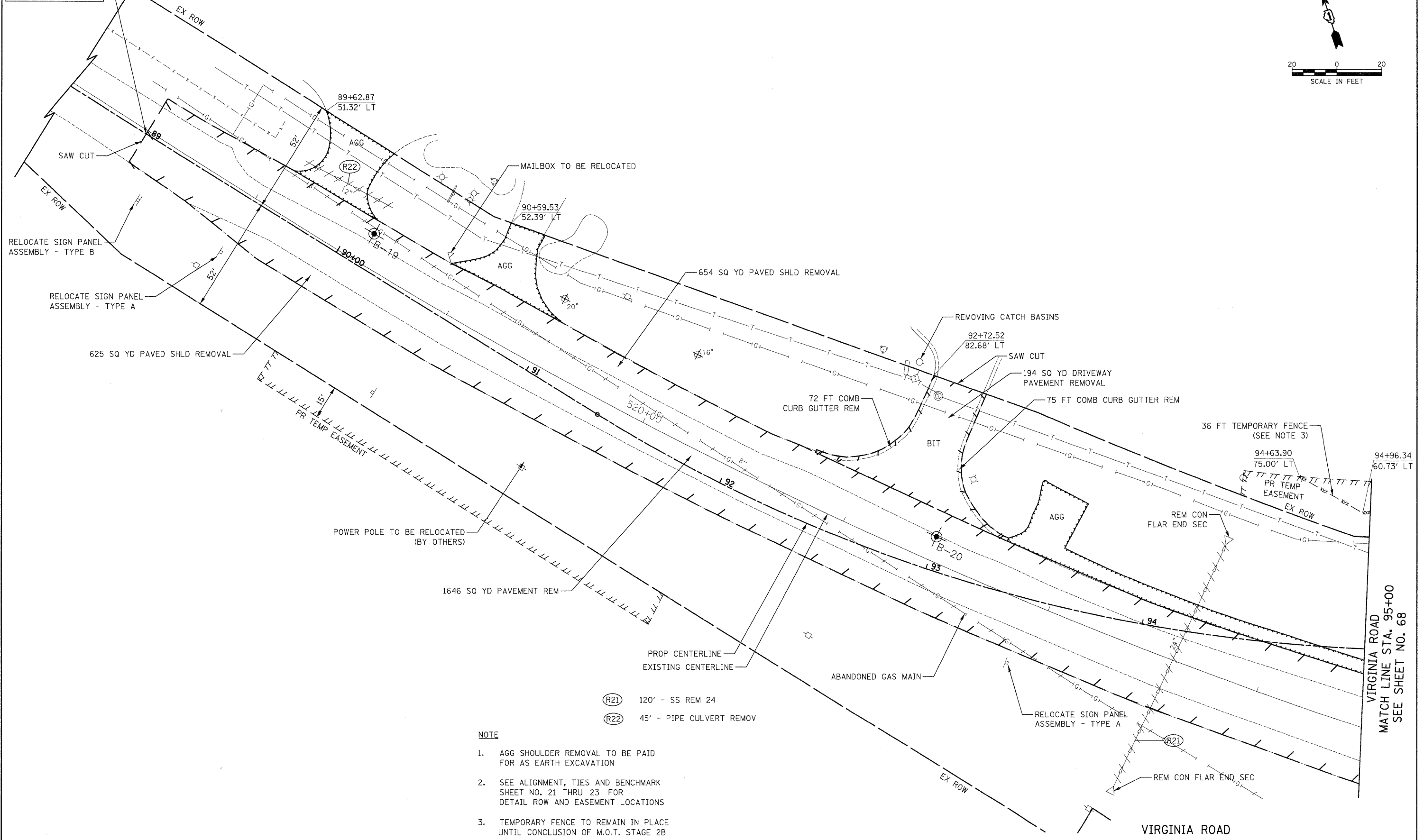

- (R21) 120' - SS REM 24
- (R22) 45' - PIPE CULVERT REMOV

- NOTE**
1. AGG SHOULDER REMOVAL TO BE PAID FOR AS EARTH EXCAVATION
 2. SEE ALIGNMENT, TIES AND BENCHMARK SHEET NO. 21 THRU 23 FOR DETAIL ROW AND EASEMENT LOCATIONS
 3. TEMPORARY FENCE TO REMAIN IN PLACE UNTIL CONCLUSION OF M.O.T. STAGE 2B

DATE	
BY	
REVIEWED	
PLOTTED	
ALIGNMENT CHECKED	
NOTED	
NO. CAD FILE NAME	
PLAN	
NOTE BOOK	
NO.	

DATE	
BY	
REVIEWED	
PLOTTED	
GRADES CHECKED	
STRUCTURE NOTATION CHECKED	
NO.	
PROFILE	
NOTE BOOK	
NO.	

FILE NAME = Y:\2278 Virginia\cadd\sheet\07-Remo	USER NAME = dte	DESIGNED - KWH	REVISED -
als\2278_REM_13.dgn		DRAWN - DTE	REVISED -
PLOT SCALE = 20.0000 ' / in.		CHECKED - GAB	REVISED -
PLOT DATE = 10/24/2011		DATE - 10/24/11	REVISED -

**STATE OF ILLINOIS
DEPARTMENT OF TRANSPORTATION**

REMOVAL PLAN		
SCALE: 1" = 20'	SHEET NO. 13 OF 14 SHEETS	STA. 89+00 TO STA. 95+00

F.A.U. RTE. 3887	SECTION 96-00209-01-PV	COUNTY McHENRY	TOTAL SHEETS 271	SHEET NO. 67
FED. ROAD DIST. NO. 1 ILLINOIS			FED. AID PROJECT HPP-4064(003)	
			CONTRACT NO. 63553	

VIRGINIA ROAD
MATCH LINE STA. 95+00
SEE SHEET NO. 68