

LEGEND

(XXX.XX) EXISTING PAVEMENT ELEVATION
XXX.XX PROPOSED PAVEMENT ELEVATION

ILLINOIS ROUTE 31

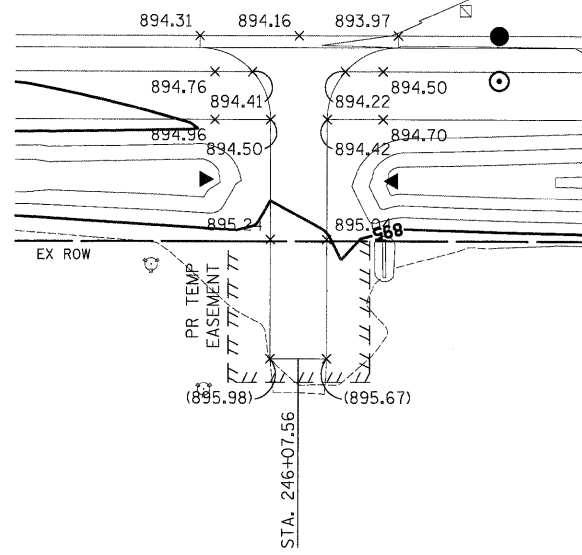

DETAIL "E"

PRIVATE ENTRANCE
STA. 246+07.56, RT

ILLINOIS ROUTE 31

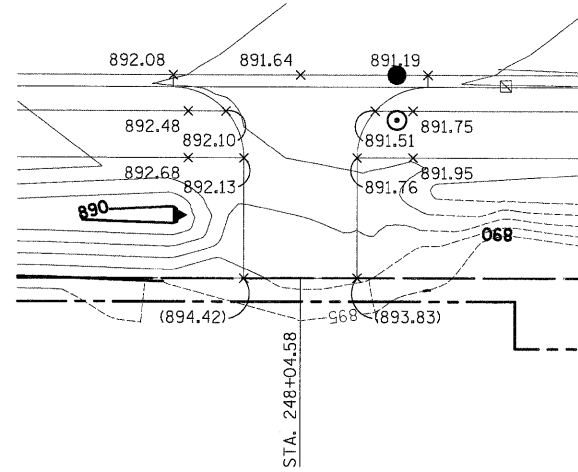

DETAIL "F"

PRIVATE ENTRANCE
STA. 248+04.58, RT

ILLINOIS ROUTE 31

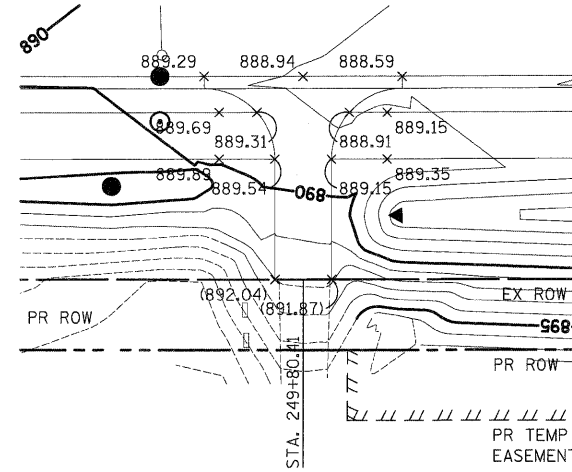

DETAIL "G"

PRIVATE ENTRANCE
STA. 249+80.41, RT

DATE	
BY	
SURVEYED	
PLOTTED	
GRADES CHECKED	
STRUCTURE NOTATIONS CHECKED	
NOTE BOOK NO.	
CADD FILE NAME	

DATE	
BY	
SURVEYED	
PLOTTED	
GRADES CHECKED	
STRUCTURE NOTATIONS CHECKED	
NOTE BOOK NO.	
CADD FILE NAME	

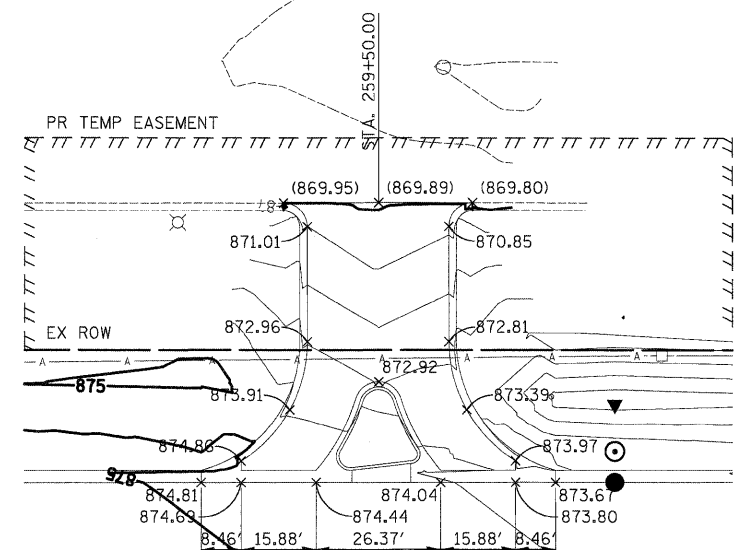

DETAIL "H"

COMMERCIAL ENTRANCE
STA. 259+50.00, LT

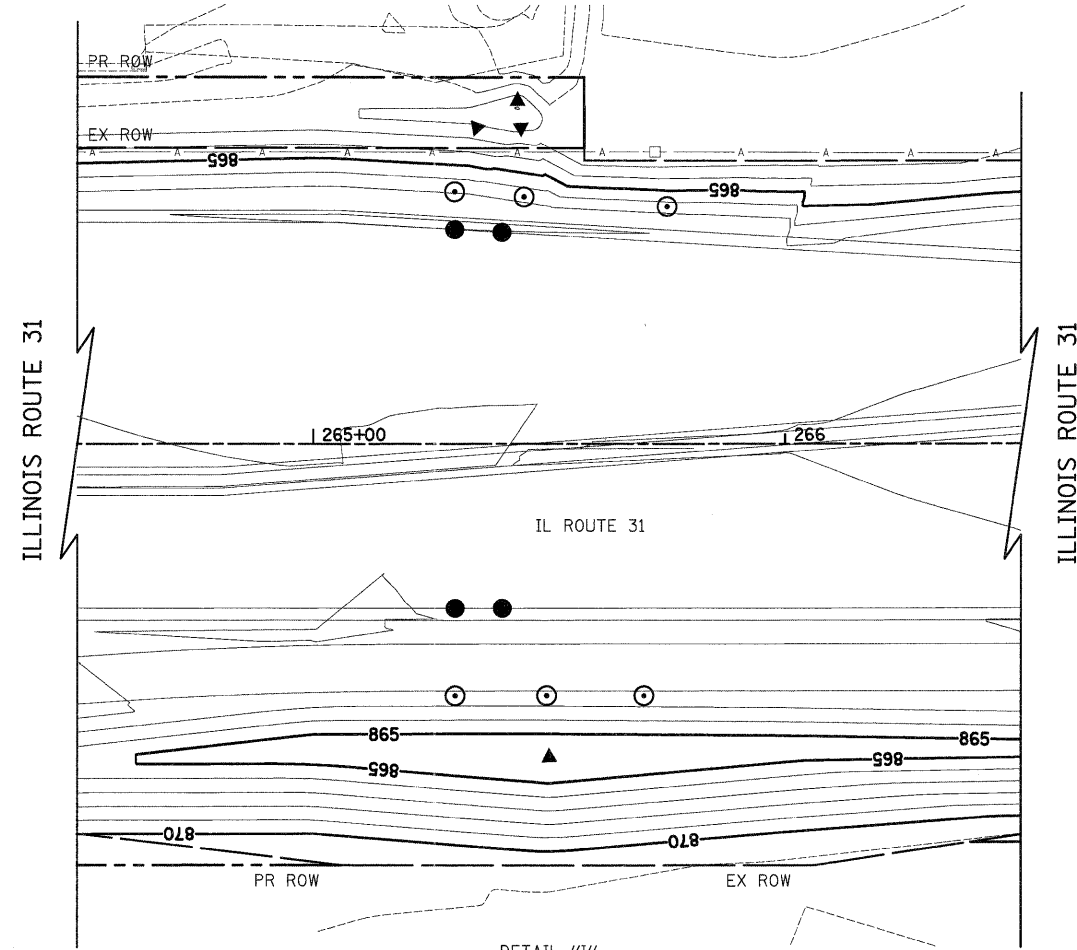

DETAIL "I"

SPECIAL DITCH GRADING
STA. 265+44 LT
STA. 265+50 RT

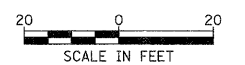

FILE NAME =	USER NAME = dte	DESIGNED - KWH	REVISED -	STATE OF ILLINOIS DEPARTMENT OF TRANSPORTATION	GRADING DETAILS	F.A.U. RTE. = 3887	SECTION = 96-00209-01-PV	COUNTY = MCHENRY	TOTAL SHEETS = 271	SHEET NO. = 160	
Y:\22278 Virginia Klasen\cadd\sheet\16-Detail	s\22278-sht-detail\16.dgn	DRAWN - KWH	REVISED -			SCALE: 1" = 20'	SHEET NO. 3 OF 6 SHEETS	STA. TO STA.	CONTRACT NO. 63553		FED. ROAD DIST. NO. 1 [ILLINOIS] FED. AID PROJECT HPP-4064(003)
	PLOT SCALE = 20.0000' / in.	CHECKED - GAB	REVISED -								
	PLOT DATE = 10/24/11	DATE - 10/24/11	REVISED -								