

- NOTES:
- CURB ALONG OUTSIDE EDGE OF PAVEMENT SHALL BE DEPRESSED WITHIN 4' OF THE RAILROAD CROSSING SURFACE.
 - ALL MEDIAN CURB SHALL BE REVERSED PITCHED.
 - CONTRACTOR SHALL EXTEND GUTTER WIDTH TO ENSURE A MINIMUM OF 2' HOT-MIX ASPHALT PAVEMENT WIDTH.

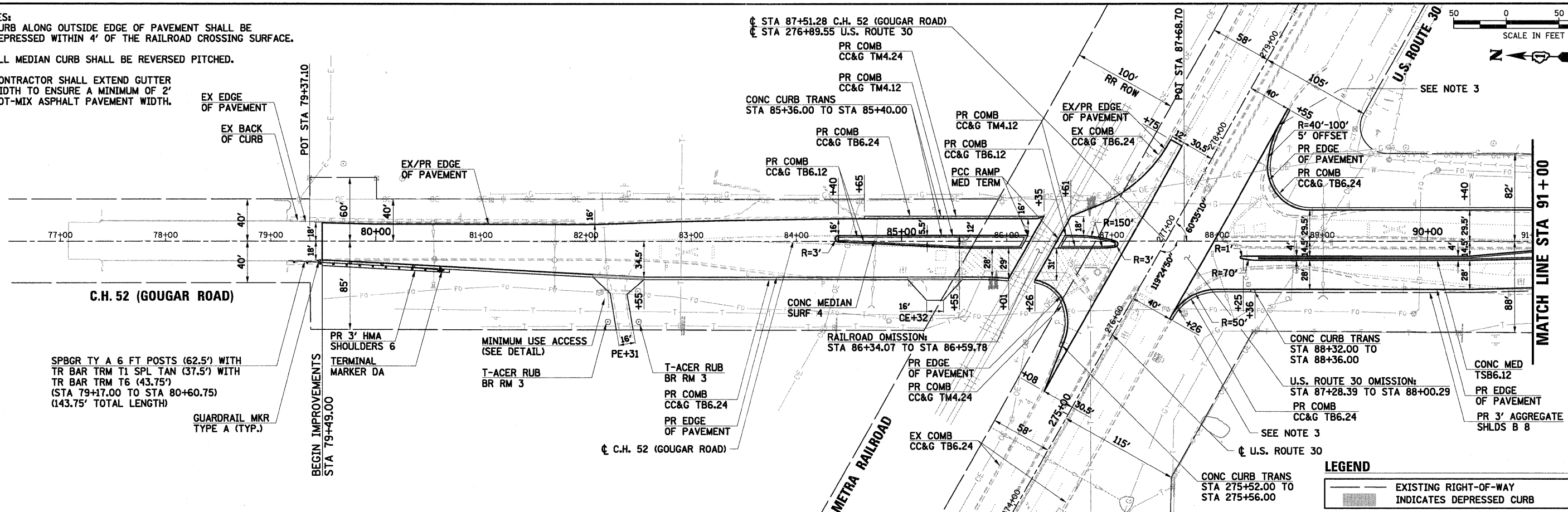
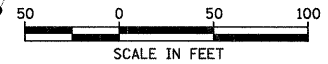

SPBGR TY A 6 FT POSTS (62.5') WITH TR BAR TRM T1 SPL TAN (37.5') WITH TR BAR TRM T6 (43.75') (STA 79+17.00 TO STA 80+60.75) (143.75' TOTAL LENGTH)

GUARDRAIL MKR TYPE A (TYP.)

BEGIN IMPROVEMENTS STA 79+49.00

MINIMUM USE ACCESS (SEE DETAIL)

C.H. 52 (GOUGAR ROAD)

METRA RAILROAD

CONC CURB TRANS STA 275+52.00 TO STA 275+56.00

LEGEND

- EXISTING RIGHT-OF-WAY
- INDICATES DEPRESSED CURB

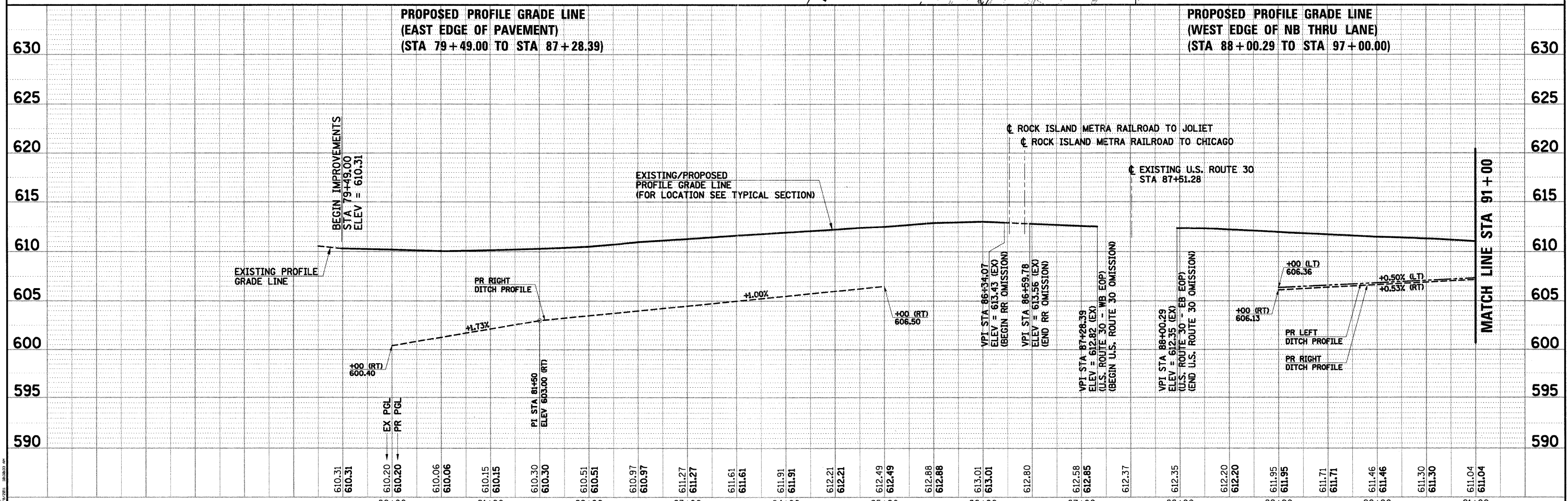

<p>SEC Group, Inc. An IRI Group Company 229 Alana Circle New Lenox, Illinois 60451 1.915.462.8024 F. 815.462.8028 www.secgroupinc.com McHenry, IL • Markletts, IL • New Lenox, IL • Chicago, IL</p>	USER NAME = RBes1 PLOT SCALE = 1" = 50' PLOT DATE = 11/8/2011	DESIGNED - BOC DRAWN - RCB CHECKED - APS DATE - 11/8/11	REVISED - REVISED - REVISED - REVISED -	<p align="center">ILLINOIS DEPARTMENT OF TRANSPORTATION PROPOSED ROADWAY IMPROVEMENTS C.H. 52 (GOUGAR ROAD) AT U.S. ROUTE 30</p>	<p align="center">PLAN AND PROFILE C.H. 52 (GOUGAR ROAD) STA 79+49 TO STA 91+00</p>	SCALE: 1" = 50' SHEET NO. 1 OF 2 SHEETS STA. TO STA.	<table border="1"> <tr> <th>F.A.U. RTE.</th> <th>SECTION NO.</th> <th>COUNTY</th> <th>TOTAL SHEETS</th> <th>SHEET NO.</th> </tr> <tr> <td>367</td> <td>07-00154-11-TL</td> <td>WILL</td> <td>70</td> <td>18</td> </tr> </table>	F.A.U. RTE.	SECTION NO.	COUNTY	TOTAL SHEETS	SHEET NO.	367	07-00154-11-TL	WILL	70	18
	F.A.U. RTE.	SECTION NO.	COUNTY	TOTAL SHEETS	SHEET NO.												
367	07-00154-11-TL	WILL	70	18													
CONTRACT NO. 63597 FED. ROAD DIST. NO. ILLINOIS FED. AID PROJECT																	