

SCALE IN FEET

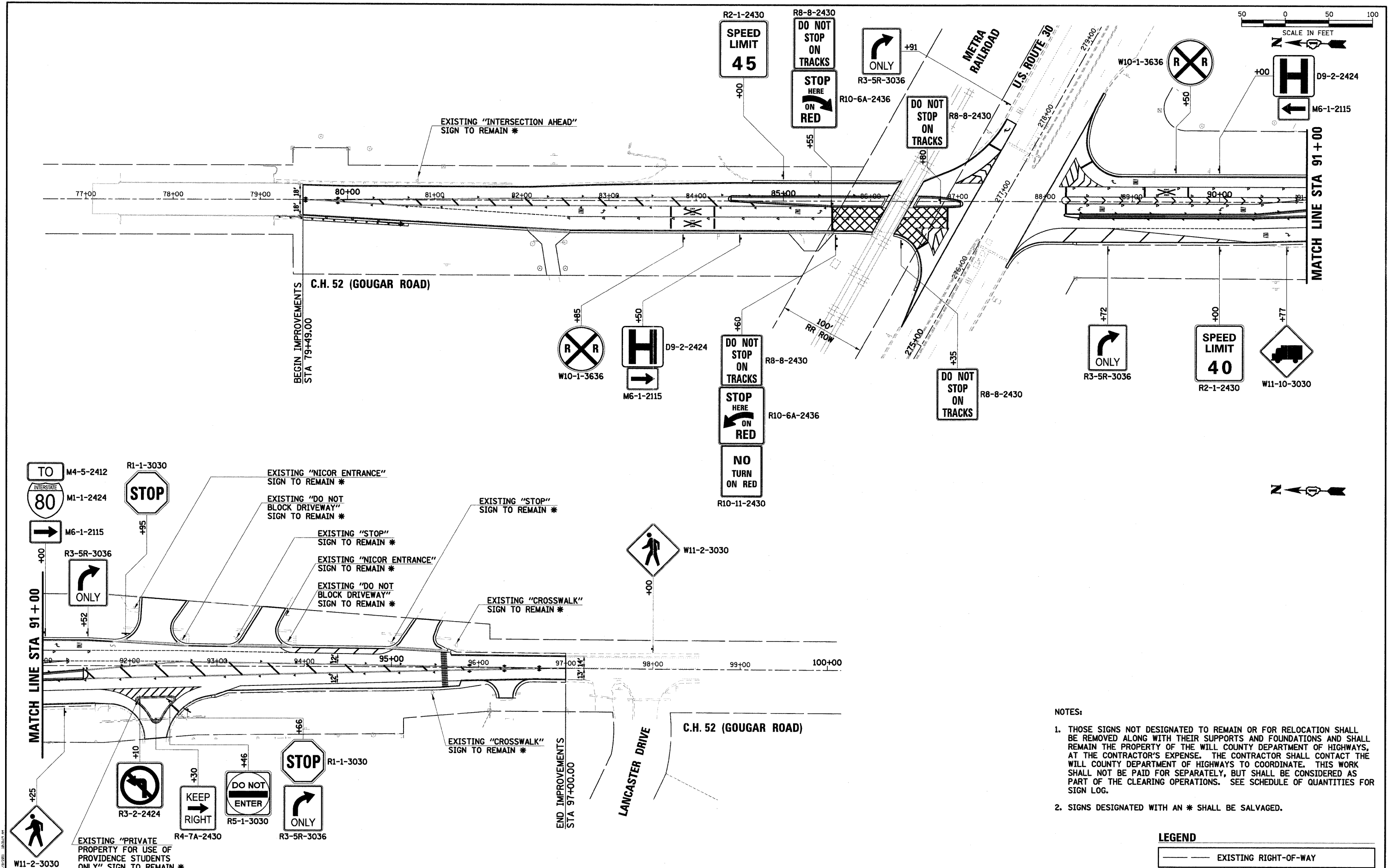

- NOTES:**
1. THOSE SIGNS NOT DESIGNATED TO REMAIN OR FOR RELOCATION SHALL BE REMOVED ALONG WITH THEIR SUPPORTS AND FOUNDATIONS AND SHALL REMAIN THE PROPERTY OF THE WILL COUNTY DEPARTMENT OF HIGHWAYS, AT THE CONTRACTOR'S EXPENSE. THE CONTRACTOR SHALL CONTACT THE WILL COUNTY DEPARTMENT OF HIGHWAYS TO COORDINATE. THIS WORK SHALL NOT BE PAID FOR SEPARATELY, BUT SHALL BE CONSIDERED AS PART OF THE CLEARING OPERATIONS. SEE SCHEDULE OF QUANTITIES FOR SIGN LOG.
 2. SIGNS DESIGNATED WITH AN * SHALL BE SALVAGED.

LEGEND

	EXISTING RIGHT-OF-WAY
--	-----------------------

SEC Group, Inc.
 11000 Professional Design Firm # 184-000158
 An HRI Group Company
 550 North Dixie
 New Lenox, Illinois 60451
 T. 815.462.2244 F. 815.462.8020
 www.secgroupinc.com
 *McHenry, IL *Mokena, IL *New Lenox, IL *Orland Park, IL

USER NAME = RBast	DESIGNED - BDC	REVISED -
PLOT SCALE = 1" = 50'	DRAWN - RCB	REVISED -
PLOT DATE = 11/8/2011	CHECKED - APS	REVISED -
	DATE - 11/8/11	REVISED -

**ILLINOIS DEPARTMENT OF TRANSPORTATION
 PROPOSED ROADWAY IMPROVEMENTS
 C.H. 52 (GOUGAR ROAD) AT U.S. ROUTE 30**

SIGNING PLAN

SCALE: 1" = 50' SHEET NO. OF SHEETS STA. TO STA.

F.A.U. RTE.	SECTION NO.	COUNTY	TOTAL SHEETS	SHEET NO.
367	07-00154-11-TL	WILL	70	29
CONTRACT NO. 63597				
FED. ROAD DIST. NO. ILLINOIS FED. AID PROJECT				