

**NOTES FOR TEMPORARY TRAFFIC SIGNALS**

1. ALL CONTROL EQUIPMENT INCLUDING EMERGENCY PRE-EMPTION AND COMMUNICATION DEVICES FOR THE TEMPORARY TRAFFIC SIGNAL(S) SHALL BE FURNISHED BY THE CONTRACTOR.
2. ONLY CONTROLLERS SUPPLIED BY ONE OF THE DISTRICT APPROVED CLOSED LOOP EQUIPMENT MANUFACTURERS WILL BE APPROVED FOR USE AT TEMPORARY SIGNAL LOCATIONS. ALL CONTROLLERS USED FOR TEMPORARY TRAFFIC SIGNALS SHALL BE FULLY ACTUATED NEMA MICROPROCESSOR BASED WITH RS232 DATA ENTRY PORTS COMPATIBLE WITH EXISTING MONITORING SOFTWARE APPROVED BY IDOT DISTRICT 1, INSTALLED IN A NEMA TS2 CABINET. ONLY ONE BRAND OF CONTROLLER WILL BE ACCEPTED FOR ANY ONE CONTRACT.
3. ALL TRAFFIC SIGNAL SECTIONS AND PEDESTRIAN SIGNAL SECTIONS SHALL BE LED AND 12" DIAMETER. HEADS SHALL BE PLACED AS INDICATED ON THE TEMPORARY TRAFFIC SIGNAL PLAN OR AS DIRECTED BY THE ENGINEER. PEDESTRIAN SIGNALS SHALL INCLUDE SOLID INTERNATIONAL SYMBOLS. PEDESTRIAN SIGNALS WITH COUNTDOWN TIMERS SHALL BE USED WHEN THE EXISTING INSTALLATION UTILIZES COUNTDOWN TYPE OR AS DIRECTED BY THE ENGINEER. COUNTDOWN TYPE PEDESTRIAN SIGNALS ARE NOT TO BE INSTALLED AT A RAILROAD INTERSECTION. THE CONTRACTOR SHALL FURNISH ENOUGH CABLE SLACK TO RELOCATE HEADS TO ANY POSITION ON THE SPAN WIRE OR AT LOCATIONS ILLUSTRATED ON THE PLANS FOR CONSTRUCTION STAGING. THE TEMPORARY TRAFFIC SIGNAL SHALL REMAIN IN OPERATION DURING ALL SIGNAL HEAD RELOCATIONS. EACH TEMPORARY TRAFFIC SIGNAL HEAD SHALL HAVE ITS OWN CABLE FROM THE CONTROLLER CABINET TO THE SIGNAL HEAD.
4. ALL EXISTING STREET NAME AND INTERSECTION REGULATORY SIGNS SHALL BE REMOVED FROM EXISTING POLES, RELOCATED AND SECURELY FASTENED TO THE SPAN WIRE OR WOOD POLE AS DIRECTED BY THE ENGINEER.
5. ANY TEMPORARY SIGNAL WITHIN AN EXISTING CLOSED LOOP TRAFFIC SIGNAL SYSTEM SHALL BE INTERCONNECTED TO THAT SYSTEM USING SIMILAR BRAND CONTROL EQUIPMENT.
6. THE TEMPORARY TRAFFIC SIGNAL SHALL HAVE THE SIGNAL HEAD DISPLAYS, SIGNAL HEAD PLACEMENTS AND CONTROLLER PHASING MATCH THE EXISTING TRAFFIC SIGNAL, AT THE TIME OF THE TURN ON, IF NO TRAFFIC STAGING IS IN PLACE OR WILL NOT BE STAGED ON THE DAY OF THE TURN ON.
7. UNINTERRUPTIBLE POWER SUPPLY (UPS) SYSTEMS SHALL BE INSTALLED AND MADE OPERATIONAL AT TEMPORARY TRAFFIC SIGNAL INSTALLATIONS WHERE UPS IS INSTALLED AT THE EXISTING TRAFFIC SIGNAL, TEMPORARY TRAFFIC SIGNALS AT INTERSECTIONS WITH FIRE STATION ACTUATED EMERGENCY VEHICLE PRE-EMPTION, OR WHEN INDICATED ON THE PLANS.
8. TRAFFIC SIGNAL MANAGEMENT SYSTEMS SHALL BE MAINTAINED IN OPERATION AS INDICATED ON THE PLANS OR AS DIRECTED BY THE ENGINEER. REQUIRED EQUIPMENT SHALL BE AS SHOWN ON THE PLANS AND THE CONTRACTOR SHALL PLACE THE EQUIPMENT IN OPERATION TO THE SATISFACTION OF THE ENGINEER AND THE AGENCY RESPONSIBLE FOR THE TRAFFIC SIGNAL MANAGEMENT SYSTEM.
9. DETECTION AT TEMPORARY TRAFFIC SIGNALS SHALL BE INCLUDED FOR ALL APPROACHES OF THE INTERSECTION UNLESS INDICATED OTHERWISE ON THE PLANS. THE DETECTION SYSTEM MUST MEET THE SPECIFICATIONS OF DISTRICT 1 AND THE CONTRACTOR SHALL PLACE THE DETECTORS INTO OPERATION TO THE SATISFACTION OF THE ENGINEER.
10. WHEN PAN, TILT, ZOOM CAMERAS ARE INSTALLED AT THE EXISTING INTERSECTION OR ARE CALLED FOR IN THE PLANS, THE CONTRACTOR SHALL BE RESPONSIBLE FOR INSTALLING AND MAINTAINING THE CAMERAS TO THE SATISFACTION OF THE ENGINEER AND THE AGENCY RESPONSIBLE FOR THE CAMERAS.
11. ALL LABOR AND MATERIAL REQUIRED TO COMPLY WITH THESE REQUIREMENTS SHALL BE INCLUDED IN THE CONTRACT BID PRICE FOR TEMPORARY TRAFFIC SIGNAL INSTALLATION.

- \* INSTALL TEMPORARY CONDUIT IN ORDER TO CONNECT THE TEMPORARY TRAFFIC SIGNALS. THE PROPOSED HANDHOLE ON THE NORTH SIDE OF THE RAILROAD TRACKS AND THE PERMANENT CONDUIT THAT RUNS UNDERNEATH THE RAILROAD TRACKS SHALL BE INSTALLED IN CONJUNCTION WITH THE TEMPORARY TRAFFIC SIGNALS.
- \*\* INSTALL TEMPORARY RADIO INTERCONNECT IN ORDER TO MAINTAIN THE EXISTING INTERCONNECT TO WASHINGTON STREET AND I-80 WEST RAMP DURING TEMPORARY TRAFFIC SIGNAL INSTALLATION (SEE SPECIAL PROVISIONS).
- \*\*\* THE POLE MOUNTED SIGNAL HEADS SHALL BE MOUNTED SO THAT THE BOTTOM OF THE SIGNAL HOUSING IS 8 FEET ABOVE THE PAVEMENT GRADE AT THE CENTER OF THE ROADWAY. THE SOUTHBOUND PRE-SIGNALS SHALL NOT OBSTRUCT THE RAILROAD WARNING DEVICES.

- NOTES:
1. SEE TEMPORARY TRAFFIC SIGNAL INSTALLATION STAGE 2 FOR TEMPORARY SIGNAGE.
  2. SEE INTERCONNECT PLANS FOR THE TEMPORARY INTERCONNECT AND PROPOSED INTERCONNECT REQUIREMENTS.

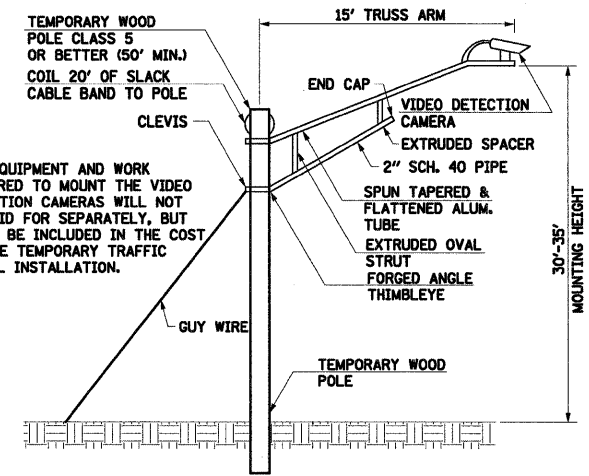
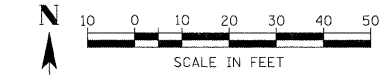

**TEMPORARY VIDEO DETECTION CAMERA MOUNTING DETAIL**

THE TRAFFIC SIGNAL CONTROL EQUIPMENT FOR THIS PROJECT SHALL BE "EAGLE" TO MATCH THE EXISTING ADJACENT SYSTEM.

THE FOLLOWING ITEMS SHALL BE REMOVED BY THE CONTRACTOR AND SHALL BE DISPOSED OF BY HIM OUTSIDE THE RIGHT-OF-WAY AT HIS EXPENSE. THE SALVAGE VALUE OF THE REMOVED EQUIPMENT SHALL BE REFLECTED IN THE CONTRACT BID PRICE. THIS WORK SHALL BE PAID FOR AT THE CONTRACT UNIT PRICE EACH FOR REMOVE EXISTING TRAFFIC SIGNAL EQUIPMENT (SEE SCHEDULE OF QUANTITIES FOR REMOVE ITEMS TO BE PAID FOR SEPARATELY).

- 5 EACH STEEL MAST ARM ASSEMBLY AND POLES
- 5 EACH TRAFFIC SIGNAL POSTS
- 15 EACH TRAFFIC SIGNAL HEADS
- 8 EACH TRAFFIC SIGNAL BACKPLATES
- 1 EACH SERVICE INSTALLATION
- 1 EACH TRAFFIC SIGNAL CONTROLLER AND CABINET (COMPLETE)
- 4 EACH ILLUMINATED NO LEFT/RIGHT-TURN SIGNS

THE FOLLOWING EXISTING TRAFFIC SIGNAL EQUIPMENT SHALL BE REMOVED BY THE CONTRACTOR, SHALL REMAIN THE PROPERTY OF THE VILLAGE OF NEW LENOX FIRE DEPARTMENT AND SHALL BE DELIVERED BY THE CONTRACTOR TO THE MAINTENANCE FACILITY DESIGNATED BY THE FIRE DEPARTMENT. THIS WORK SHALL BE INCLUDED IN THE CONTRACT UNIT PRICE FOR REMOVE EXISTING TRAFFIC SIGNAL EQUIPMENT.

- 2 EACH CONFIRMATION BEACON
- 2 EACH LIGHT DETECTOR

**LEGEND**

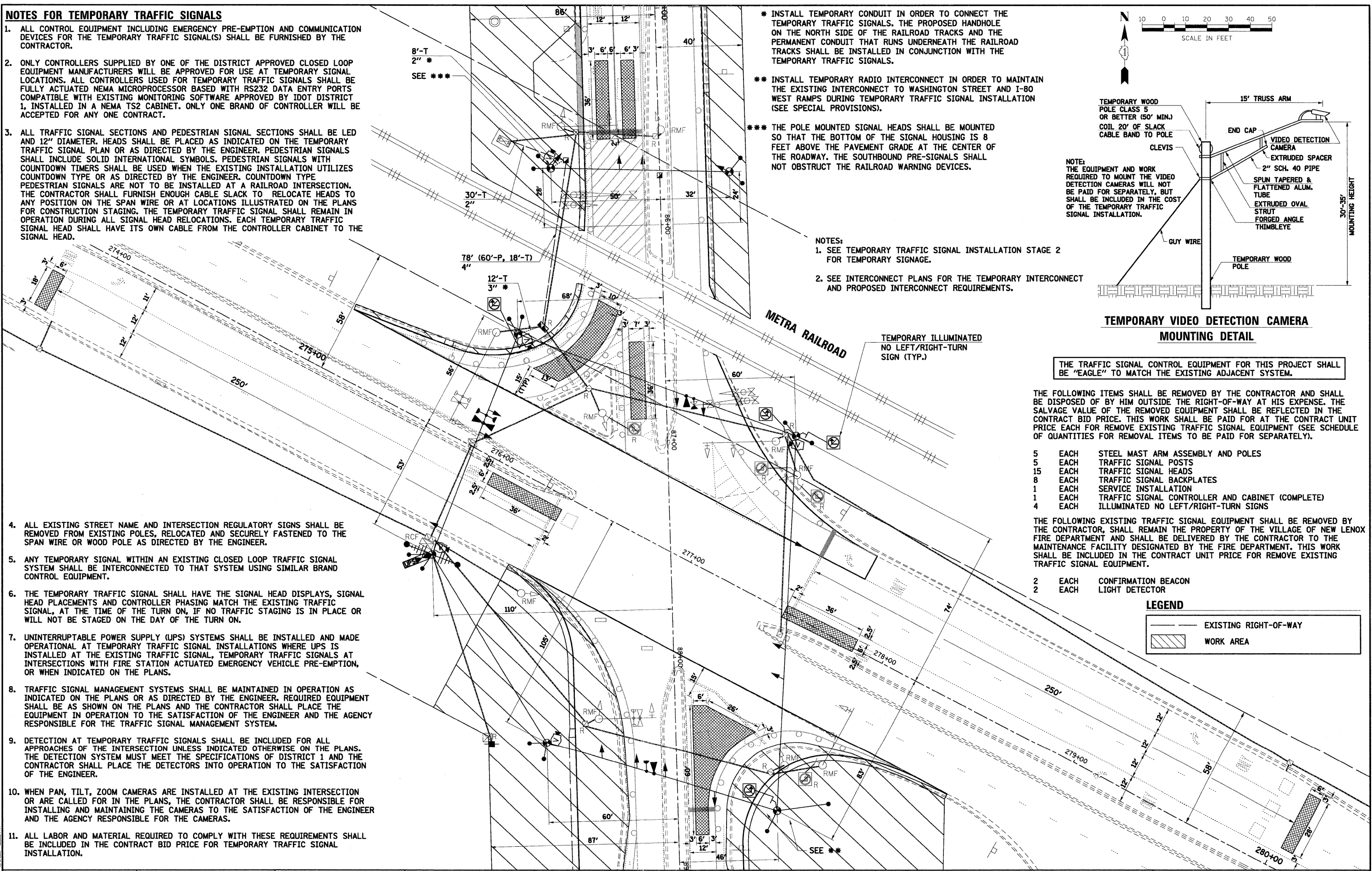
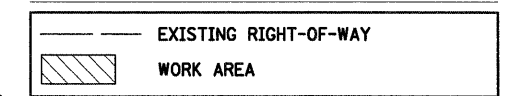

**SEC Group, Inc.**  
 An IRI Group Company  
 325 Adams Drive  
 New Lenox, Illinois 60451  
 815.462.9224 • 815.462.9228  
 www.secgroup.com

USER NAME = RB09t	DESIGNED - MJF	REVISED -
PLOT SCALE = 1"=20'	DRAWN - MJF	REVISED -
PLOT DATE = 11/8/2011	CHECKED - APS	REVISED -
	DATE - 11/8/11	REVISED -

**ILLINOIS DEPARTMENT OF TRANSPORTATION  
 PROPOSED ROADWAY IMPROVEMENTS  
 C.H. 52 (GOUGAR ROAD) AT U.S. ROUTE 30**

**TEMPORARY TRAFFIC SIGNAL INSTALLATION AND EXISTING TRAFFIC SIGNAL EQUIPMENT TO BE REMOVED - STAGE 1**

SCALE: 1"=20'	SHEET NO. OF SHEETS	STA. TO STA.
---------------	---------------------	--------------

F.A.U. RTE. 367	SECTION NO. 07-00154-11-TL	COUNTY WILL	TOTAL SHEETS 70	SHEET NO. 37
FED. ROAD DIST. NO. [ILLINOIS] FED. AID PROJECT			CONTRACT NO. 63597	