

F.A.P. RTE.	SECTION	COUNTY	TOTAL SHEETS	SHEET NO.
336	06-00345-00-CH	KANE	92	1
ILLINOIS		CONTRACT NO. 63623		

FOR INDEX OF SHEETS, SEE SHEET NO. 2

FOR LIST OF HIGHWAY STANDARDS, SEE SHEET NO. 2

DESIGN DESIGNATION:

RANDALL RD = PRINCIPAL ARTERIAL
 US ROUTE 20 RAMP = FREEWAY/EXPRESSWAY
 FOOTHILL ROAD = LOCAL STREET

ADT:

RANDALL RD = 61,000 (2030)
 US ROUTE 20 RAMP = 13,000 (2030)
 FOOTHILL ROAD = 10,000 (2030)

DESIGN SPEED:

RANDALL RD = 45 MPH
 US ROUTE 20 RAMP = 30 MPH
 FOOTHILL ROAD = 45 MPH

STATE OF ILLINOIS

DEPARTMENT OF TRANSPORTATION

DIVISION OF HIGHWAYS

PLANS FOR PROPOSED FEDERAL AID HIGHWAY

**FAP 336 (RANDALL ROAD)
 AT FAP 345 (US ROUTE 20) (FOOTHILL ROAD)
 INTERSECTION IMPROVEMENTS
 SECTION 06-00345-00-CH
 PROJECT CMF-8003 (711)**

**KANE COUNTY
 JOB NO: C-91-056-07**



LOCATION OF SECTION INDICATED THUS: - ■ -

PROJECT LOCATED IN
CITY OF ELGIN

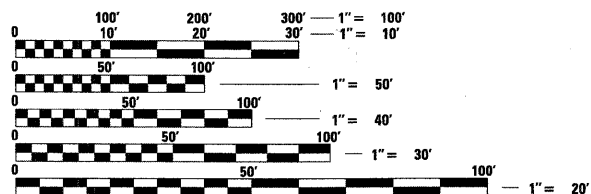

FULL SIZE PLANS HAVE BEEN PREPARED USING STANDARD ENGINEERING SCALES. REDUCED SIZED PLANS WILL NOT CONFORM TO STANDARD SCALES. IN MAKING MEASUREMENTS ON REDUCED PLANS, THE ABOVE SCALES MAY BE USED.

J.U.L.I.E. (JOINT UTILITY LOCATION INFORMATION FOR EXCAVATION)
 1-800-892-0123 OR 811

PLANS PREPARED BY
 HDR ENGINEERING INC.
 FOR
 CARL SCHOEDEL, P.E.,
 DIRECTOR OF TRANSPORTATION/ COUNTY ENGINEER
 KANE COUNTY DIVISION OF TRANSPORTATION

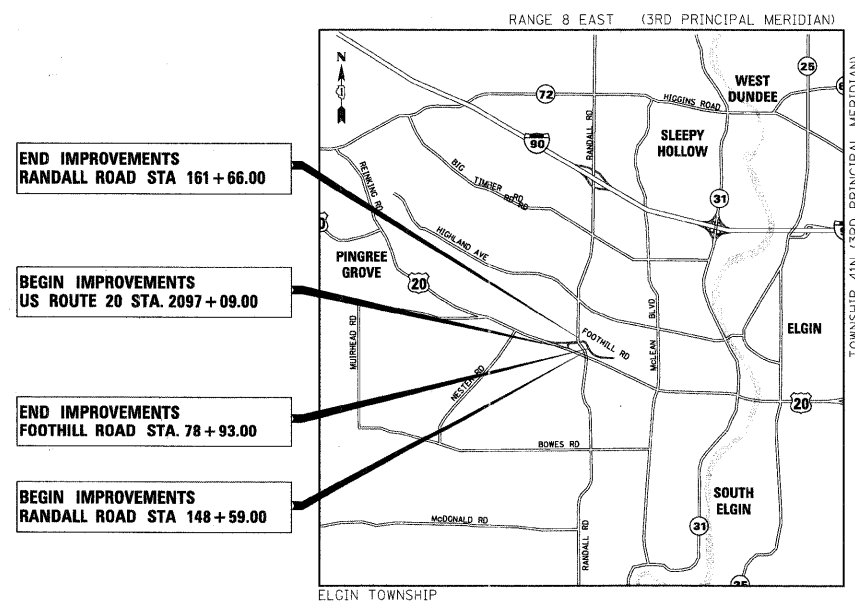

LOCATION MAP
 SCALE = N.T.S.
 GROSS LENGTH = 3,414 FT. = 0.64 MILES
 NET LENGTH = 3,414 FT. = 0.64 MILES

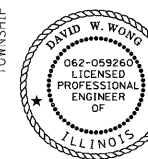

BY: *David Wong* DATE: 10/24/11
 HDR ENGINEERING, INC.
 DWGS. 1-92
 LICENSE EXPIRES NOV. 30, 2011

STATE OF ILLINOIS
 DEPARTMENT OF TRANSPORTATION

APPROVED OCTOBER 20, 2011
[Signature]
 DIRECTOR OF TRANSPORTATION/COUNTY ENGINEER
 KANE COUNTY DIVISION OF TRANSPORTATION

PASSED November 8, 2011
[Signature]
 DISTRICT 1 ENGINEER OF LOCAL ROADS & STREETS

RELEASING FOR BID
 BASED ON LIMITED
 REVIEW NOVEMBER 8, 2011
[Signature]
 DEPUTY DIRECTOR OF HIGHWAYS, REGION 1 ENGINEER

**PRINTED BY THE AUTHORITY
 OF THE STATE OF ILLINOIS**

HDR 8550 W. Bryn Mawr Ave., Suite 900
 Chicago, IL 60631
 773-380-7900
 HDR Engineering, Inc.

PROGRAM AND OFFICE ENGINEER: CHARLES F. RIDDELL, P.E., (847) 705-4406, SCHAUMBURG, IL.

CONTRACT NO. 63623