

DATE	
BY	
SURVEYED	
ALIGNMENT CHECKED	
PLAN OF WORK CHECKED	
FIELD FILE NAME	
PLAN	
NOTE BOOK	
NO.	

DATE	
BY	
SURVEYED	
GRADES CHECKED	
B.M. NOTED	
STRUCTURE NOTED THIS CIRCUIT	
PROFILE	
NOTE BOOK	
NO.	

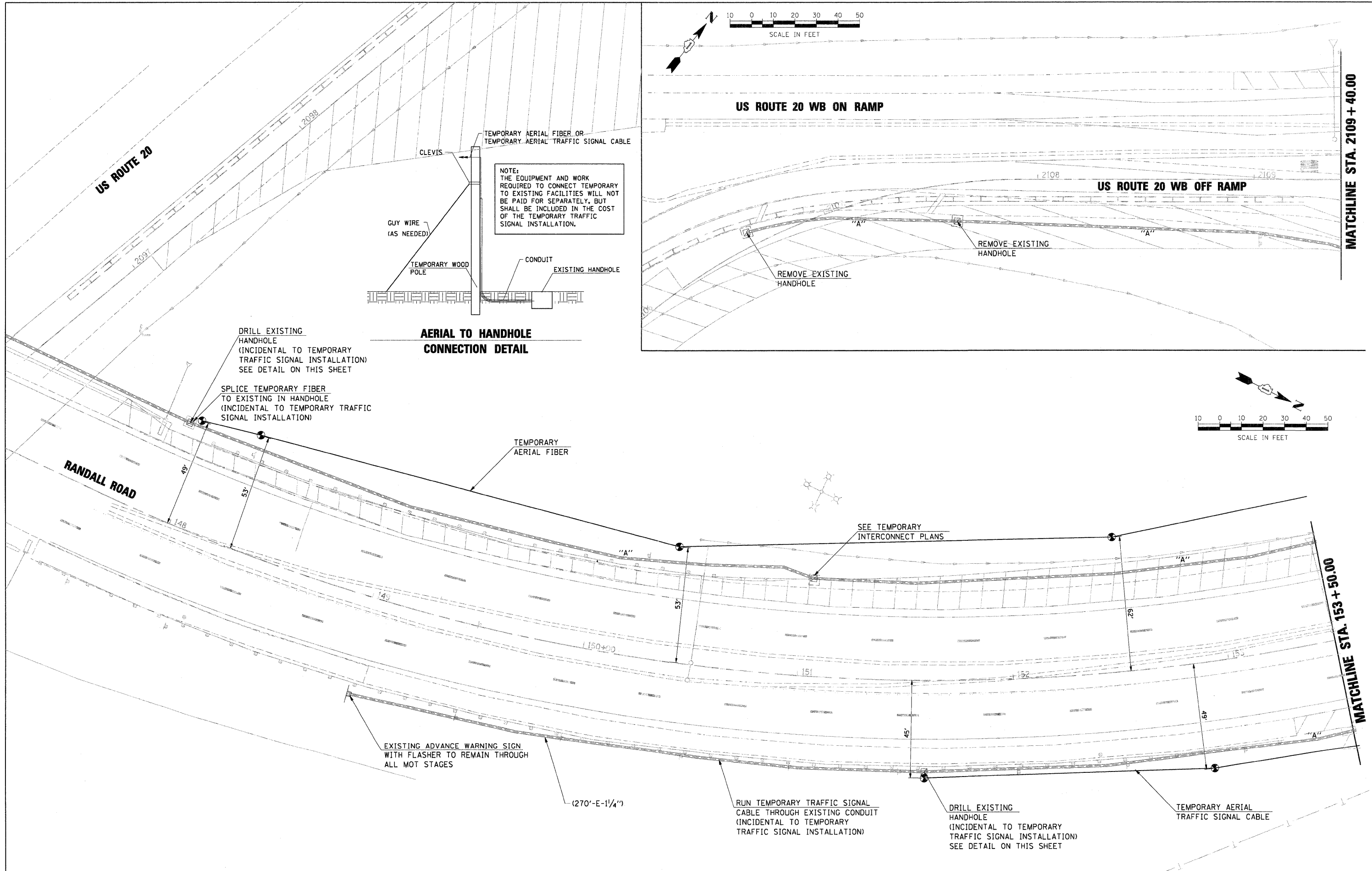

FILE NAME = D:\157287-SHT-TS02-TPLAN01.DGN

USER NAME = melopez  
 DESIGNED - BH  
 DRAWN - BH  
 CHECKED - DWW  
 DATE - 05-09-2011

REVISED -  
 REVISED -  
 REVISED -  
 REVISED -

**STATE OF ILLINOIS  
 DEPARTMENT OF TRANSPORTATION**

**TEMPORARY TRAFFIC SIGNAL INSTALLATION AND REMOVE  
 EXISTING TRAFFIC SIGNAL EQUIPMENT PLAN - STAGE 1  
 RANDALL RD AT US RTE 20 WB OFF RAMP (FOOTHILL RD)**

SCALE: SHEET NO. OF SHEETS STA. TO STA.

F.A.P. RTE. 336	SECTION 06-00345-00-CH	COUNTY KANE	TOTAL SHEETS 92	SHEET NO. 32
CONTRACT NO. 63623				
FED. ROAD DIST. NO. 1 ILLINOIS FED. AID PROJECT				