

PLAN	DATE
NO.	
BY	
SURVEYED	
ALIGNMENT CHECKED	
GRADES CHECKED	
CONTRACT FILE NAME	
NO.	

PROFILE	DATE
NO.	
BY	
SURVEYED	
GRADES CHECKED	
STRUCTURE NOTATIONS CHECKED	
NO.	

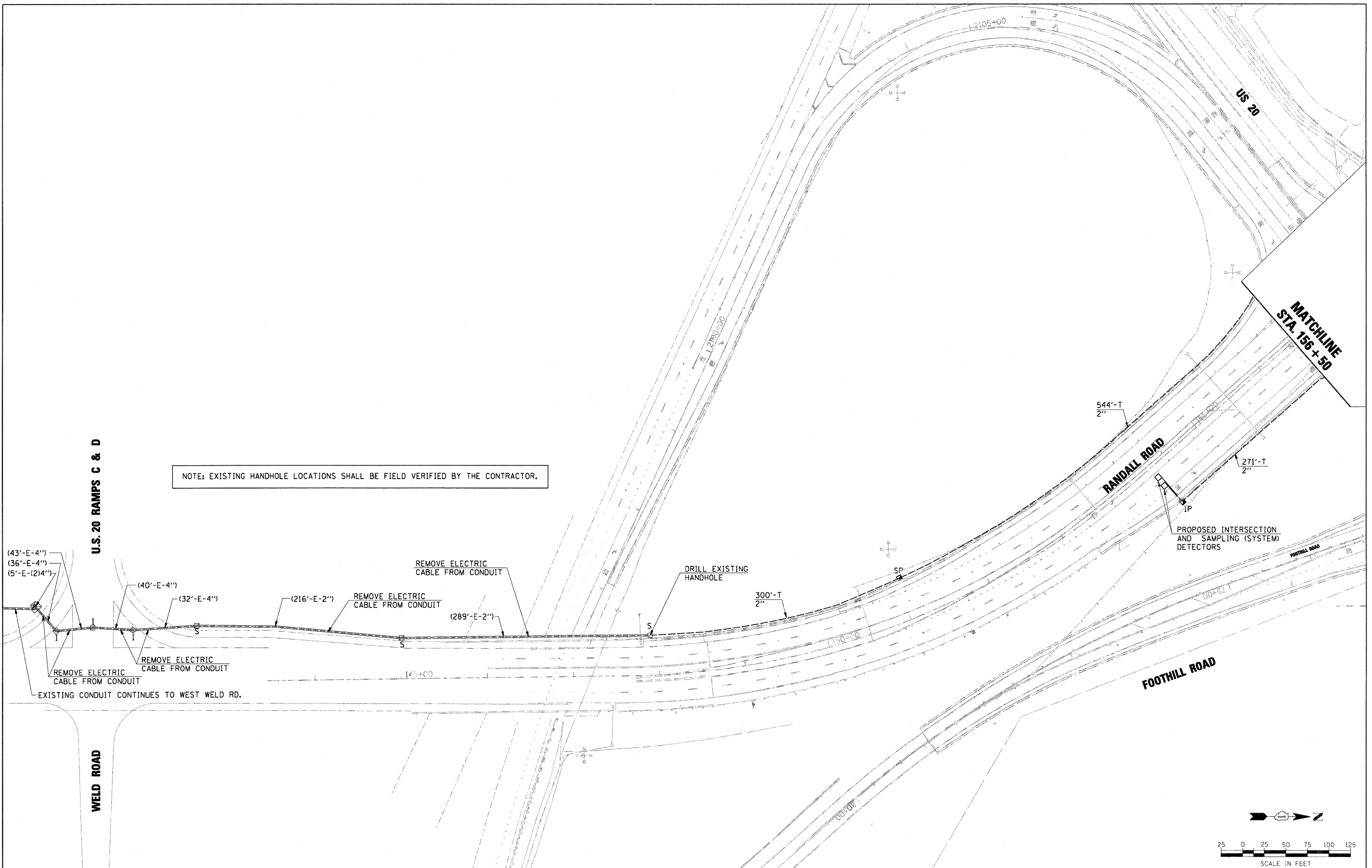

NOTE: EXISTING HANDHOLE LOCATIONS SHALL BE FIELD VERIFIED BY THE CONTRACTOR.

EXISTING CONDUIT CONTINUES TO WEST WELD RD.

FILE NAME =  
D:\157207-SHT-TS12A-INT01.DGN

USER NAME = melopez  
DESIGNED - BH  
DRAWN - BH  
CHECKED - DWW  
DATE - 05-09-2011

REVISED -  
REVISED -  
REVISED -  
REVISED -

**STATE OF ILLINOIS  
DEPARTMENT OF TRANSPORTATION**

**PROPOSED TRAFFIC SIGNAL INTERCONNECT PLAN  
RANDALL ROAD FROM WELD ROAD TO HIGHLAND AVENUE**

SCALE: SHEET NO. OF SHEETS STA. TO STA.

F.A.P. RTE.	SECTION	COUNTY	TOTAL SHEETS	SHEET NO.
336	06-00345-00-CH	KANE	92	39
CONTRACT NO. 63623				
FED. ROAD DIST. NO. 1 ILLINOIS FED. AID PROJECT				