

DATE	
BY	
SURVEYED	
TEMP. DATE	
AREAS CHECKED	
FINAL SURVEY	
NOTE BOOK	
NO.	

DATE	
BY	
SURVEYED	
TEMP. DATE	
AREAS CHECKED	
ORIGINAL SURVEY	
NOTE BOOK	
NO.	

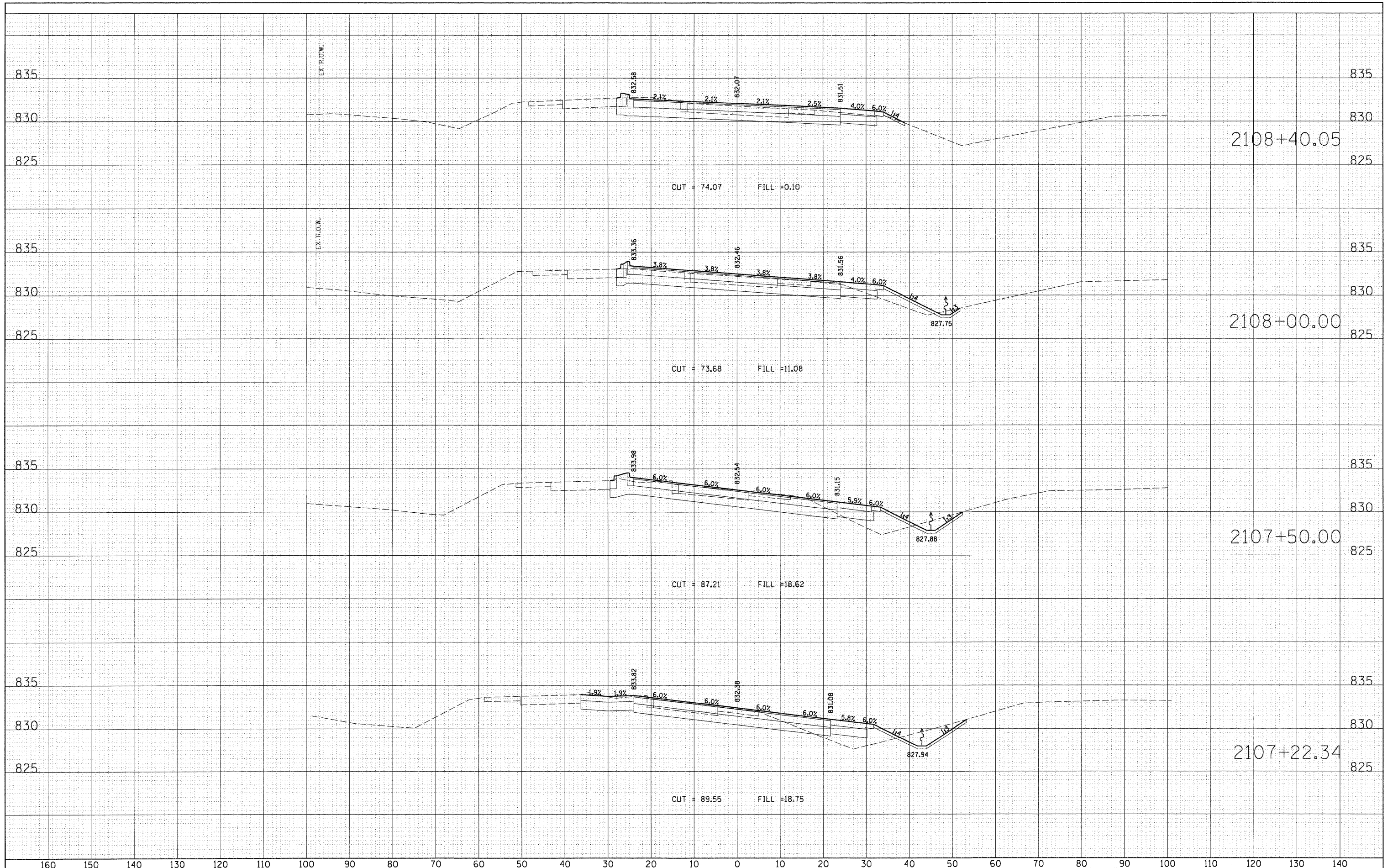

FILE NAME = D:\157207_SHT_XS_US20.DGN

USER NAME = molopez

PLOT SCALE = 1/8" = 1'

PLOT DATE = 10/24/2011

DESIGNED -

DRAWN -

CHECKED -

DATE -

REVISED -

REVISED -

REVISED -

REVISED -

STATE OF ILLINOIS
DEPARTMENT OF TRANSPORTATION

RANDALL ROAD AT US ROUTE 20 (FOOTHILL ROAD)
CROSS SECTION SHEET - RAMP US 20

SCALE: 1" = 10' SHEET NO. OF SHEETS STA. 2107+22.34 TO STA. 2108+40.05

F.A.P. R.T.E.	SECTION	COUNTY	TOTAL SHEETS	SHEET NO.
336	06-00345-00-CH	KANE	92	81
CONTRACT NO. 63623				
FED. ROAD DIST. NO. 1 ILLINOIS FED. AID PROJECT				