

INDEX OF SHEETS

1-20-2012 LETTING ITEM 026

1. TITLE SHEET
2. GENERAL NOTES, BENCHMARKS
3. SUMMARY OF QUANTITIES, HOT-MIX ASPHALT MIXTURE REQUIREMENTS, EARTH WORK TABLE
4. TYPICAL SECTIONS
5. PLAN AND PROFILE (STA 0+00 TO STA 5+00)
6. PLAN AND PROFILE (STA 5+00 TO STA 8+00)
7. PLAN AND PROFILE (STA 8+00 TO STA 9+68)
8. PLAN AND PROFILE (STA 110+00 TO STA 115+00)
9. PLAN AND PROFILE (STA 115+00 TO STA 118+00)
10. PLAN AND PROFILE (STA 118+00 TO STA 122+00)
11. PLAN AND PROFILE (STA 122+00 TO STA 125+00)
12. PLAN AND PROFILE (STA 125+00 TO STA 130+50)
13. PLAN AND PROFILE (STA 130+50 TO STA 135+00)
14. PLAN AND PROFILE (STA 135+00 TO STA 137+31)
15. EROSION CONTROL / SOD REPLACEMENT (STA 0+00 TO STA 9+68)
16. EROSION CONTROL / SOD REPLACEMENT (STA 110+00 TO STA 118+00)
17. EROSION CONTROL / SOD REPLACEMENT (STA 118+00 TO STA 125+00)
18. EROSION CONTROL / SOD REPLACEMENT (STA 125+00 TO STA 135+00)
19. EROSION CONTROL / SOD REPLACEMENT (STA 135+00 TO STA 137+31)
20. DETAILS
21. DETAILS
22. DISTRICT DETAILS
23. DISTRICT DETAILS
24. CROSS SECTIONS (STA 0+00 TO STA 9+68)
25. CROSS SECTIONS (STA 110+00 TO STA 122+00)
26. CROSS SECTIONS (STA 122+00 TO STA 137+31)

HIGHWAY STANDARDS

- 000001-06 STANDARD SYMBOLS, ABBREVIATION, & PATTERNS
- 424001-06 CURB RAMPS FOR SIDEWALKS
- 606001-04 CONCRETE CURB, COMBINATION CURB & GUTTER
- 701001-02 OFF-ROAD OPERATIONS, 2L, 2W, MORE THAN 15' AWAY
- 701006-03 OFF-ROAD OPERATIONS, 2L, 2W, 15' TO 24" FROM PAVEMENT EDGE
- 701301-04 LANE CLOSURES, 2L, 2W, SHORT TIME OPERATIONS
- 701501-06 URBAN LANE CLOSURE, 2L, 2W, UNDIVIDED
- 701801-05 SIDEWALK, CORNER AND CROSSWALK CLOSURE
- 701901-01 TRAFFIC CONTROL DEVICES
- 720001-01 SIGN PANEL MOUNTING DETAILS
- 720006-01 SIGN PANEL ERECTION DETAILS
- 720011-01 METAL PARTS FOR SIGNS
- 729001-01 APPLICATIONS OF TYPES A&B METAL POSTS

DISTRICT ONE DETAILS

- TC-10 TRAFFIC CONTROL AND PROTECTION FOR SIDE ROADS, INTERSECTIONS, AND DRIVEWAYS
- TC-13 DISTRICT ONE TYPICAL PAVEMENT MARKINGS

TRAFFIC DATA

ADT: BRADFORD DRIVE 400 ADT
 BROOKWOOD DRIVE <100 ADT

POSTED SPEED DESIGN SPEED

BRADFORD DRIVE/BROOKWOOD DRIVE 25 MPH 25 MPH
 BIKE PATH N/A MULTI-USE PATH 15 MPH (PROPOSED)

CLASSIFICATION

SHARED USE PATH

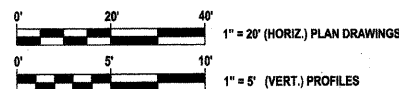

FULL SIZE PLANS HAVE BEEN PREPARED USING STANDARD ENGINEERING SCALES. REDUCED SIZED PLANS WILL NOT CONFORM TO STANDARD SCALES, IN MAKING MEASUREMENTS ON REDUCED PLANS US THE GRAPHIC SCALES ON DRAWINGS

J.U.L.I.E.
 JOINT UTILITY LOCATION INFORMATION FOR EXCAVATION
 1-800-892-0123

THE CONTRACTOR SHALL CONTACT THE OWNERS OF ALL UTILITIES 48 HOURS IN ADVANCE OF EXCAVATION. CALL J.U.L.I.E. ; 1-800-892-0123, AND ANY NON-MEMBER UTILITY OWNERS LISTED ON THE PLANS

PROJECT ENGINEER: BRIGET SCHWAB, P.E.
 PROJECT MANAGER: BRIGET SCHWAB, P.E.
 CONTRACT NO. 63624

STATE OF ILLINOIS
 DEPARTMENT OF TRANSPORTATION
 DIVISION OF HIGHWAYS

**PLANS FOR PROPOSED
 FEDERAL AID HIGHWAY
 McDONALD CREEK MULTI-USE PATH
 FROM WINDSOR DRIVE TO HINTZ ROAD
 PATH RECONSTRUCTION**

SECTION 10-00196-00-BT
 PROJECT: CMM-9003(818)
 VILLAGE OF ARLINGTON HEIGHTS
 WHEELING TOWNSHIP
 COOK COUNTY
 JOB NO. C-91-541-14

LOCATION MAP

N.T.S.
 TOWNSHIP 42 N RANGE 11 E WHEELING TOWNSHIP,
 3rd PRINCIPLE MERIDIAN

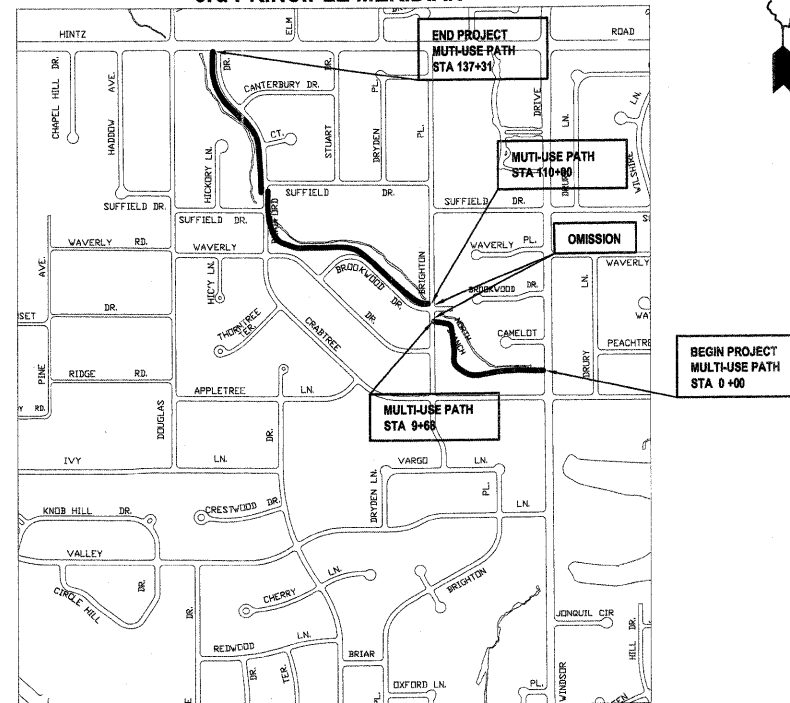

PROJECT LENGTH
 3699 FT (0.70 MI) NET & GROSS

F.A.P. RTE.	SECTION	COUNTY	TOTAL SHEETS	SHEET NO.
	10-00196-00-BT	COOK	26	1
FED. ROAD DIST. NO.		ILLINOIS	CONTRACT NO. 63624	

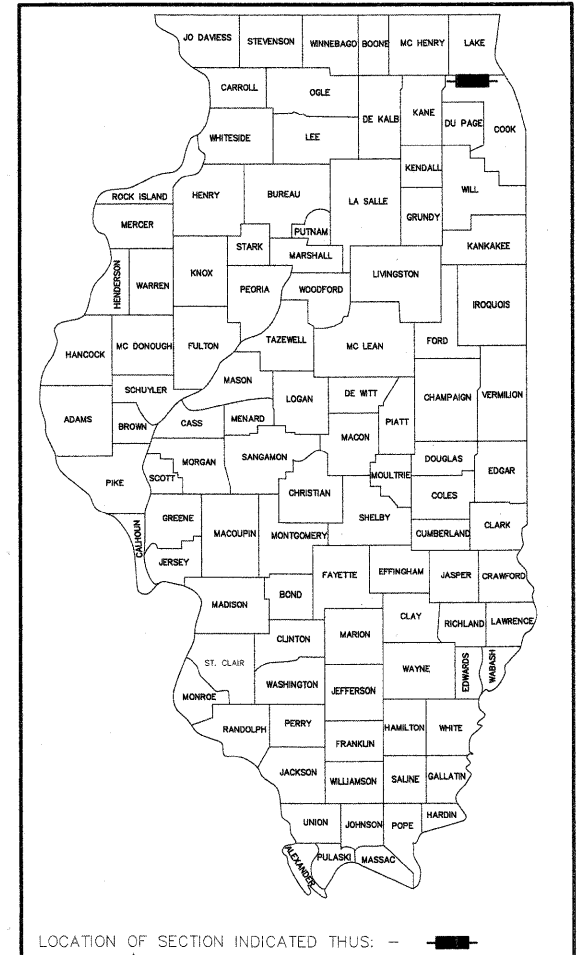

STATE OF ILLINOIS
 DEPARTMENT OF TRANSPORTATION
 DIVISION OF HIGHWAYS

APPROVED OCTOBER 25, 2011
James J. Massarelli
 VILLAGE OF ARLINGTON HEIGHTS

PASSED NOVEMBER 9, 2011
Cheryl A. Chesapeake Hart
 DISTRICT ONE ENGINEER OF LOCAL ROADS AND STREETS

RELEASING FOR BID
 BASED ON LIMITED REVIEW NOVEMBER 4, 2011
Diana M. O'Keefe
 DEPUTY DIRECTOR OF HIGHWAYS, REGION ONE ENGINEER

PROFESSIONAL ENGINEER'S SIGN & SEAL
James J. Massarelli
 JAMES J. MASSARELLI, P.E.
 REGISTERED PROFESSIONAL ENGINEER OF ILLINOIS
 LICENSES EXPIRES 11/30/2013

**PRINTED BY THE AUTHORITY
 OF THE STATE OF ILLINOIS**

PROGRAM AND OFFICE ENGINEER: CHARLES F. RIDDLE, P.E. 847-705-4406 SCHAUMBURG, IL.
 T:\Bicycle Advisory Commission\CMAQ\FY-2010\McDonald Creek\MultiUsePath_title_IDOT_sh2011-McDonaldCreekPH1.dwg
 Oct 24, 2011 - 2:47pm

SUMMARY OF QUANTITIES

CODE NO.	ITEM	UNIT	TOTAL QUANTITY	CONSTRUCTION CODE	
				80% FED 20% LOCAL	BIKE PATH 0028 URBAN
20101200	TREE ROOT PRUNING	EACH	20		20
20101700	SUPPLEMENTAL WATERING	UNIT	2		2
20200100	EARTH EXCAVATION	CU YD	170		170
20201200	REMOVAL AND DISPOSAL OF UNSUITABLE MATERIAL	CU YD	170		170
21101600	TOPSOIL FURNISH AND PLACE, VARIABLE DEPTH	SQ YD	3225		3225
25000400	NITROGEN FERTILIZER NUTRIENT	POUND	40		40
25000500	PHOSPHORUS FERTILIZER NUTRIENT	POUND	40		40
25000600	POTASSIUM FERTILIZER NUTRIENT	POUND	40		40
25200100	SODDING	SQ YD	3225		3225
28000400	PERIMTER EROSION BARRIER	FOOT	2890		2890
28000510	INLET FILTERS	EACH	5		5
31101180	SUBBASE GRANULAR MATERIAL, TYPE B 2"	SQ YD	110		110
31101200	SUBBASE GRANULAR MATERIAL, TYPE B 4"	SQ YD	230		230
31101400	SUBBASE GRANULAR MATERIAL, TYPE B 6"	SQ YD	3270		3270
40600100	BITUMINOUS MATERIALS (PRIME COAT)	GALLON	345		345
40603080	HOT-MIX ASPHALT BINDER COURSE, IL-19.0, N50	TON	75		75
40603335	HOT-MIX ASPHALT SURFACE COURSE, MIX "D", N50	TON	580		580
42400200	PORTLAND CEMENT CONCRETE SIDEWALK 5 INCH	SQ FT	1000		1000
42400800	DETECTABLE WARNINGS	SQ FT	24		24
44000100	PAVEMENT REMOVAL	SQ YD	3450		3450
44000500	COMBINATION CURB AND GUTTER REMOVAL	FOOT	830		830
44000600	SIDEWALK REMOVAL	SQ FT	1000		1000
60300105	FRAMES AND GRATES TO BE ADJUSTED	EACH	3		3
X6061610	COMBINATION CONCRETE CURB AND GUTTER, TYPE B (MODIFIED)	FOOT	830		830
67100100	MOBILIZATION	L SUM	1		1
70102620	TRAFFIC CONTROL AND PROTECTION, STANDARD 701501	L SUM	1		1
70102640	TRAFFIC CONTROL AND PROTECTION, STANDARD 701801	L SUM	1		1
72000100	SIGN PANEL - TYPE 1	SQ FT	28		28
72900100	METAL POST - TYPE A	FOOT	80		80
78000200	THERMOPLASTIC PAVEMENT MARKING - LINE 4"	FOOT	3700		3700
78000600	THERMOPLASTIC PAVEMENT MARKING - LINE 12"	FOOT	300		180
Z0013302	SEGMENTAL CONCRETE BLOCK WALL	SQ FT	180		180
Z0022800	FENCE REMOVAL	FOOT	440		440
X6320100	GUARDRAIL REMOVAL SPECIAL	FOOT	425		425
XX001249	ORNAMENTAL FENCE	FOOT	300		300
XX004101	ORNAMENTAL METAL FENCE	FOOT	160		160
XX006653	FENCE (SPECIAL)	FOOT	425		425
XZ127900	RETAINING WALL REMOVAL	FOOT	160		160

* INDICATES SPECIALTY ITEM

HOT-MIX ASPHALT MIXTURE REQUIREMENTS

MIXTURE TYPE	AIR VOIDS
ROADWAYS	
HOT-MIX ASPHALT BINDER COURSE, IL-19.0, N50, 7 1/4" (IN TWO LIFTS)	4% @ 50 GYR
HOT-MIX ASPHALT SURFACE COUSE, MIX "D", N50 (IL 9.5 mm); 2"	4% @ 50 GYR
BIKE PATH	
HOT-MIX ASPHALT SURFACE COUSE, MIX "D", N50 (IL 9.5 mm); 3"	4% @ 50 GYR
UNIT WEIGHT USED TO CALCULATE ALL HMA SURFACE MIXTURE QUANTITIES IS 112 LB/SY*IN.	
THE "AC TYPE" FOR POLYMERIZED HMA MIXES SHALL BE "SBR/SBR PG 70-22" AND FOR NON-POLYMERIZED HMA, THE "AC TYPE" SHALL E "PG 64-22" UNLESS MODIFIED BY DISTRICT ONE SPECIAL PROVISIONS.	

EARTHWORK SUMMARY TABLE

LOCATION	EARTH EXCAVATION (CU YD)	REMOVAL & DISPOSAL OF UNSUITABLE MATERIAL* (CU YD)
STA 0+00 TO STA 9+88	50	50
STA 110+00 TO 123+00	65	65
STA 126+70 TO STA 137+31	55	55
TOTAL QUANTITY =	170	170

* REMOVAL & DISPOSAL OF UNSUITABLE MATERIAL IS AN ESTIMATED QUANTITY TO ESTABLISH A CONTRACT UNIT PRICE. ACTUAL QUANTITY WILL BE DETERMINED IN THE FIELD BY THE ENGINEER. ONLY ACTUAL QUANTITY REMOVED WILL BE PAID FOR.

DATE	BY
DATE	BY
DATE	BY
DATE	BY

DATE	BY
DATE	BY
DATE	BY
DATE	BY

T:\Bicycle Advisory Commission\CAD\01-2010\McDonald Creek

FILE NAME = scheduleQuan.dwg	USER NAME = chomuth	DESIGNED - BS	REVISED -	STATE OF ILLINOIS DEPARTMENT OF TRANSPORTATION	MC DONALD CREEK MULTI USE PATH SUMMARY OF QUANTITIES, HMA MIXTURE REQUIREMENTS, EARTHWORK TABLE			F.A. RTE.	SECTION	COUNTY	TOTAL SHEETS	SHEET NO.
	VIEWPORT NAME = SCHEDULEQUAN	DRAWN - CH	REVISED -		SCALE: N.T.S.	SHEET NO.	OF	SHEETS	10-00196-00-BT	COOK	26	3
	PLOT SCALE = 1" / IN.	CHECKED - JM	REVISED -							CONTRACT NO. 63624		
	PLOT DATE = Nov 02, 2011 - 6:14am	DATE - 04/12/2011	REVISED -							FED ROAD DIST NO. 1 ILLINOIS FED. AID PROJECT		

DATE	
BY	
REVISIONS	
NOTED	
CHECKED	
BY	
DATE	
PLAN	
NOTE BOOK	
NO.	
STRUCTURE	NOTATNS CHRD

DATE	
BY	
REVISIONS	
NOTED	
CHECKED	
BY	
DATE	
PROFILE	
NOTE BOOK	
NO.	
STRUCTURE	NOTATNS CHRD

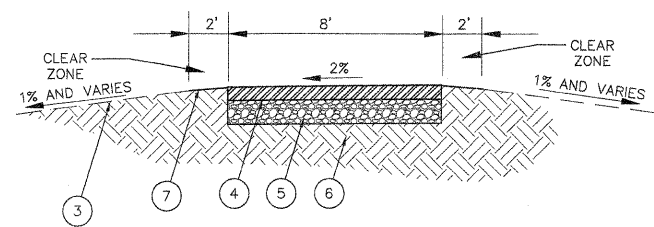

- 1 EXISTING PAVEMENT
- 2 EXISTING CURB AND GUTTER
- 3 EXISTING GROUND
- 4 PROPOSED HMA SURFACE COURSE, N50, 3"
- 5 PROPOSED SUBBASE GRANULAR MATERIAL, TY B, 6"
- 6 EXISTING SUBGRADE
- 7 PROPOSED TOPSOIL AND SOD

TYPICAL SECTION 1
STA 0+00 TO STA 9+68

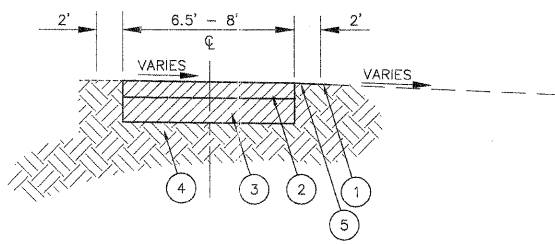

- 1 EXISTING GROUND
 - 2 EXISTING 2 1/2" HMA BIKE PATH
 - 3 EXISTING 4" SUBBASE TY B
 - 4 EXISTING SUBGRADE
 - 5 EXISTING GROUND
- ITEM TO BE REMOVED

EXISTING TYPICAL SECTION

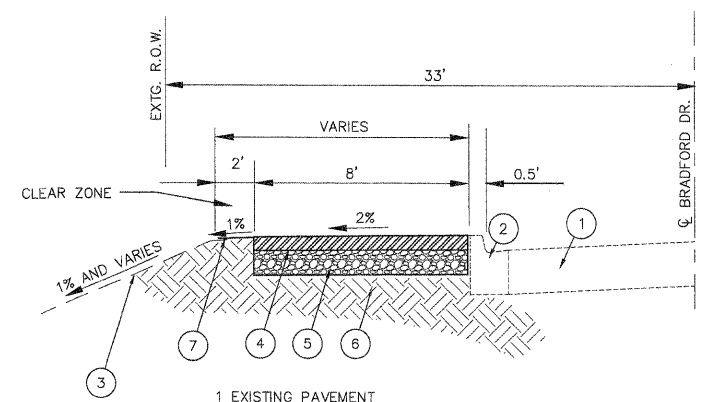

- 1 EXISTING PAVEMENT
- 2 EXISTING CURB AND GUTTER
- 3 EXISTING GROUND
- 4 PROPOSED HMA SURFACE COURSE, N50, 3"
- 5 PROPOSED SUBBASE GRANULAR MATERIAL, TY B, 6"
- 6 EXISTING SUBGRADE
- 7 PROPOSED TOPSOIL AND SOD

TYPICAL SECTION 6
STA 127+40 TO STA 128+65
STA 133+05 TO STA 134+00

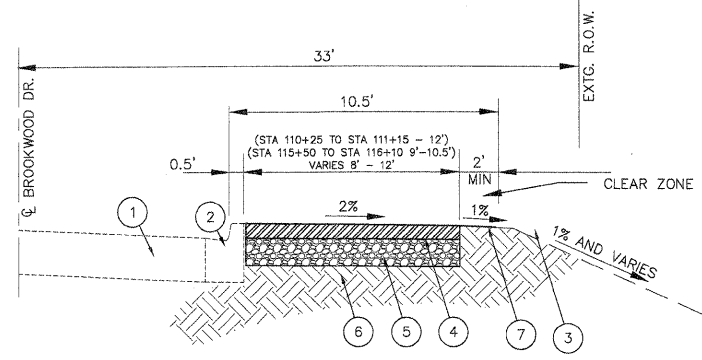

- 1 EXISTING PAVEMENT
- 2 EXISTING CURB AND GUTTER
- 3 EXISTING GROUND
- 4 PROPOSED HMA SURFACE COURSE, N50, 3"
- 5 PROPOSED SUBBASE GRANULAR MATERIAL, TY B, 6"
- 6 EXISTING SUBGRADE
- 7 PROPOSED TOPSOIL AND SOD

TYPICAL SECTION 2
STA 110+00 TO STA 111+60
STA 115+50 TO STA 116+08

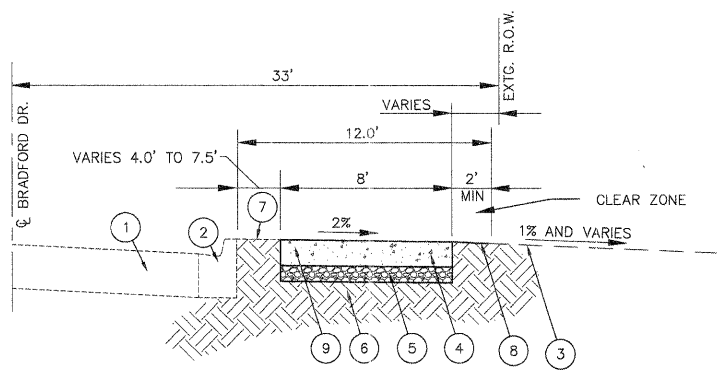

- 1 EXISTING PAVEMENT
- 2 EXISTING CURB AND GUTTER
- 3 EXISTING GROUND
- 4 EXISTING P.C.C. SIDEWALK
- 5 EXISTING STONE BASE
- 6 EXISTING SUBGRADE
- 7 EXISTING PARKWAY
- 8 PROPOSED TOPSOIL AND SOD
- 9 INTERMITTENT SIDEWALK PANEL REMOVE & REPLACE

TYPICAL SECTION 4
STA 123+00 TO STA 126+30

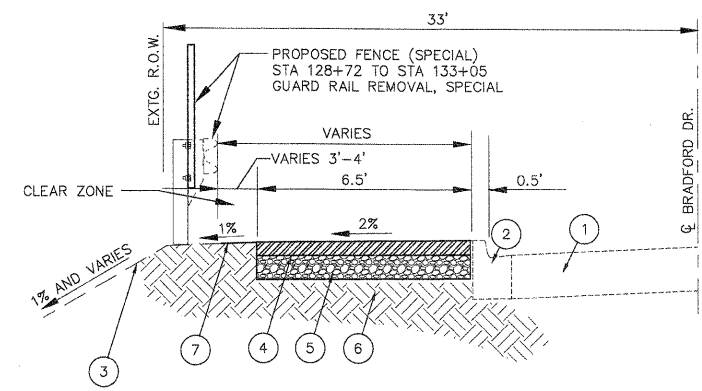

- 1 EXISTING PAVEMENT
- 2 EXISTING CURB AND GUTTER
- 3 EXISTING GROUND
- 4 PROPOSED HMA SURFACE COURSE, N50, 3"
- 5 PROPOSED SUBBASE GRANULAR MATERIAL, TY B, 6"
- 6 EXISTING SUBGRADE
- 7 PROPOSED TOPSOIL AND SOD

TYPICAL SECTION 7
STA 128+65 TO STA 133+05

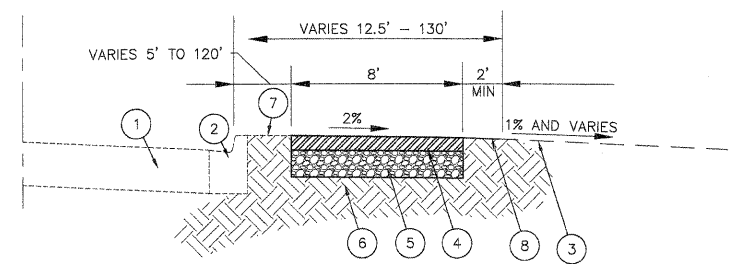

- 1 EXISTING PAVEMENT
- 2 EXISTING CURB AND GUTTER
- 3 EXISTING GROUND
- 4 PROPOSED HMA SURFACE COURSE, N50, 3"
- 5 PROPOSED SUBBASE GRANULAR MATERIAL, TY B, 6"
- 6 EXISTING SUBGRADE
- 7 EXISTING PARKWAY
- 8 PROPOSED TOPSOIL AND SOD

TYPICAL SECTION 3
STA 111+60 TO STA 115+00
STA 116+08 TO STA 123+00

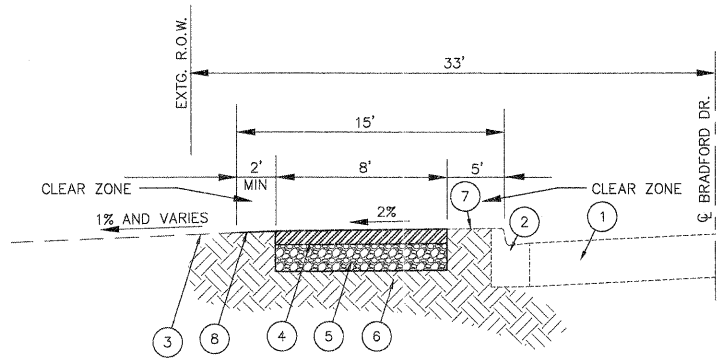

- 1 EXISTING PAVEMENT
- 2 EXISTING CURB AND GUTTER
- 3 EXISTING GROUND
- 4 PROPOSED HMA SURFACE COURSE, N50, 3"
- 5 PROPOSED SUBBASE GRANULAR MATERIAL, TY B, 6"
- 6 EXISTING SUBGRADE
- 7 EXISTING PARKWAY
- 8 PROPOSED TOPSOIL AND SOD

TYPICAL SECTION 5
STA 126+75 TO STA 127+40
STA 134+00 TO STA 137+33

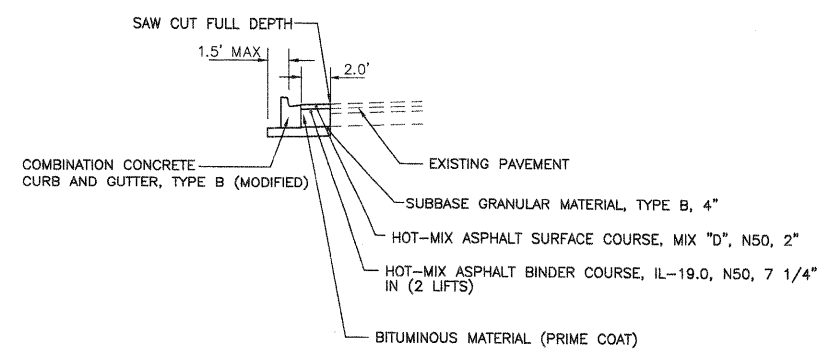

- 1 EXISTING PAVEMENT
- 2 EXISTING CURB AND GUTTER, TYPE B (MODIFIED)
- 3 EXISTING GROUND
- 4 PROPOSED HMA SURFACE COURSE, N50, 3"
- 5 PROPOSED SUBBASE GRANULAR MATERIAL, TY B, 6"
- 6 EXISTING SUBGRADE
- 7 EXISTING PARKWAY
- 8 PROPOSED TOPSOIL AND SOD

PROPOSED TYPICAL SECTION
BRADFORD DRIVE

T:\Boggs\Advisory Commission\CMO\FY-2010\McDonald Creek\

FILE NAME =	USER NAME = chomuth	DESIGNED - BS	REVISED -	STATE OF ILLINOIS DEPARTMENT OF TRANSPORTATION	MC DONALD CREEK MULTI USE PATH TYPICAL SECTIONS	F.A.R.T.E.	SECTION	COUNTY	TOTAL SHEETS	SHEET NO.
McDonald-Multi-Path-Detail.dwg	VIEWPORT NAME = TYPICALSECTIONS	DRAWN - CH	REVISED -			10-00196-00-BT	COOK	26	4	
PLOT SCALE = 1" / IN.	CHECKED - JM	REVISED -				CONTRACT NO. 63624				
PLOT DATE = Nov 01, 2011 - 3:12pm	DATE - 04/12/2011	REVISED -				FED ROAD DIST NO. 1 ILLINOIS FED. AID PROJECT				



PLAN
 SURVEYED BY: N. WINDSOR DRIVE
 DATE: _____
 CHECKED BY: _____
 GRADES CHECKED BY: _____
 DATE: _____

PROFILE
 SURVEYED BY: _____
 DATE: _____
 CHECKED BY: _____
 GRADES CHECKED BY: _____
 DATE: _____

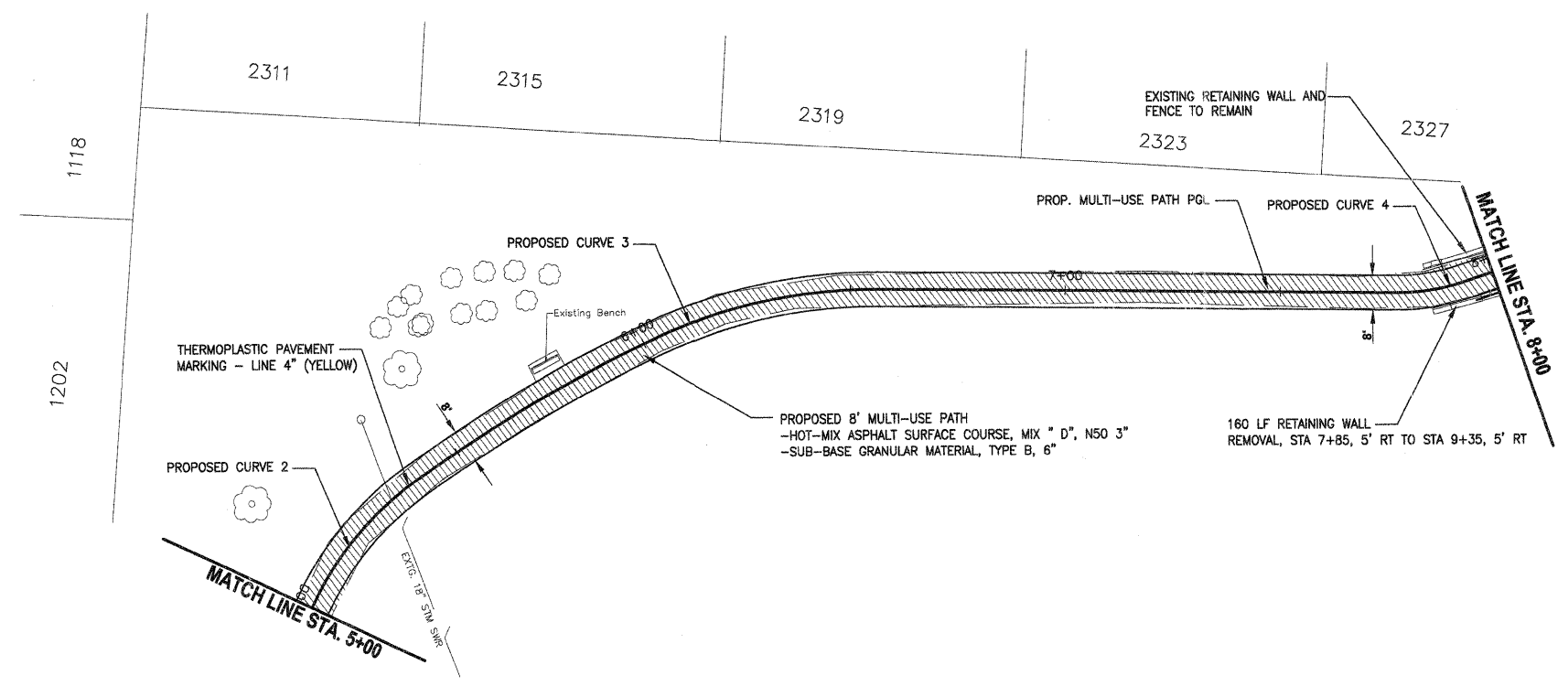

PROPOSED CURVE 2
 R=76.0000
 L=45.3869
 D=34d
 T=23.3929
 C=44.7154
 B of C=N 48' W

PROPOSED CURVE 3
 R=120.00
 L=50.4454
 D=24d
 T=25.6008
 C=50.0748
 B of C=N 4' W

PROPOSED CURVE 4
 R=46.00
 L=14.7405
 D=18d
 T=7.4340
 C=14.6775
 B of C=N 2' W

NOTES:
 EXISTING BRUSH AND GARDEN MATERIALS IN CONFLICT WITH PROPOSED IMPROVEMENTS SHALL BE REMOVED OR RELOCATED AS DETERMINED BY THE ENGINEER AND INCLUDED IN THE COST OF EARTH EXCAVATION

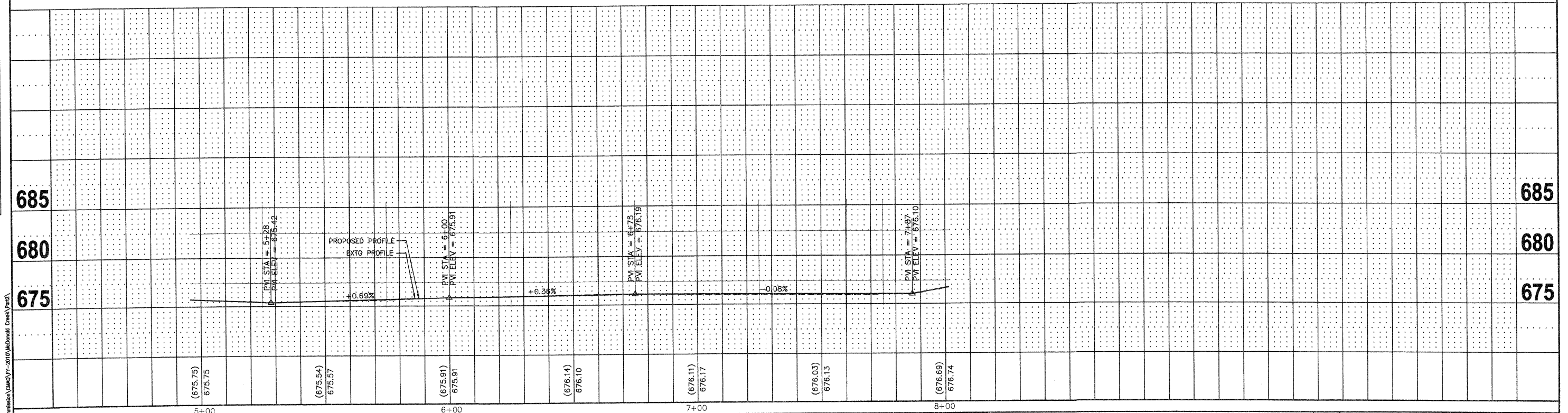

FILE NAME =	USER NAME = chomuth	DESIGNED - BS	REVISED -	STATE OF ILLINOIS DEPARTMENT OF TRANSPORTATION	MC DONALD CREEK MULTI USE PATH PLAN AND PROFILE			F.A. RTE.	SECTION	COUNTY	TOTAL SHEETS	SHEET NO.	
McDonaldCreekPort2BikePath.dwg	VIEWPORT NAME = Layout2	DRAWN - CH	REVISED -		HORIZ. 1"=20'			10-00196-00-BT	COOK	26	6		
	PLOT SCALE = 20.00' / IN.	CHECKED - JM	REVISED -		SCALE: VERT. 1"=5'			SHEET NO. OF SHEETS		STA. 5+00 TO STA. 8+00		CONTRACT NO. 63624	
	PLOT DATE = Nov 02, 2011 - 6:19am	DATE - 04/12/2011	REVISED -		FED. ROAD DIST. NO. 1 ILLINOIS FED. AID PROJECT								

PLAN	DATE
BY	
CHECKED	
NO.	

PROFILE	DATE
BY	
CHECKED	
NO.	

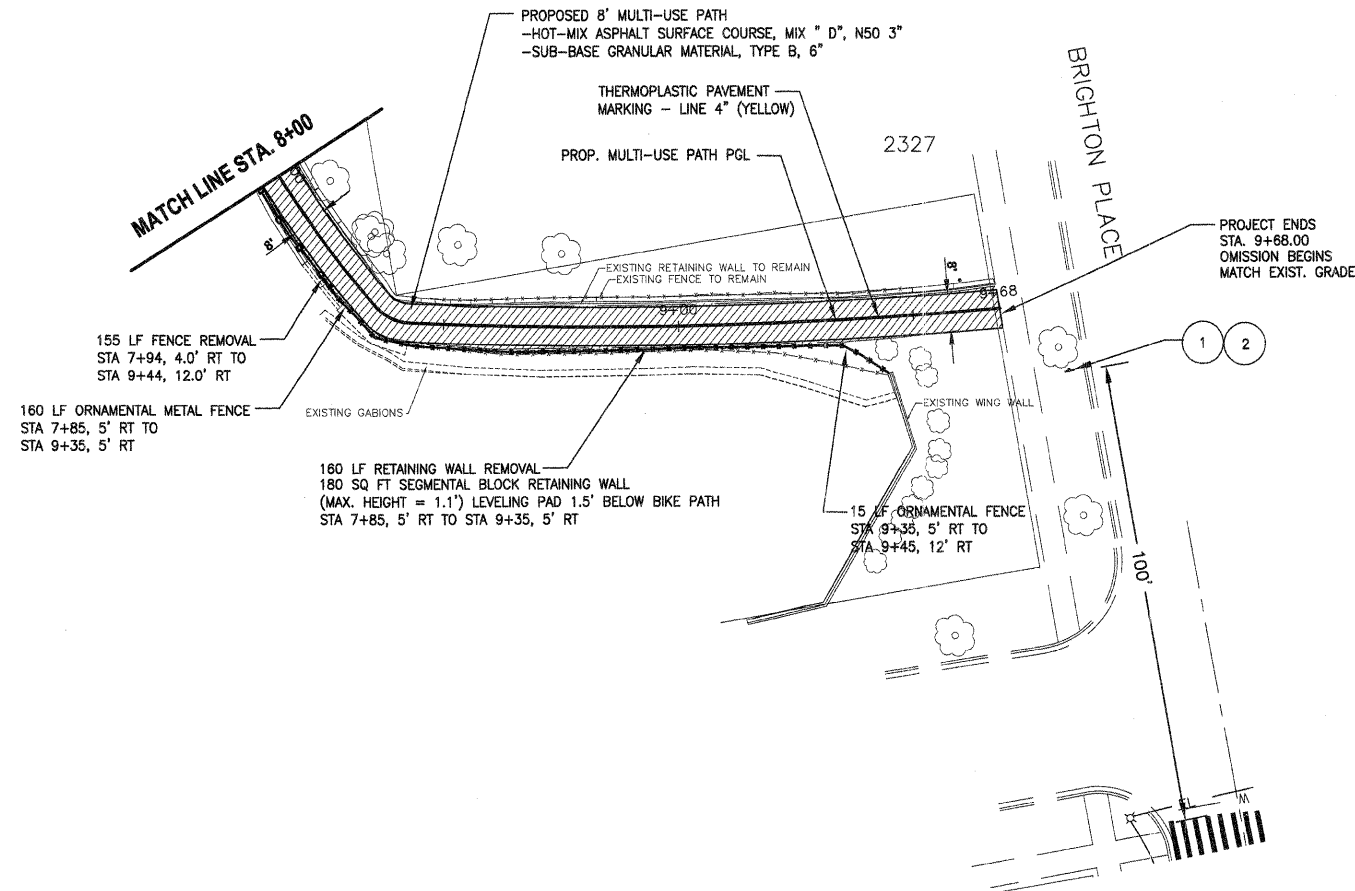

PROPOSED CURVE 5
 R=235.00
 L=42.4672
 D=10d
 T=21.2916
 C=42.4094
 B of C=S 16' E

PROPOSED CURVE 6
 R=9.70
 L=7.8372
 D=46d
 T=4.1467
 C=7.6257
 B of C=S 44' E

PROPOSED CURVE 7
 R=913.57
 L=128.2849
 D=8d
 T=64.2481
 C=128.1795
 B of C=S 71' E

SIGN LEGEND

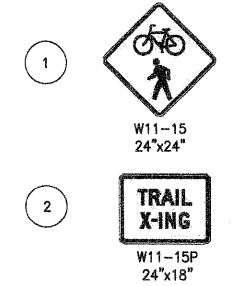

NOTES:
 EXISTING BRUSH AND GARDEN MATERIALS IN CONFLICT WITH PROPOSED IMPROVEMENTS SHALL BE REMOVED AN OR RELOCATED AS DETERMINED BY THE ENGINEER AND INCLUDED IN THE COST OF EARTH EXCAVATION

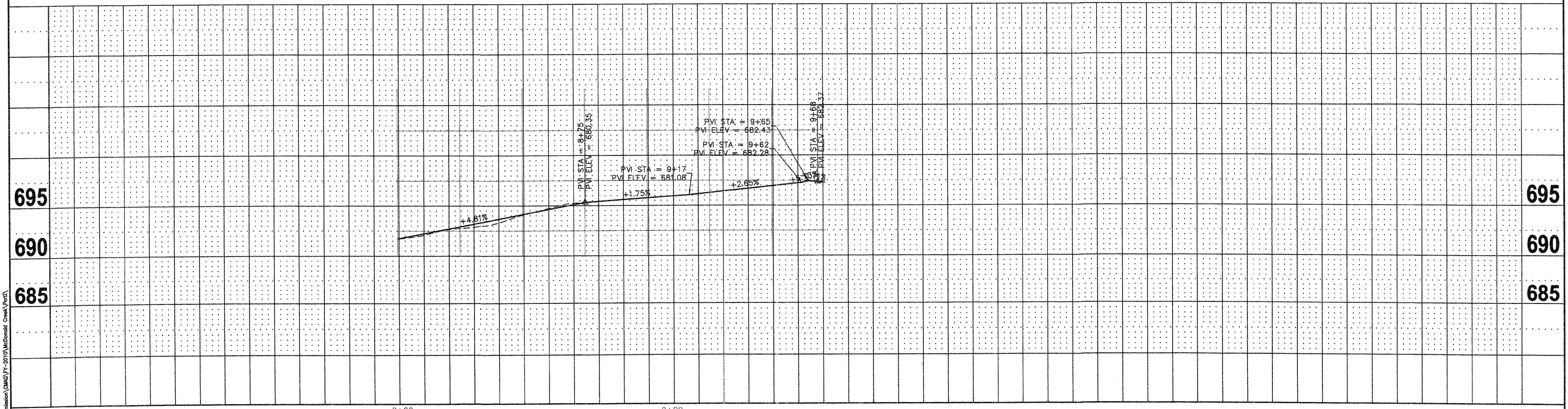

FILE NAME = McDonaldCreekPar2BikePath.dwg	USER NAME = chomuth	DESIGNED - BS	REVISED -	STATE OF ILLINOIS DEPARTMENT OF TRANSPORTATION	MC DONALD CREEK MULTI USE PATH PLAN AND PROFILE			F.A. RTE.	SECTION	COUNTY	TOTAL SHEETS	SHEET NO.
	VIEWPORT NAME = Layout3	DRAWN - CH	REVISED -		HORIZ. 1"=20'	10-00196-00-BT	COOK	26	7			
	PLOT SCALE = 20.00' / IN.	CHECKED - JM	REVISED -		SCALE: VERT. 1"=5'	SHEET NO. OF SHEETS	STA. 8+00 TO STA. 9+68	CONTRACT NO. 63624				
	PLOT DATE = Nov 02, 2011 - 6:19am	DATE - 04/12/2011	REVISED -		FED ROAD DIST NO. 1 (ILLINOIS) FED. AID PROJECT							

T:\Regis Library Commission\CMAS\JF-2010\McDonald Creek\Profile



CURVE 16
 R=27.70
 L=25.39
 D=52d30'59.4"
 T=13.67
 C=24.51
 B of C=N 13'02'38.1" W

CURVE 17
 R=421.75
 L=199.37
 D=27d5'6.1"
 T=101.58
 C=197.52
 B of C=N 6'12'56.3" W

DATE	
BY	
PLAN	
DESIGNED	
DRAWN	
CHECKED	
NO.	
STRUCTURE NOTATIONS CHFD	

DATE	
BY	
PROFILE	
DESIGNED	
DRAWN	
CHECKED	
NO.	
STRUCTURE NOTATIONS CHFD	

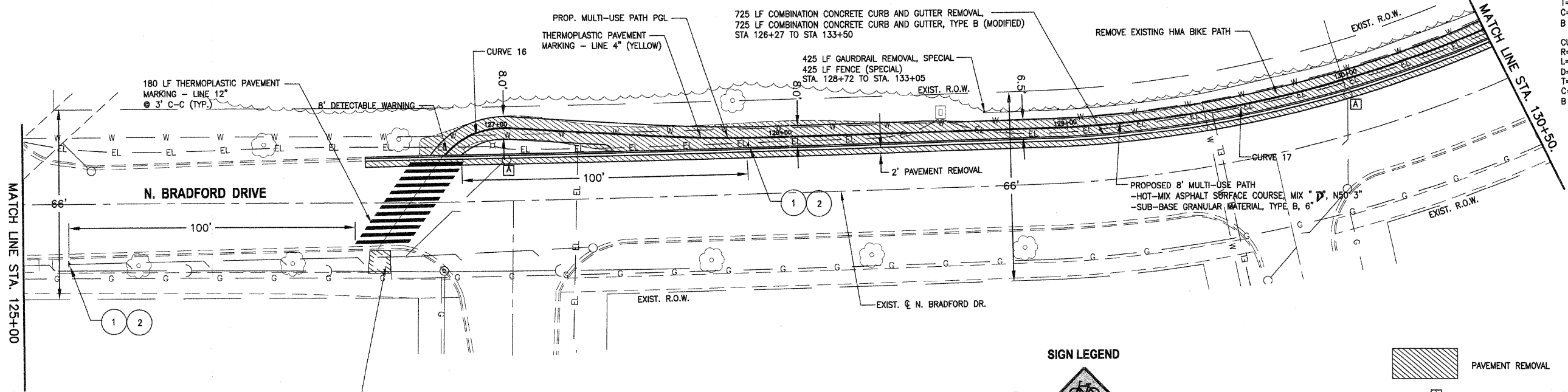

8 S.F. DETECTABLE WARNING
 100 S.F. SIDEWALK REMOVAL
 100 S.F. 5" PCC SIDEWALK REPLACEMENT

SIGN LEGEND

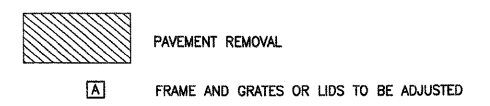
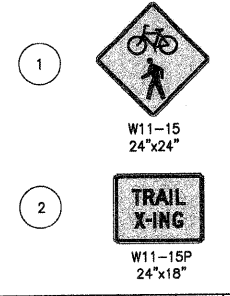

NOTES:
 EXISTING BRUSH AND GARDEN MATERIALS IN CONFLICT WITH PROPOSED IMPROVEMENTS SHALL BE REMOVED AND OR RELOCATED AS DETERMINED BY THE ENGINEER AND INCLUDED IN THE COST OF EARTH EXCAVATION

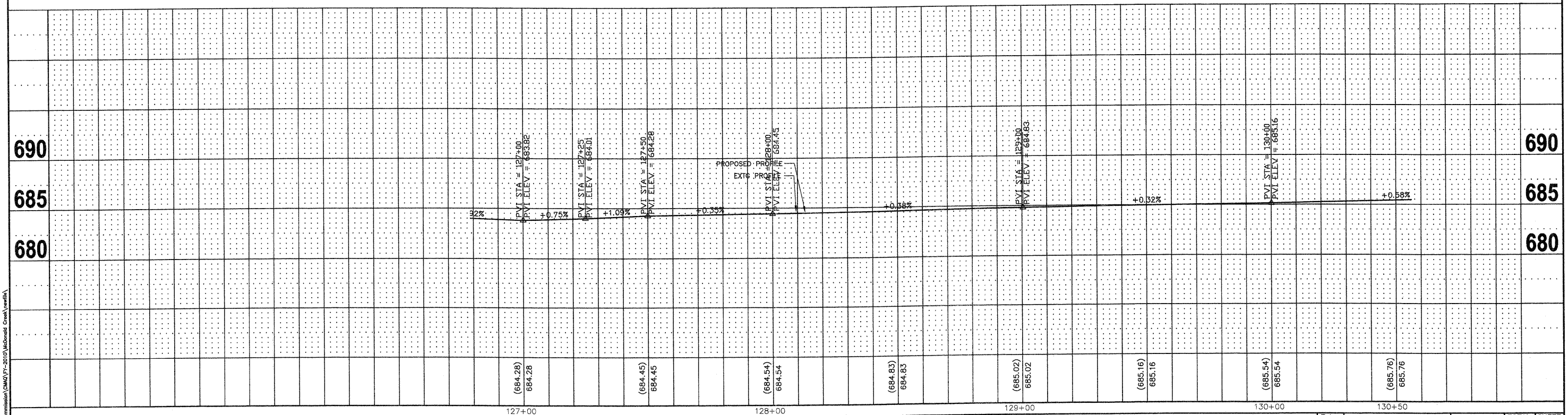

FILE NAME = 3d-phase1McDonald.dwg	USER NAME = chomuth	DESIGNED - BS	REVISED -	STATE OF ILLINOIS DEPARTMENT OF TRANSPORTATION	MC DONALD CREEK MULTI USE PATH PLAN AND PROFILE			F.A. RTE.	SECTION	COUNTY	TOTAL SHEETS	SHEET NO.
	LAYOUT NAME = 125+00-130+50	DRAWN - CH	REVISED -		HORIZ. 1"=20'				10-00196-00-BT	COOK	26	12
	PLOT SCALE = 20.00' / IN.	CHECKED - JM	REVISED -		SCALE: VERT. 1"=5'			SHEET NO.	OF SHEETS	STA. 125+00 TO STA. 130+50	CONTRACT NO. 63624	
	PLOT DATE = Oct 24, 2011 - 4:46pm	DATE - 04/12/2011	REVISED -		FED ROAD DIST NO. 1 ILLINOIS FED. AID PROJECT							

DATE	
BY	
DESIGNED	
DRAWN	
CHECKED	
NO.	

DATE	
BY	
DESIGNED	
DRAWN	
CHECKED	
NO.	

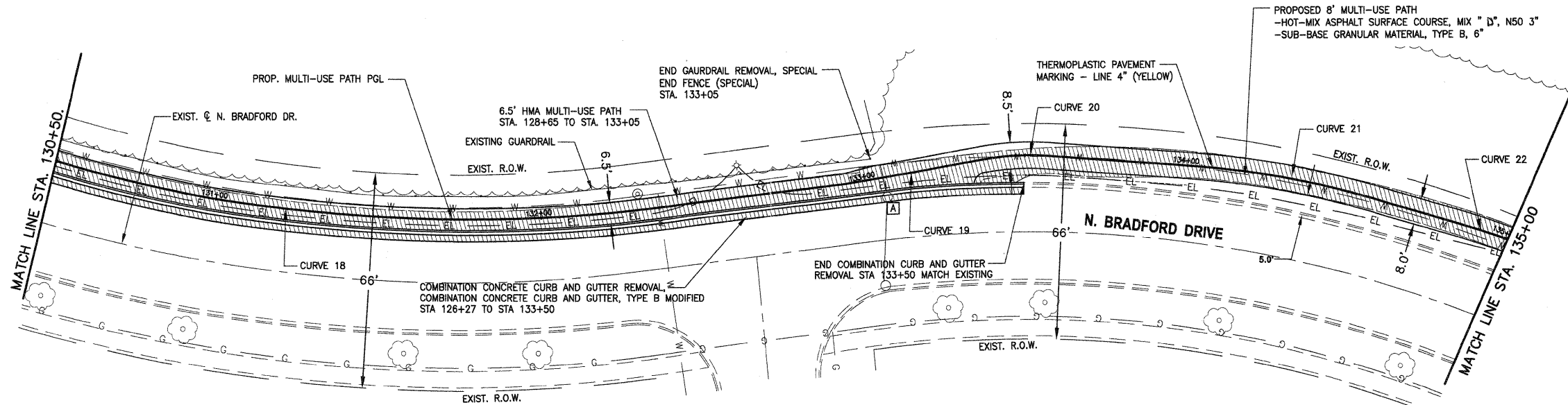

CURVE 18
 R=484.46
 L=149.74
 D=17d42'32.1"
 T=75.47
 C=149.14
 B of C=S 29'32'38.3" E

CURVE 19
 Radius=3035.82
 Length=42.41
 Delta=0d48'1.3"
 Tangent=21.20
 Chord=42.41
 B of C=S 39'46'11.7" E

CURVE 20
 R=79.30
 L=20.06
 D=14d29'25.0"
 T=10.08
 C=20.00
 B of C=N 32'55'29.8" W

CURVE 21
 R=276.57
 L=63.51
 D=13d9'28.2"
 T=31.90
 C=63.37
 B of C=N 19'06'03.2" W

CURVE 22
 R=337.15
 L=117.98
 D=20d3'1.2"
 T=59.60
 C=117.38
 B of C=N 3'27'35.4" W

- PAVEMENT REMOVAL
- FRAME AND GRATES OR LIDS TO BE ADJUSTED

NOTES:
 EXISTING BRUSH AND GARDEN MATERIALS IN CONFLICT WITH PROPOSED IMPROVEMENTS SHALL BE REMOVED AND OR RELOCATED AS DETERMINED BY THE ENGINEER AND INCLUDED IN THE COST OF EARTH EXCAVATION

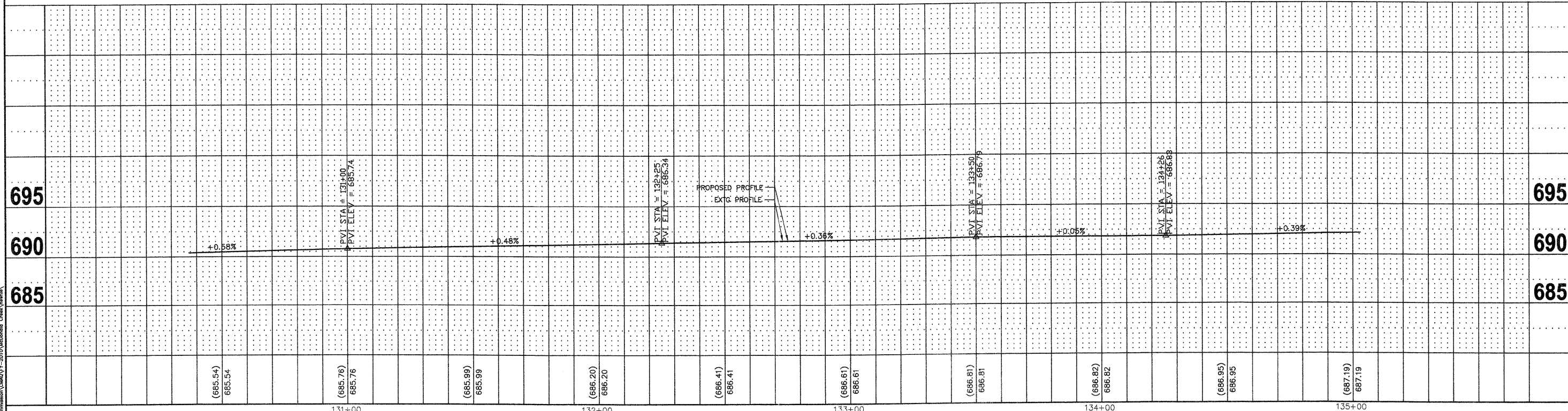

FILE NAME = 3d-phase1McDonald.dwg	USER NAME = chomuth	DESIGNED - BS	REVISED -	STATE OF ILLINOIS DEPARTMENT OF TRANSPORTATION	MC DONALD CREEK MULTI USE PATH PLAN AND PROFILE			F.A.R.T.E.	SECTION	COUNTY	TOTAL SHEETS	SHEET NO.
	LAYOUT NAME = 130+50-135+00	DRAWN - CH	REVISED -		HORIZ. 1"=20'			10-00196-00-BT	COOK	26	13	
	PLOT SCALE = 20.00' / IN.	CHECKED - JM	REVISED -		SCALE: VERT. 1"=5'			SHEET NO. OF SHEETS STA. 130+50 TO STA. 135+00			CONTRACT NO. 63624	
	PLOT DATE = Oct 24, 2011 - 4:31pm	DATE - 04/12/2011	REVISED -		FED ROAD DIST NO. 1 ILLINOIS FED. AID PROJECT							



PLAN	SURVEYED	DATE
	NOTED	
	GRADES CHECKED	
	BY	
	NO. _____	
	STRUCTURE NOTATIONS CHKD	

PROFILE	SURVEYED	DATE
	NOTED	
	GRADES CHECKED	
	BY	
	NO. _____	
	STRUCTURE NOTATIONS CHKD	

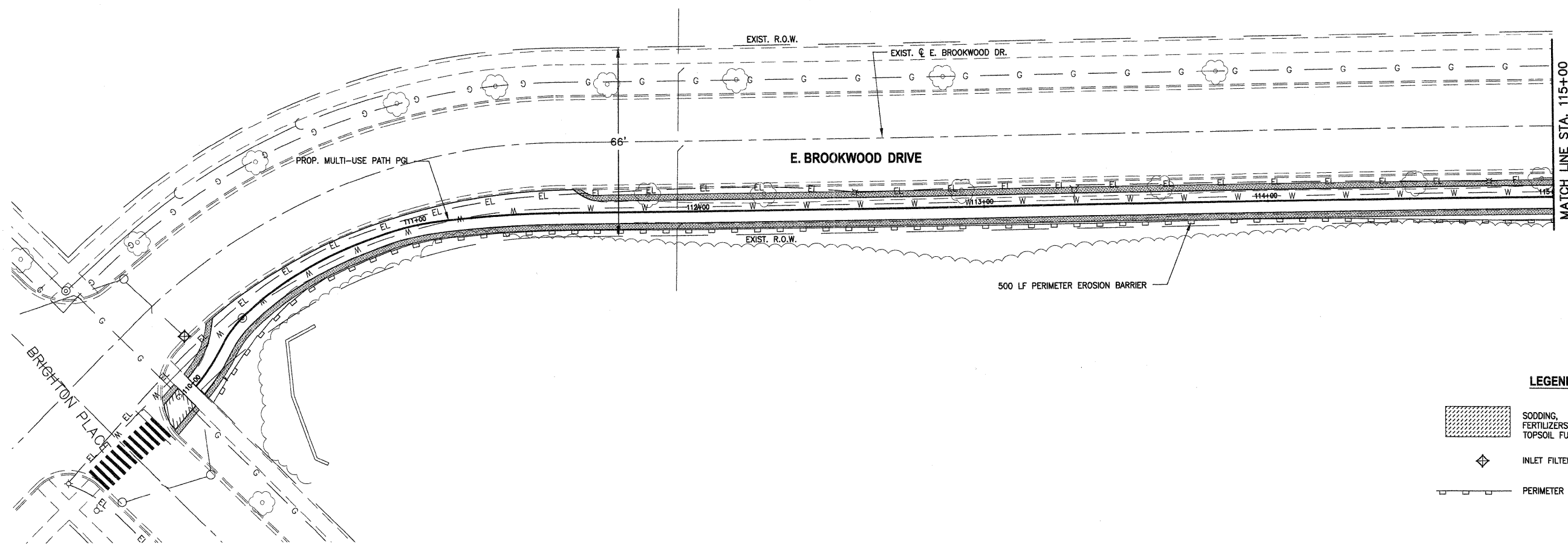
I:\Eng\Arling Commission\10403\FY-2010\McDonald Creek\mcdonk.dwg



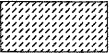

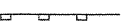
LEGEND

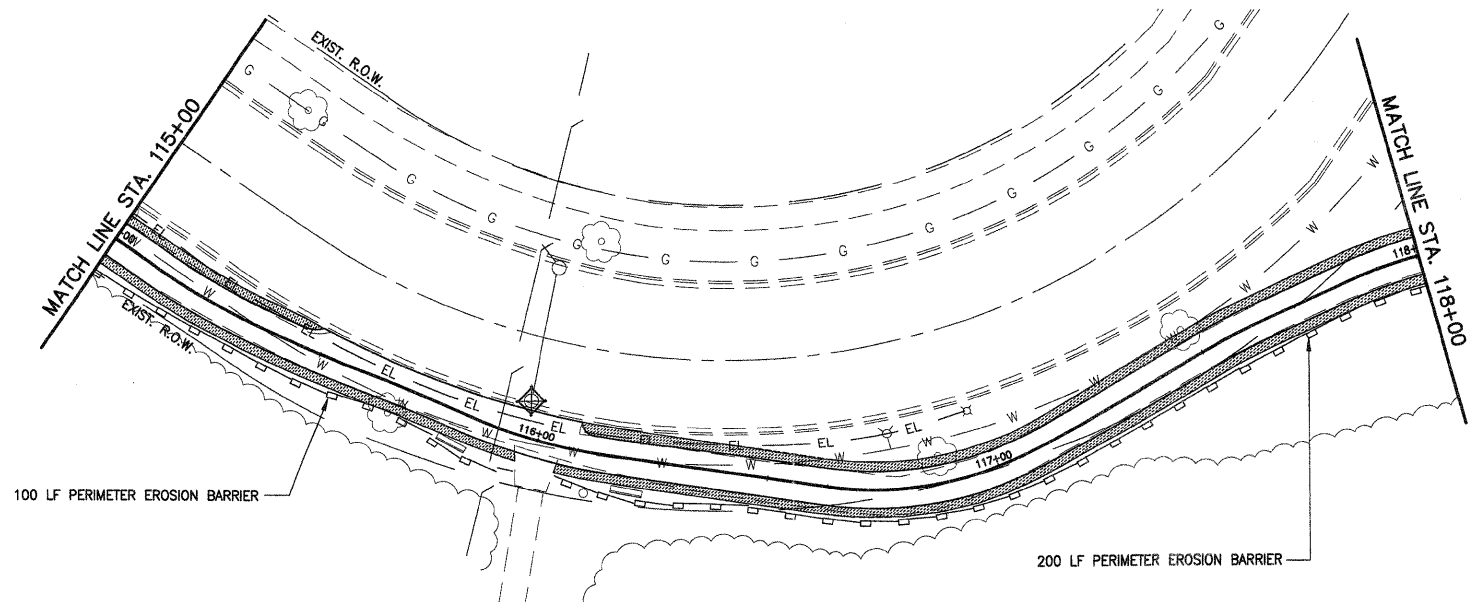
-  SODDING, FERTILIZERS, TOPSOIL FURNISH AND PLACE, VARIABLE DEPTH
-  INLET FILTERS
-  PERIMETER EROSION BARRIER



LEGEND

-  SODDING, FERTILIZERS, TOPSOIL FURNISH AND PLACE, VARIABLE DEPTH
-  INLET FILTERS
-  PERIMETER EROSION BARRIER

**STATE OF ILLINOIS
DEPARTMENT OF TRANSPORTATION**

**MC DONALD CREEK MULTI USE PATH
EROSION CONTROL / SOD REPLACEMENT**

FILE NAME = 3d-phase1McDonald.dwg	USER NAME = chomuth	DESIGNED - BS	REVISED -
LAYOUT NAME = 110+00-118+00 ER	DRAWN - CH	CHECKED - JM	REVISED -
PLOT SCALE = 20.00' / IN.	DATE = 04/12/2011		

SCALE: 1"=20'	SHEET NO. OF SHEETS	STA. 110+00 TO STA. 118+00
---------------	---------------------	----------------------------



F.A. RTE.	SECTION	COUNTY	TOTAL SHEETS	SHEET NO.
	10-00196-00-BT	COOK	26	16
CONTRACT NO. 63624				
FED. ROAD DIST. NO. 1 ILLINOIS FED. AID PROJECT				

PLAN	SUBMITTED	DATE
	REVISED	
	DESIGNED	
	CHECKED	
	BY	
	NO.	
	STRUCTURE NOTATION CHNO	

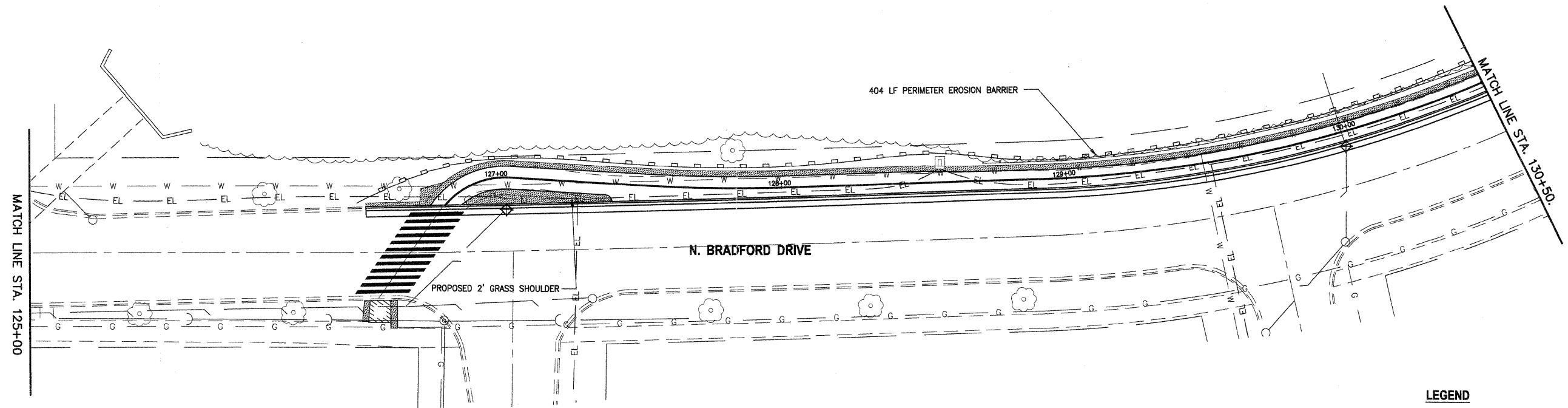
PROFILE	SUBMITTED	DATE
	REVISED	
	DESIGNED	
	CHECKED	
	BY	
	NO.	
	STRUCTURE NOTATION CHNO	



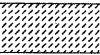

LEGEND

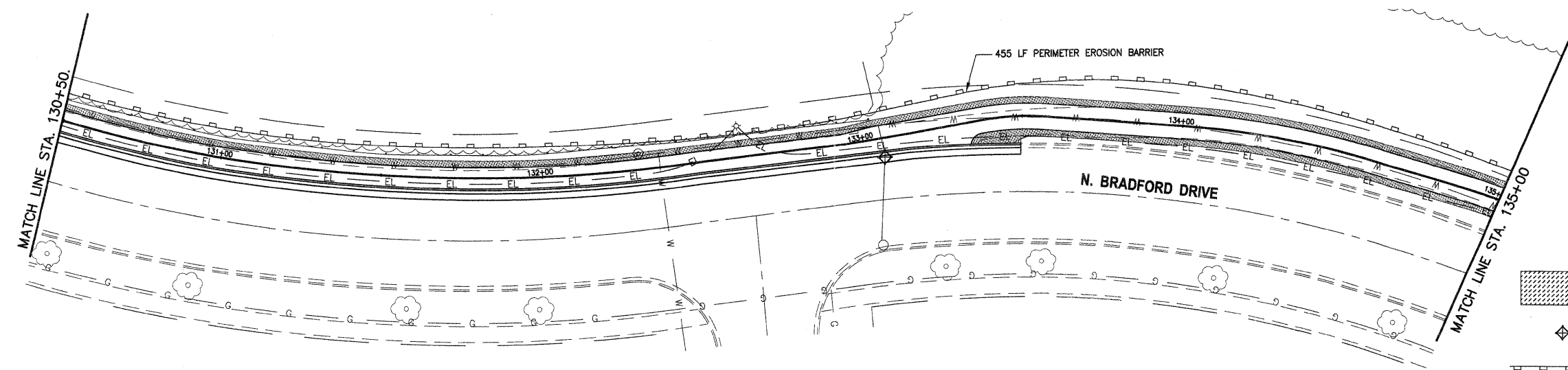
-  SODDING, FERTILIZERS, TOPSOIL FURNISH AND PLACE, VARIABLE DEPTH
-  INLET FILTERS
-  PERIMETER EROSION BARRIER



LEGEND

-  SODDING, FERTILIZERS, TOPSOIL FURNISH AND PLACE, VARIABLE DEPTH
-  INLET FILTERS
-  PERIMETER EROSION BARRIER

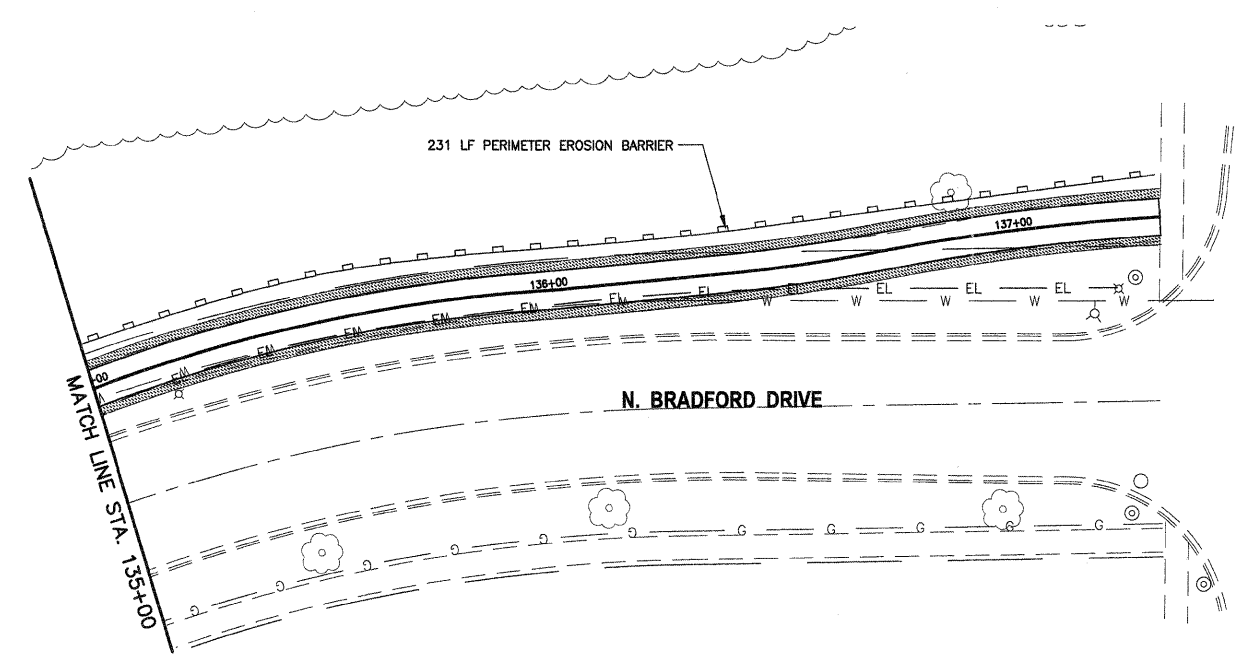

T:\projects\highway\commission\creek\10-2010\10-McDonald_Creek\yearfileA

FILE NAME = 3d-phase1McDonald.dwg	USER NAME = chomuth	DESIGNED - BS	REVISED -	STATE OF ILLINOIS DEPARTMENT OF TRANSPORTATION	MC DONALD CREEK MULTI USE PATH EROSION CONTROL / SOD REPLACEMENT			F.A. RTE.	SECTION	COUNTY	TOTAL SHEETS	SHEET NO.	
	LAYOUT NAME = 125+00-135+00 ER	DRAWN - CH	REVISED -		SCALE: 1"=20'	SHEET NO.	OF	SHEETS	STA. 125+00 TO STA. 135+00	10-00196-00-BT	COOK	26	18
	PLOT SCALE = 20.00' / IN.	CHECKED - JM	REVISED -							CONTRACT NO. 63624			
	PLOT DATE = Oct 24, 2011 - 4:10pm	DATE - 04/12/2011	REVISED -							FED ROAD DIST NO. 1 ILLINOIS FED. AID PROJECT			



HINTZ ROAD

LEGEND

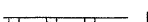
-  SODDING, FERTILIZERS, TOPSOIL FURNISH AND PLACE, VARIABLE DEPTH
-  INLET FILTERS
-  PERIMETER EROSION BARRIER

PLAN	SURVEYED	BY	DATE
	NOTED		
	GRADES CHECKED		
	STRUCTURE NOTATIONS CHKD		
	NO.		

PROFILE	SURVEYED	BY	DATE
	NOTED		
	GRADES CHECKED		
	STRUCTURE NOTATIONS CHKD		
	NO.		

T:\Bioscience Advisory Commission\CMW\11-2010\McDonald Creek\Profile.dwg

FILE NAME = 3d-phase1McDonald.dwg	USER NAME = chomuth	DESIGNED - BS	REVISED -	STATE OF ILLINOIS DEPARTMENT OF TRANSPORTATION	MC DONALD CREEK MULTI USE PATH EROSION CONTROL / SOD REPLACEMENT				F.A. RTE.	SECTION	COUNTY	TOTAL SHEETS	SHEET NO.
	LAYOUT NAME = 135+00-137+31 ER	DRAWN - CH	REVISED -		SCALE: 1"=20'	SHEET NO.	OF	SHEETS	STA. 135+00 TO STA. 137+31	10-00196-00-BT	COOK	26	19
	PLOT SCALE = 20.00' / IN.	CHECKED - JM	REVISED -							CONTRACT NO. 63624			
	PLOT DATE = Oct 24, 2011 - 4:09pm	DATE - 04/12/2011	REVISED -							FED. ROAD DIST NO. 1 ILLINOIS FED. AID PROJECT			

McDonald Creek- Camelot Connector Parkway
Guardrail and Post Aerial with Section Identification



PLAN	DATE
BY	
REVISIONS	
GRADES CHECKED	
STRUCTURE NOTATIONS CHYO	
NO.	

PROFILE	DATE
BY	
REVISIONS	
GRADES CHECKED	
STRUCTURE NOTATIONS CHYO	
NO.	

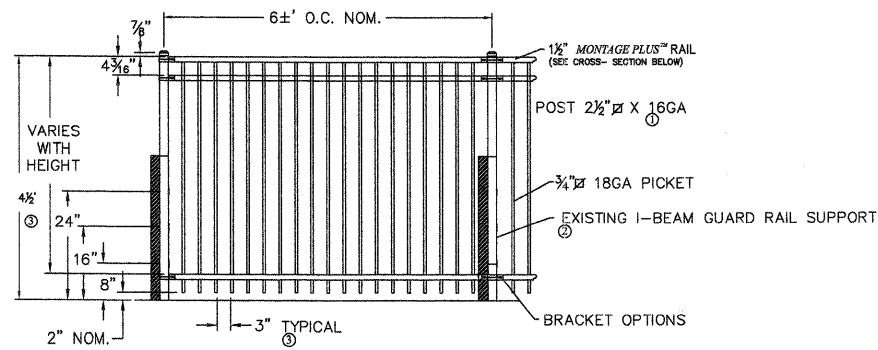

- NOTES:**
- 1.) POST SIZE DEPENDS ON FENCE HEIGHT AND WIND LOADS. SEE MONTAGE PLUS™ SPECIFICATIONS FOR POST SIZING CHART.
 - 2.) POST TO BE MOUNTED TO THE EXISTING GUARD RAIL BY THREE (3) MONTAGE PLUS FLAT MOUNT U-BRACKETS (PART # BB111) PER POST. USE INCLUDED HARDWARE TO MAKE ALL CONNECTIONS. U-BRACKET AND ALL HARDWARE TO BE BLACK IN COLOR.
 - 3.) AVAILABLE IN 3" AIR SPACE AND/OR FLUSH BOTTOM ON MOST HEIGHTS.

RAKING DIRECTIONAL ARROW WELDED PANEL CAN BE RAKED 30" OVER 8" WITH ARROW POINTING DOWN GRADE.

PROFUSION™ WELDING PROCESS NO EXPOSED WELDS, GOOD NEIGHBOR PROFILE - SAME APPEARANCE ON BOTH SIDES

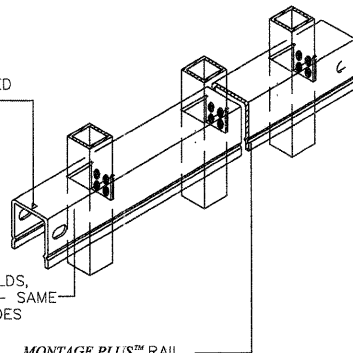

MONTAGE PLUS™ RAIL SPECIALLY FORMED HIGH STRENGTH ARCHITECTURAL SHAPE, OR APPROVED EQUAL

McDonald Creek- Camelot Connector Parkway	
Existing Dimensions between Guardrail I-Beam guardrail supports	
Section (from North to South)	Width between I-Beam guardrail supports
1	6' 2"
2	6' 5"
3	6' 1.5"
4	6' 0.5"
5	6' 3"
6	6' 2"
7	6' 3"
8	6' 4"
9	6' 4"
10	6' 2.5"
11	6' 4"
12	6' 2.5"
13	6' 4"
14	6' 2"
15	6' 3.5"
16	6' 4.5"
17	6' 1"
18	6' 3.5"
19	6' 3.5"
20	6' 3.5"
21	6' 2"
22	6' 2.5"
23	6' 4.5"
24	6' 0.5"
25	6' 3"
26	6' 4.5"
27	6' 0.5"
28	6' 4"
29	6' 4"
30	6' 2.5"
31	6' 0.5"
32	6' 6"
33	6' 1"
34	6' 4.25"
35	6' 3"
36	6' 3.5"
37	6' 0.5"
38	6' 5.25"
39	6' 1"
40	6' 3.5"

Existing Dimensions Continued	
Section (from North to South)	Width between I-Beam guardrail supports
41	6' 3"
42	6' 2.5"
43	6' 0.5"
44	6' 6.5"
45	6' 1"
46	6' 4"
47	6' 0"
48	6' 5.5"
49	6' 3.25"
50	6' 2.5"
51	6' 0"
52	6' 5.25"
53	6' 3.5"
54	6' 2"
55	6' 0.5"
56	6' 5.25"
57	6' 3"
58	6' 3.5"
59	6' 4.5"
60	6' 3"
61	6' 0.5"
62	6' 5.5"
63	6' 2"
64	6' 3"
65	6' 1"
66	6' 5.5"
67	6' 0"
68	6' 5.5"
TOTAL	425 L.F.

General info:
70 I-Beam guardrail supports total
All I-Beam guardrail supports are approximately 32" in height (dependent upon grade)
Width Measurements taken from middle of I-Beam guardrail supports

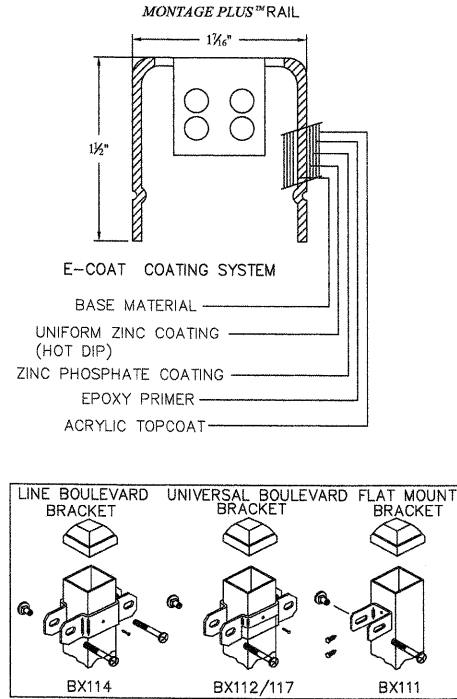

VALUES SHOWN ARE NOMINAL AND NOT TO BE USED FOR INSTALLATION PURPOSES, SEE PRODUCT SPECIFICATION FOR INSTALLATION REQUIREMENTS.

FENCE (SPECIAL) DETAIL

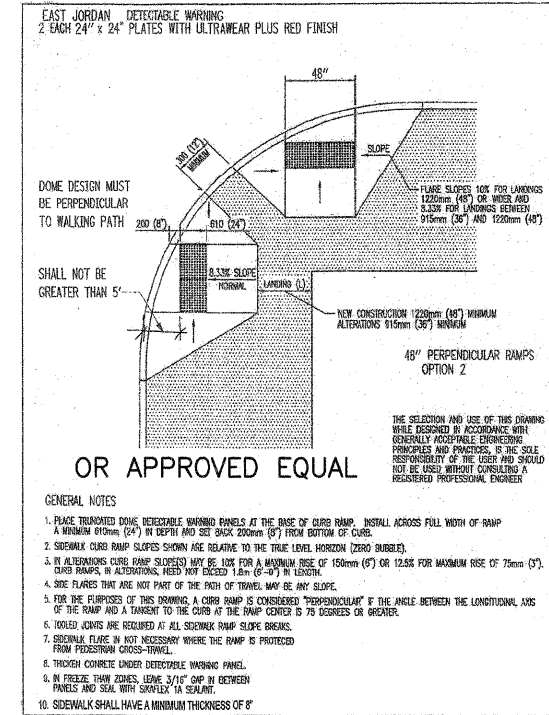

OR APPROVED EQUAL

- GENERAL NOTES:**
1. PLACE TRUNCATED DOME DETECTABLE WARNING PANELS AT THE BASE OF CURB RAMP. INSTALL ACROSS FULL WIDTH OF RAMP A MINIMUM 610mm (24") IN DEPTH AND SET BACK 200mm (8") FROM BOTTOM OF CURB.
 2. SIDEWALK CURB RAMP SLOPES SHOWN ARE RELATIVE TO THE TRUE LEVEL HORIZON (ZERO BUBBLE).
 3. IN ALTERNATION CURB RAMP SLOPES MAY BE 1:12 FOR A MAXIMUM RISE OF 150mm (6") OR 1:20 FOR MAXIMUM RISE OF 75mm (3"). CURB RAMP, IN ALTERNATION, NEED NOT EXCEED 1:4m (6'-0") IN LENGTH.
 4. SIDE FLARES THAT ARE NOT PART OF THE PATH OF TRAVEL MAY BE ANY SLOPE.
 5. FOR THE PURPOSES OF THIS DRAWING A CURB RAMP IS CONSIDERED "PERPENDICULAR" IF THE ANGLE BETWEEN THE LONGITUDINAL AXIS OF THE RAMP AND A TANGENT TO THE CURB AT THE RAMP CENTER IS 75 DEGREES OR GREATER.
 6. JOINTS JOINTS ARE REQUIRED AT ALL SIDEWALK RAMP SLOPE BREAKS.
 7. SIDEWALK FLARE, IF NOT NECESSARY WHERE THE RAMP IS PROTECTED FROM PEDESTRIAN CROSS-TRAVEL.
 8. TYPICAL CONCRETE UNDER DETECTABLE WARNING PANEL.
 9. IN FREEZE THAW ZONES, LEAVE 3/16" GAP IN BETWEEN PANELS AND SEAL WITH GRAPEX IN SEALANT.
 10. SIDEWALK SHALL HAVE A MINIMUM THICKNESS OF 6"

DETECTABLE WARNINGS DETAIL

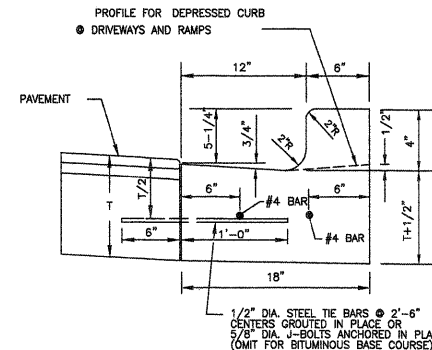

COMBINATION CONCRETE CURB AND GUTTER TYPE B (MODIFIED)

- NOTES:**
1. 2-#4 LONGITUDINAL BARS 20 FEET IN LENGTH WITH 12" OVERLAPS, AT 60" INTERVALS, EXCEPT AT EXPANSION JOINTS.
 2. EXPANSION JOINTS SHALL BE A MINIMUM OF 3/4" PREFORMED EXPANSION MATERIAL, AND SHALL BE PROVIDED WITH TWO 1" DIA. X 18" COATED SMOOTH DOWEL BARS FITTED WITH A CAP THAT WILL ALLOW A MINIMUM OF 1" OF EXPANSION.
 3. CONSTRUCTION JOINTS SHALL BE TEMPLATE FORMED OR SAW-CUT (WITHIN 24 HOURS OF PLACEMENT OF THE CURB) TO 1/5TH THE DEPTH OF THE GUTTER FLAG AT 10 FT. INTERVALS AT THE JOINTS IN AN ADJACENT CONCRETE PAVEMENT OR AT THE DIRECTION ON THE ENGINEER.
 4. THICKNESS OF THE CURB SHALL BE A MINIMUM OF 9".

T:\Bayside Advisory Commission\GMA\07-2010\McDonald Creek

FILE NAME = McDonald-Multi-Path-Detail2.dwg

USER NAME = chomuth	DESIGNED - BS	REVISED -
VIEWPORT NAME = FENCESH2	DRAWN - CH	REVISED -
PLOT SCALE = 1" / IN.	CHECKED - JM	REVISED -
PLOT DATE = Oct 24, 2011 - 4:01pm	DATE - 04/12/2011	REVISED -

STATE OF ILLINOIS
DEPARTMENT OF TRANSPORTATION

MC DONALD CREEK MULTI USE PATH
DETAILS

SCALE: N.T.S. SHEET NO. OF SHEETS

F.A.R.T.E.	SECTION	COUNTY	TOTAL SHEETS	SHEET NO.
	10-00196-00-BT	COOK	26	21
CONTRACT NO. 63624			FED ROAD DIST NO. 1 ILLINOIS FED. AID PROJECT	

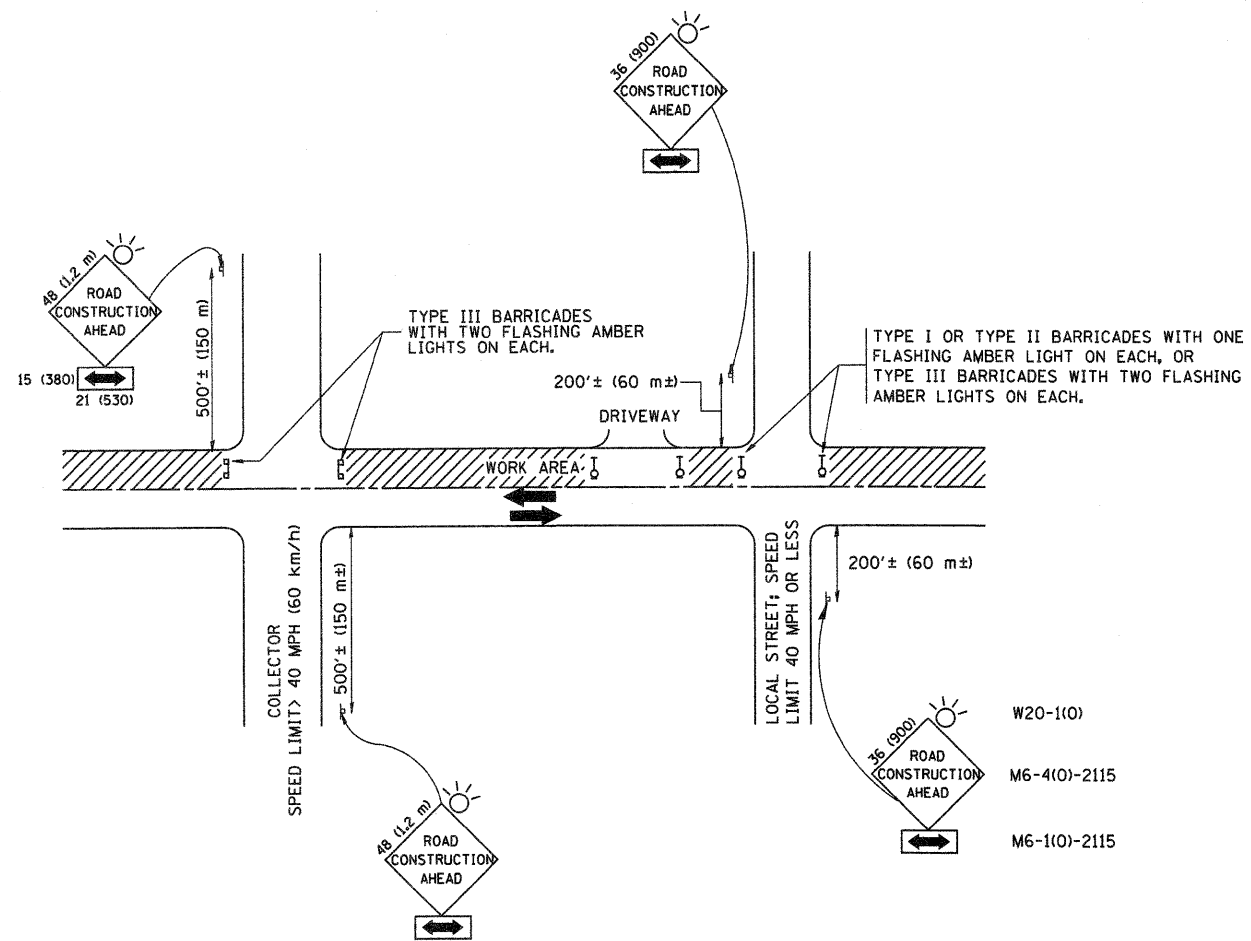

TRAFFIC CONTROL AND PROTECTION FOR SIDE ROADS, INTERSECTIONS, AND DRIVEWAYS

NOTES:

A. FOR NO LANE RESTRICTION ON THE SIDE ROAD OR DRIVEWAYS

1. SIDE ROAD WITH A SPEED LIMIT OF 40 MPH (60 km/h) OR LESS AS SHOWN ON THE DRAWING AND AS DIRECTED BY THE ENGINEER:

a) ONE ROAD CONSTRUCTION AHEAD SIGN 36 x 36 (900x900) WITH A FLASHER AND FLAG MOUNTED ON IT APPROXIMATELY 200' (60 m) IN ADVANCE OF THE MAIN ROUTE.

b) THE CLOSED PORTION OF THE MAIN ROUTE SHALL BE PROTECTED BY BLOCKING WITH TYPE I, TYPE II OR TYPE III BARRICADES, 1/3 OF THE CROSS SECTION OF THE CLOSED PORTION.

2. SIDE ROAD WITH A SPEED LIMIT GREATER THAN 40 MPH (60 km/h) AS SHOWN ON THE DRAWING AND AS DIRECTED BY THE ENGINEER:

a) ONE ROAD CONSTRUCTION AHEAD SIGN 48 x 48 (1.2 m x 1.2 m) WITH A FLASHER MOUNTED ON IT APPROXIMATELY 500' (150 m) IN ADVANCE OF THE MAIN ROUTE.

b) THE CLOSED PORTION OF THE MAIN ROUTE SHALL BE PROTECTED BY BLOCKING WITH TYPE III BARRICADES, 1/2 OF THE CROSS SECTION OF THE CLOSED PORTION.

3. WHEN THE SIDE ROAD LIES BETWEEN THE BEGINNING OF THE MAINLINE SIGNING AND THE WORK ZONE, A SINGLE HEADED ARROW (M6-1) SHALL BE USED IN LIEU OF THE DOUBLE HEADED ARROW (M6-4).

B. FOR A LANE CLOSURE ON A SIDE ROAD OR DRIVEWAY:

USE APPLICABLE PORTIONS OF THE TYPICAL APPLICATION OF TRAFFIC CONTROL DEVICES (STD. 701501, STD. 701606 OR THE APPROPRIATE STANDARD). THE SPACING OF SIGNS AND BARRICADES SHALL BE ADJUSTED FOR FIELD CONDITIONS AS DIRECTED BY THE ENGINEER. THE DIRECTIONAL ARROW SHALL BE COVERED OR REMOVED WHEN NO LONGER CONSISTENT WITH THE SIDE ROAD LANE CLOSURE.

C. ADVANCE WARNING SIGNS ARE TO BE OMITTED ON DRIVEWAY UNLESS OTHERWISE NOTED.

D. THE TRAFFIC CONTROL AND PROTECTION FOR SIDE ROADS, INTERSECTIONS, AND DRIVEWAYS SHALL BE INCIDENTAL TO THE COST OF SPECIFIED TRAFFIC CONTROL STANDARDS OR ITEMS.

All dimensions are in millimeters (inches) unless otherwise shown.

FILE NAME =	USER NAME = gaglianobt	DESIGNED - LHA	REVISED - J. OBERLE 10-18-95
W:\distsstd\22x34\to10.dgn		DRAWN -	REVISED - A. HOUSEH 03-06-96
	PLOT SCALE = 50.000' / IN.	CHECKED -	REVISED - A. HOUSEH 10-15-96
	PLOT DATE = 1/4/2008	DATE - 06-89	REVISED - T. RAMMACHER 01-06-00

STATE OF ILLINOIS
DEPARTMENT OF TRANSPORTATION

TRAFFIC CONTROL AND PROTECTION FOR
SIDE ROADS, INTERSECTIONS, AND DRIVEWAYS

SCALE: NONE SHEET NO. 1 OF 1 SHEETS STA. TO STA.

F.A. RTE.	SECTION	COUNTY	TOTAL SHEETS	SHEET NO.
			26	22
TC-10		CONTRACT NO. 63624		
FED. ROAD DIST. NO. 1 ILLINOIS FED. AID PROJECT				

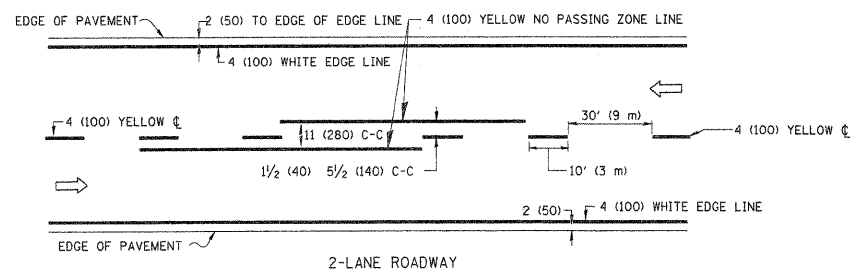

2-LANE ROADWAY

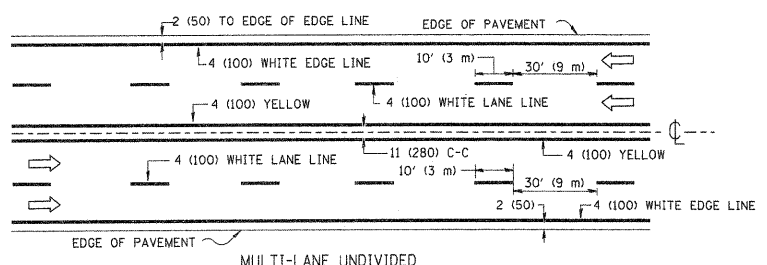

MULTI-LANE UNDIVIDED

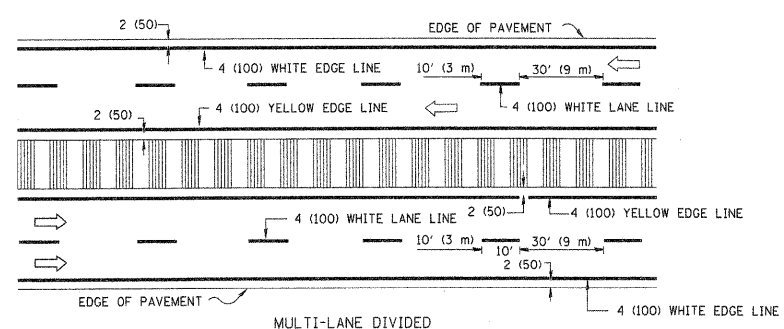

MULTI-LANE DIVIDED WITH MOUNTABLE MEDIAN

NOTE: MEDIANS WITH BARRIER CURB DO NOT REQUIRE AN EDGE LINE

TYPICAL LANE AND EDGE LINE MARKING

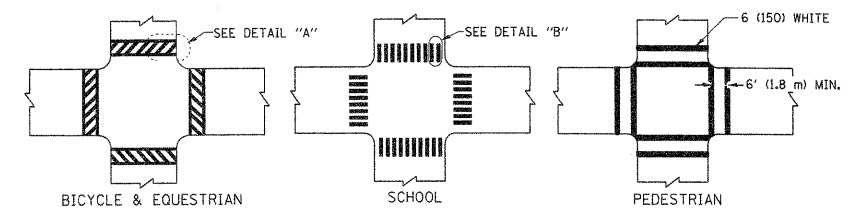

TYPICAL CROSSWALK MARKING

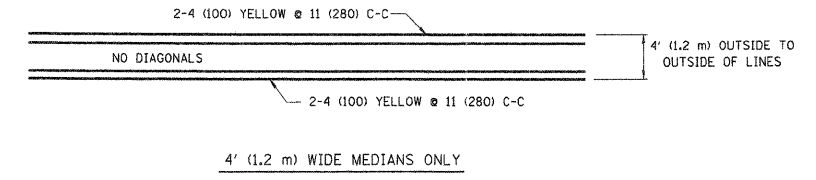

4' (1.2 m) WIDE MEDIANS ONLY

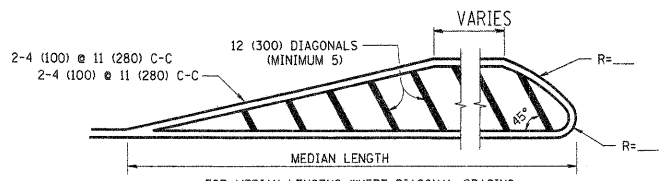

MEDIANS OVER 4' (1.2 m) WIDE

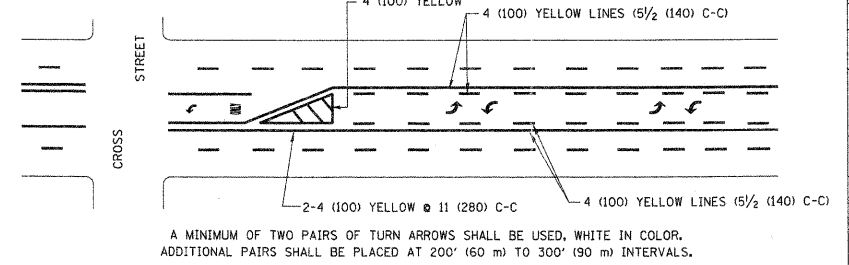

TYPICAL PAINTED MEDIAN MARKING

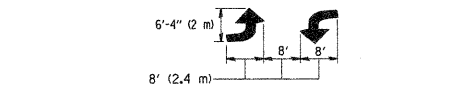

TYPICAL LEFT (OR RIGHT) TURN LANE

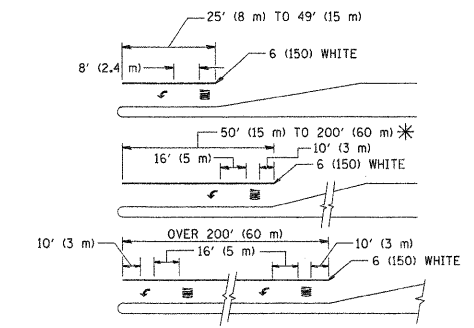

TYPICAL TURN LANE MARKING

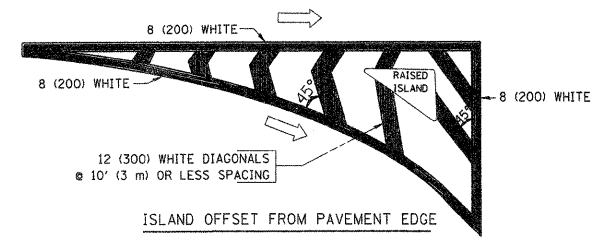

ISLAND OFFSET FROM PAVEMENT EDGE

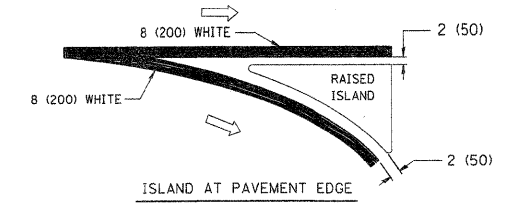

ISLAND AT PAVEMENT EDGE

TYPICAL ISLAND MARKING

TYPE OF MARKING	WIDTH OF LINE	PATTERN	COLOR	SPACING / REMARKS
CENTERLINE ON 2 LANE PAVEMENT	4 (100)	SKIP-DASH	YELLOW	10' (3 m) LINE WITH 30' (9 m) SPACE
CENTERLINE ON MULTI-LANE UNDIVIDED PAVEMENT	2 @ 4 (100)	SOLID	YELLOW	11 (280) C-C
NO PASSING ZONE LINES: FOR ONE DIRECTION FOR BOTH DIRECTIONS	4 (100) 2 @ 4 (100)	SOLID SOLID	YELLOW YELLOW	5 1/2 (140) C-C FROM SKIP-DASH CENTERLINE 11 (280) C-C OMIT SKIP-DASH CENTERLINE BETWEEN
LANE LINES	4 (100) 5 (125) ON FREEWAYS	SKIP-DASH SKIP-DASH	WHITE WHITE	10' (3 m) LINE WITH 30' (9 m) SPACE
DOTTED LINES (EXTENSIONS OF CENTER, LANE OR TURN LANE MARKINGS)	SAME AS LINE BEING EXTENDED	SKIP-DASH	SAME AS LINE BEING EXTENDED	2' (600) LINE WITH 6' (1.8 m) SPACE
EDGE LINES	4 (100)	SOLID	YELLOW-LEFT WHITE-RIGHT	OUTLINE MOUNTABLE MEDIANS IN YELLOW; EDGE LINES ARE NOT USED NEXT TO BARRIER CURB
TURN LANE MARKINGS	6 (150) LINE; FULL SIZE LETTERS & SYMBOLS (8' (2.4m))	SOLID	WHITE	SEE TYPICAL TURN LANE MARKING DETAIL
TWO WAY LEFT TURN MARKING	2 @ 4 (100) EACH DIRECTION 8' (2.4m) LEFT ARROW	SKIP-DASH AND SOLID IN PAIRS	YELLOW WHITE	10' (3 m) LINE WITH 30' (9 m) SPACE FOR SKIP-DASH 5 1/2 (140) C-C BETWEEN SOLID LINE AND SKIP-DASH LINE SEE TYPICAL TWO-WAY LEFT TURN MARKING DETAIL
CROSSWALK LINES (PEDESTRIAN) A. DIAGONALS (BIKE & EQUESTRIAN) B. LONGITUDINAL BARS (SCHOOL)	2 @ 6 (150) 12 (300) @ 45° 12 (300) @ 90°	SOLID SOLID SOLID	WHITE WHITE WHITE	NOT LESS THAN 6' (1.8 m) APART 2' (600) APART 2' (600) APART SEE TYPICAL CROSSWALK MARKING DETAILS.
STOP LINES	24 (600)	SOLID	WHITE	PLACE 4' (1.2 m) IN ADVANCE OF AND PARALLEL TO CROSSWALK, IF PRESENT. OTHERWISE, PLACE AT DESIRED STOPPING POINT, PARALLEL TO CROSSROAD CENTERLINE, WHERE POSSIBLE
PAINTED MEDIANS	2 @ 4 (100) WITH 12 (300) DIAGONALS @ 45° NO DIAGONALS USED FOR 4' (1.2 m) WIDE MEDIANS	SOLID	YELLOW; TWO WAY TRAFFIC WHITE; ONE WAY TRAFFIC	11 (280) C-C FOR THE DOUBLE LINE SEE TYPICAL PAINTED MEDIAN MARKING.
GORE MARKING AND CHANNELIZING LINES	8 (200) WITH 12 (300) DIAGONALS @ 45°	SOLID	WHITE	DIAGONALS: 15' (4.5 m) C-C (LESS THAN 30MPH (50 km/h)) 20' (6 m) C-C 30MPH (50 km/h) TO 45MPH (70 km/h) 30' (9 m) C-C (OVER 45MPH (70 km/h))
RAILROAD CROSSING	24 (600) TRANSVERSE LINES; "RR" 15' (4.5 m) LETTERS; 16 (400) LINE FOR "X"	SOLID	WHITE	SEE STATE STANDARD 780001 AREA OF: "R"=3.6 SQ. FT. (0.33 m ²) EACH "X"=54.0 SQ. FT. (5.0 m ²)
SHOULDER DIAGONALS	12 (300) @ 45°	SOLID	WHITE - RIGHT YELLOW - LEFT	50' (15 m) C-C (LESS THAN 30MPH (50 km/h)) 75' (25 m) C-C (30 MPH (50 km/h) TO 45MPH (70 km/h)) 150' (45 m) C-C (OVER 45MPH (70 km/h))

FOR FURTHER DETAILS ON PAVEMENT MARKING REFER TO STANDARD SPECIFICATIONS FOR ROAD AND BRIDGE CONSTRUCTION AND STATE STANDARD 780001.

All dimensions are in inches (millimeters) unless otherwise shown.

FILE NAME =	USER NAME = drivakosgn	DESIGNED - EVERS	REVISED -T. RAMMACHER 10-27-94
ca:\pw_work\p1\det\drivakosgn\d0108315\to3.dgn		DRAWN -	REVISED -C. JUICIUS 09-09-09
	PLOT SCALE = 50.000 ' / IN.	CHECKED -	REVISED -
	PLOT DATE = 9/9/2009	DATE - 03-19-90	REVISED -

STATE OF ILLINOIS
DEPARTMENT OF TRANSPORTATION

DISTRICT ONE			
TYPICAL PAVEMENT MARKINGS			
SCALE: NONE	SHEET NO. 1 OF 1 SHEETS	STA.	TO STA.

F.A. RTE.	SECTION	COUNTY	TOTAL SHEETS NO.
			26 23
TC-13		CONTRACT NO. 63624	
FED. ROAD DIST. NO. 1 ILLINOIS FED. AID PROJECT			

DATE			
BY			
REVISIONS			
NO. 1	DATE	BY	DESCRIPTION
1			
2			
3			
4			
5			
6			
7			
8			
9			
10			
11			
12			
13			
14			
15			
16			
17			
18			
19			
20			
21			
22			
23			
24			
25			
26			
27			
28			
29			
30			
31			
32			
33			
34			
35			
36			
37			
38			
39			
40			
41			
42			
43			
44			
45			
46			
47			
48			
49			
50			
51			
52			
53			
54			
55			
56			
57			
58			
59			
60			
61			
62			
63			
64			
65			
66			
67			
68			
69			
70			
71			
72			
73			
74			
75			
76			
77			
78			
79			
80			
81			
82			
83			
84			
85			
86			
87			
88			
89			
90			
91			
92			
93			
94			
95			
96			
97			
98			
99			
100			

DATE			
BY			
REVISIONS			
NO. 1	DATE	BY	DESCRIPTION
1			
2			
3			
4			
5			
6			
7			
8			
9			
10			
11			
12			
13			
14			
15			
16			
17			
18			
19			
20			
21			
22			
23			
24			
25			
26			
27			
28			
29			
30			
31			
32			
33			
34			
35			
36			
37			
38			
39			
40			
41			
42			
43			
44			
45			
46			
47			
48			
49			
50			
51			
52			
53			
54			
55			
56			
57			
58			
59			
60			
61			
62			
63			
64			
65			
66			
67			
68			
69			
70			
71			
72			
73			
74			
75			
76			
77			
78			
79			
80			
81			
82			
83			
84			
85			
86			
87			
88			
89			
90			
91			
92			
93			
94			
95			
96			
97			
98			
99			
100			

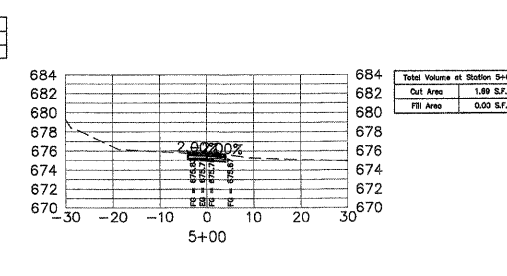
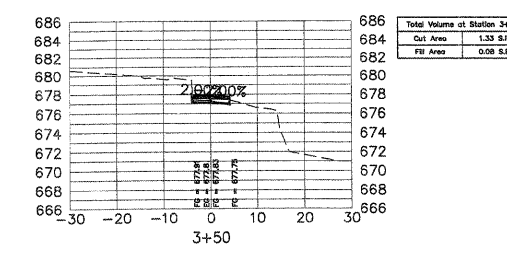
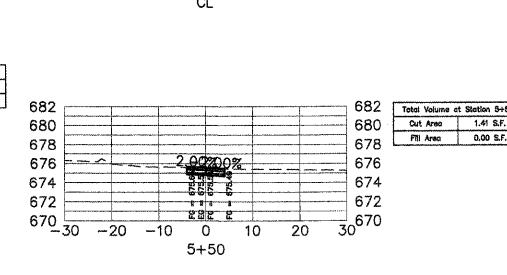
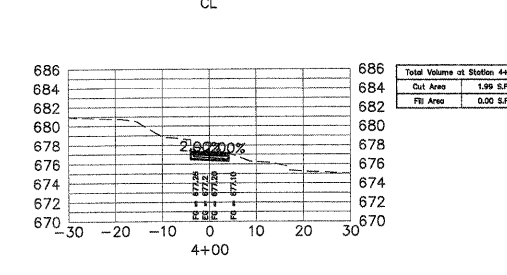
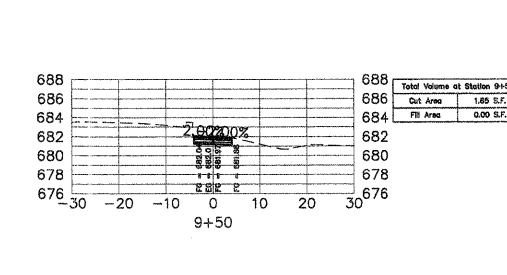
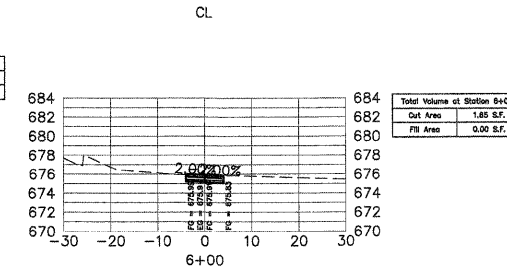
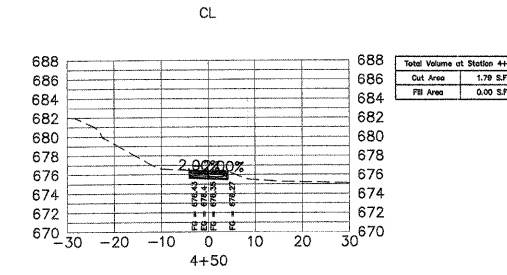
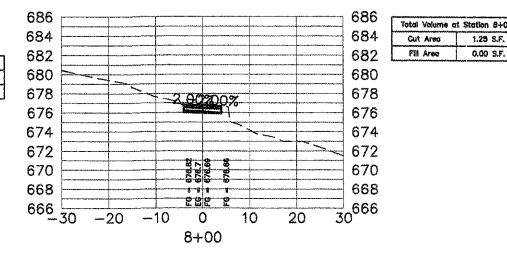
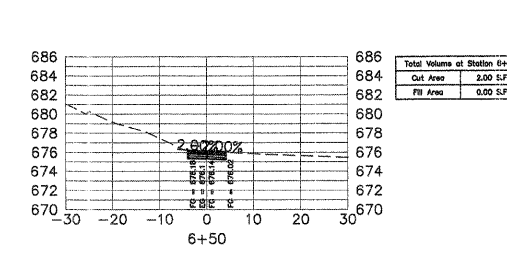
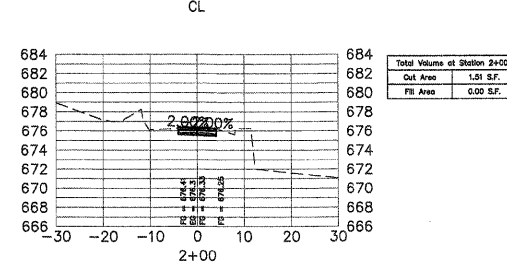
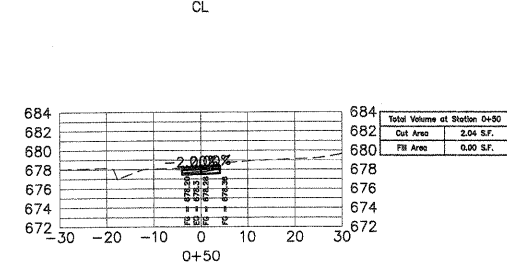
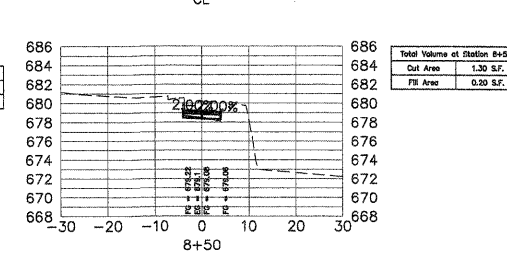
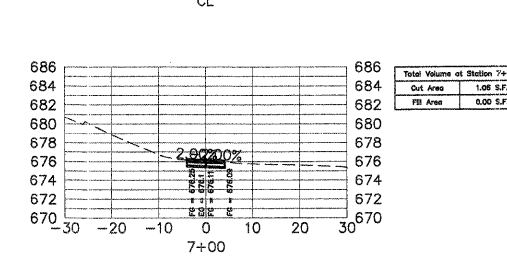
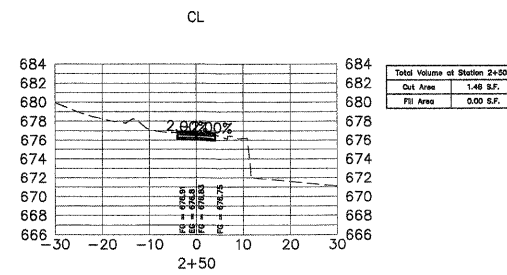
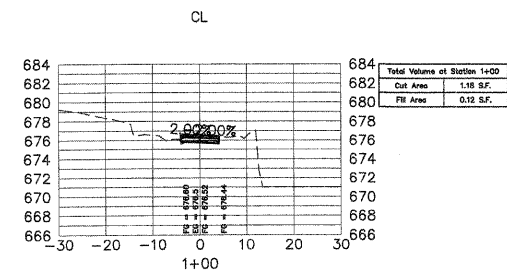
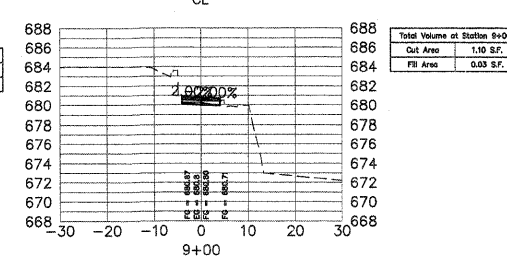
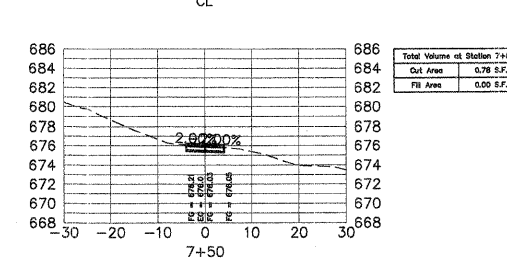
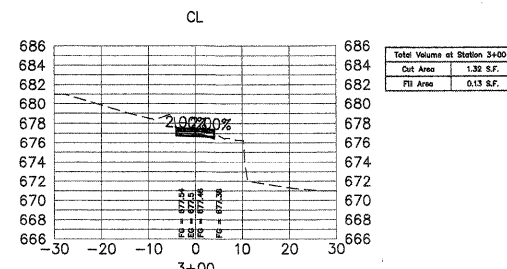
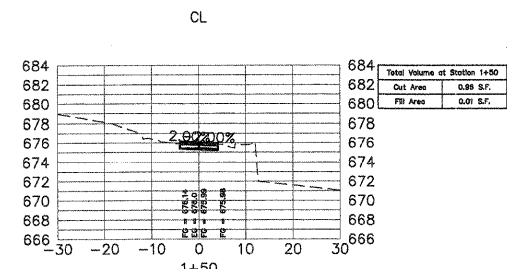

FILE NAME = Mc Donald Creek Part 2 Site Path.dwg

USER NAME = chomuth	DESIGNED - BS	REVISED -
VIEWPORT NAME = CrossSection1	DRAWN - CH	REVISED -
PLOT SCALE = 20.00' / IN.	CHECKED - JM	REVISED -
PLOT DATE = Nov 02, 2011 - 8:21am	DATE - 04/12/2011	REVISED -

STATE OF ILLINOIS
DEPARTMENT OF TRANSPORTATION

MC DONALD CREEK MULTI USE PATH CROSS SECTIONS	
SCALE: 1"=20'	SHEET NO. OF SHEETS
STA. 0+00 TO STA. 9+68	

F.A. RTE.	SECTION	COUNTY	TOTAL SHEETS	SHEET NO.
	10-00196-00-BT	COOK	26	24
FED ROAD DIST NO. 1 ILLINOIS FED. AID PROJECT			CONTRACT NO. 63624	

