

PLAN	REVISIONS	DATE
NO.	NO.	
NO.	NO.	
NO.	NO.	
NO.	NO.	
NO.	NO.	

PROFILE	REVISIONS	DATE
NO.	NO.	
NO.	NO.	
NO.	NO.	
NO.	NO.	
NO.	NO.	

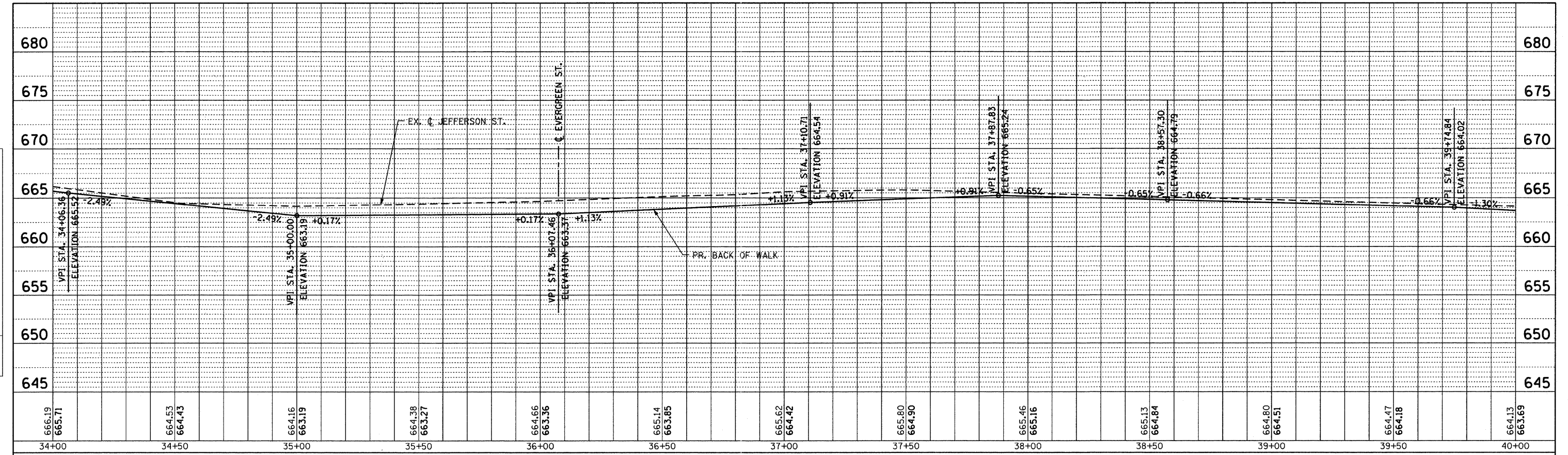

SOUTH SIDE - JEFFERSON ST

NO LONGITUDINAL SLOPES EXCEED 5%. ALL SIDEWALKS ADA COMPLIANT.

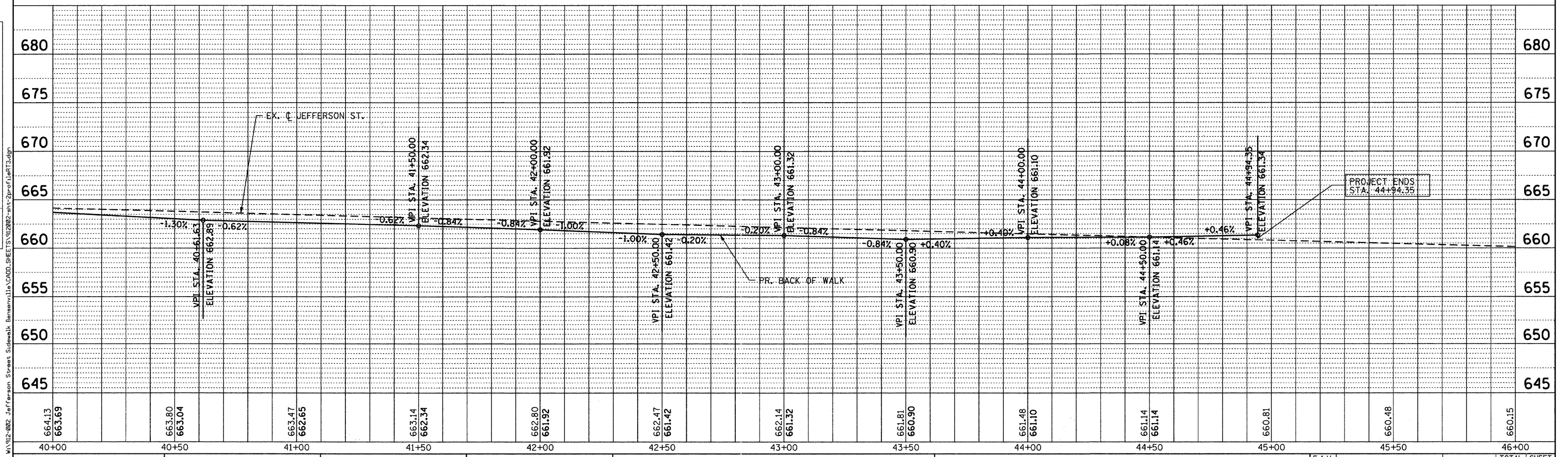

PROJECT ENDS STA. 44+94.35

Bollinger, Lach & Associates, Inc.
 ITASCA, ILLINOIS

USER NAME = delj	DESIGNED - BPD	REVISED -
PLOT SCALE = 20,0000' / IN.	DRAWN - MTC	REVISED -
PLOT DATE = 8/29/2011	CHECKED - BPD	REVISED -
	DATE - 08-29-2011	REVISED -

STATE OF ILLINOIS
DEPARTMENT OF TRANSPORTATION

PROFILE - BACK OF WALK - SOUTH SIDE
 SCALE: 1"=20' HZ
 SCALE: 1"=5' VT
 SHEET NO. 19 OF 38 SHEETS
 STA. 34+00 TO STA. 45+00

F.A.U. RTE.	SECTION	COUNTY	TOTAL SHEETS	SHEET NO.
1370	11-00088-00-SW		38	19
CONTRACT NO. 63639			ILLINOIS FED. AID PROJECT	