

**WEST EDGE OF PAVEMENT**

Location	Station	Offset	Theoretical Grade Elevations
S. End of South Appr.	11+90.75	-5.00	673.27
A	11+95.75	-5.00	673.54
N. End of South Appr.	12+00.75	-5.00	673.81

**☉ FOX RIVER TRAIL & PROFILE GRADE LINE (P.G.L.)**

Location	Station	Offset	Theoretical Grade Elevations
S. End of South Appr.	11+90.75	0.00	673.35
A	11+95.75	0.00	673.58
N. End of South Appr.	12+00.75	0.00	673.81

**EAST EDGE OF PAVEMENT**

Location	Station	Offset	Theoretical Grade Elevations
S. End of South Appr.	11+90.75	5.00	673.27
A	11+95.75	5.00	673.54
N. End of South Appr.	12+00.75	5.00	673.81

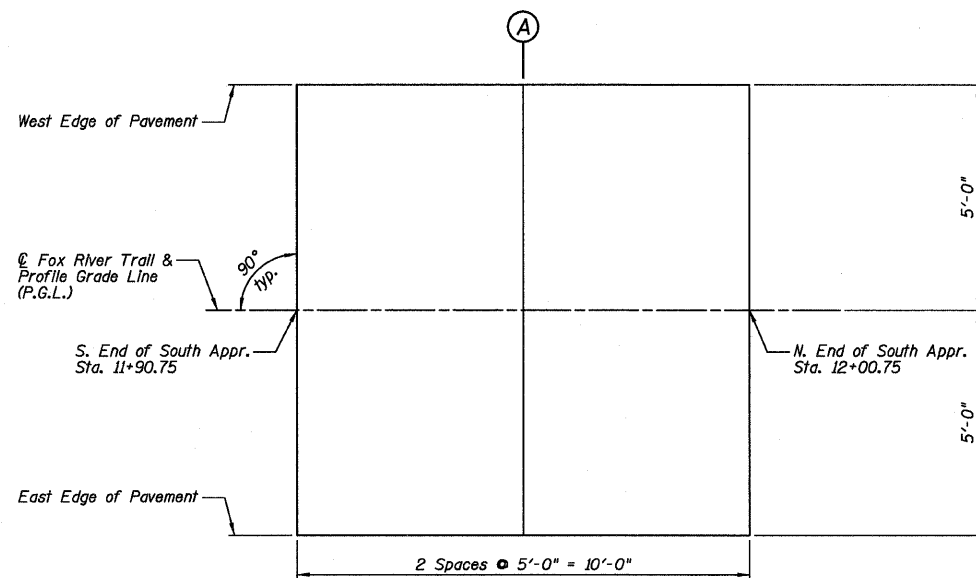

**SOUTH APPROACH SLAB PLAN**

**WEST EDGE OF PAVEMENT**

Location	Station	Offset	Theoretical Grade Elevations
S. End of North Appr.	13+83.25	-5.00	674.15
A	13+88.25	-5.00	673.90
N. End of North Appr.	13+93.25	-5.00	673.66

**☉ FOX RIVER TRAIL & PROFILE GRADE LINE (P.G.L.)**

Location	Station	Offset	Theoretical Grade Elevations
S. End of North Appr.	13+83.25	0.00	674.15
A	13+88.25	0.00	673.94
N. End of North Appr.	13+93.25	0.00	673.74

**EAST EDGE OF PAVEMENT**

Location	Station	Offset	Theoretical Grade Elevations
S. End of North Appr.	13+83.25	5.00	674.15
A	13+88.25	5.00	673.90
N. End of North Appr.	13+93.25	5.00	673.66

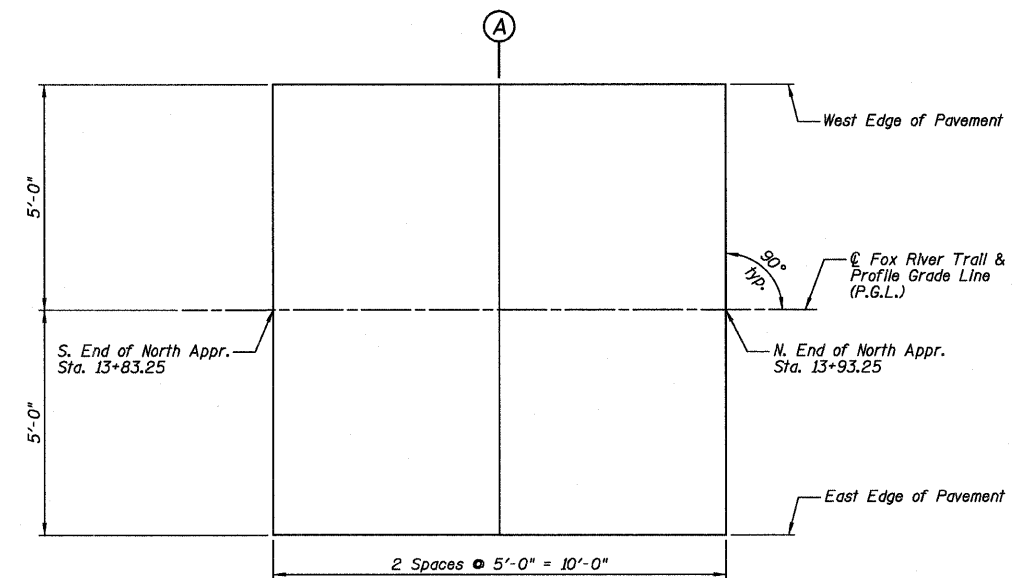

**NORTH APPROACH SLAB PLAN**

**Farnsworth**  
GROUP, INC.  
2709 McGraw Drive  
Bloomington, Illinois 61704  
309/663-8435, 309/663-1571 fax

DESIGNED - JML/JCZ	REVISED
CHECKED - JML	REVISED
DRAWN - DJM	REVISED
CHECKED - MSW	REVISED
DATE - 10/17/11	

**GENEVA PARK DISTRICT  
GENEVA, ILLINOIS**

**TOP OF APPROACH SLAB ELEVATIONS  
ISLAND PARK NORTH BRIDGE**

SHEET NO. B4 OF 31 SHEETS

F.A. RTE.	SECTION	COUNTY	TOTAL SHEETS	SHEET NO.
N/A	06-P4005-00-BR	KANE	42	13
CONTRACT NO. 63643			ILLINOIS FED. AID PROJECT	