

PLAN INCLUDED FOR REFERENCE

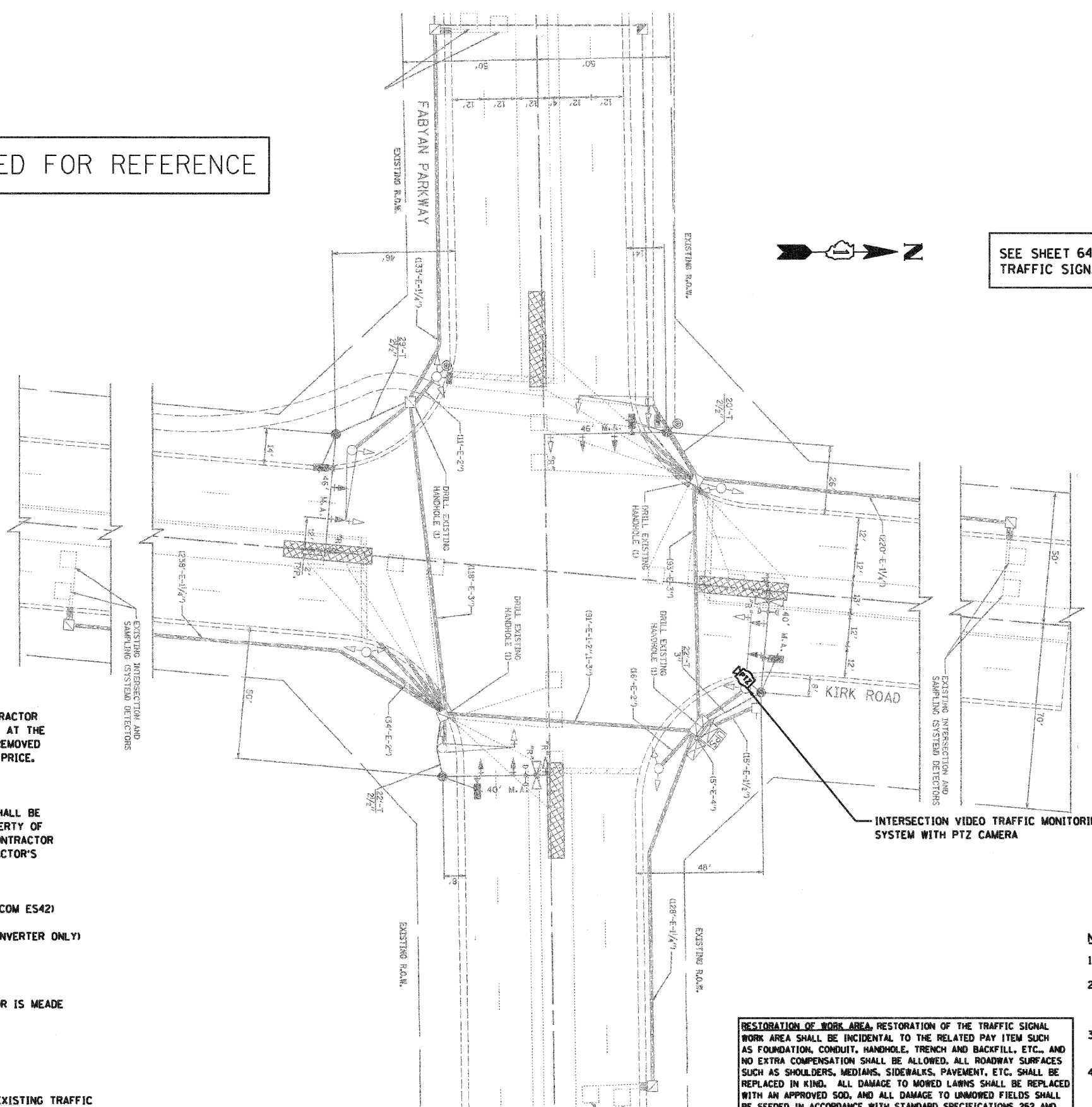

SEE SHEET 64 FOR TRAFFIC SIGNAL LEGEND

THE FOLLOWING ITEMS SHALL BE REMOVED BY THE CONTRACTOR AND SHALL BE DISPOSED OF OUTSIDE THE RIGHT-OF-WAY AT THE CONTRACTOR'S EXPENSE. THE SALVAGE VALUE OF THE REMOVED EQUIPMENT SHALL BE REFLECTED IN THE CONTRACT BID PRICE.

- 4 EACH CONFIRMATION BEACON

THE FOLLOWING EXISTING TRAFFIC SIGNAL EQUIPMENT SHALL BE REMOVED BY THE CONTRACTOR, SHALL REMAIN THE PROPERTY OF THE KANE COUNTY, AND SHALL BE DELIVERED BY THE CONTRACTOR TO THE COUNTY'S TRAFFIC SIGNAL MAINTENANCE CONTRACTOR'S MAIN FACILITY.

- 1 EACH MASTER CONTROLLER
- 1 EACH ETHERNET SWITCH TYPE I (GARRETCOM ES42)
- 1 EACH MALFUNCTION MANAGEMENT UNIT
- 1 EACH UNINTERRUPTABLE POWER SUPPLY (INVERTER ONLY)
- 1 EACH TREEHAVEN RVSFB120
- 1 EACH IVDO STREAMER/ENCODER
- 1 EACH PTZ CAMERA

THE COUNTY'S TRAFFIC SIGNAL MAINTENANCE CONTRACTOR IS MEADE ELECTRIC, CO. LOCATED AT:

30 W 751 NORTH AURORA ROAD  
NAPERVILLE, IL 60563  
TEL (708) 588-2500

ALL REMOVED ITEMS LISTED WILL BE PAID AS REMOVE EXISTING TRAFFIC SIGNAL EQUIPMENT.

INTERSECTION VIDEO TRAFFIC MONITORING SYSTEM WITH PTZ CAMERA

**RESTORATION OF WORK AREA**, RESTORATION OF THE TRAFFIC SIGNAL WORK AREA SHALL BE INCIDENTAL TO THE RELATED PAY ITEM SUCH AS FOUNDATION, CONDUIT, HANDHOLE, TRENCH AND BACKFILL, ETC., AND NO EXTRA COMPENSATION SHALL BE ALLOWED. ALL ROADWAY SURFACES SUCH AS SHOULDERS, MEDIANS, SIDEWALKS, PAVEMENT, ETC. SHALL BE REPLACED IN KIND. ALL DAMAGE TO MOWED LAWNS SHALL BE REPLACED WITH AN APPROVED SOD, AND ALL DAMAGE TO UNMOWED FIELDS SHALL BE SEEDED IN ACCORDANCE WITH STANDARD SPECIFICATIONS 252 AND 250 RESPECTIVELY. SOD SHALL BE WATERED AS DIRECTED BY ENGINEER AND PER ACT 252.08 & 252.09 IN STP SPECS.

NOTES:

1. NEW ELEMENTS SHOWN IN BOLD. EXISTING ELEMENTS INCLUDED FOR REFERENCE ONLY (GRAYSCALE).
2. EXISTING CONDITIONS, INCLUDING THE CONDITION AND AVAILABILITY OF CONDUITS, HAVE NOT BEEN FIELD VERIFIED. CONTRACTOR MUST VERIFY EXISTING CONDITIONS BEFORE COMMENCING WORK.
3. THE EXACT LOCATION OF ALL UTILITIES SHALL BE FIELD VERIFIED BY THE CONTRACTOR BEFORE THE INSTALLATION OF ANY COMPONENT OF THE TRAFFIC SIGNAL SYSTEM.
4. THE CONTRACTOR SHALL CONTACT THE KANE COUNTY DIVISION OF TRANSPORTATION (630.584.5265) FOR TRAFFIC SIGNAL CABLE LOCATIONS A MINIMUM OF 48 HOURS IN ADVANCE (SATURDAYS, SUNDAYS, AND HOLIDAYS EXCLUDED) AT ANY LOCATION WITHIN THE RIGHT-OF-WAY.

P:\11-2811\9867280\700 CAD0 & GIS Files\702 Eval\Sheets\CEa\_Signal\Kirk and Fabyan\_T2.dgn

**JACOBS**  
ONE NORTH FRANKLIN  
CHICAGO IL, 60606  
312-251-3000

USER NAME =	DESIGNED - CH	REVISED -
PLOT SCALE =	DRAWN - MO, DI	REVISED -
PLOT DATE = 11/7/2011	CHECKED - KC	REVISED -
	DATE - #DATE	REVISED -

**KANE COUNTY  
DIVISION OF TRANSPORTATION**

**TRAFFIC SIGNAL PLAN  
KIRK ROAD AND FABYAN PARKWAY**

F.A.P. RTE. 360	SECTION 10-00403-00-TL	COUNTY KANE	TOTAL SHEETS 72	SHEET NO. 13
CONTRACT NO. 63648				
FED. ROAD DIST. NO. (ILLINOIS) FED. AID PROJECT				

SCALE: SHEET NO. OF SHEETS STA. TO STA.