

11/7/2011

PLAN INCLUDED FOR REFERENCE

NOT TO SCALE

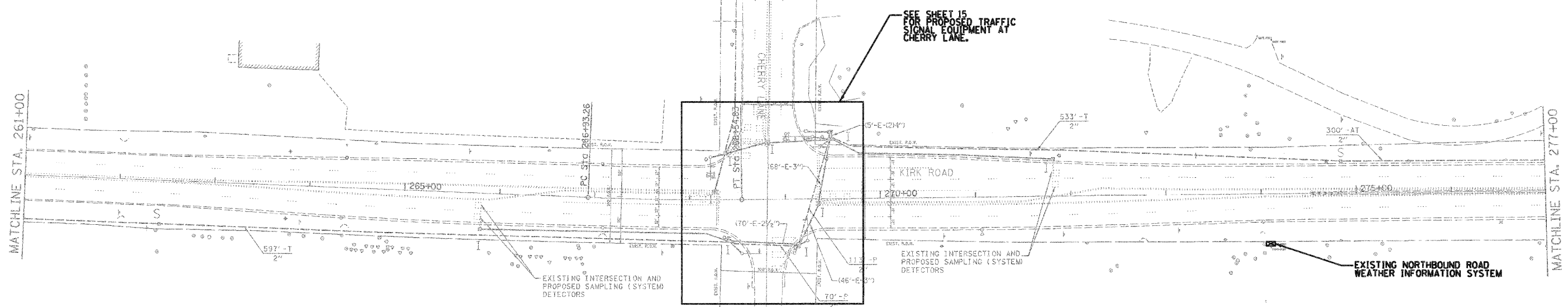

SCHEDULE OF QUANTITIES - ROAD WEATHER INFORMATION STATION (NOT SHOWN)

PAY ITEM	UNIT	QUANTITY
MAINTENANCE OF EXISTING TRAFFIC SIGNAL INSTALLATION	EACH	1
ETHERNET MANAGED SWITCH, TYPE 1	EACH	1
MODIFY EXISTING CONTROLLER CABINET	EACH	1

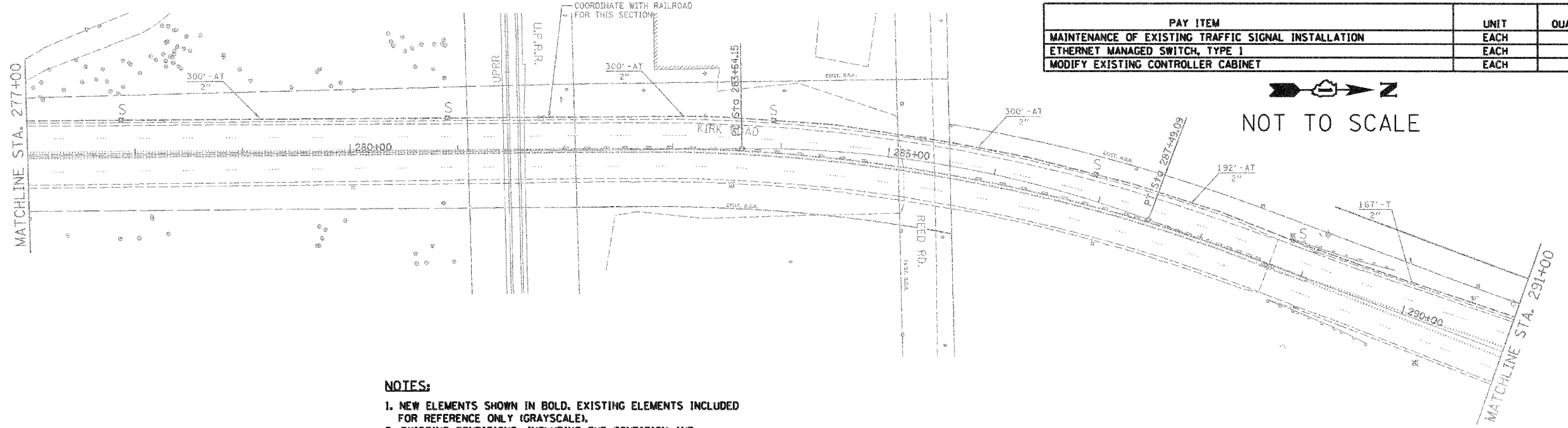

NOT TO SCALE

SEE SHEET 64 FOR TRAFFIC SIGNAL LEGEND

NOTES:

1. NEW ELEMENTS SHOWN IN BOLD. EXISTING ELEMENTS INCLUDED FOR REFERENCE ONLY (GRAYSCALE).
2. EXISTING CONDITIONS, INCLUDING THE CONDITION AND AVAILABILITY OF CONDUITS, HAVE NOT BEEN FIELD VERIFIED. CONTRACTOR MUST VERIFY EXISTING CONDITIONS BEFORE COMMENCING WORK.
3. THE EXACT LOCATION OF ALL UTILITIES SHALL BE FIELD VERIFIED BY THE CONTRACTOR BEFORE THE INSTALLATION OF ANY COMPONENT OF THE TRAFFIC SIGNAL SYSTEM.
4. THE CONTRACTOR SHALL CONTACT THE KANE COUNTY DIVISION OF TRANSPORTATION (630.584.1170) FOR TRAFFIC SIGNAL CABLE LOCATIONS A MINIMUM OF 48 HOURS IN ADVANCE (SATURDAYS, SUNDAYS, AND HOLIDAYS EXCLUDED) AT ANY LOCATION WITHIN THE RIGHT-OF-WAY.
5. ROAD WEATHER INFORMATION SYSTEM (RWIS) WILL BE INSTALLED BY OTHERS PRIOR TO KIRK ROAD PROJECT. CONTRACTOR WILL CONNECT RWIS TO KIRK ROAD NETWORK.

RESTORATION OF WORK AREA: RESTORATION OF THE TRAFFIC SIGNAL WORK AREA SHALL BE INCIDENTAL TO THE RELATED PAY ITEM SUCH AS FOUNDATION, CONDUIT, HANDHOLE, TRENCH AND BACKFILL, ETC., AND NO EXTRA COMPENSATION SHALL BE ALLOWED. ALL ROADWAY SURFACES SUCH AS SHOULDERS, MEDIANS, SIDEWALKS, PAVEMENT, ETC. SHALL BE REPLACED IN KIND. ALL DAMAGE TO MOWED LAWNS SHALL BE REPLACED WITH AN APPROVED SOO, AND ALL DAMAGE TO UNMOWED FIELDS SHALL BE SEEDED IN ACCORDANCE WITH STANDARD SPECIFICATIONS 252 AND 250 RESPECTIVELY. SOO SHALL BE WATERED AS DIRECTED BY ENGINEER AND PER ACT 292.08 & 292.09 IN STP SPECS.

P:\1-261\1\986708\708_CADD & GIS Files\702 Civil\Sheet\08 Interconnect.dgn

JACOBS
ONE NORTH FRANKLIN
CHICAGO IL, 60606
312-251-3000

USER NAME =	DESIGNED - CH	REVISED -
PLOT SCALE =	DRAWN - MO, DI	REVISED -
PLOT DATE = 11/7/2011	CHECKED - KG	REVISED -
	DATE - #DATE	REVISED -

KANE COUNTY
DIVISION OF TRANSPORTATION

INTERCONNECT PLAN
KIRK ROAD (SHEET 8 OF 22)

SCALE: SHEET NO. OF SHEETS STA. TO STA.

F.A.P. RTE. 360	SECTION 10-00403-00-TL	COUNTY KANE	TOTAL SHEETS 72	SHEET NO. 40
FED. ROAD DIST. NO. ILLINOIS FED. AID PROJECT			CONTRACT NO. 63648	