

11/7/2011

P:\2011\9867007\007\000 CAD & GIS Files\782 Civil\Sheet\IB Interconnect.dgn

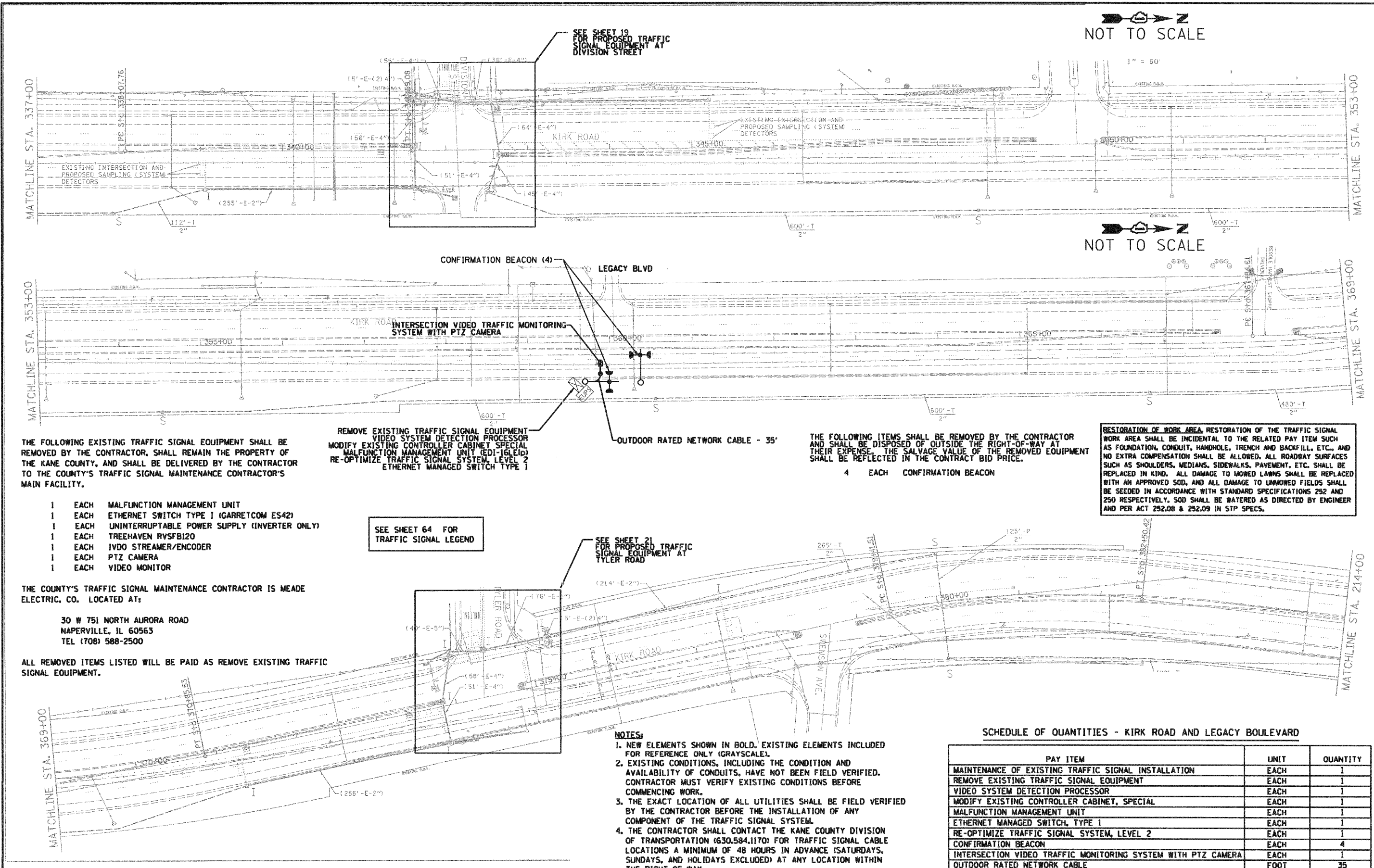

THE FOLLOWING EXISTING TRAFFIC SIGNAL EQUIPMENT SHALL BE REMOVED BY THE CONTRACTOR, SHALL REMAIN THE PROPERTY OF THE KANE COUNTY, AND SHALL BE DELIVERED BY THE CONTRACTOR TO THE COUNTY'S TRAFFIC SIGNAL MAINTENANCE CONTRACTOR'S MAIN FACILITY.

- 1 EACH MALFUNCTION MANAGEMENT UNIT
- 1 EACH ETHERNET SWITCH TYPE I (GARRETCOM ES42)
- 1 EACH UNINTERRUPTIBLE POWER SUPPLY (INVERTER ONLY)
- 1 EACH TREEHAVEN RVSFBI20
- 1 EACH IVDO STREAMER/ENCODER
- 1 EACH PTZ CAMERA
- 1 EACH VIDEO MONITOR

THE COUNTY'S TRAFFIC SIGNAL MAINTENANCE CONTRACTOR IS MEADE ELECTRIC, CO. LOCATED AT:

30 W 751 NORTH AURORA ROAD
 NAPERVILLE, IL 60563
 TEL (708) 588-2500

ALL REMOVED ITEMS LISTED WILL BE PAID AS REMOVE EXISTING TRAFFIC SIGNAL EQUIPMENT.

REMOVE EXISTING TRAFFIC SIGNAL EQUIPMENT
 VIDEO SYSTEM DETECTION PROCESSOR
 MODIFY EXISTING CONTROLLER CABINET SPECIAL MALFUNCTION MANAGEMENT UNIT (EDI-16LE16)
 RE-OPTIMIZE TRAFFIC SIGNAL SYSTEM, LEVEL 2
 ETHERNET MANAGED SWITCH TYPE 1

SEE SHEET 64 FOR TRAFFIC SIGNAL LEGEND

SEE SHEET 21 FOR PROPOSED TRAFFIC SIGNAL EQUIPMENT AT TYLER ROAD

THE FOLLOWING ITEMS SHALL BE REMOVED BY THE CONTRACTOR AND SHALL BE DISPOSED OF OUTSIDE THE RIGHT-OF-WAY AT THEIR EXPENSE. THE SALVAGE VALUE OF THE REMOVED EQUIPMENT SHALL BE REFLECTED IN THE CONTRACT BID PRICE.

- 4 EACH CONFIRMATION BEACON

RESTORATION OF WORK AREA, RESTORATION OF THE TRAFFIC SIGNAL WORK AREA SHALL BE INCIDENTAL TO THE RELATED PAY ITEM SUCH AS FOUNDATION, CONDUIT, HANDHOLE, TRENCH AND BACKFILL, ETC., AND NO EXTRA COMPENSATION SHALL BE ALLOWED. ALL ROADWAY SURFACES SUCH AS SHOULDERS, MEDIANS, SIDEWALKS, PAVEMENT, ETC. SHALL BE REPLACED IN KIND. ALL DAMAGE TO MOWED LAWNS SHALL BE REPLACED WITH AN APPROVED SOD, AND ALL DAMAGE TO UNMOWED FIELDS SHALL BE SEEDDED IN ACCORDANCE WITH STANDARD SPECIFICATIONS 252 AND 250 RESPECTIVELY. SOD SHALL BE WATERED AS DIRECTED BY ENGINEER AND PER ACT 252.08 & 252.09 IN STP SPECS.

- NOTES:**
- NEW ELEMENTS SHOWN IN BOLD, EXISTING ELEMENTS INCLUDED FOR REFERENCE ONLY (GRAYSCALE).
 - EXISTING CONDITIONS, INCLUDING THE CONDITION AND AVAILABILITY OF CONDUITS, HAVE NOT BEEN FIELD VERIFIED. CONTRACTOR MUST VERIFY EXISTING CONDITIONS BEFORE COMMENCING WORK.
 - THE EXACT LOCATION OF ALL UTILITIES SHALL BE FIELD VERIFIED BY THE CONTRACTOR BEFORE THE INSTALLATION OF ANY COMPONENT OF THE TRAFFIC SIGNAL SYSTEM.
 - THE CONTRACTOR SHALL CONTACT THE KANE COUNTY DIVISION OF TRANSPORTATION (630.584.1170) FOR TRAFFIC SIGNAL CABLE LOCATIONS A MINIMUM OF 48 HOURS IN ADVANCE (SATURDAYS, SUNDAYS, AND HOLIDAYS EXCLUDED) AT ANY LOCATION WITHIN THE RIGHT-OF-WAY.

SCHEDULE OF QUANTITIES - KIRK ROAD AND LEGACY BOULEVARD

PAY ITEM	UNIT	QUANTITY
MAINTENANCE OF EXISTING TRAFFIC SIGNAL INSTALLATION	EACH	1
REMOVE EXISTING TRAFFIC SIGNAL EQUIPMENT	EACH	1
VIDEO SYSTEM DETECTION PROCESSOR	EACH	1
MODIFY EXISTING CONTROLLER CABINET, SPECIAL MALFUNCTION MANAGEMENT UNIT	EACH	1
ETHERNET MANAGED SWITCH, TYPE 1	EACH	1
RE-OPTIMIZE TRAFFIC SIGNAL SYSTEM, LEVEL 2	EACH	1
CONFIRMATION BEACON	EACH	4
INTERSECTION VIDEO TRAFFIC MONITORING SYSTEM WITH PTZ CAMERA	EACH	1
OUTDOOR RATED NETWORK CABLE	FOOT	35

JACOBS
 ONE NORTH FRANKLIN
 CHICAGO IL, 60606
 312-251-3000

USER NAME =	DESIGNED - CH	REVISED -
PLDT SCALE =	DRAWN - MO, DI	REVISED -
PLDT DATE = 11/7/2011	CHECKED - KG	REVISED -
	DATE - #DATE	REVISED -

KANE COUNTY
 DIVISION OF TRANSPORTATION

INTERCONNECT PLAN
 KIRK ROAD (SHEET 10 OF 22)

SCALE: SHEET NO. OF SHEETS STA. TO STA.

F.A.P. RTE. 360	SECTION 10-00403-00-TL	COUNTY KANE	TOTAL SHEETS 72	SHEET NO. 42
FED. ROAD DIST. NO. (ILLINOIS) FED. AID PROJECT		CONTRACT NO. 63648		