

PLAN INCLUDED FOR REFERENCE

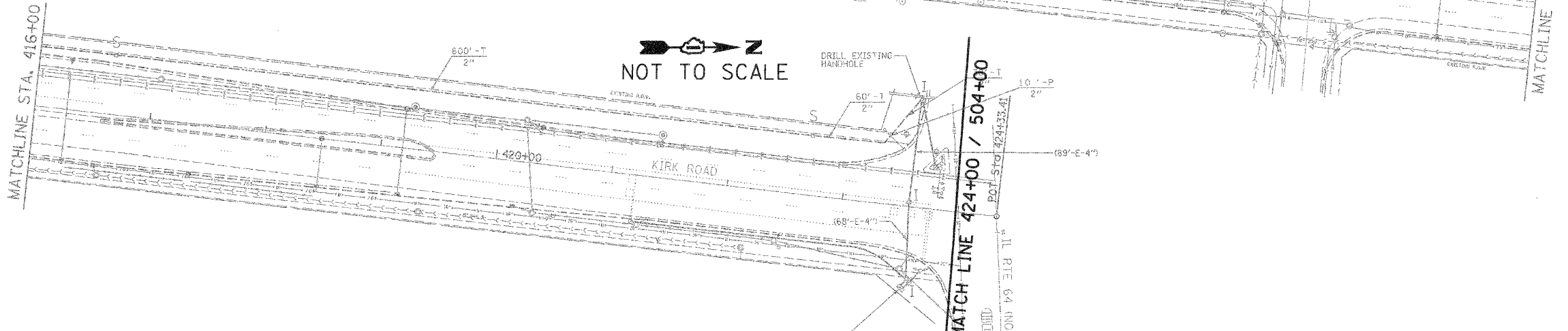

SEE SHEET 64 FOR TRAFFIC SIGNAL LEGEND

- NOTES:**
1. NEW ELEMENTS SHOWN IN BOLD. EXISTING ELEMENTS INCLUDED FOR REFERENCE ONLY (GRAYSCALE).
 2. EXISTING CONDITIONS, INCLUDING THE CONDITION AND AVAILABILITY OF CONDUITS, HAVE NOT BEEN FIELD VERIFIED. CONTRACTOR MUST VERIFY EXISTING CONDITIONS BEFORE COMMENCING WORK.
 3. THE EXACT LOCATION OF ALL UTILITIES SHALL BE FIELD VERIFIED BY THE CONTRACTOR BEFORE THE INSTALLATION OF ANY COMPONENT OF THE TRAFFIC SIGNAL SYSTEM.
 4. THE CONTRACTOR SHALL CONTACT THE KANE COUNTY DIVISION OF TRANSPORTATION (630.584.1170) FOR TRAFFIC SIGNAL CABLE LOCATIONS A MINIMUM OF 48 HOURS IN ADVANCE (SATURDAYS, SUNDAYS, AND HOLIDAYS EXCLUDED) AT ANY LOCATION WITHIN THE RIGHT-OF-WAY.

PROPOSED INTERCONNECT FIBER AND TRACER CABLE SHALL BE INSTALLED UP TO THIS CONTROLLER CABINET TO PROTECT THE ENDS OF CABLES. CONNECTION TO CONTROLLER AT IL RTE 64 SHALL BE MADE IN FUTURE BY OTHERS

RESTORATION OF WORK AREA, RESTORATION OF THE TRAFFIC SIGNAL WORK AREA SHALL BE INCIDENTAL TO THE RELATED PAY ITEM SUCH AS FOUNDATION, CONDUIT, HANDHOLE, TRENCH AND BACKFILL, ETC., AND NO EXTRA COMPENSATION SHALL BE ALLOWED. ALL ROADWAY SURFACES SUCH AS SHOULDERS, MEDIANS, SIDEWALKS, PAVEMENT, ETC. SHALL BE REPLACED IN KIND. ALL DAMAGE TO MOWED LAWNS SHALL BE REPLACED WITH AN APPROVED SOD, AND ALL DAMAGE TO UNMOWED FIELDS SHALL BE SEEDED IN ACCORDANCE WITH STANDARD SPECIFICATIONS 252 AND 250 RESPECTIVELY. SOD SHALL BE WATERED AS DIRECTED BY ENGINEER AND PER ACT 252.08 & 252.09 IN STP SPECS.

PA_201105067080708_CADD & GIS Files\702 Eval\Sheet\1111\Interconnect7.dgn

JACOBS
 ONE NORTH FRANKLIN
 CHICAGO IL, 60606
 312-251-3000

| | | |
|-----------------------|----------------|-----------|
| USER NAME = | DESIGNED - CH | REVISED - |
| PLOT SCALE = | DRAWN - MO, DI | REVISED - |
| PLOT DATE = 11/7/2011 | CHECKED - KG | REVISED - |
| | DATE - #DATE | REVISED - |

KANE COUNTY
 DIVISION OF TRANSPORTATION

INTERCONNECT PLAN
KIRK ROAD (SHEET 11 OF 22)

SCALE: SHEET NO. OF SHEETS STA. TO STA.

| F.A.P. RTE. | SECTION | COUNTY | TOTAL SHEETS | SHEET NO. |
|---|----------------|--------|--------------------|-----------|
| 360 | 10-00403-00-TL | KANE | 72 | 43 |
| FED. ROAD DIST. NO. ILLINOIS/FED. AID PROJECT | | | CONTRACT NO. 63648 | |