

- LEGEND**
- ① PORTLAND CEMENT CONCRETE PAVEMENT, 10" (JOINTED)
 - ② HOT-MIX ASPHALT SURFACE COURSE, MIX "D", N70, 2"
 - ③ LEVELING BINDER (MACHINE METHOD), N50
 - ④ HOT-MIX ASPHALT BASE COURSE, 8"
 - ⑤ HOT-MIX ASPHALT BASE COURSE WIDENING, 8"
 - ⑥ AGGREGATE SUBGRADE, 12"
 - ⑦ LONGITUDINAL CONSTRUCTION JOINT (INCLUDED IN COST OF PORTLAND CEMENT CONCRETE PAVEMENT, 10" JOINTED)
 - ⑧ TIE BARS (INCLUDED IN COST OF COMB CONC CURB & GUTTER)
 - ⑨ SAW CUTS
 - ⑩ HOT-MIX ASPHALT SHOULDERS, 8" (IN 3 LIFTS)
 - ⑪ HOT-MIX ASPHALT SHOULDERS, 6" (IN 2 LIFTS)
 - ⑫ AGGREGATE SHOULDERS TYPE B, 8"
 - ⑬ COMBINATION CONCRETE CURB AND GUTTER B6.24
 - ⑭ RAIL BASE
 - ⑮ TOPSOIL FURNISH AND PLACE, 4"
 - ⑯ STEEL PLATE BEAM GUARD RAIL, TYPE A
 - ⑰ STEEL RAIL (SPECIAL)
 - ⑱ GEOTECHNICAL FABRIC

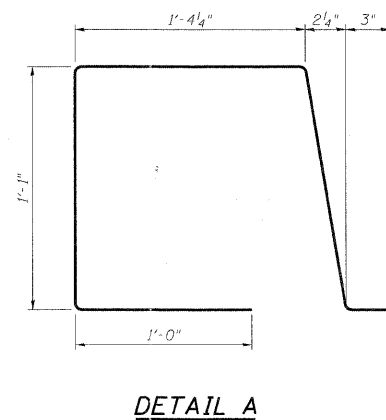
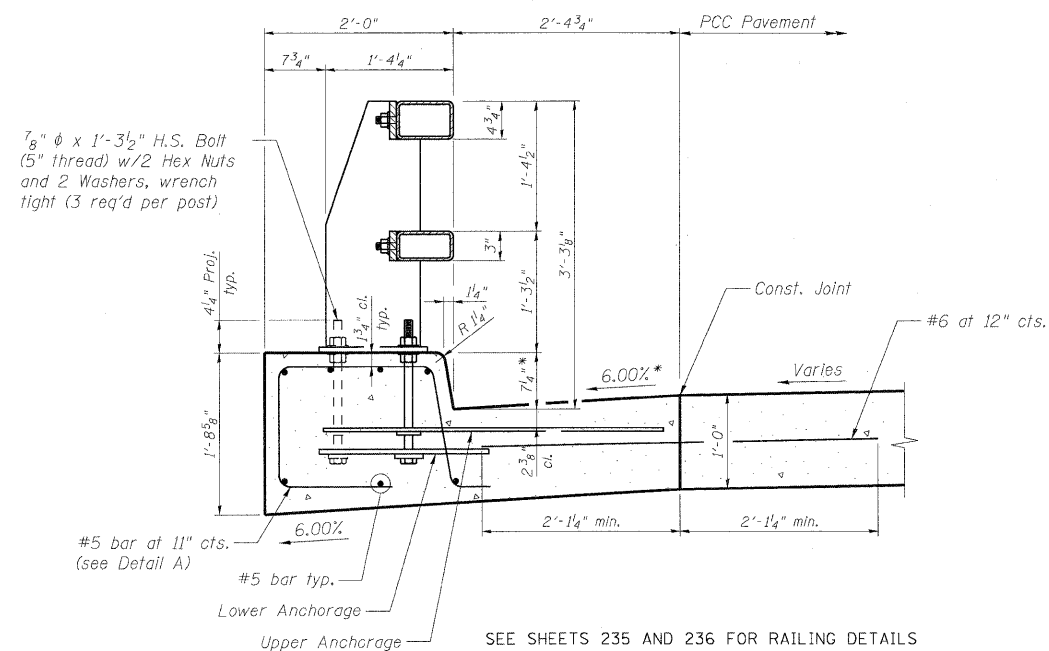

*GUTTER SLOPE AND CURB HEIGHT SHALL TRANSITION TO MEET THE CROSS SLOPES AND CURB HEIGHTS OF THE APPROACH SLABS OVER A DISTANCE OF 10'.

STRUCTURAL DESIGN TRAFFIC:		YEAR	2030
PV = 13300	SU = 1085	MU =	1085
ROAD/STREET CLASSIFICATION:		CLASS	II
PERCENT OF STRUCTURAL DESIGN TRAFFIC IN DESIGN LANE:			
P = 86%	S = 7%	M =	7%
TRAFFIC DATA:		ACTUAL TF =	15.29
		MINIMUM TF =	6.03
SUBGRADE SUPPORT RATING:		SSR =	POOR

PLOT SCALE: 1/8" = 1'-0" (SEE SHEET 235 FOR FULL SIZE) ... \prpln\ABC-shd-RDGT-tp-04.dgn ... 11/9/2011

FILE NAME =	DESIGNED - MAC	REVISED -
... \prpln\ABC-shd-RDGT-tp-04.dgn	DRAWN - TMB	REVISED -
USER NAME = tblank	CHECKED - RMT	REVISED -
PLOT DATE = 11/9/2011	DATE - 10/23/2011	REVISED -



CITY OF ST. CHARLES

**PROPOSED TYPICAL SECTIONS
RED GATE ROAD**

SCALE: NTS SHEET NO. 4 OF 4 SHEETS STA. TO STA.

F.A. RTE.	SECTION	COUNTY	TOTAL SHEETS	SHEET NO.
	04-00092-00-BR	KANE	440	32
CONTRACT NO. 63650				
ILLINOIS FED. AID PROJECT				