

MATCH LINE STA. 92+00.00

MATCH LINE STA. 98+00.00

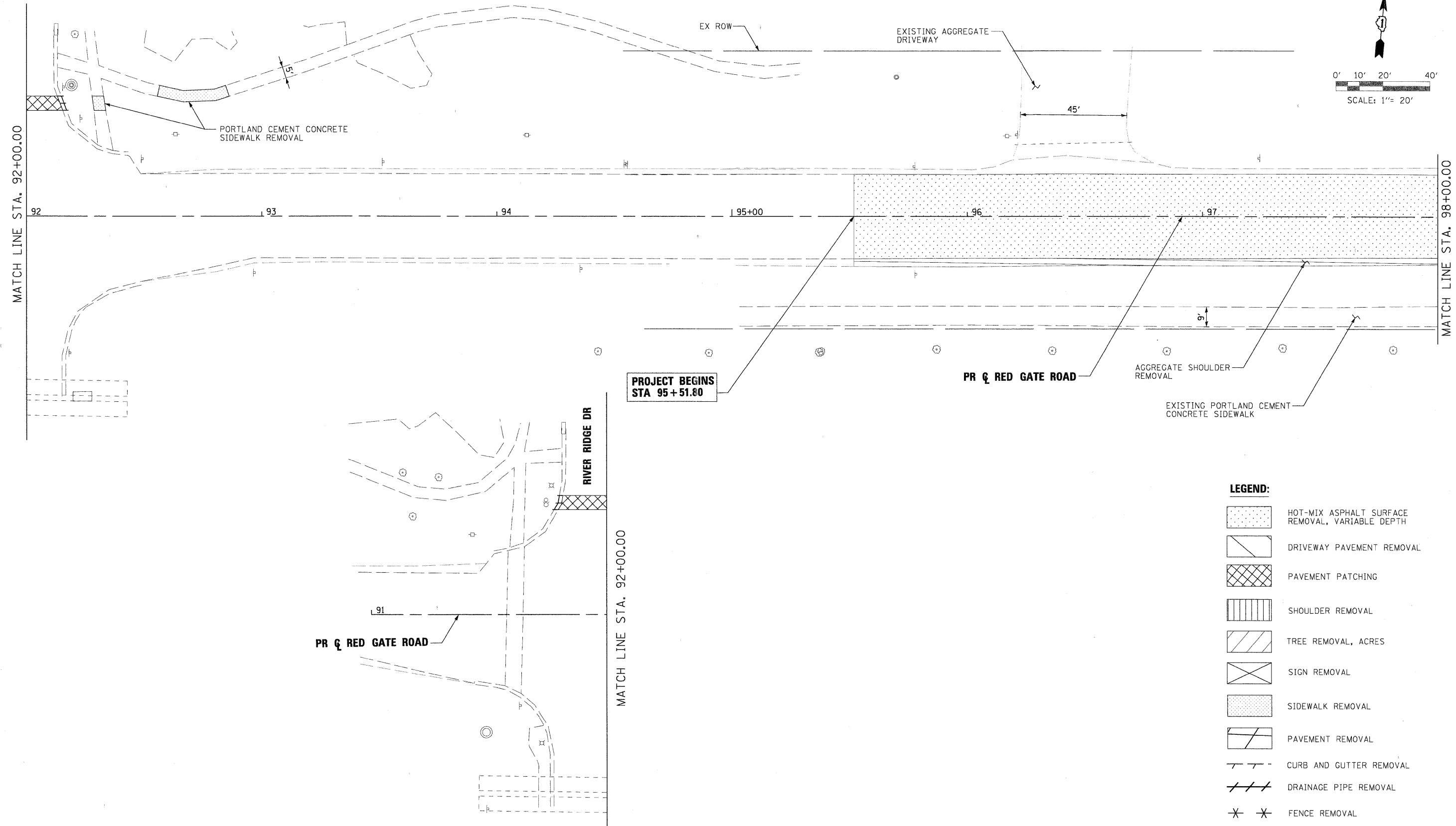

**LEGEND:**

- HOT-MIX ASPHALT SURFACE REMOVAL, VARIABLE DEPTH
- DRIVEWAY PAVEMENT REMOVAL
- PAVEMENT PATCHING
- SHOULDER REMOVAL
- TREE REMOVAL, ACRES
- SIGN REMOVAL
- SIDEWALK REMOVAL
- PAVEMENT REMOVAL
- CURB AND GUTTER REMOVAL
- DRAINAGE PIPE REMOVAL
- FENCE REMOVAL
- STRUCTURE REMOVAL
- EXISTING SIGNAL REMOVAL

PLOT DATE = 11/21/2011  
USER NAME = toddblank  
...\\prpln-abc-shr-RedGate-rem-01.cgn  
FILE NAME =  
DESIGNED - MAC  
DRAWN - TMB  
CHECKED - RMT  
DATE - 10/23/2011  
REVISED -  
REVISED -  
REVISED -  
REVISED -

|                                       |                   |           |
|---------------------------------------|-------------------|-----------|
| FILE NAME =                           | DESIGNED - MAC    | REVISED - |
| ...\\prpln-abc-shr-RedGate-rem-01.cgn | DRAWN - TMB       | REVISED - |
| USER NAME = toddblank                 | CHECKED - RMT     | REVISED - |
| PLOT DATE = 11/21/2011                | DATE - 10/23/2011 | REVISED - |



**CITY OF ST. CHARLES**

**ROADWAY REMOVAL PLAN  
RED GATE ROAD**

SCALE: 1"=20' SHEET NO. 1 OF 13 SHEETS STA. BOP TO STA. 98+00.00

| F.A. RTE.                 | SECTION        | COUNTY | TOTAL SHEETS | SHEET NO. |
|---------------------------|----------------|--------|--------------|-----------|
|                           | 04-00092-00-BR | KANE   | 440          | 39        |
| CONTRACT NO. 63650        |                |        |              |           |
| ILLINOIS FED. AID PROJECT |                |        |              |           |