

TOP PLAN

* 1 Set contains 4-s22(E) bars. See Section D-D.

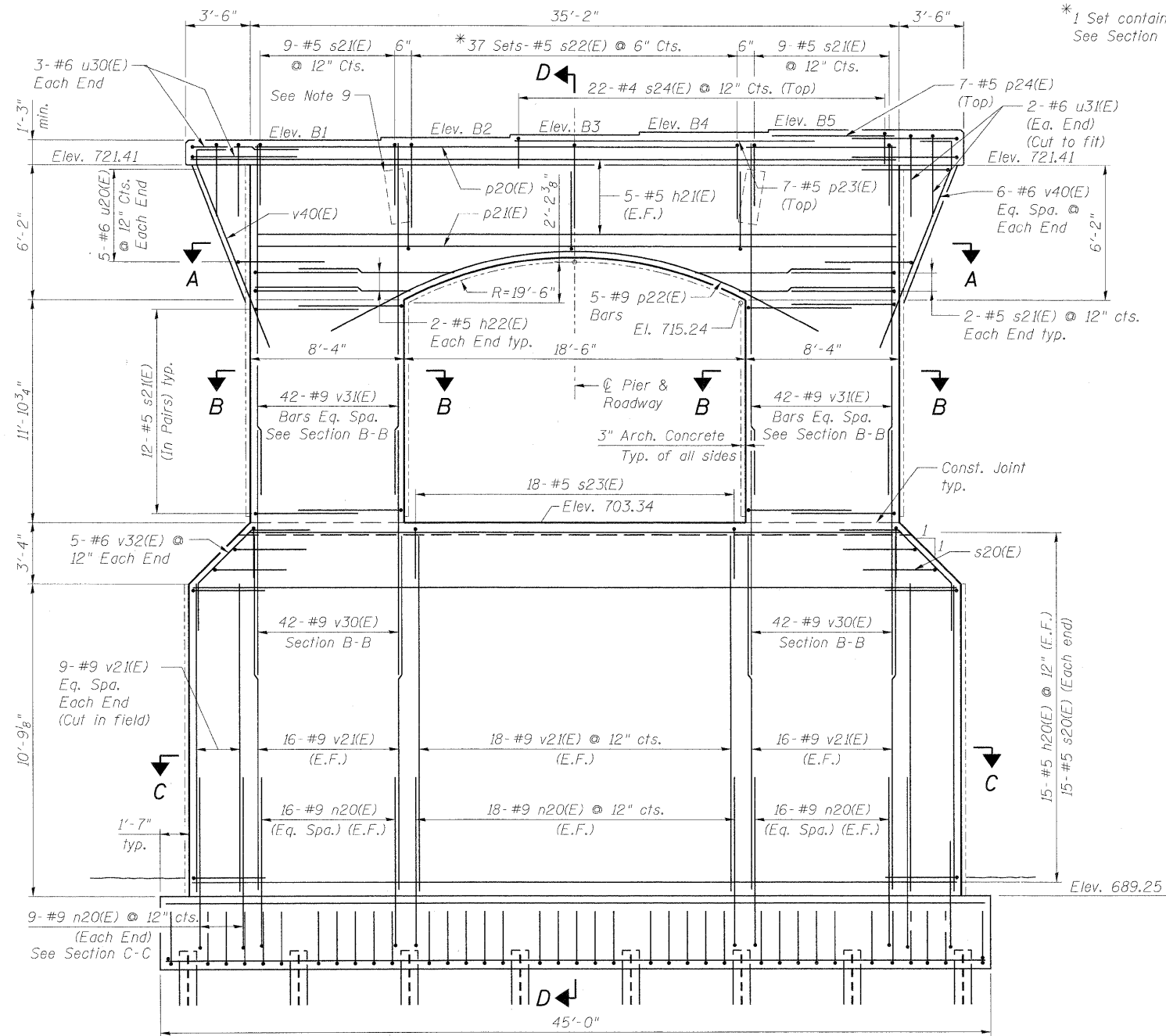

ELEVATION

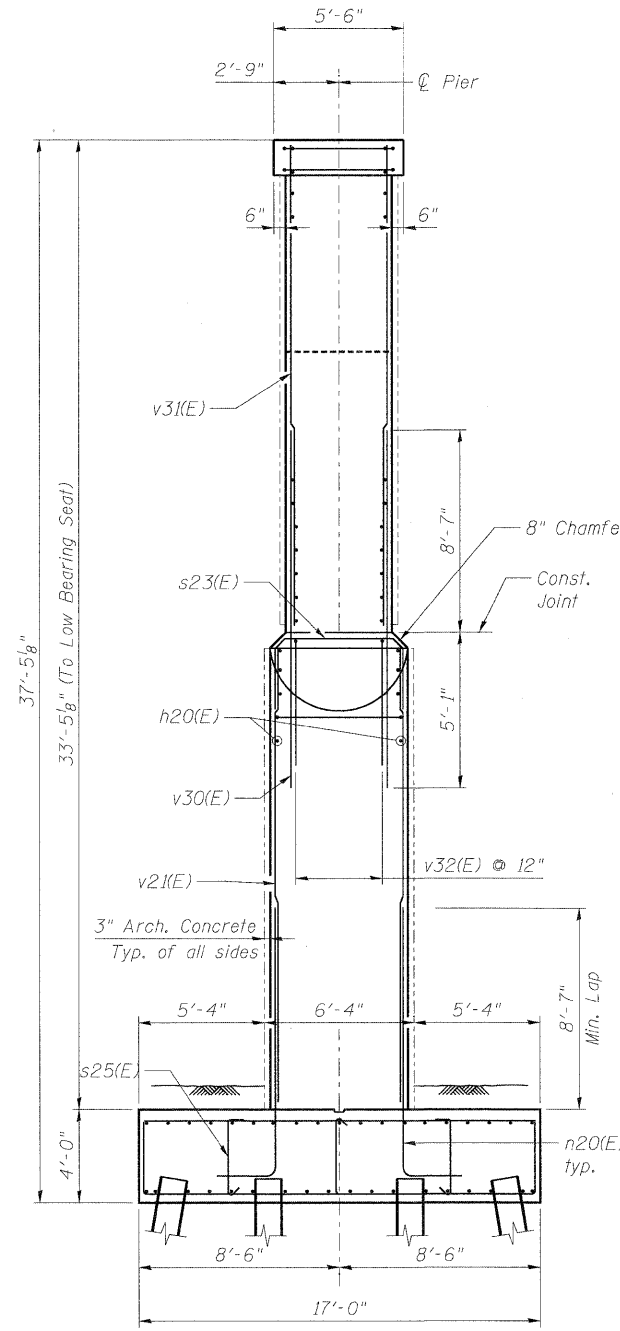

END VIEW

ELEVATION TABLE

B1	B2	B3	B4	B5
722.68	722.86	723.05	723.24	723.43

PILE DATA

Type: HP14x73 with pile shoes
 Nominal Required Bearing: 446 kips
 Factored Resistance Available: 245 kips
 Est. Length: 70 feet
 No. Production Piles: 31
 No. Test Piles: 1

NOTES:

- Use the following minimum lap lengths except as noted:
 #5: 3'-3" #6: 3'-10" #9: 8'-7"
- See sheet S44 for sections A-A thru D-D.
- Space reinforcement in cap to miss anchor bolts.
- Pour steps monolithically with cap.
- For footing plan, see sheet S45.
- For details of piles, see sheet S48.
- For Bill of Materials see sheet S46.
- Bridge seat elevations based on bearing heights shown on Sheets S35-S36. Any deviation from these heights shall be accounted for by the Contractor. Additional costs incurred due to these changes shall be at the Contractor's expense.
- See sheet SM11 of Multi-use Trail Bridge for Cable Anchorage Details.

benesch
 engineers · scientists · planners
 Alfred Benesch & Company
 205 North Michigan Avenue, Suite 2400
 Chicago, Illinois 60601
 312-565-0450 Job No. 10092

FILE NAME =	USER NAME = akoeschall	DESIGNED - MJF	REVISED -
0456024_041_PierDtl1.dgn		CHECKED - AJK	REVISED -
	PLOT SCALE =	DRAWN - RMC	REVISED -
	PLOT DATE = 11/9/2011	CHECKED - AJK	REVISED -



CITY OF ST. CHARLES

PIER 1 DETAILS
STRUCTURE NO. 045-6024 RED GATE ROAD OVER THE FOX RIVER
 SHEET NO. S41 OF S56 SHEETS

F.A.I. RTE.	SECTION	COUNTY	TOTAL SHEETS	SHEET NO.
	04-00092-00-BR	KANE	440	263
CONTRACT NO. 63650			ILLINOIS FED. AID PROJECT	

x:\10000s\10092\engineering\documents\redgatephase1\groverfoxriver\final\plans\0456024_041_PierDtl1.dgn 5:04:28 PM 11/9/2011