

DATE	BY
SURVEYED	PLOTTED
NOTE BOOK	AREAS CHECKED
NO.	

DATE	BY
SURVEYED	PLOTTED
NOTE BOOK	AREAS CHECKED
NO.	

PLOT SCALE: 1/8" = 10'-0" (PLOT) FULL SIZE: 1/4" = 10'-0" (LOCAL WORKSPACE) (1/4" DRAWING TITLE BLOCK)

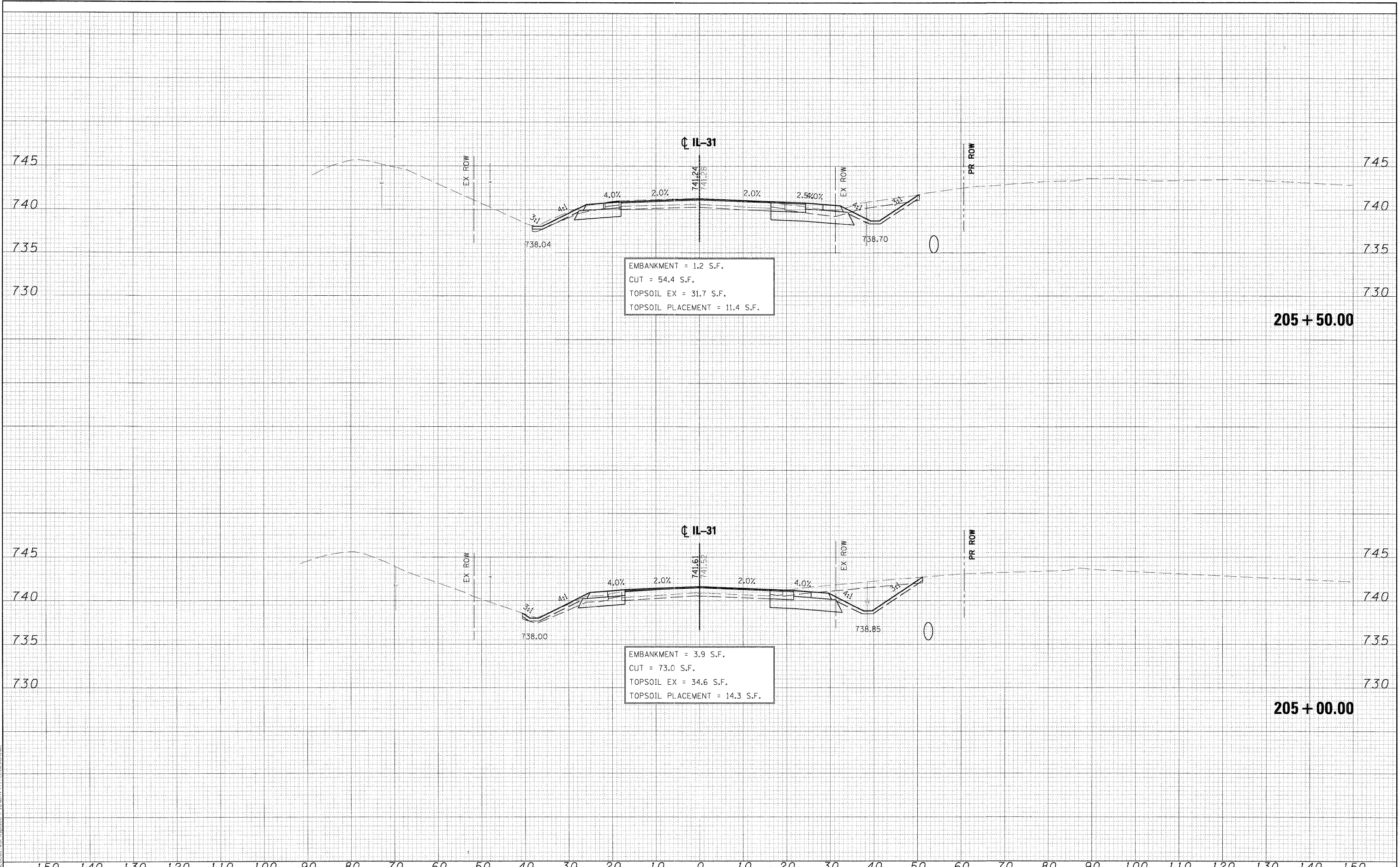

EMBANKMENT = 1.2 S.F.  
 CUT = 54.4 S.F.  
 TOPSOIL EX = 31.7 S.F.  
 TOPSOIL PLACEMENT = 11.4 S.F.

EMBANKMENT = 3.9 S.F.  
 CUT = 73.0 S.F.  
 TOPSOIL EX = 34.6 S.F.  
 TOPSOIL PLACEMENT = 14.3 S.F.

150 140 130 120 110 100 90 80 70 60 50 40 30 20 10 0 10 20 30 40 50 60 70 80 90 100 110 120 130 140 150

FILE NAME =	DESIGNED - MAC	REVISED -
...\\Cross_sections\IL31-pxs.dgn	DRAWN - TMB	REVISED -
USER NAME = macieian	CHECKED - RMT	REVISED -
PLOT DATE = 11/10/2011	DATE - 10/23/2011	REVISED -



CITY OF ST. CHARLES

IL 31  
CROSS-SECTIONS

SCALE: SHEET NO. 5 OF 19 SHEETS STA. 205+00.00 TO STA. 205+50.00

F.A. RTE.	SECTION	COUNTY	TOTAL SHEETS	SHEET NO.
	04-00092-00-BR	KANE	440	370
			CONTRACT NO. 63650	
ILLINOIS FED. AID PROJECT				