

STRUCTURE NO.	STATION	OFFSET	TYPE	RIM EL.	INVERT ELEVATION
1	55+14	14' LT	MANHOLES, TYPE A, 5' DIA TYPE 1 FRAME, CLOSED LID	621.50	612.70 (36' SE) 613.20 (30' NW) 617.05 (10' NE) 617.40 (10' W)
2	55+23	20' LT	CATCH BASINS, TYPE A 4' DIA, TYPE 1 FRAME, OPEN LID	621.25	617.50 (10' E)
3	55+24	20' RT	CATCH BASINS, TYPE A 4' DIA, TYPE 1 FRAME, OPEN LID	621.15	617.40 (10' SW)

EXISTING TOPOGRAPHY

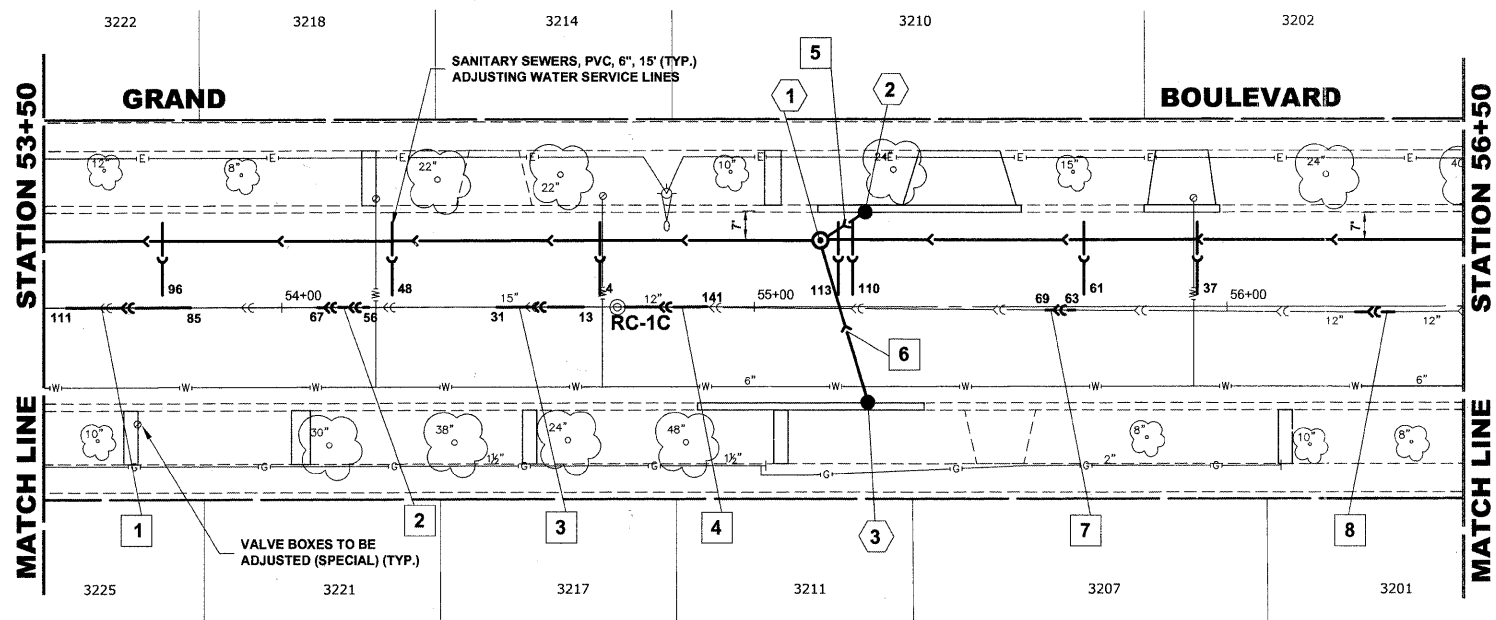

PIPE NO.	LENGTH	PAY ITEM	SLOPE	C.Y.T.B.
1	26'	15" PVC CS PIPE REPL	0.145%	7.7
2	11'	15" PVC CS PIPE REPL	0.145%	3.1
3	18'	15" PVC CS PIPE REPL	0.145%	5.0
4	16'	12" PVC CS PIPE REPL	0.194%	4.0
5	10'	STORM SEW CL B 2 10	1.00%	0.7
6	35'	STORM SEW CL B 2 10	1.00%	3.1
7	6'	12" PVC CS PIPE REPL	0.194%	1.5
8	8'	12" PVC CS PIPE REPL	0.194%	2.0

NOTE :
FIGURES SHOWN AT THE END OF THE 6" SANITARY SEWER SERVICES INDICATE THE DISTANCE THE SERVICE IS FROM THE COMBINED SEWER MANHOLE.

PROPOSED IMPROVEMENTS

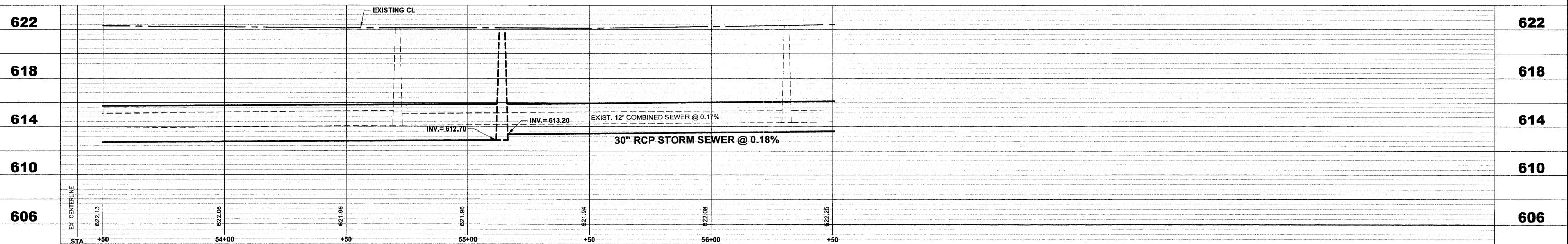

<p>HANCOCK ENGINEERING Civil Engineers Municipal Consultants Established 1911</p>	USER NAME - DESIGNED - WOP, JG DRAWN - MK, DMM CHECKED - WOP, JG DATE - 10-24-11	REVISED - REVISED - REVISED - REVISED -	STATE OF ILLINOIS DEPARTMENT OF TRANSPORTATION	GRAND BOULEVARD UTILITY PLAN AND PROFILE	ROUTE NO. - SECTION - COUNTY - TOTAL SHEETS - SHEET NO. -
	PLOT SCALE - PLOT DATE -	SCALE: 1"=20'H, 1"=4'V. SHEET NO. 7 OF 10 SHEETS STA. 53+50 TO STA. 56+50			FIELD BOOK NO. - FED. ROAD DIST. NO. 1 ILLINOIS FED. AID PROJECT M-9003(875)
	9913 Riverwood Road Woodbury, Illinois 61890-2798 Phone: 708/965-6300 Fax: 708/965-6322	CONTRACT NO. 63651			E.H.E. PROJECT NO. 125-09-23201
	STA. +50 54+00 +50 55+00 +50 56+00 +50	622 618 614 610 606			622 618 614 610 606

Drawing file: W:\Projects\12509232 - Grand Blvd. Design Engineering\Grand Blvd\Grand Blvd.dwg Oct. 26, 2011 - 11:47am