

STRUCTURE NO.	STATION	OFFSET	TYPE	RIM EL.	INVERT ELEVATION
1	14+35	21' RT	CATCH BASINS, TYPE A 4' DIA, TYPE 1 FRAME, OPEN LID	619.95	616.20 (10' NE)
2	14+60	5' LT	MANHOLES, TYPE A 7' DIA TYPE 1 FRAME, CLOSED LID	620.35	609.14 (38'X60' ESE) 609.20 (48' W) 615.85 (10' SW)
3	15+04	87' RT	INLETS, TYPE A TYPE 1 FRAME, OPEN LID	619.90	616.50 (10' E)
4	14+89	11' LT	CATCH BASINS, TYPE A 4' DIA, TYPE 1 FRAME, OPEN LID	620.00	616.10 (10' SE)
5	15+10	13' RT	MANHOLES, TYPE A 7' DIA TYPE 1 FRAME, CLOSED LID	620.90	609.10 (38'X60' E) 609.10 (38'X60' WNW) 615.65 (10' NE) 615.75 (10' NW)
6	15+38	33' LT	CATCH BASINS, TYPE A 4' DIA, TYPE 1 FRAME, OPEN LID	620.10	616.20 (10' SW)
7	15+35	68' RT	CATCH BASINS, TYPE A 4' DIA, TYPE 1 FRAME, OPEN LID	619.70	616.20 (12' NNW) 616.20 (10' WSW)
8	15+30	45' RT	VALVE VAULTS, TYPE A4' DIA, TYPE 1 FRAME, CLOSED LID	621.00	616.00 (T/P)

PIPE NO.	LENGTH	PAY ITEM	SLOPE	CY.T.B.
1	35'	STORM SEW CL B 2 10	1.00%	1.5
2	50'	SS CL A 2 EQRS 48	0.20%	97.1
3	37'	STORM SEW CL B 2 10	1.00%	0.0
4	60'	STORM SEW CL B 2 12	1.00%	3.4
5	35'	STORM SEW CL B 2 10	1.00%	2.4
6	55'	STORM SEW CL B 2 10	1.00%	4.6
7	9'	15' PVC CS PIPE REPL	0.145%	1.7
8	6'	12' PVC CS PIPE REPL	0.194%	2.8
9	6'	12' PVC CS PIPE REPL	0.194%	0.2
10	331'	SS CL A 2 EQRS 48	0.082%	622.6
11	15'	15' PVC CS PIPE REPL	0.145%	2.5
12	15'	15' PVC CS PIPE REPL	0.145%	2.9

PROPOSED IMPROVEMENTS

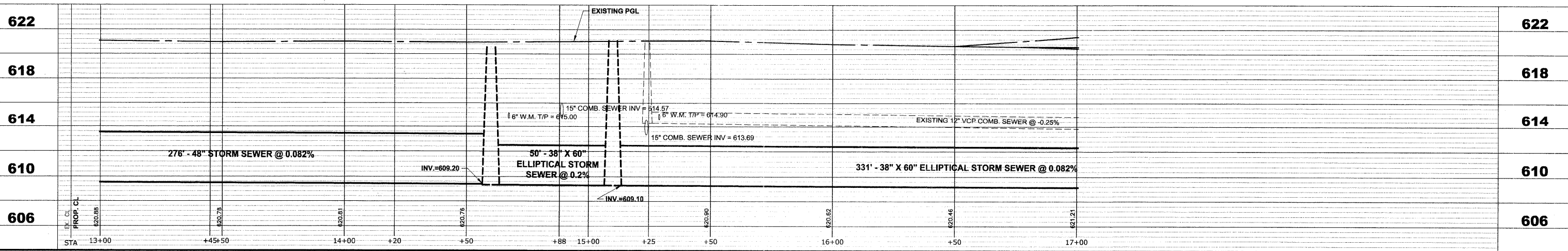

<p>HANCOCK ENGINEERING Civil Engineers Municipal Consultants Established 1911</p>	USER NAME - PLOT SCALE - PLOT DATE -	DESIGNED - WOP, JG DRAWN - MK, DMM CHECKED - WOP, JG DATE - 10-24-11	REVISED - REVISED - REVISED - REVISED -	STATE OF ILLINOIS DEPARTMENT OF TRANSPORTATION	MONROE AVENUE UTILITY PLAN AND PROFILE	ROUTE NO. - SECTION - COUNTY - TOTAL SHEETS - SHEET NO. -
	933 Riverside Blvd Wheeling, IL 60091-7176 Phone: 708.965-0900 Fax: 708.965-1212	SCALE: 1"=20'H, 1"=4'V. SHEET NO. 5 OF 8 SHEETS STA. 13+00 TO STA. 17+00	FAU 1694 07-00122-01-PV COOK 86 48 FIELD BOOK NO. -/AERIALS/ILL CONTRACT NO. 63651 FED. ROAD DIST. NO. 1 ILLINOIS FED. AID PROJECT M-9003(875) E.H.E. PROJECT NO. 125-09-23201			

Drawing file: W:\Projects\12509232 - Grand Blvd. Design Engineer\Grand Blvd\Grand Blvd.dwg Oct. 26, 2011 - 11:31am