

STRUCTURE NO.	STATION	OFFSET	TYPE	RM EL.	INVERT ELEVATION
1	18+45	13' RT	MANHOLES, TYPE A, 7' DIA TYPE 1 FRAME, CLOSED LID	619.50	608.83 (38" X 60" E-W) 614.78 (12"S) 613.62 (12"N)

EXISTING TOPOGRAPHY

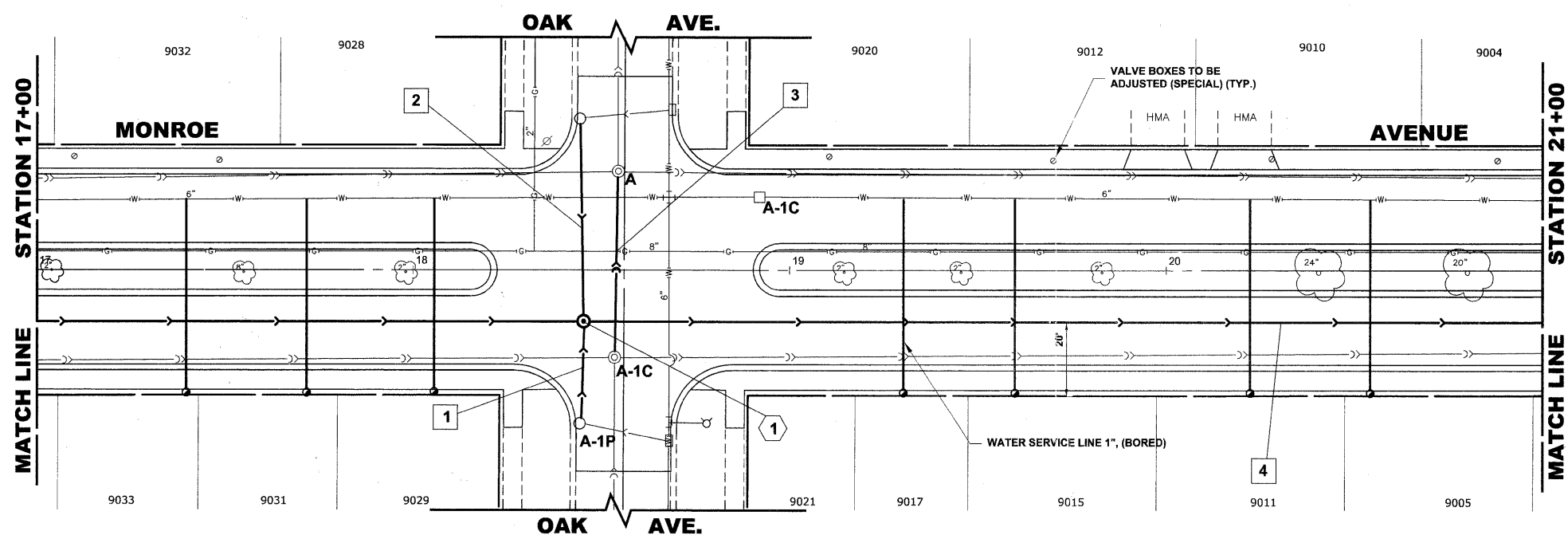

PIPE NO.	LENGTH	PAY ITEM	SLOPE	C.Y.T.B.
1	27'	STORM SEW CL B 2 12	1.00%	1.3
2	53'	STORM SEW CL B 2 12	0.45%	3.2
3	45'	15" PVC CS PIPE REPL	0.145%	7.5
4	340'	SS CL A 2 EQRS 48	0.082%	559.9

PROPOSED IMPROVEMENTS

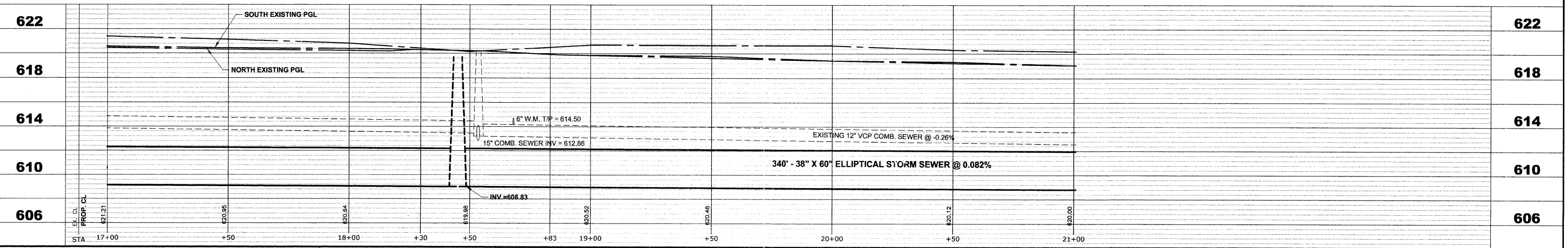

Drawing file: W:\Projects\12509232 - Grand Blvd. Design - Engineer\Ground Blvd\Ground Blvd.dwg Oct 26, 2011 - 11:33am



USER NAME -	DESIGNED - WOP, JG	REVISED -
PLOT SCALE -	DRAWN - MK, DMM	REVISED -
PLOT DATE -	CHECKED - WOP, JG	REVISED -
	DATE - 10-24-11	REVISED -

**STATE OF ILLINOIS
DEPARTMENT OF TRANSPORTATION**

**MONROE AVENUE
UTILITY PLAN AND PROFILE**

SCALE: 1"=20'H. 1"=4'V. SHEET NO. 6 OF 8 SHEETS STA. 17+00 TO STA. 21+00

ROUTE NO.	SECTION	COUNTY	TOTAL SHEETS	SHEET NO.
FAU 1694	07-00122-01-PV	COOK	86	49
FIELD BOOK NO.	CONTRACT NO.			
-JAERIALS/LL	63651			
FED. ROAD DIST. NO. 1 ILLINOIS FED. AID PROJECT M-9003(875)				
E.H.E. PROJECT NO. 125-09-23201				