

STRUCTURE NO.	STATION	OFFSET	TYPE	RIM EL.	INVERT ELEVATION
1	21+78	42' LT	CATCH BASINS, TYPE A, 4' DIA, TYPE 1 FRAME, OPEN LID	617.70	614.36 (10' E) 614.36 (12' SSE)
2	21+89	13' RT	MANHOLES, TYPE A, 7' DIA TYPE 1 FRAME, CLOSED LID	618.30	608.55 (38"X60" VV) 608.55 (48" E) 613.60 (12" SW) 614.11 (12" NNW)
3	21+89	24' LT	COMBINED SEWER MANHOLE, 4' DIA TYPE 1 FRAME, CLOSED LID	618.38	611.78 (15" N) 611.78 (12" S) 611.54 (12" E) 611.78 (12" W)
4	22+02	42' LT	INLETS, TYPE A TYPE 1 FRAME, OPEN LID	617.60	614.50 (10' W)
5	24+00	24' RT	CATCH BASINS, TYPE A, 4' DIA, TYPE 1 FRAME, OPEN LID	617.95	614.00 (10' NE)
6	24+04	13' RT	MANHOLES, TYPE A, 6' DIA TYPE 1 FRAME, CLOSED LID	618.25	608.38 (48" E-W) 613.88 (10' SW)

**EXISTING TOPOGRAPHY**

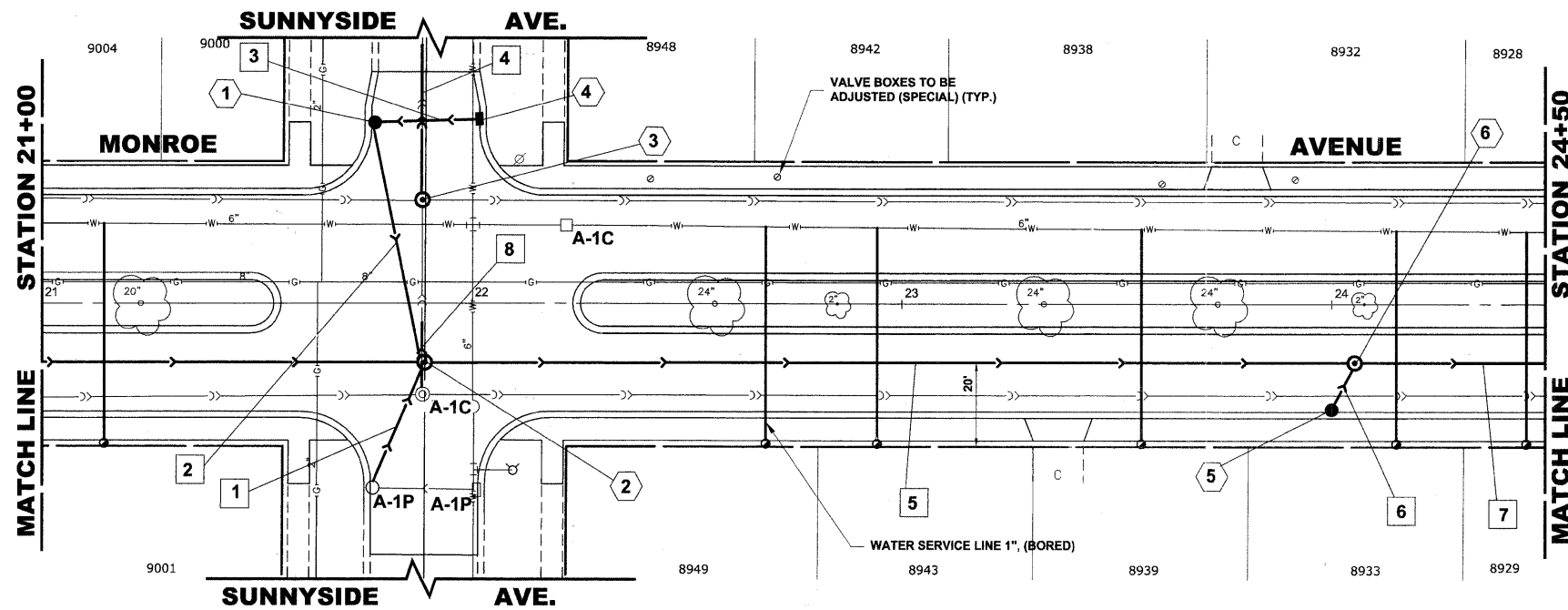

PIPE NO.	LENGTH	PAY ITEM	SLOPE	C.Y.T.B.
1	32'	STORM SEW CL B 2 12	1.00%	1.3
2	56'	STORM SEW CL B 2 12	0.45%	0.0
3	24'	SS DI T1 10	0.60%	0.0
4	35'	15" PVC CS PIPE REPL	0.145%	5.7
5	210'	SS RG CL A 2 48	0.082%	325.3
6	12'	STORM SEW CL B 2 10	1.00%	0.5
7	101'	SS RG CL A 2 48	0.082%	163.6
8	15'	12" PVC CS PIPE REPL	0.194%	2.0

**PROPOSED IMPROVEMENTS**

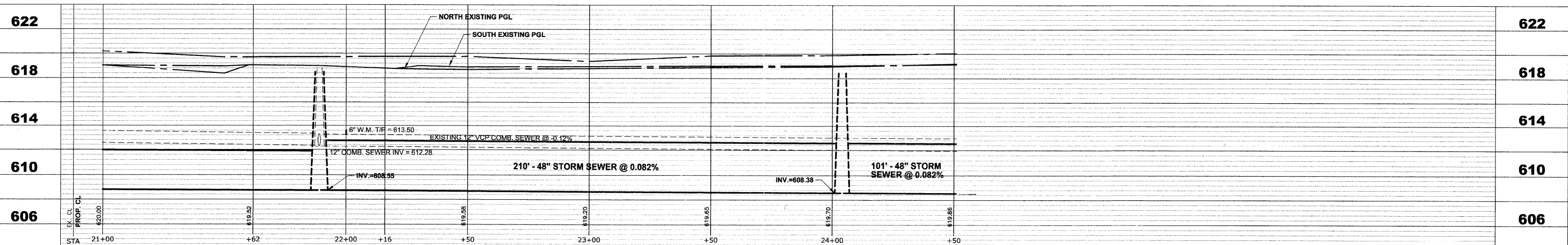

<b>HANCOCK ENGINEERING</b> Civil Engineers Municipal Consultants Established 1911	USER NAME -	DESIGNED - WOP, JG	REVISED -	<b>STATE OF ILLINOIS</b> <b>DEPARTMENT OF TRANSPORTATION</b>	<b>MONROE AVENUE</b> <b>UTILITY PLAN AND PROFILE</b>	ROUTE NO.	SECTION	COUNTY	TOTAL SHEETS	SHEET NO.
	PLOT SCALE -	DRAWN - MK, DMM	REVISED -			FAU 1684	07-00122-01-PV	COOK	86	50
	PLOT DATE -	CHECKED - WOP, JG	REVISED -			FIELD BOOK NO. -JAERIALS/ILL	CONTRACT NO. 63651			
	DATE - 10-24-11	DATE -	REVISED -			FED. ROAD DIST. NO. 1 ILLINOIS	FED. AID PROJECT M-9003(875)			

SCALE: 1"=20'H, 1"=4'V. SHEET NO. 7 OF 8 SHEETS STA. 21+00 TO STA. 24+50

E.H.E. PROJECT NO. 125-09-23201

Drawing file: W:\Projects\12509232 - Grand Blvd. Design - Engineer\Grand Blvd\Grand Blvd.dwg Oct. 26, 2011 - 11:34am