

LANDSCAPING NOTES

SODDING:
 ALL DISTURBED AREAS INDICATED ON CROSS SECTION OR LANDSCAPING PLANS TO BE SODDED, INCLUDING FERTILIZER NUTRIENTS*, AND SUPPLEMENTAL WATERING WHICH IS TO BE USED AFTER THE INITIAL WATERING (AS SPECIFIED AND AS DIRECTED BY THE ENGINEER) AT THE RATE OF 10 GALLONS PER SQUARE YARD SODDING. SODDED SLOPES WHICH ARE 2:1 OR STEEPER SHALL BE STAKED. (PROVIDE A 3" STRIP AROUND CATCH BASINS IN SEEDING AREAS).

FERTILIZER NUTRIENTS* FOR SODDING:
 USE A FERTILIZER WITH A 1:1:1 RATIO PER ACRE:
 60 LBS. NITROGEN FERTILIZER NUTRIENT
 60 LBS. PHOSPHORUS FERTILIZER NUTRIENT
 60 LBS. POTASSIUM FERTILIZER NUTRIENT
 TOTAL: 180 LBS. PER ACRE

4" TOP SOIL LAYER:
 SOIL SHALL BE SPREAD AS INDICATED ON THE TYPICAL CROSS SECTIONS.
 A MINIMUM OF GRADING TO BE PERMITTED WITHIN AN APPROXIMATE RADIUS OF 6' FROM ALL TREES TO BE SAVED AS DETERMINED BY THE ENGINEER.

MULCH:
 MULCH TO BE PLACED AROUND ALL TREES LOCATED IN AREAS THAT ARE TO BE SODDED.

TREE REPLACEMENT			
COMMON NAME	SCIENTIFIC NAME	SIZE	QUANTITY
ARISTOCRAT CALLERY PEAR	PYRUS CALLERYANA ARISTOCRAT	3" CALIPER	3

NOTE: ALL TREES BALLED AND BURLAPPED

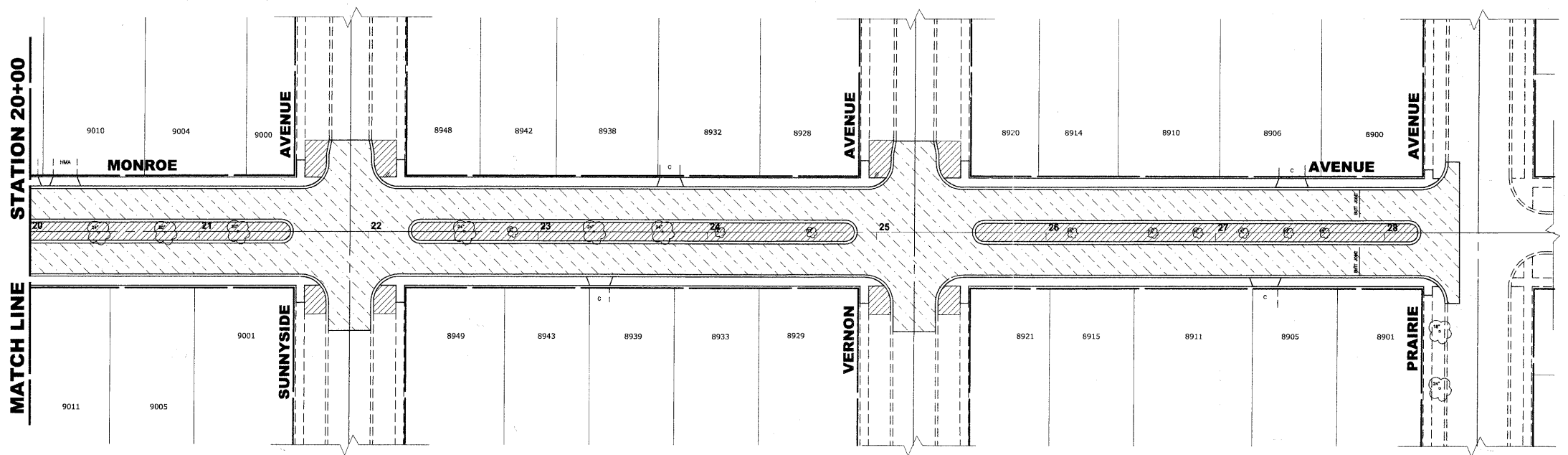

LEGEND OF SYMBOLS

SYMBOL	DESCRIPTION
	PROPOSED HOT-MIX ASPHALT AREA
	PROPOSED CONCRETE AREA
	PROPOSED SODDED PARKWAY
	PROPOSED DECORATIVE BRICK SIDEWALK
	PROPOSED BIOSWALE

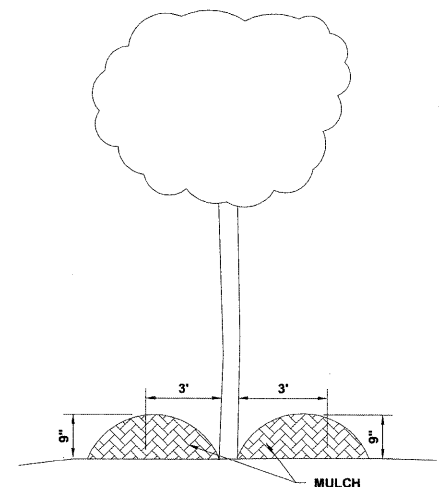

TREE MULCH DETAIL

Drawing file: W:\Projects\12509232 - Grand Blvd. Design Engineer\Grand Blvd 40 - Streets.dwg Oct. 24, 2011 1:48pm



USER NAME -	DESIGNED - WOP, JG	REVISED -
PLOT SCALE -	DRAWN - MK, DMM	REVISED -
PLOT DATE -	CHECKED - WOP, JG	REVISED -
	DATE - 10-24-11	REVISED -

**STATE OF ILLINOIS
 DEPARTMENT OF TRANSPORTATION**

ASPHALT AND LANDSCAPING PLAN

SCALE: 1" = 40'

SHEET NO. 4 OF 4 SHEETS STA. - TO STA. -

ROUTE NO. FAU 1694	SECTION 07-00122-01-PV	COUNTY COOK	TOTAL SHEETS 86	SHEET NO. 67
FIELD BOOK NO. -/AERIALS/ILL		CONTRACT NO. 63651		
FED. ROAD DIST. NO. 1 ILLINOIS FED. AID PROJECT M-9003(875)				

E.H.E. PROJECT NO. 125-09-23201