

F.A.U. RTE.	SECTION	COUNTY	TOTAL SHEETS	SHEET NO.
2542	11-00057-00-RS	DUPAGE	32	1

CONTRACT NO. 63653

**INDEX OF SHEETS**

- 1 COVER SHEET AND INDEX OF SHEETS
- 2 GENERAL NOTES AND HIGHWAY STANDARDS
- 3 SUMMARY OF QUANTITIES
- 4 TYPICAL SECTIONS
- 5 ALIGNMENT, TIES AND BENCHMARKS
- 6-8 IMPROVEMENT PLAN
- 9-11 LANDSCAPING AND EROSION CONTROL PLANS
- 12-14 PAVEMENT MARKING PLANS
- 15 BD-22 PAVEMENT PATCHING FOR HMA SURFACED PAVEMENT
- 16 BD-32 BUTT JOINT AND HMA TAPER DETAILS
- 17 TC-10 TRAFFIC CONTROL AND PROTECTION FOR SIDE ROADS, INTERSECTIONS AND DRIVEWAYS
- 18 TC-13 DISTRICT ONE TYPICAL PAVEMENT MARKINGS
- 19 TC-16 PAVEMENT MARKING LETTERS AND SYMBOLS FOR TRAFFIC STAGING
- 20 TC-22 ARTERIAL ROAD INFORMATION SIGN
- 21 TC-26 DRIVEWAY ENTRANCE SIGNING
- 22-32 CROSS SECTIONS

**TRAFFIC DATA**

ADT:  
5,300 VPD (2010)                      8,000 VPD (2030)

**POSTED SPEED**

35 MPH (EXISTING)                      40 MPH (EXISTING)  
35 MPH (PROPOSED)                      40 MPH (PROPOSED)

**FUNCTIONAL CLASSIFICATION**

COLLECTOR - RURAL

**STATE OF ILLINOIS**  
**DEPARTMENT OF TRANSPORTATION**  
**DIVISION OF HIGHWAYS**  
**PLANS FOR PROPOSED**  
**FEDERAL AID HIGHWAY**

**FAU ROUTE 2542 (FAIR OAKS ROAD)**  
**FAP ROUTE 0307 (NORTH AVENUE) TO FAP ROUTE 0367 (ARMY TRAIL ROAD)**  
**RESURFACING**  
**SECTION 11-00057-00-RS**  
**PROJECT M-9003(830)**  
**VILLAGE OF CAROL STREAM**  
**DUPAGE COUNTY**  
**JOB NO. C-91-573-11**

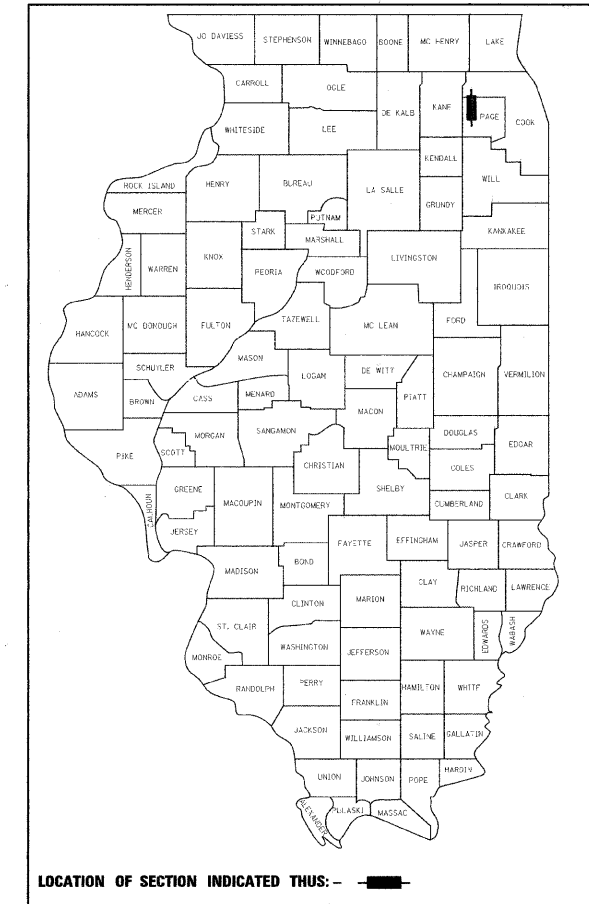

PROJECT IS LOCATED IN THE VILLAGE OF CAROL STREAM

PROJECT PROJECT ENDS STATION 581+59

PROJECT PROJECT BEGINS STATION 500+42

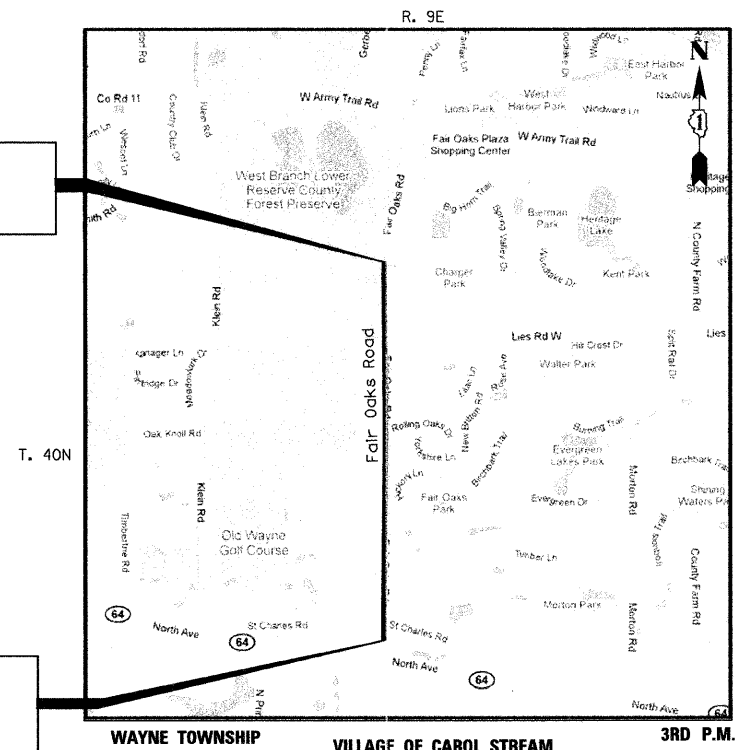

**LOCATION MAP**

NOT TO SCALE  
PROJECT LENGTH (GROSS AND NET)  
8,117 FT (1.54 MILES)

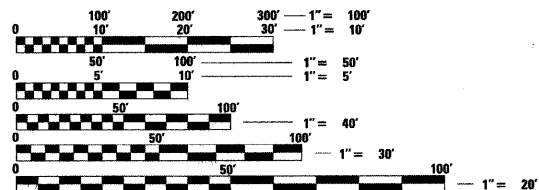

FULL SIZE PLANS HAVE BEEN PREPARED USING STANDARD ENGINEERING SCALES. REDUCED SIZED PLANS WILL NOT CONFORM TO STANDARD SCALES. IN MAKING MEASUREMENTS ON REDUCED PLANS, THE ABOVE SCALES MAY BE USED.

J.U.L.I.E.  
JOINT UTILITY LOCATION INFORMATION FOR EXCAVATION  
1-800-892-0123  
OR 811

**CONTRACT NO. 63653**

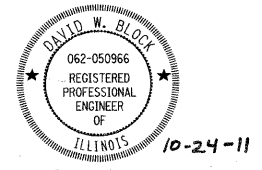

DAVID W. BLOCK, P.E.  
NO. 062-050966  
EXP. DATE 11/30/11

STATE OF ILLINOIS  
DEPARTMENT OF TRANSPORTATION  
DIVISION OF HIGHWAYS

APPROVED ON: OCTOBER 24, 2011

*[Signature]*  
VILLAGE OF CAROL STREAM, DIRECTOR OF ENGINEERING SERVICES

PASSED NOVEMBER 1, 2011

*[Signature]*  
DISTRICT 1 ENGINEER OF LOCAL ROADS & STREETS

RELEASING FOR BID  
BASED ON LIMITED  
REVIEW NOVEMBER 2, 2011

*[Signature]*  
DEPUTY DIRECTOR OF HIGHWAYS, REGION 1 ENGINEER

**PRINTED BY THE AUTHORITY  
OF THE STATE OF ILLINOIS**



**GENERAL NOTES**

- ALL REFERENCES TO "STANDARD SPECIFICATIONS" IN THESE GENERAL NOTES SHALL BE INTERPRETED TO MEAN "STANDARD SPECIFICATIONS FOR ROAD AND BRIDGE CONSTRUCTION" ADOPTED BY THE ILLINOIS DEPARTMENT OF TRANSPORTATION, JANUARY 1, 2012.
- ALL REFERENCES TO "ENGINEER" SHALL BE INTERPRETED TO MEAN THE RESIDENT ENGINEER.
- IT IS THE CONTRACTOR'S RESPONSIBILITY TO ASCERTAIN EXISTING FIELD CONDITIONS PRIOR TO BIDDING ON THE PROJECT.
- BEFORE STARTING EXCAVATION, THE CONTRACTOR SHALL CALL "JULIE" (JOINT UTILITY LOCATION INFORMATION FOR EXCAVATION) AT 8-1-1 AND THE VILLAGE OF CAROL STREAM AT 630-665-7553 FOR FIELD LOCATIONS OF BURIED UTILITIES (48 HOURS NOTIFICATION IS REQUIRED).
- THE CONTRACTOR WILL NOT BE ALLOWED TO SET UP A YARD OR FIELD OFFICE ON STATE OR VILLAGE PROPERTY OR ROW WITHOUT WRITTEN PERMISSION FROM THE ENGINEER.
- SAW CUTTING OF PAVEMENTS, SIDEWALK, ETC. SHALL BE TO FULL DEPTH AND SHALL RESULT IN A CLEAN STRAIGHT EDGE ON THE PORTION REMAINING. ALL SAW CUTTING SHALL BE CONSIDERED INCLUDED IN THE COST OF THE ITEM REMOVED.
- THE CONTRACTOR SHALL PROTECT AND CAREFULLY PRESERVE ALL SECTION OR SUBSECTION MONUMENTS, PROPERTY CORNERS, AND REFERENCE MARKERS UNTIL THE OWNER, HIS AGENT, OR AN AUTHORIZED SURVEYOR HAS WITNESSED OR OTHERWISE REFERENCED THEIR LOCATIONS.
- OFFSET LOCATIONS GIVEN IN THE PLANS FOR STRUCTURES, EDGE OF PAVEMENT, ETC. ARE FROM THE ROADWAY CENTERLINE.
- HOT-MIX ASPHALT SURFACE REMOVAL BUTT JOINTS WILL BE INSTALLED AT THE ENDS OF ALL RESURFACING (WHERE RESURFACING MEETS EXISTING PAVEMENT), IN ACCORDANCE WITH THE BUTT JOINT AND HOT-MIX ASPHALT TAPER DETAILS SHEET INCLUDED IN THE PLANS, UNLESS OTHERWISE SPECIFIED.
- QUANTITIES FOR PATCHING SHALL NOT EXCEED THOSE PROVIDED IN THE SUMMARY OF QUANTITIES UNLESS APPROVED BY THE ENGINEER. THE ENGINEER WILL VERIFY FINAL PATCH LOCATIONS IN THE FIELD, PRIOR TO REMOVAL.
- THE CONTRACTOR SHALL COORDINATE PAVING OPERATIONS FOR BOTH HMA LEVEL BINDER AND SURFACE COURSES SO THAT THE LONGITUDINAL JOINTS ARE CLOSED AND COMPACTED AT THE END OF EACH DAY. PAVING OPERATIONS SHALL BE SCHEDULED SO THAT ADJACENT LANES ARE PAVED IN THE SAME DIRECTION AS THE INITIAL LANE MINIMIZING THE TIME THE EDGE OF A PAVEMENT MAT IS ALLOWED TO COOL.

**STORM SEWERS, WATER MAINS, AND UTILITIES**

- THE CONTRACTOR SHALL BE RESPONSIBLE FOR CONTACTING THE OWNERS OF ALL UTILITIES PRIOR TO CONSTRUCTION TO DETERMINE THE LOCATION OF ALL UTILITY EQUIPMENT. THE CONTRACTOR SHALL COOPERATE WITH ALL UTILITY OWNERS IN ACCORDANCE WITH THE STANDARD SPECIFICATIONS IF UTILITY RELOCATION, ADJUSTMENT, OR PROTECTION IS NECESSARY.
- THE LOCATION OF EXISTING DRAINAGE STRUCTURES, STORM SEWERS, WATER MAINS, SANITARY SEWERS, AND ANY OTHER PUBLIC UTILITIES AS SHOWN ON THE PLANS IS APPROXIMATE AND THEIR EXACT LOCATION IS TO BE DETERMINED IN THE FIELD BY THE CONTRACTOR. THIS WORK SHALL BE CONSIDERED AS INCLUDED IN THE UNIT BID PRICES OF THE CONTRACT, AND NO ADDITIONAL COMPENSATION WILL BE ALLOWED.
- THE CONTRACTOR SHALL BE RESPONSIBLE FOR THE PROTECTION OF ALL UNDERGROUND AND SURFACE UTILITIES EVEN IF NOT SHOWN ON THE PLANS. ALL UTILITY PROPERTY DAMAGE DURING CONSTRUCTION SHALL BE REPAIRED OR REPLACED TO THE SATISFACTION OF THE ENGINEER AT THE CONTRACTOR'S EXPENSE.
- ALL UTILITY OWNERS SHALL BE NOTIFIED AT LEAST 3 DAYS PRIOR TO THE START OF CONSTRUCTION.
- THE CONTRACTOR SHALL USE ALL NECESSARY PRECAUTIONS AND PROTECTION MEASURES REQUIRED TO MAINTAIN EXISTING UTILITIES AND SEWERS THAT MUST BE KEPT IN OPERATION.
- THE CONTRACTOR SHALL ENSURE ALL WATER SYSTEM VALVES, VALVE VAULTS, AND SANITARY SEWER MANHOLES REMAIN READILY ACCESSIBLE FOR EMERGENCY OPERATIONS. THE LOCATIONS OF ALL WATER AND SANITARY FACILITIES SHALL BE MARKED AND READILY VISIBLE AT ALL TIMES.
- ALL LOOSE MATERIAL DEPOSITED IN THE FLOWLINE OF DRAINAGE STRUCTURES, WHICH OBSTRUCTS THE NATURAL FLOW OF WATER SHALL BE REMOVED AT THE CLOSE OF EACH WORKING DAY. PRIOR TO ACCEPTANCE OF THE IMPROVEMENT, ALL DRAINAGE STRUCTURES SHALL BE FREE OF DIRT AND DEBRIS. THIS WORK WILL NOT BE PAID FOR SEPARATELY, BUT SHALL BE CONSIDERED AS INCLUDED IN THE UNIT BID PRICES OF THE CONTRACT IN ACCORDANCE WITH ARTICLE 107.15.

BOXED ITEMS INDICATE WORK NOT PAID FOR SEPARATELY BUT INCLUDED IN ANOTHER PAY ITEM OR INCLUDED IN THE CONTRACT.

**TRAFFIC CONTROL**

- SEE TRAFFIC CONTROL HIGHWAY STANDARDS CONCERNING TRAFFIC CONTROL AND PROTECTION.
- THE CONTRACTOR SHALL SCHEDULE CONSTRUCTION ACTIVITIES SO THAT TWO LANES OF TRAFFIC SHALL REMAIN OPEN AT ALL TIMES.

**SIGNING AND STRIPING**

- SEE IDOT STANDARD DETAIL 780001, DISTRICT ONE DETAIL TC-13 AND PLAN SHEETS FOR PAVEMENT MARKING DETAILS.
- THE CONTRACTOR WILL BE REQUIRED TO TEMPORARILY RESET ALL SIGNS THAT INTERFERE WITH CONSTRUCTION OPERATIONS. ALL SUCH SIGNS MUST BE MAINTAINED STRAIGHT AND CLEAN FOR THE DURATION OF THE TEMPORARY SETTING AND MUST BE RE-ERECTED AT A TEMPORARY LOCATION IN A WORKMANLIKE MANNER AND BE VISIBLE TO THE TRAFFIC FOR WHICH IT IS INTENDED. THIS WORK WILL NOT BE PAID FOR SEPARATELY, BUT SHALL BE INCLUDED IN THE UNIT BID PRICES OF THE CONTRACT IN ACCORDANCE WITH ARTICLE 107.25.

**MISCELLANEOUS**

- MATERIALS RESULTING FROM THE REMOVAL OF CONCRETE SURFACES, UTILITY STRUCTURE ADJUSTMENT, RESTORATION WORK, ETC. SHALL BE REMOVED AT THE END OF EACH DAY TO AN APPROVED SITE. IF THE CONTRACTOR DOES NOT REMOVE THESE MATERIALS AT THE REQUEST OF THE ENGINEER, THE VILLAGE OF CAROL STREAM WILL HIRE A CONTRACTOR TO HAVE THE MATERIAL REMOVED AND THE CONTRACTOR SHALL BE BILLED (CHARGED) ACCORDINGLY.
- THE INDISCRIMINATE USE OF FIRE HYDRANTS, EXISTING STREAMS, CREEKS, WETLANDS, OR PONDS IS STRICTLY PROHIBITED. THE CONTRACTOR SHALL PROVIDE A WATER TRUCK AND DRIVER AS REQUIRED TO OBTAIN AND TRANSPORT THIS WATER. THE CONTRACTOR SHALL BE RESPONSIBLE FOR OBTAINING WATER FROM AN APPROVED SOURCE. IF THIS WATER IS FROM A SOURCE OTHER THAN HIS/HER YARD, WRITTEN APPROVAL FROM THE AGENCY HAVING JURISDICTION FOR THE SOURCE OF THE WATER MUST BE RECEIVED BY THE CONTRACTOR PRIOR TO USE OF THE WATER.
- THE CONTRACTOR SHALL BE RESPONSIBLE FOR SWEEPING AND CLEANING STREETS OF ANY DEBRIS AND MATERIAL THAT HAS ACCUMULATED AS A RESULT OF THE CONSTRUCTION ACTIVITY. A MECHANICAL SWEEPER, MECHANICALLY DRIVEN AIR AND HANDWORK WITH SHOVEL AND BROOM SHALL BE UTILIZED TO PROVIDE A CLEAN STREET FOR THE MOTORING PUBLIC. WITHIN 24 HOURS OF PLACING PRIME COAT AND THE LAYING OF HMA, THE CONTRACTOR SHALL SWEEP THE PAVEMENT AND REMOVE STANDING WATER, EARTH, WEEDS, LEAVES, DIRT, CONSTRUCTION DEBRIS AND ALL LOOSE MATERIAL.
- WHEN REMOVING PAVEMENT, CURB AND GUTTER, SHOULDER, AND/OR ANY OTHER STRUCTURES, THE USE OF ANY TYPE OF CONCRETE BREAKERS WHICH MIGHT DAMAGE UNDERGROUND PUBLIC OR PRIVATE UTILITIES AND BUILDING FOUNDATIONS WILL NOT BE PERMITTED. UNDER NO CIRCUMSTANCES WILL THE USE OF A FROST BALL BE PERMITTED.
- SPRINKLER SYSTEMS DAMAGED BY THE CONTRACTOR OR IN CONFLICT WITH THE PROPOSED IMPROVEMENT SHALL BE REPAIRED OR RELOCATED BY THE CONTRACTOR. THE CONTRACTOR SHALL COORDINATE WITH PROPERTY OWNERS OR SPRINKLER SYSTEM MAINTENANCE CONTRACTORS TO DETERMINE REPAIR METHODS OR RELOCATION LIMITS. THIS WORK SHALL BE INCLUDED IN THE COST OF EARTH EXCAVATION.

**HIGHWAY STANDARDS**

STD. NO.	DESCRIPTION
000001-06	STANDARD SYMBOLS, ABBREVIATIONS AND PATTERNS
280001-06	TEMPORARY EROSION CONTROL SYSTEMS
424001-06	PERPENDICULAR CURB RAMPS FOR SIDEWALKS
442201-03	CLASS C AND D PATCHES
482011-03	HMA SHLD. STRIPS/SHLDS. WITH RESURFACING OR WIDENING AND RESURFACING PROJECTS
542401-01	METAL END SECTION FOR PIPE CULVERTS
602401-03	MANHOLE TYPE A
602601-02	PRECAST REINFORCED CONCRETE FLAT SLAB TOP
604001-03	FRAME AND LIDS TYPE 1
604056-03	FRAME AND GRATE TYPE 11V
606001-04	CONCRETE CURB TYPE B AND COMBINATION CONCRETE CURB AND GUTTER
701006-03	OFF-RD OPERATIONS, 2L, 2W, 15' (4.5 m) TO 24" (600 mm) FROM PAVEMENT EDGE
701301-04	LANE CLOSURE, 2L, 2W, SHORT TIME OPERATIONS
701311-03	LANE CLOSURE, 2L, 2W, MOVING OPERATIONS-DAY ONLY
701501-06	URBAN LANE CLOSURE, 2L, 2W, UNDIVIDED
701801-05	LANE CLOSURE MULTILANE 1W OR 2W CROSSWALK OR SIDEWALK CLOSURE
701901-02	TRAFFIC CONTROL DEVICES
780001-03	TYPICAL PAVEMENT MARKINGS

FILE NAME = g:\ch09\0088\road\sheet5\5-102-GenNotes	USER NAME = USFR	DESIGNED - CEC	REVISED -	<b>STATE OF ILLINOIS DEPARTMENT OF TRANSPORTATION</b>	<b>FAIR OAKS ROAD GENERAL NOTES AND HIGHWAY STANDARDS</b>	F.A.U. RTE.	SECTION	COUNTY	TOTAL SHEETS	SHEET NO.	
	PLOT SCALE = 69,9996 Ft / IN.	DRAWN - JKM	REVISED -			2542	11-00057-00-RS	DUPAGE	32	2	
	PLOT DATE = 11/1/2011	CHECKED - DWB	REVISED -			CONTRACT NO. 63653					
		DATE - 10/24/2011	REVISED -			NOT TO SCALE	SHEET NO. 1 OF 1 SHEETS	STA.	TO STA.		FED. ROAD DIST. NO. 1   ILLINOIS   FED. AID PROJECT

SUMMARY OF QUANTITIES				0005 ROADWAY 70% STP 30% LA
CODE NO	PAY ITEM	UNIT	QUANTITY	
20200100	EARTH EXCAVATION	CU YD	625	625
20201200	REMOVAL AND DISPOSAL OF UNSUITABLE MATERIAL	CU YD	1,334	1,334
20400800	FURNISHED EXCAVATION	CU YD	256	256
20800150	TRENCH BACKFILL	CU YD	12	12
21101615	TOPSOIL FURNISH AND PLACE, 4"	SQ YD	6,173	6,173
25000400	NITROGEN FERTILIZER NUTRIENT	POUND	77	77
25000500	PHOSPHORUS FERTILIZER NUTRIENT	POUND	77	77
25000600	POTASSIUM FERTILIZER NUTRIENT	POUND	77	77
25200110	SODDING, SALT TOLERANT	SQ YD	6,173	6,173
25200200	SUPPLEMENTAL WATERING	UNIT	19	19
28000250	TEMPORARY EROSION CONTROL SEEDING	POUND	128	128
28000400	PERIMETER EROSION BARRIER	FOOT	1,775	1,775
28000500	INLET AND PIPE PROTECTION	EACH	9	9
28000510	INLET FILTERS	EACH	17	17
31101200	SUBBASE GRANULAR MATERIAL, TYPE B 4"	SQ YD	2,607	2,607
35800100	PREPARATION OF BASE	SQ YD	22,444	22,444
40600100	BITUMINOUS MATERIALS (PRIME COAT)	GALLON	4,663	4,663
40600300	AGGREGATE (PRIME COAT)	TON	94	94
40600400	MIXTURE FOR CRACKS, JOINTS, AND FLANGEWAYS	TON	30	30
40600827	POLYMERIZED LEVELING BINDER (MACHINE METHOD), IL-4.75, N50	TON	1,230	1,230
40600982	HOT-MIX ASPHALT SURFACE REMOVAL - BUTT JOINT	SQ YD	229	229
40600990	TEMPORARY RAMP	SQ YD	229	229
40603080	HOT-MIX ASPHALT BINDER COURSE, IL-19.0, N50	TON	584	584
40603335	HOT-MIX ASPHALT SURFACE COURSE, MIX "D", N50	TON	2,708	2,708
42001300	PROTECTIVE COAT	SQ YD	279	279
42300200	PORTLAND CEMENT CONCRETE DRIVEWAY PAVEMENT, 6 INCH	SQ YD	149	149
42400200	PORTLAND CEMENT CONCRETE SIDEWALK 5 INCH	SQ FT	267	267
42400800	DETECTABLE WARNINGS	SQ FT	73	73
44000155	HOT-MIX ASPHALT SURFACE REMOVAL, 1 1/2"	SQ YD	22,215	22,215
44000200	DRIVEWAY PAVEMENT REMOVAL	SQ YD	797	797
44000500	COMBINATION CURB AND GUTTER REMOVAL	FOOT	396	396
44000600	SIDEWALK REMOVAL	SQ FT	340	340
44201713	CLASS D PATCHES, TYPE I, 6 INCH	SQ YD	834	834
44201717	CLASS D PATCHES, TYPE II, 6 INCH	SQ YD	834	834
44201721	CLASS D PATCHES, TYPE III, 6 INCH	SQ YD	834	834
44201723	CLASS D PATCHES, TYPE IV, 6 INCH	SQ YD	834	834
48102100	AGGREGATE WEDGE SHOULDER, TYPE B	TON	306	306
50105220	PIPE CULVERT REMOVAL	FOOT	136	136
54215547	METAL END SECTIONS 12"	EACH	2	2
54215550	METAL END SECTIONS 15"	EACH	5	5
54215553	METAL END SECTIONS 18"	EACH	2	2
54215559	METAL END SECTIONS 24"	EACH	2	2

SUMMARY OF QUANTITIES				0005 ROADWAY 70% STP 30% LA
CODE NO	PAY ITEM	UNIT	QUANTITY	
542D0217	PIPE CULVERTS, CLASS D, TYPE 1 12"	FOOT	14	14
542D0220	PIPE CULVERTS, CLASS D, TYPE 1 15"	FOOT	11	11
542D0223	PIPE CULVERTS, CLASS D, TYPE 1 18"	FOOT	22	22
542D0229	PIPE CULVERTS, CLASS D, TYPE 1 24"	FOOT	10	10
60218400	MANHOLES, TYPE A, 4'-DIAMETER, TYPE 1 FRAME, CLOSED LID	EACH	3	3
60404805	FRAMES AND GRATES, TYPE 11V	EACH	2	2
60603800	COMBINATION CONCRETE CURB AND GUTTER, TYPE B-6.12	FOOT	396	396
67100100	MOBILIZATION	L SUM	1	1
70102620	TRAFFIC CONTROL AND PROTECTION, STANDARD 701501	L SUM	1	1
70102635	TRAFFIC CONTROL AND PROTECTION, STANDARD 701701	L SUM	1	1
70102640	TRAFFIC CONTROL AND PROTECTION, STANDARD 701801	L SUM	1	1
70300100	SHORT TERM PAVEMENT MARKING	FOOT	3,257	3,257
* 70300220	TEMPORARY PAVEMENT MARKING - LINE 4"	FOOT	19,405	19,405
* 70300280	TEMPORARY PAVEMENT MARKING - LINE 24"	FOOT	137	137
* 70301000	WORK ZONE PAVEMENT MARKING REMOVAL	SQ FT	675	675
* 78000200	THERMOPLASTIC PAVEMENT MARKING - LINE 4"	FOOT	32,341	32,341
* 78000400	THERMOPLASTIC PAVEMENT MARKING - LINE 6"	FOOT	79	79
* 78000600	THERMOPLASTIC PAVEMENT MARKING - LINE 12"	FOOT	152	152
* 78000650	THERMOPLASTIC PAVEMENT MARKING - LINE 24"	FOOT	228	228
Z0004522	HOT-MIX ASPHALT DRIVEWAY PAVEMENT, 6"	SQ YD	560	560
Z0013798	CONSTRUCTION LAYOUT	L SUM	1	1
Z0018400	DRAINAGE STRUCTURES TO BE ADJUSTED	EACH	4	4
Z0023202	SEDIMENT CONTROL, DRAINAGE STRUCTURE INLET FILTER CLEANING	EACH	34	34
Z0030850	TEMPORARY INFORMATION SIGNING	SQ FT	402	402
Z0042002	POROUS GRANULAR EMBANKMENT, SUBGRADE	CU YD	56	56
** Z0076600	TRAINEES	hour	500	500

\* SPECIALTY ITEM

\*\* TRAINEES CONSTRUCTION  
TYPE CODE = 0042

FILE NAME = g:\CH09\0008\Road\Sheets\G-1029-500.SHT	USER NAME = USER	DESIGNED - CEC	REVISED -
		DRAWN - JKM	REVISED -
	PLOT SCALE = 69.3996 Ft / IN.	CHECKED - DWB	REVISED -
	PLOT DATE = 11/1/2011	DATE - 10/24/2011	REVISED -

STATE OF ILLINOIS  
DEPARTMENT OF TRANSPORTATION

FAIR OAKS ROAD  
SUMMARY OF QUANTITIES

NOT TO SCALE SHEET NO. 1 OF 1 SHEETS STA. TO STA.

F.A.U. RTE. 2542	SECTION 11-00057-00-RS	COUNTY DUPAGE	TOTAL SHEETS 32	SHEET NO. 3
CONTRACT NO. 63653				
FED. ROAD DIST. NO. 1 ILLINOIS FED. AID PROJECT				

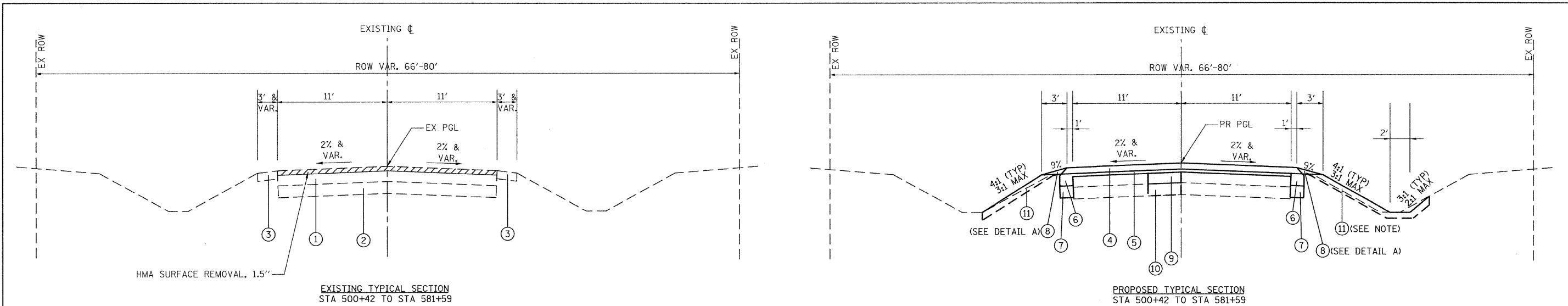

- LEGEND**
- ① EXISTING HMA PAVEMENT, 5" & VARIES
  - ② EXISTING AGGREGATE BASE COURSE, 6" & VARIES
  - ③ EXISTING AGGREGATE SHOULDER
  - ④ HOT-MIX ASPHALT SURFACE COURSE, MIX "D", N50, 2"
  - ⑤ POLYMERIZED LEVELING BINDER (MACHINE METHOD), IL-4.75, N50, 1"
  - ⑥ HOT-MIX ASPHALT BINDER COURSE, IL-19.0, N50, 4" (18" WIDE)
  - ⑦ SUB-BASE GRANULAR MATERIAL, TYPE B 4"
  - ⑧ AGGREGATE WEDGE SHOULDERS, TYPE B
  - ⑨ CLASS D PATCHES, 6", AS DIRECTED BY THE ENGINEER
  - ⑩ REMOVAL AND DISPOSAL OF UNSUITABLE MATERIAL AND REPLACEMENT WITH POROUS GRANULAR EMBANKMENT, SUBGRADE AS DIRECTED BY THE ENGINEER
  - ⑪ TOPSOIL FURNISH AND PLACE, 4" SODDING, SALT TOLERANT (GRADING TO CONSTRUCTION LIMIT LINE - SEE PLANS)

**HOT-MIX ASPHALT MIXTURE REQUIREMENTS**

THE CONTRACTOR SHALL MILL BEFORE PATCHING.

MIXTURE TYPE	AIR VOIDS @ Ndes
HMA SURFACE COURSE, MIX "D", N50 (IL 9.5mm), 2"	4% @ 50 GYRATIONS
POLYMERIZED LEVELING BINDER (MACHINE METHOD), IL-4.75, N50, 1"	4% @ 50 GYRATIONS
HMA BINDER COURSE, IL-19.0, N50, 4" (IN 2 LIFTS)	4% @ 50 GYRATIONS
CLASS D PATCHES (HMA BINDER IL-19 MM), 6" (IN 2 LIFTS)	4% @ 50 GYRATIONS
<b>HOT-MIX ASPHALT DRIVEWAYS 6"</b>	
HMA SURFACE COURSE, MIX "D", N50 (IL 9.5mm) 2"	4% @ 50 GYRATIONS
HMA BASE COURSE (HMA BINDER IL - 19mm) 4" (IN 2 LIFTS)	4% @ 50 GYRATIONS

NOTES: 1) THE UNIT WEIGHT USED TO CALCULATE ALL HMA SURFACE MIXTURE QUANTITIES IS 112 LBS/SQ YD/IN.  
 2) THE "AC TYPE" FOR POLYMERIZED HMA MIXES SHALL BE "SBS/SBR PG 76-22" AND FOR NON-POLYMERIZED HMA THE "AC TYPE" SHALL BE "PG 64-22" UNLESS MODIFIED BY DISTRICT ONE SPECIAL PROVISIONS. FOR "PERCENT OF RAP" SEE SPECIAL PROVISIONS.

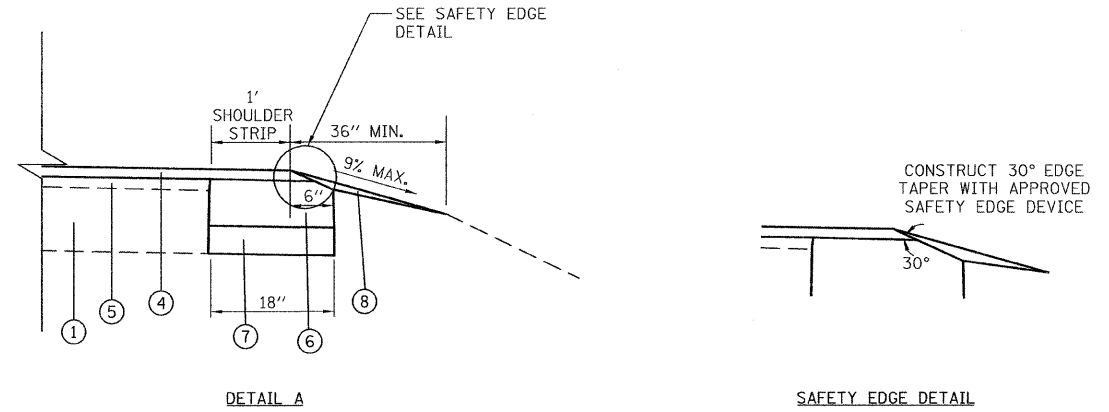

NOTE: THE PROPOSED TOPSOIL AND SOD SHALL BE GRADED TO A 4:1 TYPICAL SLOPE OR 3:1 MAX. SLOPE TO TIE INTO EXISTING FRONT SLOPE OR SHALL BE GRADED AS SHOWN ON CROSS SECTIONS WHERE DITCHES WILL BE RELOCATED.

**EARTHWORK TABLES**

LOCATION	REM AND DISP OF UNSUITABLE MATERIAL (TOPSOIL STRIPPING) (CU YD)		EARTH EXCAVATION (CU YD)		EXCAVATION TO BE USED IN EMBANKMENT (ADJ FOR 15% SHRINKAGE) (CU YD)		EMBANKMENT (CU YD)		EARTHWORK BALANCE WASTE (+) OR SHORTAGE (-) (CU YD)	
	LEFT	RIGHT	LEFT	RIGHT	LEFT	RIGHT	LEFT	RIGHT	LEFT	RIGHT
SOUTH END TO NORTH END	633	645	303	322	258	273	378	409	-120	-136
<b>TOTAL</b>	<b>633</b>	<b>645</b>	<b>303</b>	<b>322</b>	<b>258</b>	<b>273</b>	<b>378</b>	<b>409</b>	<b>-120</b>	<b>-136</b>

**EARTHWORK SUMMARY OF QUANTITIES**

	LEFT	RIGHT	TOTAL
EARTH EXCAVATION	303	322	625
REMOVAL AND DISPOSAL OF UNSUITABLE MATERIAL (TOPSOIL STRIPPING)	633	645	1,278
REMOVAL AND DISPOSAL OF UNSUITABLE MATERIAL (UNDERCUTTING)	56		56
TOTAL REMOVAL AND DISPOSAL OF UNSUITABLE MATERIAL	689	645	1,334
FURNISHED EXCAVATION	120	136	256

NOTE: THERE ARE NO CUTS, FILLS, OR TOPSOIL REMOVAL TABLES SHOWN ON THE CROSS SECTIONS BECAUSE CROSS SECTIONS ARE ONLY SHOWN IN LOCATIONS WHERE DITCHES WILL BE RELOCATED.

POROUS GRANULAR EMBANKMENT SUBGRADE (PGES) HAS BEEN PROVIDED FOR SOILS WHICH TEND TO BE UNSTABLE WHEN WET. THE ACTUAL NEED FOR REMOVAL AND REPLACEMENT WITH PGES WILL BE DETERMINED IN THE FIELD AT THE TIME OF CONSTRUCTION BY THE ENGINEER (BY USE OF A CONE PENETROMETER IN CONJUNCTION WITH THE IDOT SUBGRADE STABILITY MANUAL). IF UNSTABLE SOILS ARE ENCOUNTERED, THE SOILS SHALL BE REMOVED AND REPLACED WITH PGES. IF UNSTABLE SOILS ARE NOT ENCOUNTERED, THEN THE QUANTITY SHALL BE DEDUCTED AND NO ADDITIONAL COMPENSATION WILL BE DUE TO THE CONTRACTOR.



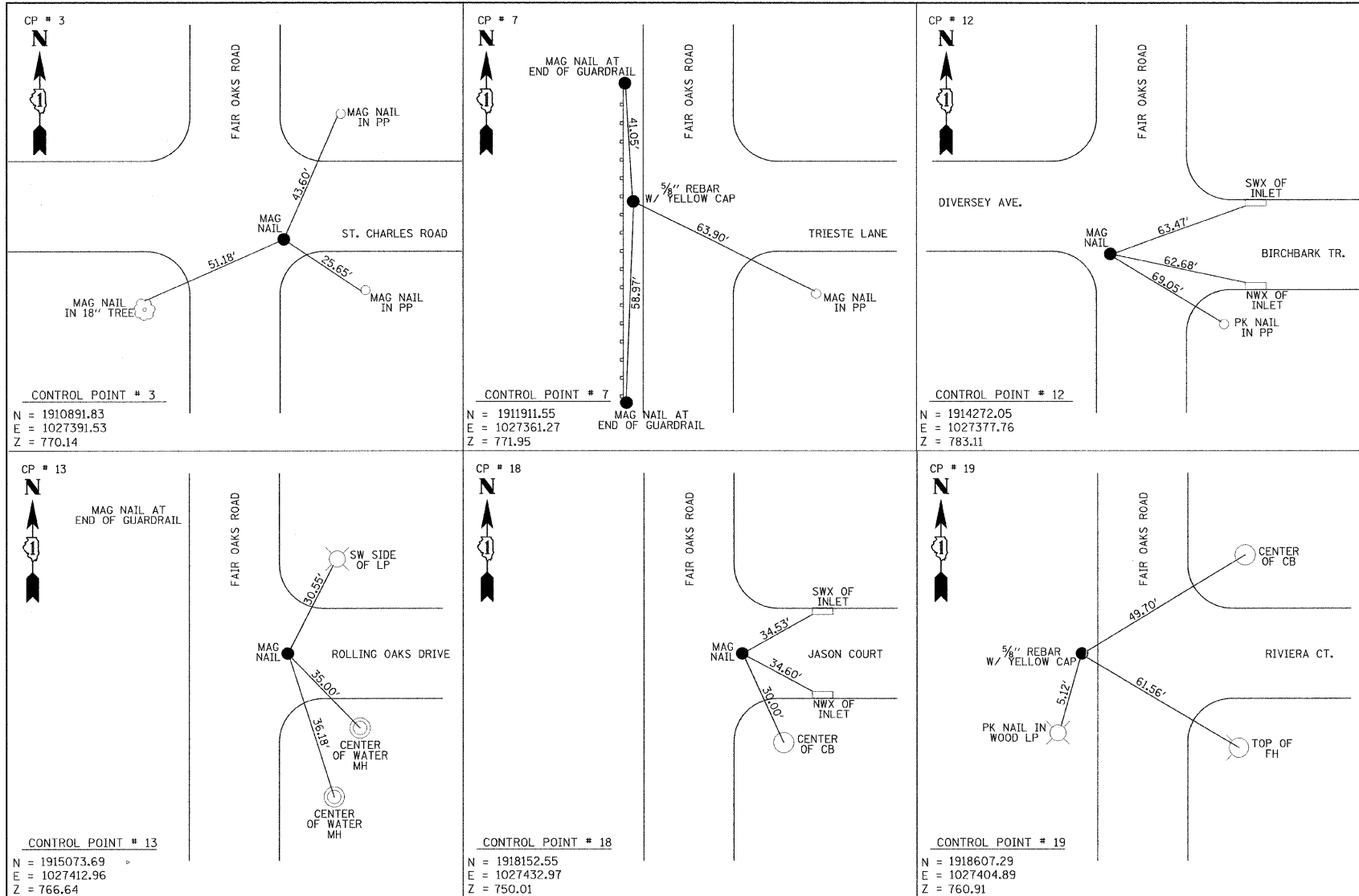

**BENCHMARK SUMMARY**

NAME	ELEVATION	DESCRIPTION
DK-3194	747.82	BRASS DISK ON HEADWALL AT THE SW X OF THE T. INTERSECTION OF FAIR OAKS RD. AND JASON COURT.
TBM # 8	761.40	SET RAILROAD SPIKE IN 1ST POWER POLE NORTH OF LIES ROAD.
TBM # 10	768.16	SET "X" IN THE SW BOLT OF THE FH AT THE SE X OF FAIR OAKS RD. AND VIOLET ST.
TBM # 12	769.21	SET "X" IN THE NW BOLT OF THE FH AT THE SE X OF FAIR OAKS RD. AND ROLLING OAKS DR.
TBM # 14	770.49	SET "X" IN THE SW BOLT OF THE 1ST FH SOUTH OF WYNN AVE.
TBM # 16	772.03	SET RAILROAD SPIKE IN POWER POLE W/ LIGHT AT THE SE X OF FAIR OAKS RD. AND TIMBER LANE.
TBM # 18	769.57	FOUND RAILROAD SPIKE IN POWER POLE W/ LIGHT AT THE NE X OF FAIR OAKS RD. AND ST. CHARLES RD.

NOTE: TBM NUMBERS DO NOT CORRELATE TO CONTROL POINT NUMBERS.

**COORDINATE INFORMATION**

LOCATION	STATION	NORTHING	EASTING
BEGIN POT	500+00.00	1910558.66	1027369.04
POT	501+00.18	1910658.84	1027369.53
POT	504+00.50	1910959.16	1027371.76
POT	507+42.89	1911301.54	1027371.43
POT	514+10.64	1911969.29	1027373.92
POT	523+83.00	1912941.63	1027379.73
POT	537+77.90	1914336.48	1027391.42
POT	542+16.87	1914775.45	1027393.15
POT	545+81.08	1915139.63	1027398.01
POT	558+22.86	1916381.34	1027411.00
POT	564+78.83	1917037.31	1027412.89
POT	570+23.11	1917581.56	1027416.98
POT	576+43.53	1918201.98	1027419.65
END POT	581+82.82	1918741.28	1027419.11

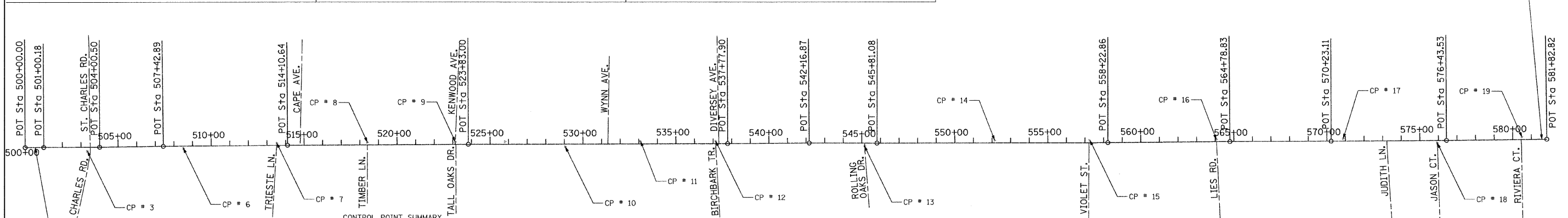

**CONTROL POINT SUMMARY**

NAME	NORTHING	EASTING	ELEVATION	DESCRIPTION
CP #3	190891.83	1027391.53	770.14	FOUND MAG NAIL SE X OF FAIR OAKS RD. AND ST. CHARLES RD.
CP #6	1911409.86	1027383.76	765.46	SET MAG NAIL E. SIDE OF FAIR OAKS RD. BY #2N760 MAILBOX +/- 500' N. OF ST. CHARLES RD.
CP #7	1911911.55	1027361.27	771.95	SET 5/8" REBAR W/ YELLOW CAP W. SIDE OF FAIR OAKS RD. AT THE C OF TRIESTE LN.
CP #8	1912398.93	1027363.25	770.41	SET 5/8" REBAR W/ YELLOW CAP W. SIDE OF FAIR OAKS RD. AT THE C OF TIMBER LN.
CP #9	1912871.72	1027366.39	771.96	SET MAG NAIL W. SIDE OF FAIR OAKS RD. AT THE C OF TALL OAKS DR./KENWOOD AVE.
CP #10	1913462.82	1027398.27	768.20	SET 5/8" REBAR W/ YELLOW CAP E. SIDE OF FAIR OAKS RD. 240' +/- SOUTH OF WYNN AVE.
CP #11	1913867.32	1027373.88	781.35	SET 5/8" REBAR W/ YELLOW CAP W. SIDE OF FAIR OAKS RD. 175' +/- N. OF WYNN AVE. ACROSS FROM P.P. #60995.
CP #12	1914272.05	1027377.76	783.11	SET MAG NAIL SW X OF FAIR OAKS RD. AND DIVERSEY AVE. ON C OF BIRCHBARK TR.
CP #13	1915073.69	1027412.96	766.64	SET MAG NAIL E. SIDE OF FAIR OAKS RD. AT C OF ROLLING OAKS DR.
CP #14	1915772.39	1027391.15	761.57	SET 5/8" REBAR W/ YELLOW CAP W. SIDE OF FAIR OAKS RD. 508' +/- S. OF VIOLET ST. ACROSS FROM P.P. #71690.
CP #15	1916281.04	1027396.49	766.22	SET 5/8" REBAR W/ YELLOW CAP W. SIDE OF FAIR OAKS RD. AT THE C OF VIOLET ST.
CP #16	1916965.49	1027400.37	761.81	SET 5/8" REBAR W/ YELLOW CAP W. SIDE OF FAIR OAKS RD. AT THE C OF LIES RD.
CP #17	1917646.46	1027403.65	755.66	SET 5/8" REBAR W/ YELLOW CAP W. SIDE OF FAIR OAKS RD. 235' +/- S. OF JUDITH CT.
CP #18	1918152.55	1027432.97	750.01	SET MAG NAIL E. SIDE OF FAIR OAKS RD. AT THE C OF JASON CT.
CP #19	1918607.29	1027404.89	760.91	SET 5/8" REBAR W/ YELLOW CAP W. SIDE OF FAIR OAKS RD. AT THE C OF RIVIERA CT.



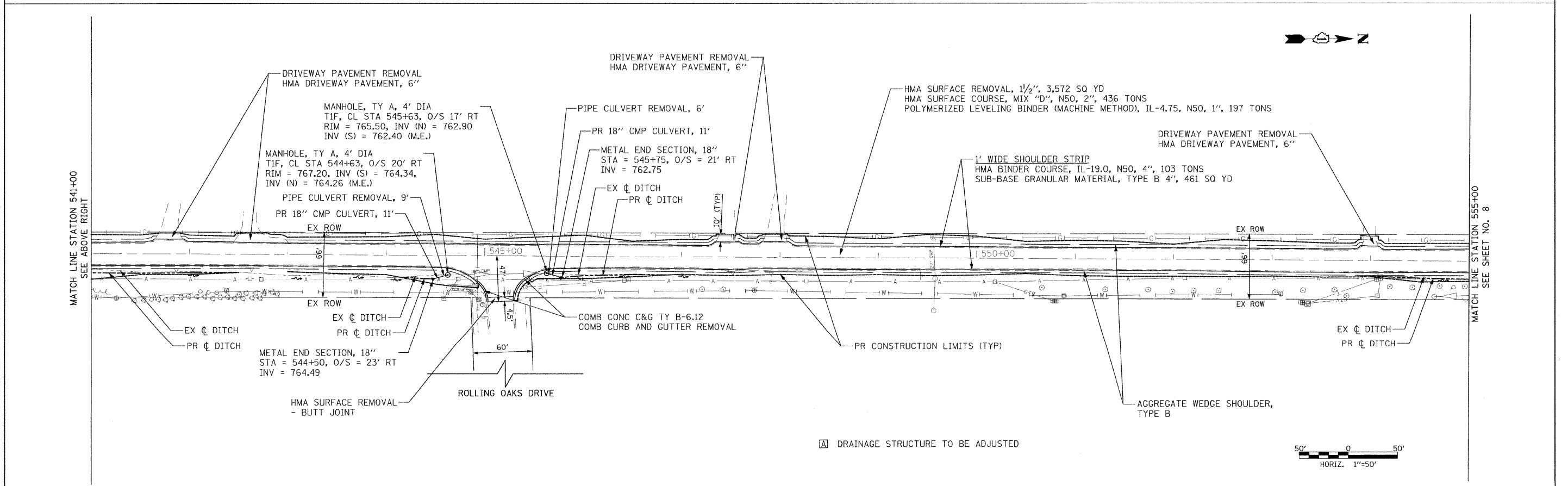
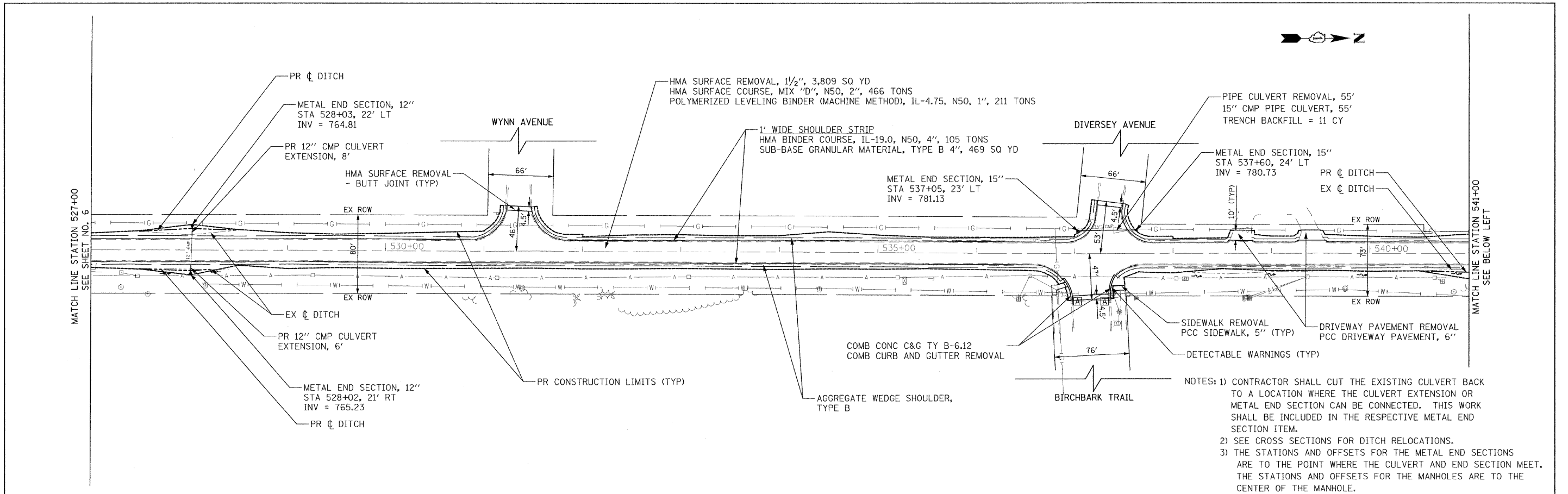

☐ DRAINAGE STRUCTURE TO BE ADJUSTED

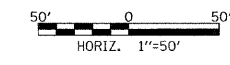

FILE NAME = g:\ch09\0008\road\sheet\PP-202.sht	USER NAME = .USER.	DESIGNED CEC	REVISED	<b>STATE OF ILLINOIS DEPARTMENT OF TRANSPORTATION</b>	<b>FAIR OAKS ROAD IMPROVEMENT PLAN</b>		F.A.U. RTE. 2542	SECTION 11-00057-00-RS	COUNTY DUPAGE	TOTAL SHEETS 32	SHEET NO. 7	
PLOT SCALE = 50.000 ' / IN.	CHECKED - DWB	DATE - 10/24/2011	REVISED -		SCALE: #SCALE	SHEET NO. 2 OF 3 SHEETS	STA. 527+00 TO STA. 555+00	CONTRACT NO. 63653				
PLOT DATE = 11/12/2011	DATE - 10/24/2011	REVISED -	REVISED -		FED. ROAD DIST. NO. [ILLINOIS] FED. AID PROJECT							

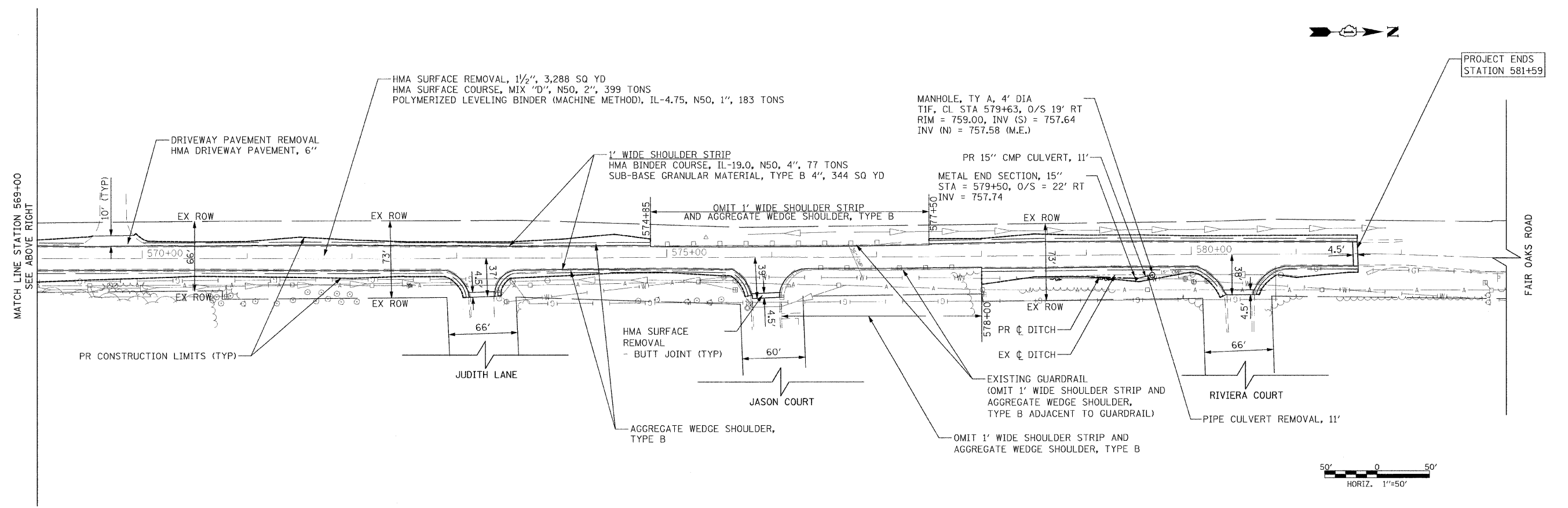
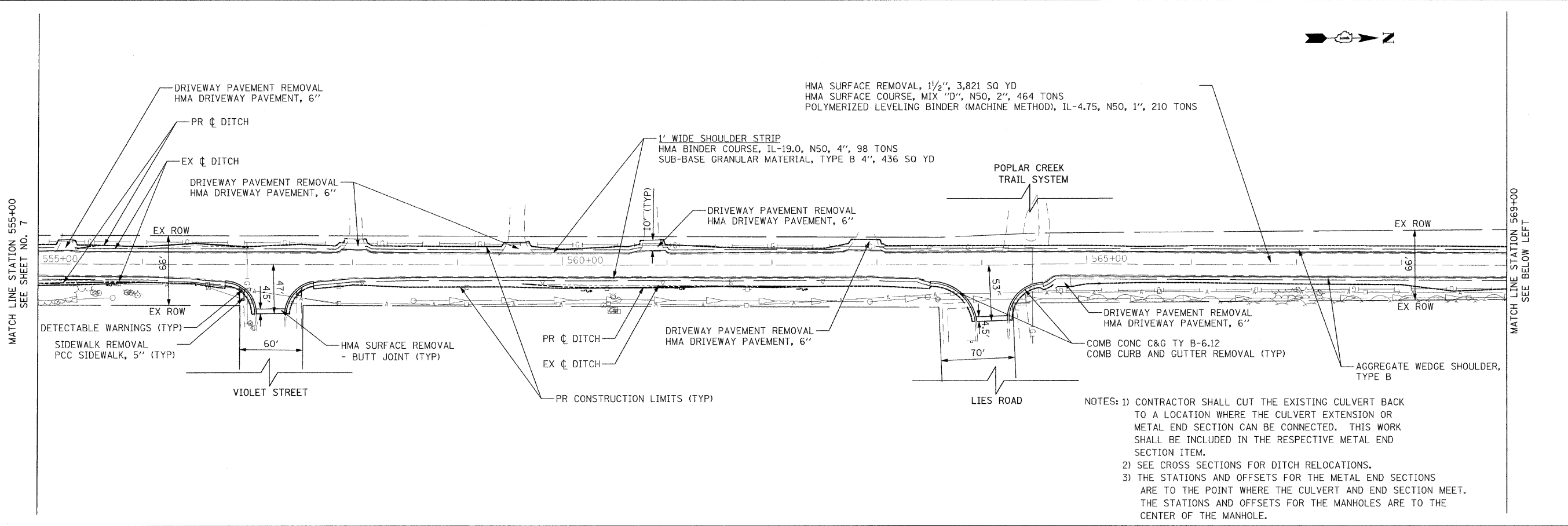

FILE NAME = g:\ch2\9\0009\road\sheet\PP-203.sht	USER NAME = .USER.	DESIGNED - CEC	REVISED - ---	<b>STATE OF ILLINOIS DEPARTMENT OF TRANSPORTATION</b>	<b>FAIR OAKS ROAD IMPROVEMENT PLAN</b>	F.A.U. RTE. 2542	SECTION 11-00057-00-RS	COUNTY DUPAGE	TOTAL SHEETS 32	SHEET NO. 8		
PLOT SCALE = 50.000 1/2 IN.	CHECKED - DWB	REVISED - ---	SCALE: #SCALE			SHEET NO. 3 OF 3 SHEETS	STA. 555+00 TO STA. 581+59	CONTRACT NO. 63653				
PLOT DATE = 11/17/2011	DATE - 10/24/2011	REVISED - ---	FED. ROAD DIST. NO. [ ] ILLINOIS FED. AID PROJECT									

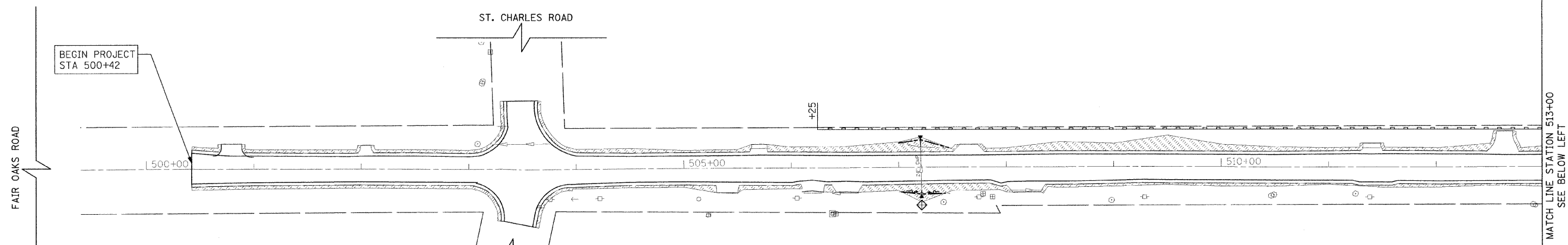
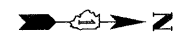

**TEMPORARY EROSION CONTROL NOTES**

1. THE ENGINEER SHALL CONDUCT A FIELD REVIEW FOR EROSION AND SEDIMENT CONTROL WITH THE PRIME AND SUBCONTRACTORS PRIOR TO ANY EARTHWORK OPERATIONS TO DETERMINE TIMING OF CONTROL MEASURES.
2. THE CONTRACTOR WILL BE REQUIRED TO IMPLEMENT AND MAINTAIN EROSION CONTROL MEASURES IMMEDIATELY AFTER STRIPPING OF EXISTING VEGETATION.
3. NO CONCENTRATED RUNOFF FLOW FROM STRIPPED AREAS SHALL LEAVE THE SITE WITHOUT BEING TREATED. THE CONTRACTOR SHALL ADJUST HIS OPERATIONS AND IMPLEMENT EROSION CONTROL MEASURES ACCORDINGLY.
4. INLET FILTERS SHALL BE PROVIDED ON ALL EXISTING AND PROPOSED INLETS AND CATCH BASINS WITHIN THE PROJECT LIMITS. SEDIMENT CONTROL, DRAINAGE STRUCTURE INLET FILTER CLEANING WILL BE REQUIRED DURING THE CONSTRUCTION PERIOD AS NEEDED. AN ESTIMATED QUANTITY OF 2 ADDITIONAL CLEANINGS HAS BEEN INCLUDED IN THE QUANTITIES.
5. EROSION CONTROL MEASURES SHALL BE INSPECTED BY THE CONTRACTOR AND ENGINEER AT LEAST ONCE EVERY SEVEN DAYS OR WITHIN 24 HOURS OF ANY STORM EXCEEDING 1/2" OF PRECIPITATION OR EQUIVALENT SNOWFALL.
6. THE CONTRACTOR SHALL TAKE ALL PRECAUTIONS TO PREVENT POLLUTION OF STORM WATER AND SHALL FOLLOW IEPA & IDOT CONSTRUCTION MEMORANDUM NO. 06-60.
7. STABILIZATION MEASURES SHALL BE INITIATED AS SOON AS PRACTICAL, BUT NO MORE THAN 14 DAYS AFTER CONSTRUCTION ACTIVITY HAS CEASED IN AN AREA WHERE CONSTRUCTION ACTIVITY WILL NOT OCCUR FOR A PERIOD OF 21 OR MORE CALENDAR DAYS.
8. THE CONTRACTOR SHALL APPLY TEMPORARY EROSION CONTROL SEEDING TO ALL ERODIBLE BARE EARTH AREAS WITHIN THE CONTRACT LIMITS EACH WEEK, REGARDLESS OF WEATHER CONDITIONS OR PROGRESS OF THE WORK, UNLESS OTHERWISE DIRECTED BY THE ENGINEER. ERODIBLE EMBANKMENT AND EXCAVATION AREAS WHERE WORK IS IN PROGRESS SHALL BE INCLUDED ON THE AREAS TO BE SEEDED.

**LEGEND**

- SODDING, SALT TOLERANT TOPSOIL FURNISH AND PLACE, 4" NITROGEN, PHOSPHORUS, AND POTASSIUM FERTILIZER NUTRIENT
- PERIMETER EROSION BARRIER
- INLET AND PIPE PROTECTION

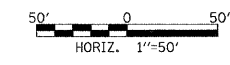
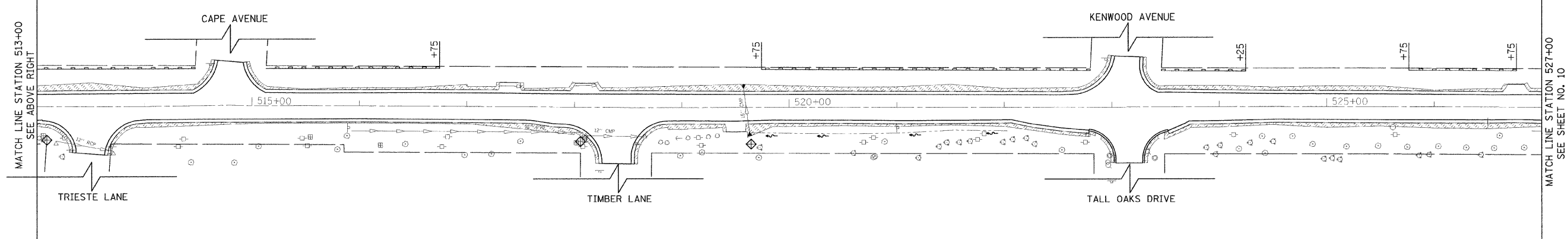
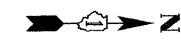

FILE NAME = g:\ch09\0008\road\Sheets\EC-301.sht	USER NAME = _USER_	DESIGNED - CEC	REVISED -	<b>STATE OF ILLINOIS DEPARTMENT OF TRANSPORTATION</b>	<b>FAIR OAKS ROAD LANDSCAPING AND EROSION CONTROL PLAN</b>	F.A.U. RTE. 2542	SECTION 11-00057-00-RS	COUNTY DUPAGE	TOTAL SHEETS 32	SHEET NO. 9	
PLOT SCALE = 50,000 / IN.		CHECKED - DWB	REVISED -			SCALE: #SCALE		SHEET NO. 1 OF 3 SHEETS		CONTRACT NO. 63653	
PLOT DATE = 11/17/2011		DATE - 10/24/2011	REVISED -			STA. 500+42 TO STA. 527+00		FED. ROAD DIST. NO. - [ILLINOIS] FED. AID PROJECT			



MATCH LINE STATION 527+00  
SEE SHEET NO. 9

MATCH LINE STATION 541+00  
SEE BELOW LEFT

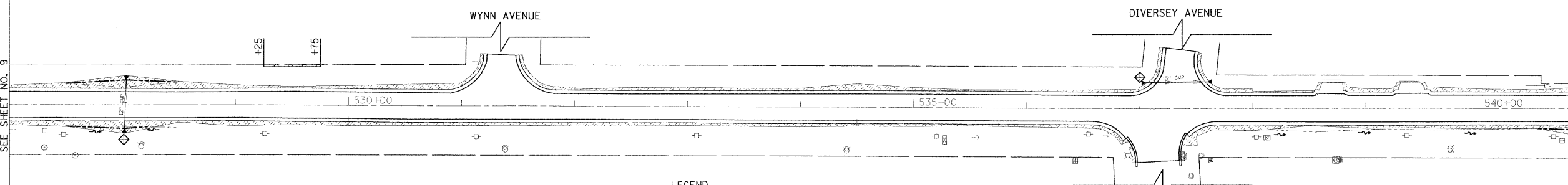

**TEMPORARY EROSION CONTROL NOTES**

1. THE ENGINEER SHALL CONDUCT A FIELD REVIEW FOR EROSION AND SEDIMENT CONTROL WITH THE PRIME AND SUBCONTRACTORS PRIOR TO ANY EARTHWORK OPERATIONS TO DETERMINE TIMING OF CONTROL MEASURES.
2. THE CONTRACTOR WILL BE REQUIRED TO IMPLEMENT AND MAINTAIN EROSION CONTROL MEASURES IMMEDIATELY AFTER STRIPPING OF EXISTING VEGETATION.
3. NO CONCENTRATED RUNOFF FLOW FROM STRIPPED AREAS SHALL LEAVE THE SITE WITHOUT BEING TREATED. THE CONTRACTOR SHALL ADJUST HIS OPERATIONS AND IMPLEMENT EROSION CONTROL MEASURES ACCORDINGLY.
4. INLET FILTERS SHALL BE PROVIDED ON ALL EXISTING AND PROPOSED INLETS AND CATCH BASINS WITHIN THE PROJECT LIMITS. SEDIMENT CONTROL, DRAINAGE STRUCTURE INLET FILTER CLEANING WILL BE REQUIRED DURING THE CONSTRUCTION PERIOD AS NEEDED. AN ESTIMATED QUANTITY OF 2 ADDITIONAL CLEANINGS HAS BEEN INCLUDED IN THE QUANTITIES.

**LEGEND**

- SODDING, SALT TOLERANT TOPSOIL FURNISH AND PLACE, 4" NITROGEN, PHOSPHORUS, AND POTASSIUM FERTILIZER NUTRIENT
- PERIMETER EROSION BARRIER
- INLET AND PIPE PROTECTION

5. EROSION CONTROL MEASURES SHALL BE INSPECTED BY THE CONTRACTOR AND ENGINEER AT LEAST ONCE EVERY SEVEN DAYS OR WITHIN 24 HOURS OF ANY STORM EXCEEDING 1/2" OF PRECIPITATION OR EQUIVALENT SNOWFALL.
6. THE CONTRACTOR SHALL TAKE ALL PRECAUTIONS TO PREVENT POLLUTION OF STORM WATER AND SHALL FOLLOW IEPA & IDOT CONSTRUCTION MEMORANDUM NO. 06-60.
7. STABILIZATION MEASURES SHALL BE INITIATED AS SOON AS PRACTICAL, BUT NO MORE THAN 14 DAYS AFTER CONSTRUCTION ACTIVITY HAS CEASED IN AN AREA WHERE CONSTRUCTION ACTIVITY WILL NOT OCCUR FOR A PERIOD OF 21 OR MORE CALENDAR DAYS.
8. THE CONTRACTOR SHALL APPLY TEMPORARY EROSION CONTROL SEEDING TO ALL ERODIBLE BARE EARTH AREAS WITHIN THE CONTRACT LIMITS EACH WEEK, REGARDLESS OF WEATHER CONDITIONS OR PROGRESS OF THE WORK, UNLESS OTHERWISE DIRECTED BY THE ENGINEER. ERODIBLE EMBANKMENT AND EXCAVATION AREAS WHERE WORK IS IN PROGRESS SHALL BE INCLUDED ON THE AREAS TO BE SEEDED.



MATCH LINE STATION 541+00  
SEE ABOVE RIGHT

MATCH LINE STATION 555+00  
SEE SHEET NO. 11

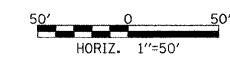
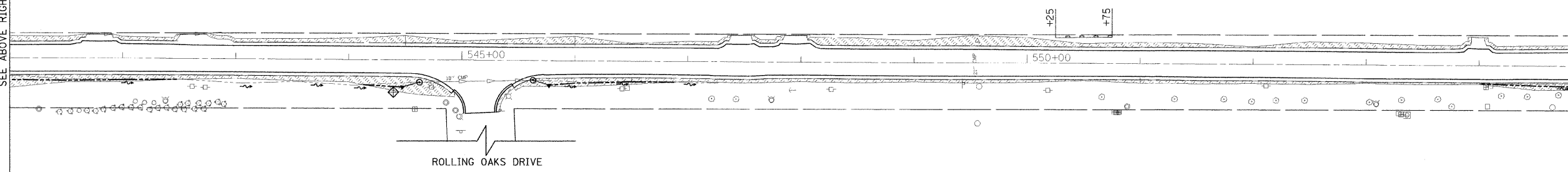

FILE NAME = g:\ch09\0008\road\Sheets\EC-302.sht  
USER NAME = USER  
PLOT SCALE = 50.000 ' / IN.  
PLOT DATE = 11/17/2011

DESIGNED - CEC	REVISED - ---
DRAWN - CEC	REVISED - ---
CHECKED - DWB	REVISED - ---
DATE - 10/24/2011	REVISED - ---

**STATE OF ILLINOIS  
DEPARTMENT OF TRANSPORTATION**

**FAIR OAKS ROAD  
LANDSCAPING AND EROSION CONTROL PLAN**

SCALE: #SCALE SHEET NO. 2 OF 3 SHEETS STA. 527+00 TO STA. 555+00

F.A.U. RTE. 2542	SECTION 11-00057-00-RS	COUNTY DUPAGE	TOTAL SHEETS 32	SHEET NO. 10
FED. ROAD DIST. NO. ILLINOIS FED. AID PROJECT CONTRACT NO. 63653				





MATCH LINE STATION 555+00  
SEE SHEET NO. 10

MATCH LINE STATION 569+00  
SEE BELOW LEFT

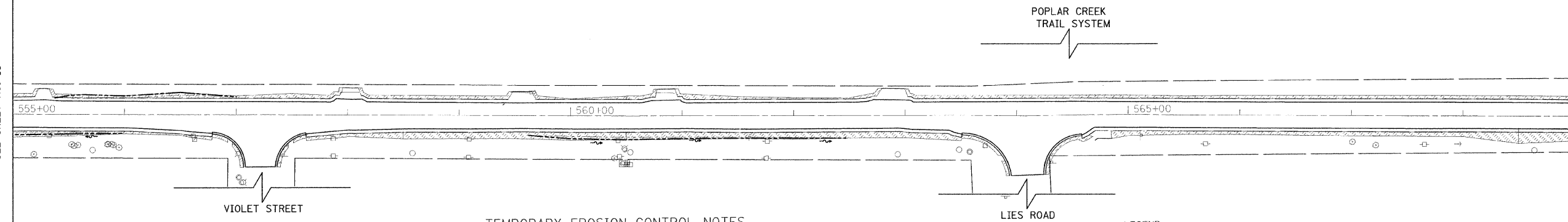

**TEMPORARY EROSION CONTROL NOTES**

1. THE ENGINEER SHALL CONDUCT A FIELD REVIEW FOR EROSION AND SEDIMENT CONTROL WITH THE PRIME AND SUBCONTRACTORS PRIOR TO ANY EARTHWORK OPERATIONS TO DETERMINE TIMING OF CONTROL MEASURES.
2. THE CONTRACTOR WILL BE REQUIRED TO IMPLEMENT AND MAINTAIN EROSION CONTROL MEASURES IMMEDIATELY AFTER STRIPPING OF EXISTING VEGETATION.
3. NO CONCENTRATED RUNOFF FLOW FROM STRIPPED AREAS SHALL LEAVE THE SITE WITHOUT BEING TREATED. THE CONTRACTOR SHALL ADJUST HIS OPERATIONS AND IMPLEMENT EROSION CONTROL MEASURES ACCORDINGLY.
4. INLET FILTERS SHALL BE PROVIDED ON ALL EXISTING AND PROPOSED INLETS AND CATCH BASINS WITHIN THE PROJECT LIMITS. SEDIMENT CONTROL, DRAINAGE STRUCTURE INLET FILTER CLEANING WILL BE REQUIRED DURING THE CONSTRUCTION PERIOD AS NEEDED. AN ESTIMATED QUANTITY OF 2 ADDITIONAL CLEANINGS HAS BEEN INCLUDED IN THE QUANTITIES.
5. EROSION CONTROL MEASURES SHALL BE INSPECTED BY THE CONTRACTOR AND ENGINEER AT LEAST ONCE EVERY SEVEN DAYS OR WITHIN 24 HOURS OF ANY STORM EXCEEDING 1/2" OF PRECIPITATION OR EQUIVALENT SNOWFALL.
6. THE CONTRACTOR SHALL TAKE ALL PRECAUTIONS TO PREVENT POLLUTION OF STORM WATER AND SHALL FOLLOW IEPA & IDOT CONSTRUCTION MEMORANDUM NO. 06-60.
7. STABILIZATION MEASURES SHALL BE INITIATED AS SOON AS PRACTICAL, BUT NO MORE THAN 14 DAYS AFTER CONSTRUCTION ACTIVITY HAS CEASED IN AN AREA WHERE CONSTRUCTION ACTIVITY WILL NOT OCCUR FOR A PERIOD OF 21 OR MORE CALENDAR DAYS.
8. THE CONTRACTOR SHALL APPLY TEMPORARY EROSION CONTROL SEEDING TO ALL ERODIBLE BARE EARTH AREAS WITHIN THE CONTRACT LIMITS EACH WEEK, REGARDLESS OF WEATHER CONDITIONS OR PROGRESS OF THE WORK, UNLESS OTHERWISE DIRECTED BY THE ENGINEER. ERODIBLE EMBANKMENT AND EXCAVATION AREAS WHERE WORK IS IN PROGRESS SHALL BE INCLUDED ON THE AREAS TO BE SEEDDED.

**LEGEND**

- SODDING, SALT TOLERANT TOPSOIL FURNISH AND PLACE, 4" NITROGEN, PHOSPHORUS, AND POTASSIUM FERTILIZER NUTRIENT
- PERIMETER EROSION BARRIER
- INLET AND PIPE PROTECTION



MATCH LINE STATION 569+00  
SEE ABOVE RIGHT

FAIR OAKS ROAD

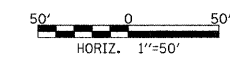
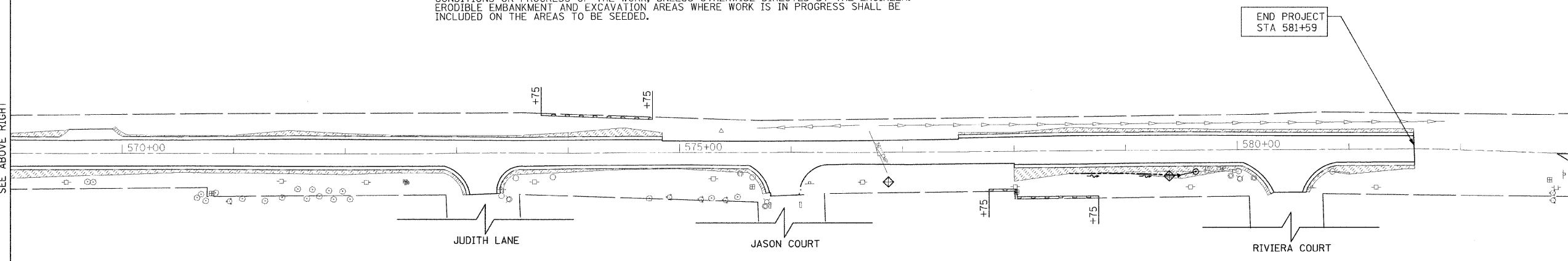

FILE NAME = g:\ch09\0008\road\Sheets\EC-303.sht	USER NAME = USERL	DESIGNED - CEC	REVISED - ---	<b>STATE OF ILLINOIS DEPARTMENT OF TRANSPORTATION</b>	<b>FAIR OAKS ROAD LANDSCAPING AND EROSION CONTROL PLAN</b>	F.A.J. RTE. 2542	SECTION 11-00057-00-RS	COUNTY DUPAGE	TOTAL SHEETS 32	SHEET NO. 11		
PLOT SCALE = 50.000' / IN.		CHECKED - DWB	REVISED - ---			SCALE: #SCALE ---	SHEET NO. 3 OF 3 SHEETS	STA. 555+00 TO STA. 581+59	CONTRACT NO. 63653			
PLOT DATE = 11/17/2011		DATE - 10/24/2011	REVISED - ---			FED. ROAD DIST. NO. - ILLINOIS FED. AID PROJECT						

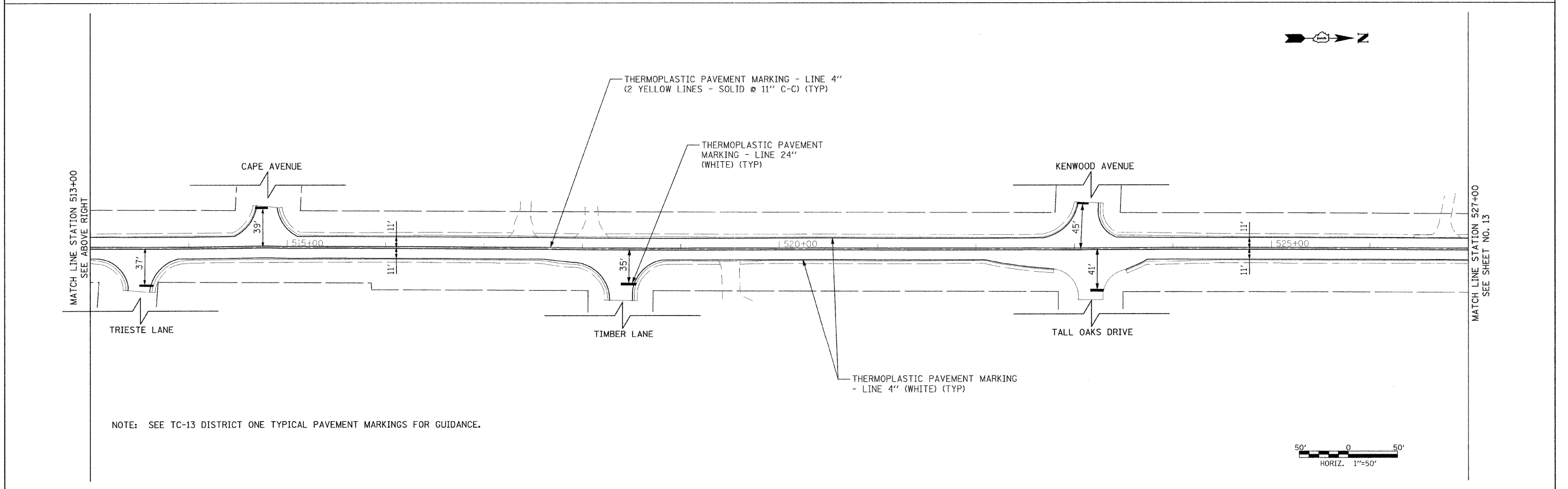
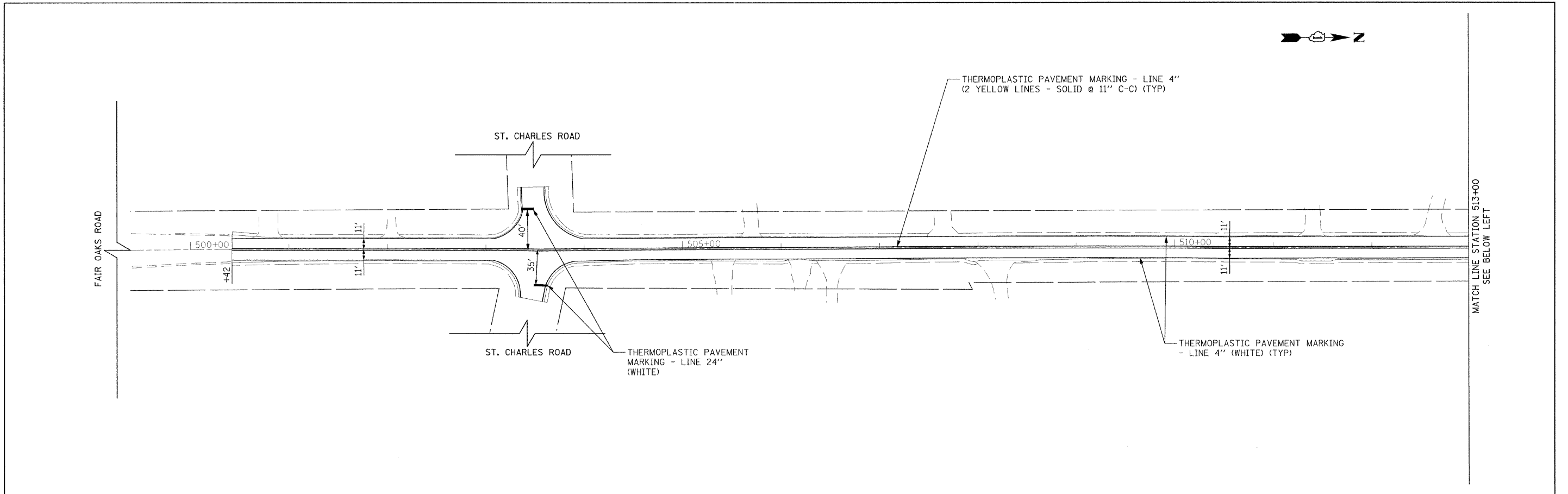

NOTE: SEE TC-13 DISTRICT ONE TYPICAL PAVEMENT MARKINGS FOR GUIDANCE.



FILE NAME = g:\ch09\0005\road\sheet\PM-501.dht	USER NAME = USERL	DESIGNED = CEC	REVISED = ---	<b>STATE OF ILLINOIS DEPARTMENT OF TRANSPORTATION</b>	<b>FAIR OAKS ROAD PAVEMENT MARKING PLAN</b>			F.A.U. RTE. 2542	SECTION 11-00057-00-RS	COUNTY DUPAGE	TOTAL SHEETS 32	SHEET NO. 12
PLOT SCALE = 50.000' / IN.	CHECKED = DWB	REVISED = ---	REVISED = ---		SCALE: \$SCALE	SHEET NO. 1 OF 3 SHEETS	STA. 500+42 TO STA. 527+00	CONTRACT NO. 63653				
PLOT DATE = 11/1/2011	DATE = 10/24/2011	REVISED = ---	REVISED = ---		FED. ROAD DIST. NO. [ILLINOIS] FED. AID PROJECT							

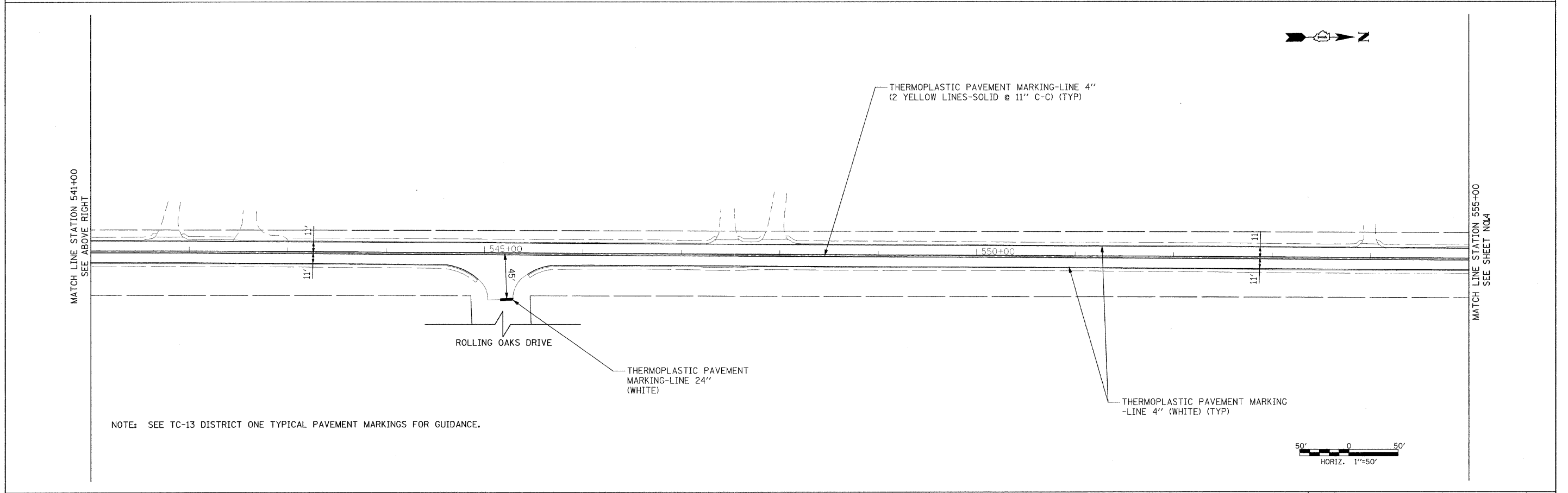
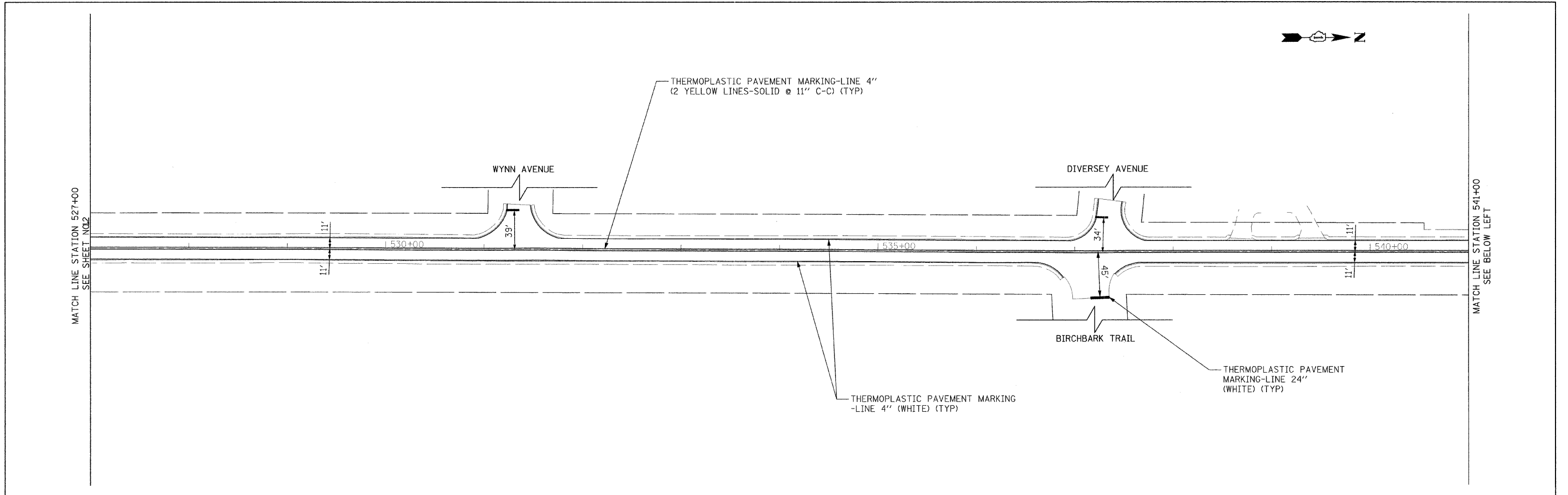

NOTE: SEE TC-13 DISTRICT ONE TYPICAL PAVEMENT MARKINGS FOR GUIDANCE.

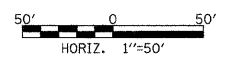

FILE NAME = g:\ch09\0000\road\sheets\PM-502aht	USER NAME = .USER.	DESIGNED - CEC	REVISED - ---	<b>STATE OF ILLINOIS DEPARTMENT OF TRANSPORTATION</b>	<b>FAIR OAKS ROAD PAVEMENT MARKING PLAN</b>		F.A.U. RTE. 2542	SECTION 11-00057-00-RS	COUNTY DUPAGE	TOTAL SHEETS 32	SHEET NO. 13	
PLOT SCALE = 50.000 ' / IN.	CHECKED - DWB	REVISED - ---	REVISED - ---		SCALE: @SCALE	SHEET NO. 2 OF 3 SHEETS	STA. 527+00 TO STA. 555+00	CONTRACT NO. 63653				
PLOT DATE = 11/1/2011	DATE - 10/24/2011	REVISED - ---	REVISED - ---		FED. ROAD DIST. NO. ILLINOIS FED. AID PROJECT							

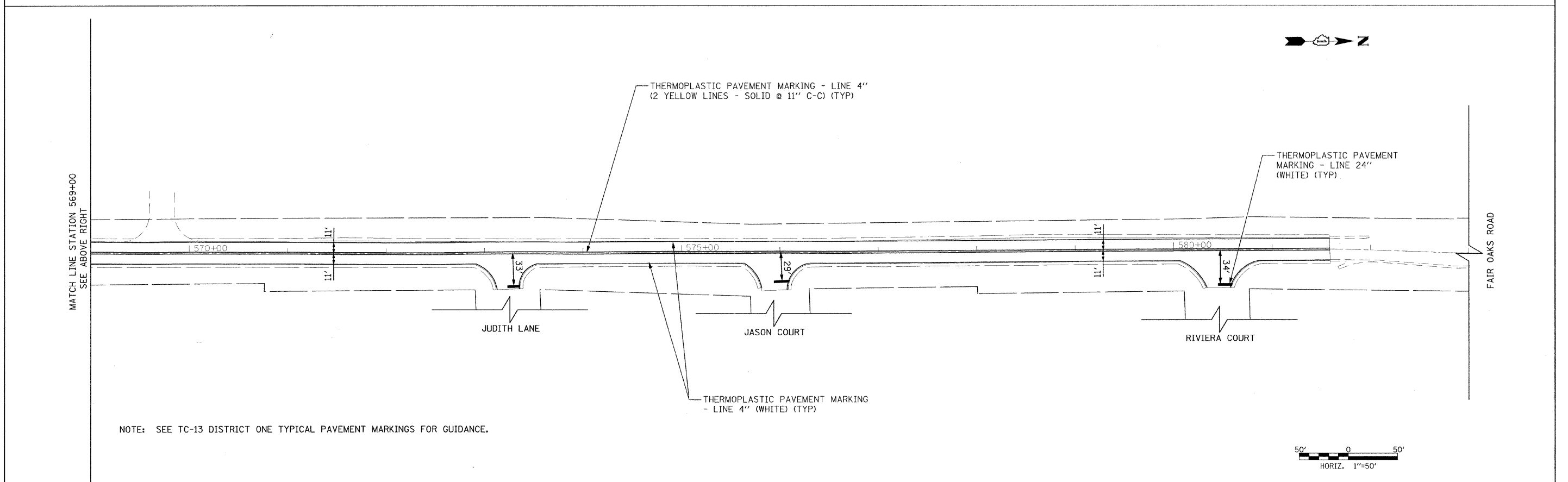
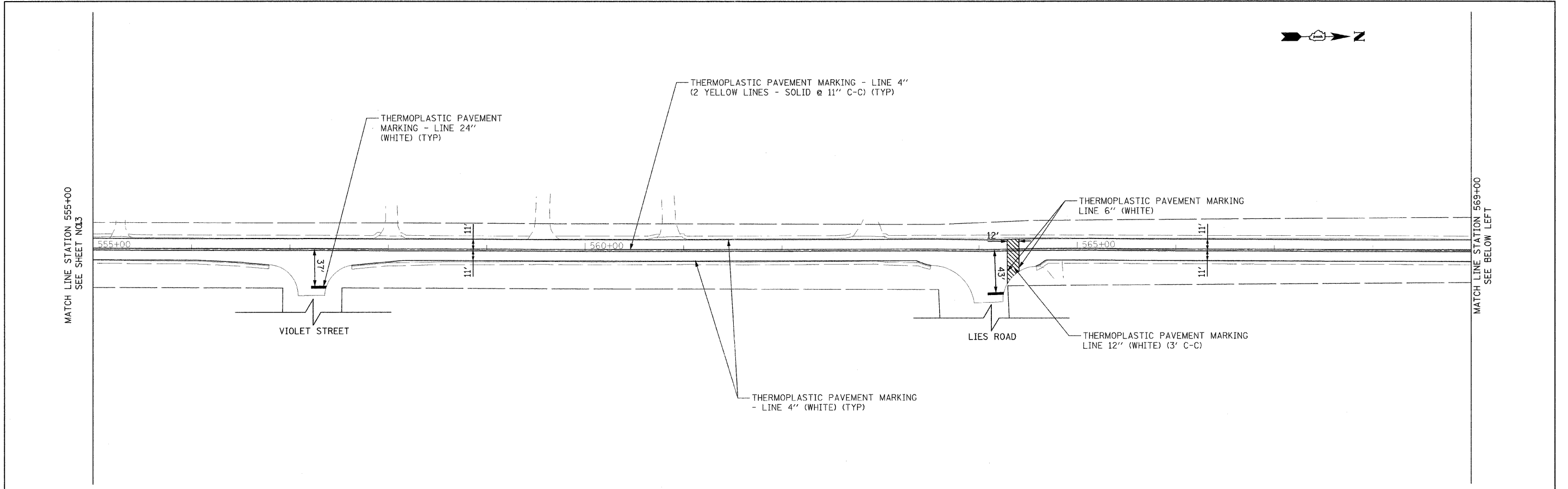

NOTE: SEE TC-13 DISTRICT ONE TYPICAL PAVEMENT MARKINGS FOR GUIDANCE.

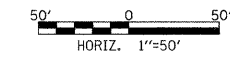

FILE NAME = g:\ch09\0008\road\sheet\PM-503.sht	USER NAME = .USER.	DESIGNED - CEC	REVISED - ---	<b>STATE OF ILLINOIS DEPARTMENT OF TRANSPORTATION</b>	<b>FAIR OAKS ROAD PAVEMENT MARKING PLAN</b>	F.A.U. RTE. 2542	SECTION 11-00057-00-RS	COUNTY DUPAGE	TOTAL SHEETS 32	SHEET NO. 14		
PLOT SCALE = 50.000' / IN.	CHECKED - DWB	REVISED - ---	SCALE: *SCALE			SHEET NO. 3 OF 3 SHEETS	STA. 555+00 TO STA. 581+59	FED. ROAD DIST. NO. ILLINOIS FED. AID PROJECT				
PLOT DATE = 11/1/2011	DATE - 10/24/2011	REVISED - ---	CONTRACT NO. 63653									



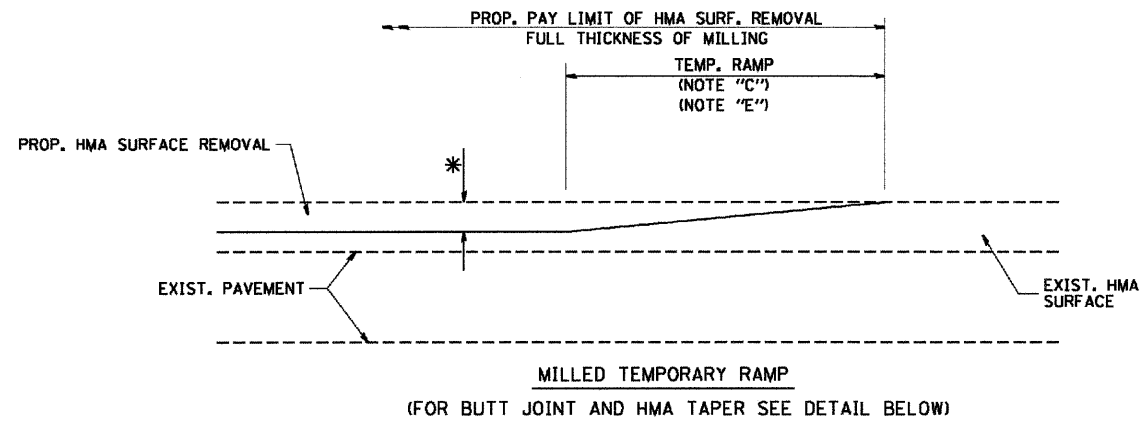

**OPTION 1**

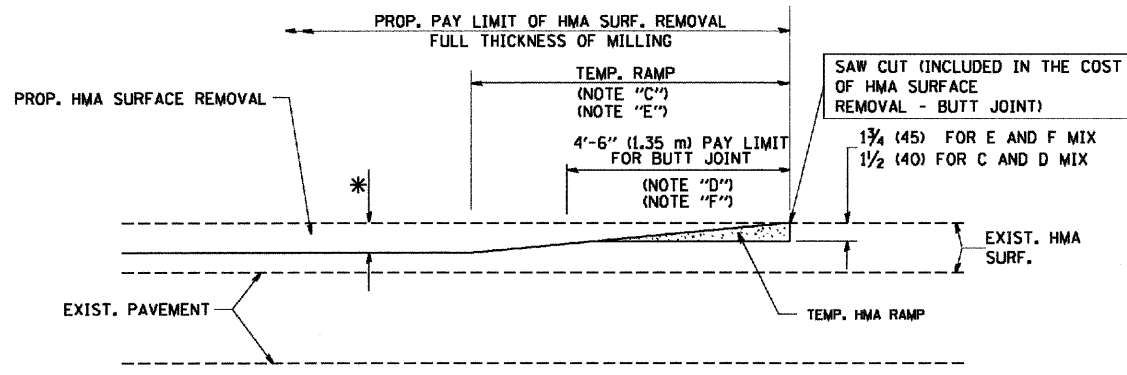

**OPTION 2**  
**TYPICAL TEMPORARY RAMP**

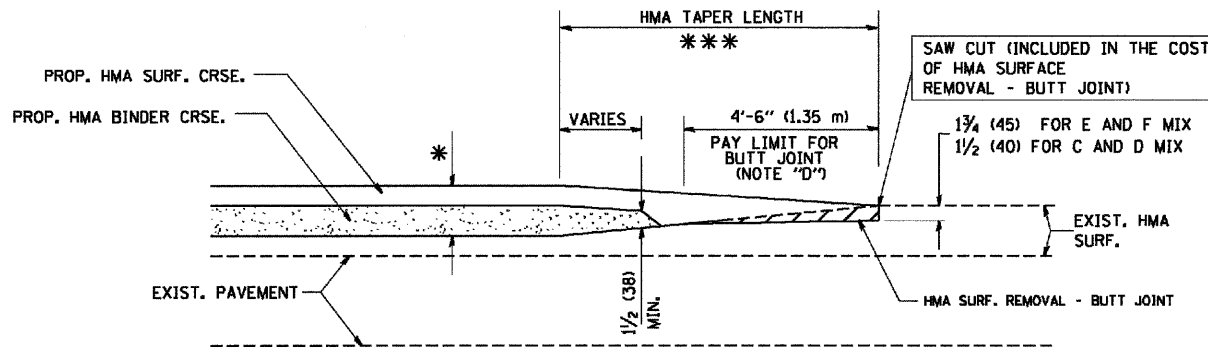

**TYPICAL BUTT JOINT AND HMA TAPER FOR MILLING AND RESURFACING**

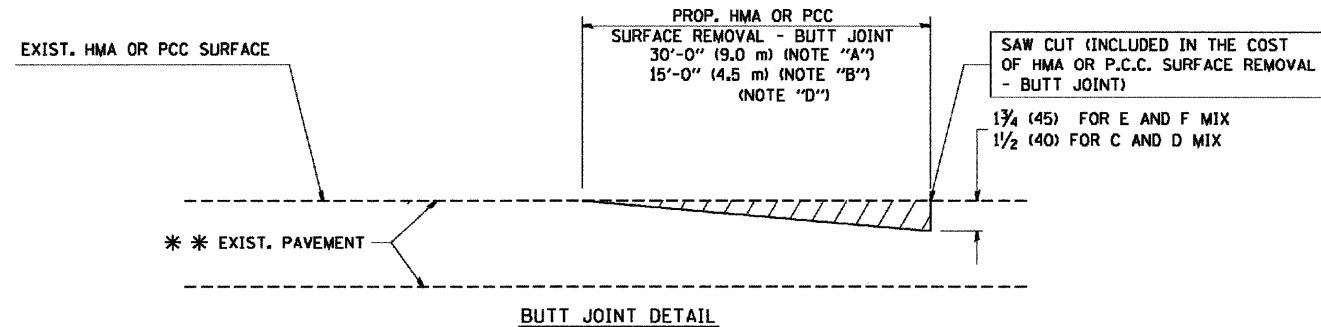

**BUTT JOINT DETAIL**

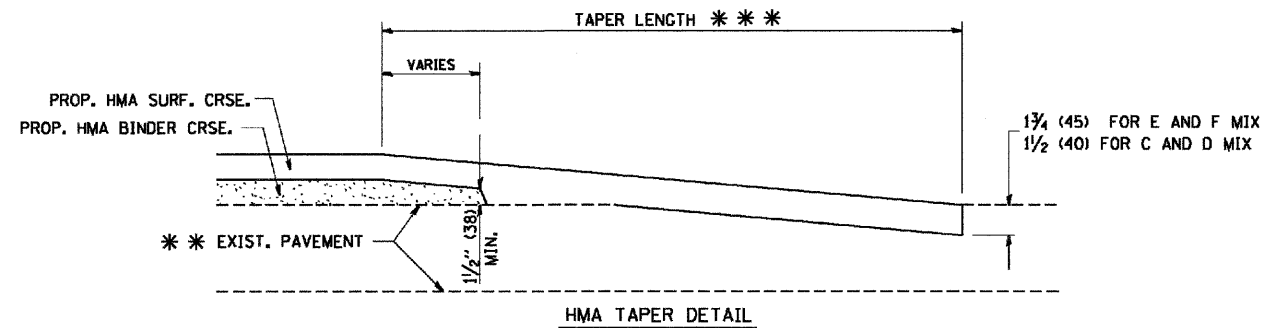

**HMA TAPER DETAIL**

**TYPICAL BUTT JOINT AND HMA TAPER FOR RESURFACING ONLY**

\*\*\* PC CONCRETE, HMA OR HMA RESURFACED PAVEMENT.

**NOTES**

- A: MAINLINE ROADWAYS AND MAJOR SIDE ROADS.
  - B: MINOR SIDE ROADS.
  - C: THE TEMP. RAMP SHALL BE CONSTRUCTED IMMEDIATELY UPON REMOVAL OF THE EXISTING HMA SURFACE.
  - D: THE BUTT JOINT SHALL BE CONSTRUCTED IMMEDIATELY PRIOR TO PLACING THE PROPOSED HMA COURSES.
  - E: TAPER THE TEMP. RAMP AT A RATE OF 3'-0" (900 mm) PER 1 INCH (25 mm) OF MILLING THICKNESS.
  - F: INSTALLATION AND REMOVAL OF THE 4'-6" (1.35 m) TEMP. RAMP IS INCLUDED IN COST OF HMA SURFACE REMOVAL - BUTT JOINT
  - G: SEE ARTICLE 406.08 AND 406.14 OF THE STANDARD SPECIFICATIONS FOR "HMA AND/OR PCC SURFACE REMOVAL, BUTT JOINT".
- \* SEE TYPICAL SECTIONS FOR MILLING THICKNESS.
- \*\*\* 20'-0" (6.1 m) PER 1 (25) RESURFACING (NOTE "A")  
10'-0" (3.0 m) PER 1 (25) RESURFACING (NOTE "B")

**BASIS OF PAYMENT:**

THE BUTT JOINT WILL BE PAID FOR AT THE CONTRACT UNIT PRICE PER SQUARE YARD (SQUARE METER) FOR "HOT-MIX ASPHALT SURFACE REMOVAL - BUTT JOINT" OR FOR "PORTLAND CEMENT CONCRETE SURFACE REMOVAL - BUTT JOINT".

ALL DIMENSIONS ARE IN INCHES (MILLIMETERS) UNLESS OTHERWISE SHOWN.

FILE NAME = W:\cistatd\22x34\bd32.dgn	USER NAME = geglennob	DESIGNED - M. DE YONG	REVISED - R. SHAH 10-25-94
		DRAWN -	REVISED - A. ABBAS 03-21-97
	PLOT SCALE = 50.0000' / IN.	CHECKED -	REVISED - M. GOMEZ 04-06-01
	PLOT DATE = 1/4/2008	DATE - 06-13-90	REVISED - R. BORO 01-01-07

**STATE OF ILLINOIS  
DEPARTMENT OF TRANSPORTATION**

<b>BUTT JOINT AND HMA TAPER DETAILS</b>	
SCALE: NONE	SHEET NO. 1 OF 1 SHEETS STA. TO STA.

F.A.J. RTE.	SECTION	COUNTY	TOTAL SHEETS	SHEET NO.
2542	11-00057-00-RS	DUPAGE	32	16
BD400-05 BD32			CONTRACT NO. 63653	
FED. ROAD DIST. NO. 1 ILLINOIS FED. AID PROJECT				



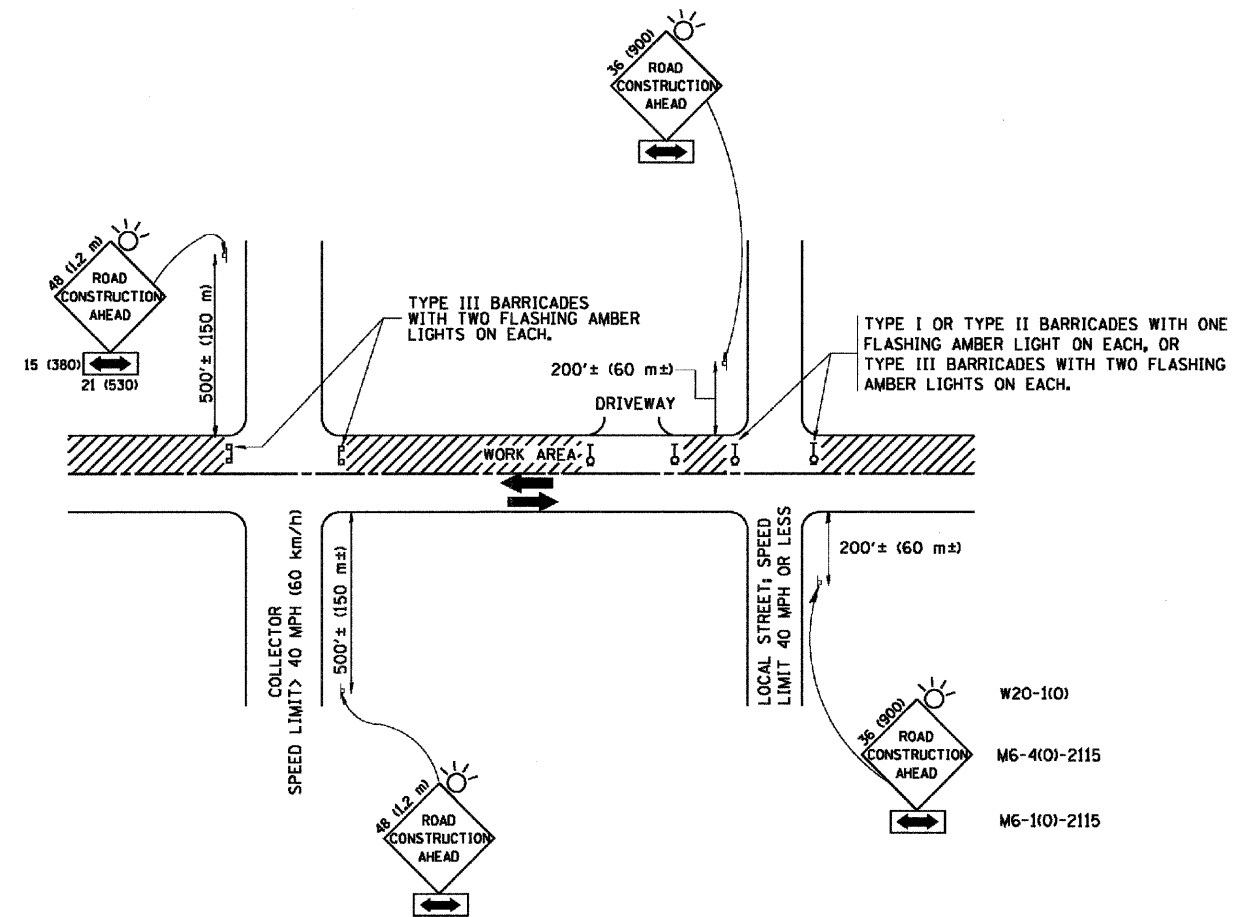

### TRAFFIC CONTROL AND PROTECTION FOR SIDE ROADS, INTERSECTIONS, AND DRIVEWAYS

#### NOTES:

##### A. FOR NO LANE RESTRICTION ON THE SIDE ROAD OR DRIVEWAYS

1. SIDE ROAD WITH A SPEED LIMIT OF 40 MPH (60 km/h) OR LESS AS SHOWN ON THE DRAWING AND AS DIRECTED BY THE ENGINEER:

a) ONE ROAD CONSTRUCTION AHEAD SIGN 36 x 36 (900x900) WITH A FLASHER AND FLAG MOUNTED ON IT APPROXIMATELY 200' (60 m) IN ADVANCE OF THE MAIN ROUTE.

b) THE CLOSED PORTION OF THE MAIN ROUTE SHALL BE PROTECTED BY BLOCKING WITH TYPE I, TYPE II OR TYPE III BARRICADES, 1/3 OF THE CROSS SECTION OF THE CLOSED PORTION.

2. SIDE ROAD WITH A SPEED LIMIT GREATER THAN 40 MPH (60 km/h) AS SHOWN ON THE DRAWING AND AS DIRECTED BY THE ENGINEER:

a) ONE ROAD CONSTRUCTION AHEAD SIGN 48 x 48 (1.2 m x 1.2 m) WITH A FLASHER MOUNTED ON IT APPROXIMATELY 500' (150 m) IN ADVANCE OF THE MAIN ROUTE.

b) THE CLOSED PORTION OF THE MAIN ROUTE SHALL BE PROTECTED BY BLOCKING WITH TYPE III BARRICADES, 1/2 OF THE CROSS SECTION OF THE CLOSED PORTION.

3. WHEN THE SIDE ROAD LIES BETWEEN THE BEGINNING OF THE MAINLINE SIGNING AND THE WORK ZONE, A SINGLE HEADED ARROW (M6-1) SHALL BE USED IN LIEU OF THE DOUBLE HEADED ARROW (M6-4).

##### B. FOR A LANE CLOSURE ON A SIDE ROAD OR DRIVEWAY:

USE APPLICABLE PORTIONS OF THE TYPICAL APPLICATION OF TRAFFIC CONTROL DEVICES (STD. 701501, STD. 701606 OR THE APPROPRIATE STANDARD). THE SPACING OF SIGNS AND BARRICADES SHALL BE ADJUSTED FOR FIELD CONDITIONS AS DIRECTED BY THE ENGINEER. THE DIRECTIONAL ARROW SHALL BE COVERED OR REMOVED WHEN NO LONGER CONSISTENT WITH THE SIDE ROAD LANE CLOSURE.

C. ADVANCE WARNING SIGNS ARE TO BE OMITTED ON DRIVEWAY UNLESS OTHERWISE NOTED.

D. THE TRAFFIC CONTROL AND PROTECTION FOR SIDE ROADS, INTERSECTIONS, AND DRIVEWAYS SHALL BE INCIDENTAL TO THE COST OF SPECIFIED TRAFFIC CONTROL STANDARDS OR ITEMS.

All dimensions are in millimeters (inches) unless otherwise shown.

FILE NAME = W:\diststd\22x34\td16.dgn	USER NAME = ggliorobt	DESIGNED - LHA	REVISED - J. OBERLE 10-18-95
		DRAWN -	REVISED - A. HOUSEH 03-06-96
	PLOT SCALE = 50.000' / IN.	CHECKED -	REVISED - A. HOUSEH 10-15-96
	PLOT DATE = 1/4/2008	DATE - 06-89	REVISED - T. RAMMACHER 01-06-00

STATE OF ILLINOIS  
DEPARTMENT OF TRANSPORTATION

TRAFFIC CONTROL AND PROTECTION FOR  
SIDE ROADS, INTERSECTIONS, AND DRIVEWAYS

SCALE: NONE SHEET NO. 1 OF 1 SHEETS STA. TO STA.

F.A.J. RTE.	SECTION	COUNTY	TOTAL SHEETS	SHEET NO.
2542	11-00057-00-RS	DUPAGE	32	17
TC-10			CONTRACT NO. 63653	
FED. ROAD DIST. NO. 1 ILLINOIS/FED. AID PROJECT				

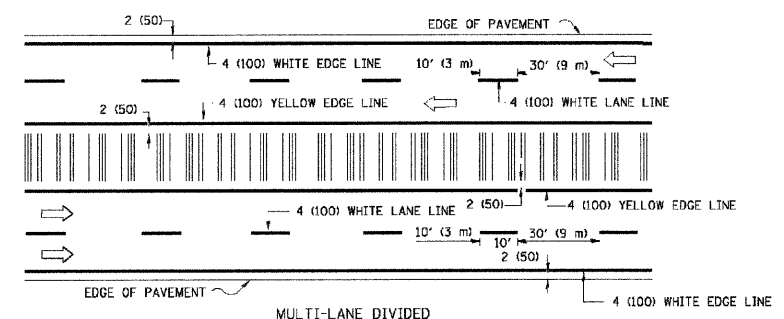
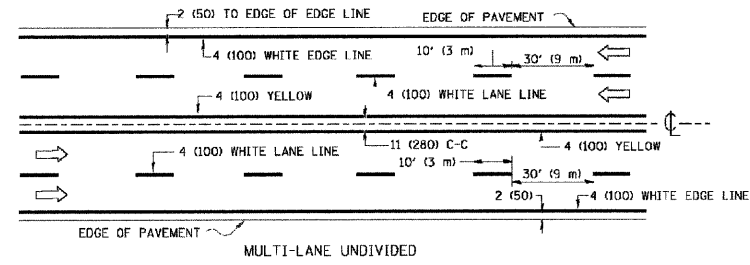
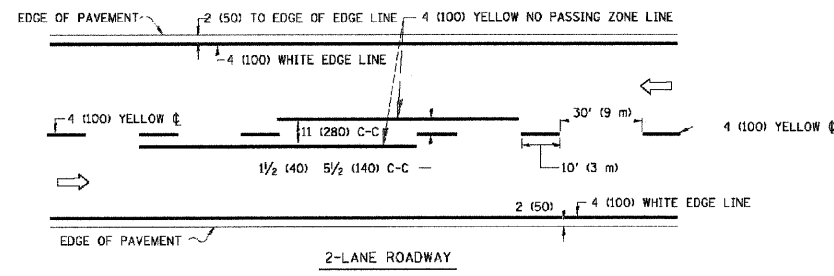

NOTE: MEDIANS WITH BARRIER CURB DO NOT REQUIRE AN EDGE LINE

TYPICAL LANE AND EDGE LINE MARKING

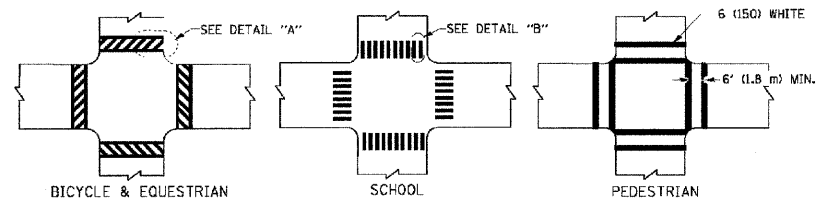

TYPICAL CROSSWALK MARKING

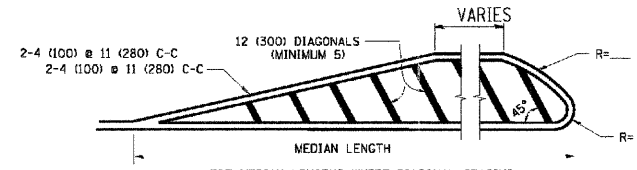
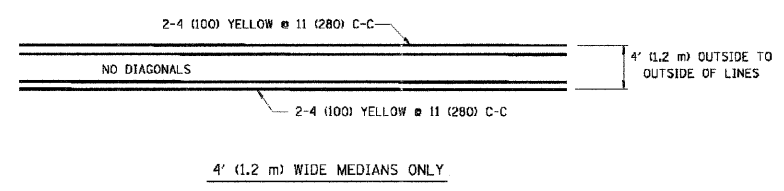

FOR MEDIAN LENGTHS WHERE DIAGONAL SPACING CANNOT BE ATTAINED, USE 5 (FIVE) EQUALLY SPACED DIAGONAL LINES.  
 DIAGONAL LINE SPACING: 50' (15 m) C-C (LESS THAN 30MPH (50 km/h))  
 75' (25 m) C-C 30MPH (50 km/h) TO 45MPH (70 km/h)  
 150' (45 m) C-C (MORE THAN 45MPH (70 km/h))

MEDIANS OVER 4' (1.2 m) WIDE

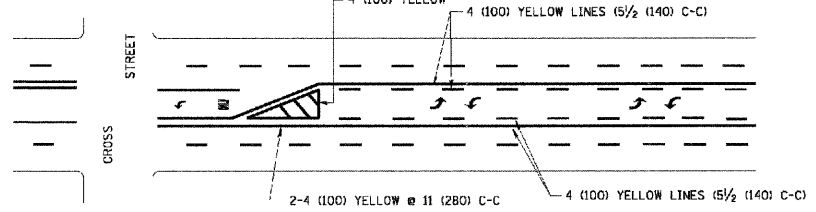

A MINIMUM OF TWO PAIRS OF TURN ARROWS SHALL BE USED, WHITE IN COLOR. ADDITIONAL PAIRS SHALL BE PLACED AT 200' (60 m) TO 300' (90 m) INTERVALS.

TYPICAL PAINTED MEDIAN MARKING

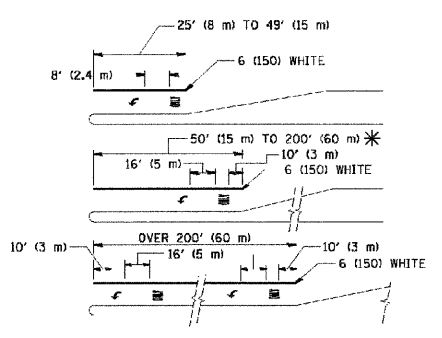

FULL SIZE LETTERS 8' (2.4 m) AND ARROWS SHALL BE USED.  
 \* AREA = 15.6 SQ. FT. (1.5 m<sup>2</sup>) ONLY AREA = 20.8 SQ. FT. (1.9 m<sup>2</sup>)  
 \* TURN LANES IN EXCESS OF 400' (120 m) IN LENGTH MAY HAVE AN ADDITIONAL SET OF ARROW - "ONLY" INSTALLED MIDWAY BETWEEN THE OTHER TWO SETS OF ARROW - "ONLY".

TYPICAL LEFT (OR RIGHT) TURN LANE

TYPICAL TURN LANE MARKING

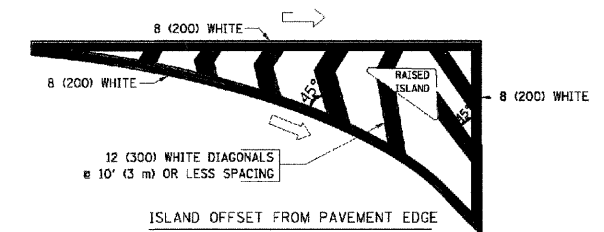

ISLAND OFFSET FROM PAVEMENT EDGE

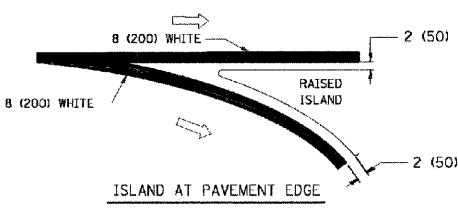

ISLAND AT PAVEMENT EDGE

TYPICAL ISLAND MARKING

TYPE OF MARKING	WIDTH OF LINE	PATTERN	COLOR	SPACING / REMARKS
CENTERLINE ON 2 LANE PAVEMENT	4 (100)	SKIP-DASH	YELLOW	10' (3 m) LINE WITH 30' (9 m) SPACE
CENTERLINE ON MULTI-LANE UNDIVIDED PAVEMENT	2 @ 4 (100)	SOLID	YELLOW	11 (280) C-C
NO PASSING ZONE LINES FOR ONE DIRECTION FOR BOTH DIRECTIONS	4 (100) 2 @ 4 (100)	SOLID SOLID	YELLOW YELLOW	5/2 (140) C-C FROM SKIP-DASH CENTERLINE 11 (280) C-C OMIT SKIP-DASH CENTERLINE BETWEEN
LANE LINES	4 (100) 5 (125) ON FREEWAYS	SKIP-DASH SKIP-DASH	WHITE WHITE	10' (3 m) LINE WITH 30' (9 m) SPACE
DOTTED LINES (EXTENSIONS OF CENTER, LANE OR TURN LANE MARKINGS)	SAME AS LINE BEING EXTENDED	SKIP-DASH	SAME AS LINE BEING EXTENDED	2' (600) LINE WITH 6' (1.8 m) SPACE
EDGE LINES	4 (100)	SOLID	YELLOW-LEFT WHITE-RIGHT	OUTLINE MOUNTABLE MEDIANS IN YELLOW; EDGE LINES ARE NOT USED NEXT TO BARRIER CURB
TURN LANE MARKINGS	6 (150) LINE; FULL SIZE LETTERS & SYMBOLS (8' (2.4 m))	SOLID	WHITE	SEE TYPICAL TURN LANE MARKING DETAIL
TWO WAY LEFT TURN MARKING	2 @ 4 (100) EACH DIRECTION 8' (2.4 m) LEFT ARROW	SKIP-DASH AND SOLID IN PAIRS	YELLOW WHITE	10' (3 m) LINE WITH 30' (9 m) SPACE FOR SKIP-DASH 5/2 (140) C-C BETWEEN SOLID LINE AND SKIP-DASH LINE SEE TYPICAL TWO-WAY LEFT TURN MARKING DETAIL
CROSSWALK LINES (PEDESTRIAN) A. DIAGONALS (BIKE & EQUESTRIAN) B. LONGITUDINAL BARS (SCHOOL)	2 @ 6 (150) 12 (300) @ 45° 12 (300) @ 90°	SOLID SOLID SOLID	WHITE WHITE WHITE	NOT LESS THAN 6' (1.8 m) APART 2' (600) APART SEE TYPICAL CROSSWALK MARKING DETAILS.
STOP LINES	24 (600)	SOLID	WHITE	PLACE 4' (1.2 m) IN ADVANCE OF AND PARALLEL TO CROSSWALKS, IF PRESENT. OTHERWISE, PLACE AT DESIRED STOPPING POINT, PARALLEL TO CROSSROAD CENTERLINE, WHERE POSSIBLE
PAINTED MEDIANS	2 @ 4 (100) WITH 12 (300) DIAGONALS @ 45° NO DIAGONALS USED FOR 4' (1.2 m) WIDE MEDIANS	SOLID	YELLOW; TWO WAY TRAFFIC WHITE; ONE WAY TRAFFIC	11 (280) C-C FOR THE DOUBLE LINE SEE TYPICAL PAINTED MEDIAN MARKING.
GORE MARKING AND CHANNELIZING LINES	8 (200) WITH 12 (300) DIAGONALS @ 45°	SOLID	WHITE	DIAGONALS: 15' (4.5 m) C-C (LESS THAN 30MPH (50 km/h)) 20' (6 m) C-C 30MPH (50 km/h) TO 45MPH (70 km/h) 30' (9 m) C-C (OVER 45MPH (70 km/h))
RAILROAD CROSSING	24 (600) TRANSVERSE LINES; "RR" IS 6' (1.8 m) LETTERS: 16 (400) LINE FOR "X"	SOLID	WHITE	SEE STATE STANDARD 780001 AREA OF: "R"=3.6 SQ. FT. (0.33 m <sup>2</sup> ) EACH "X"=84.0 SQ. FT. (7.8 m <sup>2</sup> )
SHOULDER DIAGONALS	12 (300) @ 45°	SOLID	WHITE - RIGHT YELLOW - LEFT	50' (15 m) C-C (LESS THAN 30MPH (50 km/h)) 75' (25 m) C-C (30 MPH (50 km/h) TO 45MPH (70 km/h)) 150' (45 m) C-C (OVER 45MPH (70 km/h))

FOR FURTHER DETAILS ON PAVEMENT MARKING REFER TO STANDARD SPECIFICATIONS FOR ROAD AND BRIDGE CONSTRUCTION AND STATE STANDARD 780001.

All dimensions are in inches (millimeters) unless otherwise shown.

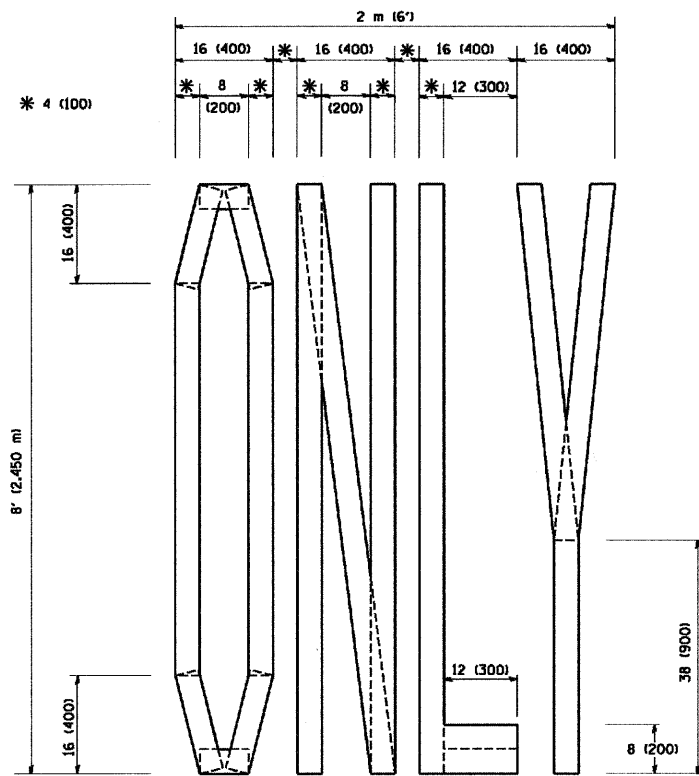

QUANTITY  
 4 (100) LINE = 64.1 ft. (19.7 m)  
 21.1 sq. ft. (1.97 sq. m)

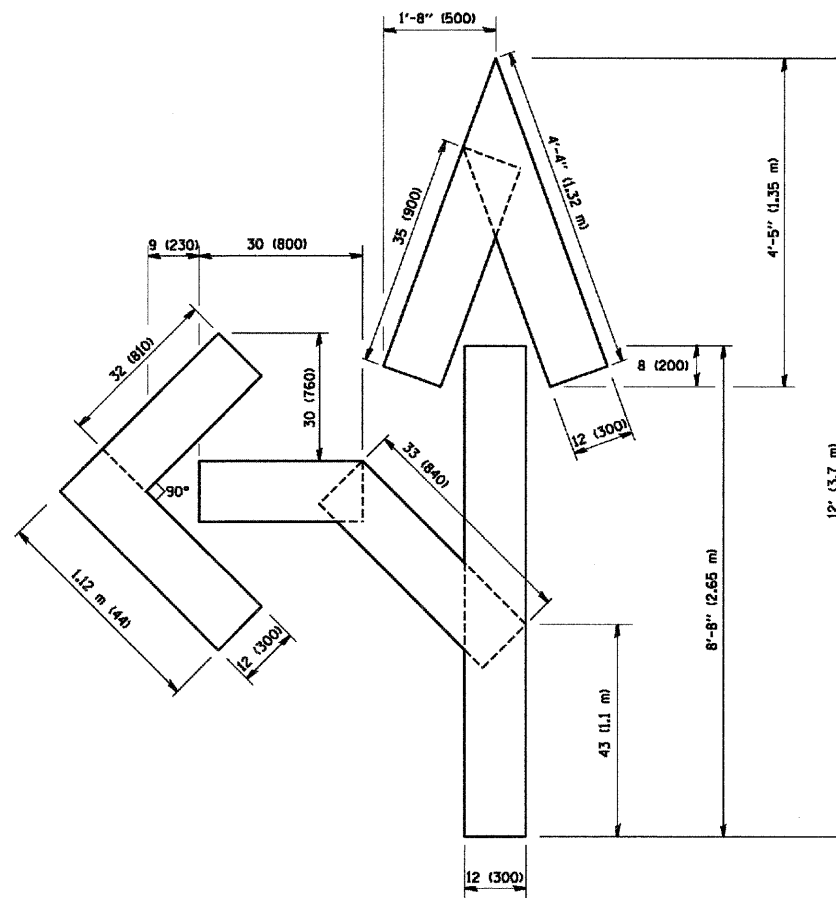

QUANTITY  
 4 (100) LINE = 82.5 ft. (25.3 m)  
 27.5 sq. ft. (2.53 sq. m)

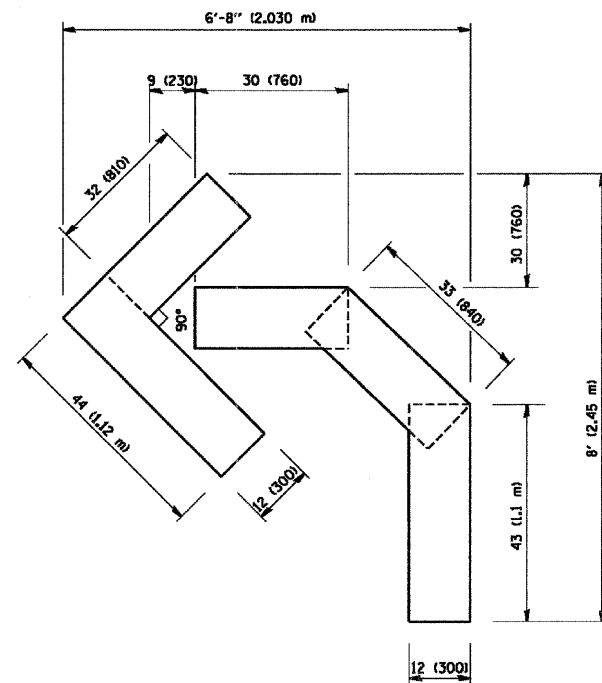

QUANTITY  
 4 (100) LINE = 45.5 ft. (13.9 m)  
 15.2 sq. ft. (1.39 sq. m)

All dimensions are in Inches (millimeters) unless otherwise shown.

FILE NAME = W:\distatd\22x34\to16.dgn	USER NAME = geglennob	DESIGNED -	REVISED - T. RAMMACHER 06-05-96	<b>STATE OF ILLINOIS DEPARTMENT OF TRANSPORTATION</b>	<b>PAVEMENT MARKING LETTERS AND SYMBOLS FOR TRAFFIC STAGING</b>	F.A.J. RTE.	SECTION	COUNTY	TOTAL SHEETS	SHEET NO.		
		DRAWN -	REVISED - T. RAMMACHER 11-04-97			2542	11-00057-00-RS	DUPAGE	32	19		
		PLOT SCALE = 50.0000' / IN.	REVISED - T. RAMMACHER 03-02-98			<b>TC-16</b>		CONTRACT NO. 63653				
		PLOT DATE = 1/4/2008	REVISED - E. GOMEZ 08-28-00			SCALE: NONE	SHEET NO. 1 OF 1 SHEETS	STA.	TO STA.		FED. ROAD DIST. NO. 1	ILLINOIS FED. AID PROJECT
		DATE = 09-18-94										

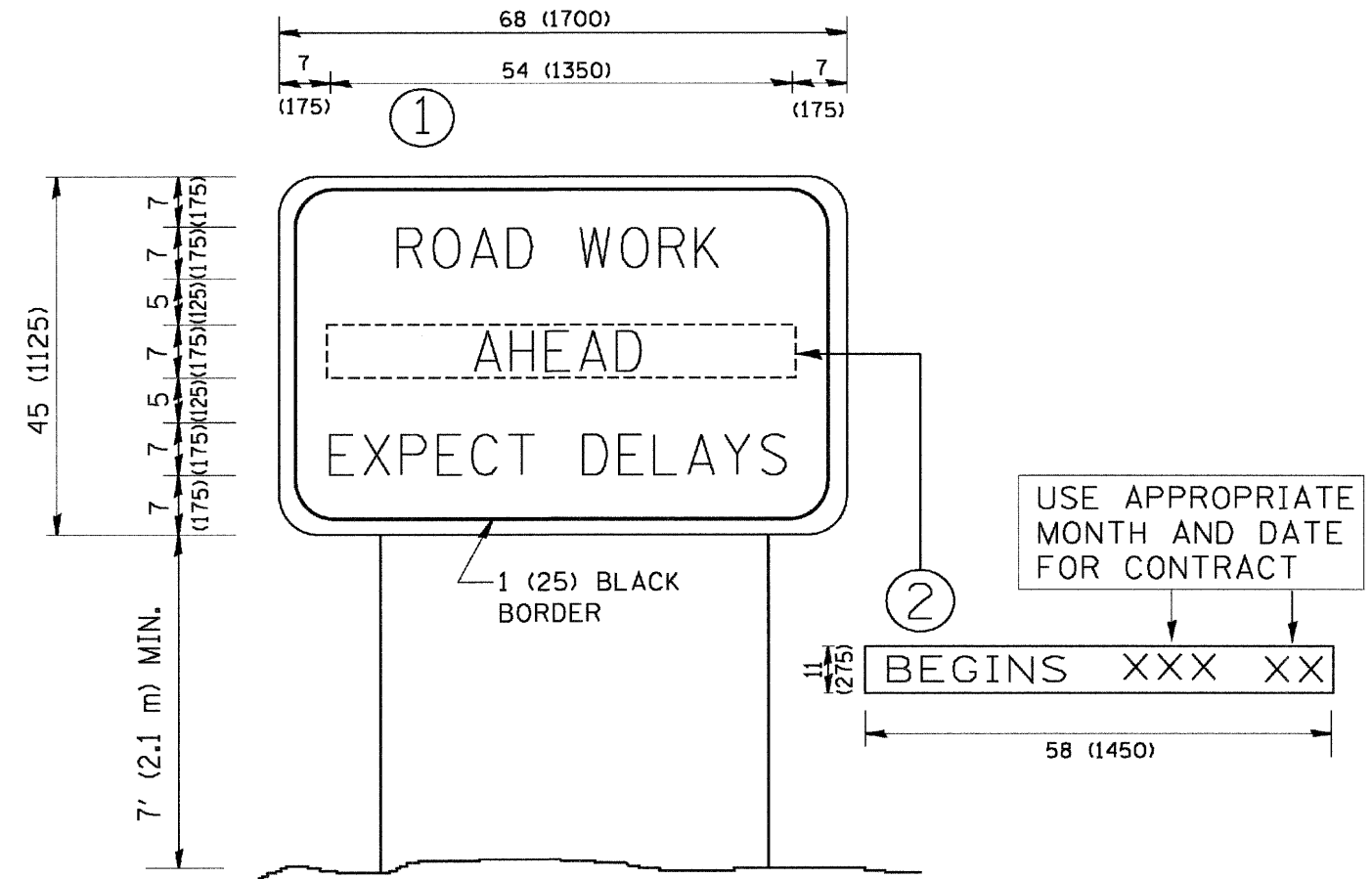

**NOTES:**

1. USE BLACK LETTERING ON ORANGE BACKGROUND.
2. ERECT SIGNS IN ADVANCE OF THE LOCATION FOR THE "ROAD CONSTRUCTION AHEAD" SIGN AT LOCATIONS AS DIRECTED BY THE ENGINEER.
3. ERECT SIGN ① WITH INSTALLED PANEL ② ONE WEEK PRIOR TO THE START OF CONSTRUCTION.
4. REMOVE PANEL ② SOON AFTER THE START OF CONSTRUCTION.
5. SEE SPECIAL PROVISION FOR "TEMPORARY INFORMATION SIGNING" FOR ADDITIONAL INFORMATION.
6. ONE SIGN ASSEMBLY EQUALS 25.70 SQ. FT. (2.3 SQ. M.)
7. SHALL BE PAID FOR AS TEMPORARY INFORMATION SIGNING.

ALL DIMENSIONS ARE IN INCHES (MILLIMETERS) UNLESS OTHERWISE SHOWN.

FILE NAME = W:\dists\td\22x34\to22.dgn	USER NAME = gaglianobt	DESIGNED - DRAWN -	REVISED - REVISED -
		DESIGNED - CHECKED -	REVISED - REVISED -
		DESIGNED - DATE -	REVISED - REVISED -

**STATE OF ILLINOIS  
DEPARTMENT OF TRANSPORTATION**

**ARTERIAL ROAD  
INFORMATION SIGN**

SCALE: NONE SHEET NO. 1 OF 1 SHEETS STA. TO STA.

F.A.U. RTE.	SECTION	COUNTY	TOTAL SHEETS	SHEET NO.
2542	11-00057-00-RS	DUPAGE	32	20
TC-22			CONTRACT NO. 63653	
FED. ROAD DIST. NO. 1 ILLINOIS FED. AID PROJECT				

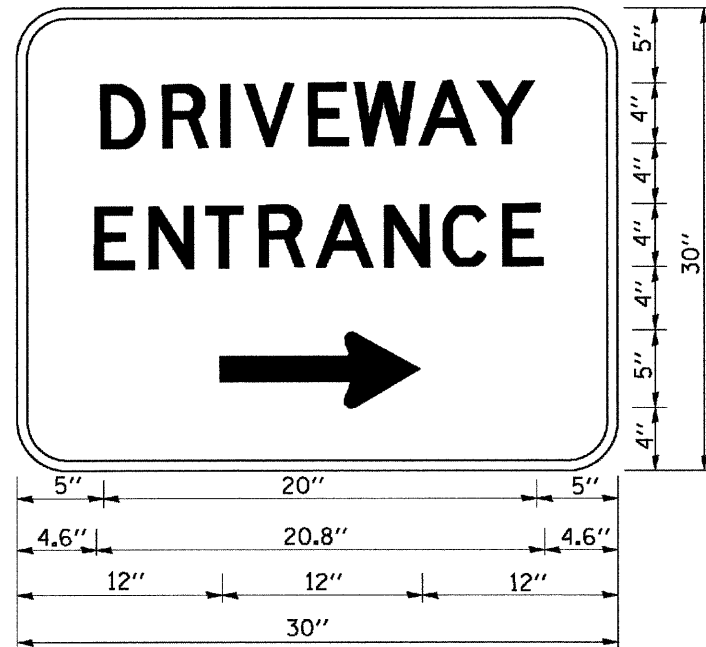

3.0" RADIUS, 0.5" BORDER, WHITE ON GREEN; REFLECTORIZED  
 "DRIVEWAY" D; "ENTRANCE" D; STANDARD ARROW CUSTOM 12.0" x 5.0"

**NOTES:**

1. HALF OF THE SIGNS WILL REQUIRE A LEFT HAND FACING ARROW.
2. TWO SIGNS SHALL BE USED AT EACH COMMERCIAL ENTRANCE PLACED BACK-TO-BACK: ONE WITH A RIGHT HAND ARROW (SHOWN) SHALL BE PLACED ON THE NEAR RIGHT SIDE THE DRIVEWAY AND ONE WITH A LEFT HAND ARROW SHALL BE PLACED ON THE FAR LEFT SIDE OF THE DRIVEWAY.
3. SIGNS TO BE PAID FOR AS ITEM "TEMPORARY INFORMATION SIGNING".

FILE NAME = M:\distatd\22x34\to26.dgn	USER NAME = gaglienob	DESIGNED -	REVISED - C. JUCIUS 02-15-07	<b>STATE OF ILLINOIS DEPARTMENT OF TRANSPORTATION</b>	<b>DRIVEWAY ENTRANCE SIGNING</b>			F.A.I. RTE.	SECTION	COUNTY	TOTAL SHEETS	SHEET NO.
	PLOT SCALE = 50.000' / IN.	CHECKED -	REVISED -					2542	11-00057-00-RS	DUPAGE	32	21
PLOT DATE = 1/4/2008	DATE -	REVISED -	REVISED -	SCALE: NONE	SHEET NO. 1	OF 1	SHEETS	STA.	TO STA.	TC-26 FED. ROAD DIST. NO. 1 (ILLINOIS) FED. AID PROJECT CONTRACT NO. 63653		

















FINAL SURVEY	SURVISED
NOTE BOOK NO.	PLOTTED
NO.	TEMPLATE
	AREAS CHECKED

ORIGINAL SURVEY	SURVISED
NOTE BOOK NO.	PLOTTED
NO.	TEMPLATE
	AREAS CHECKED

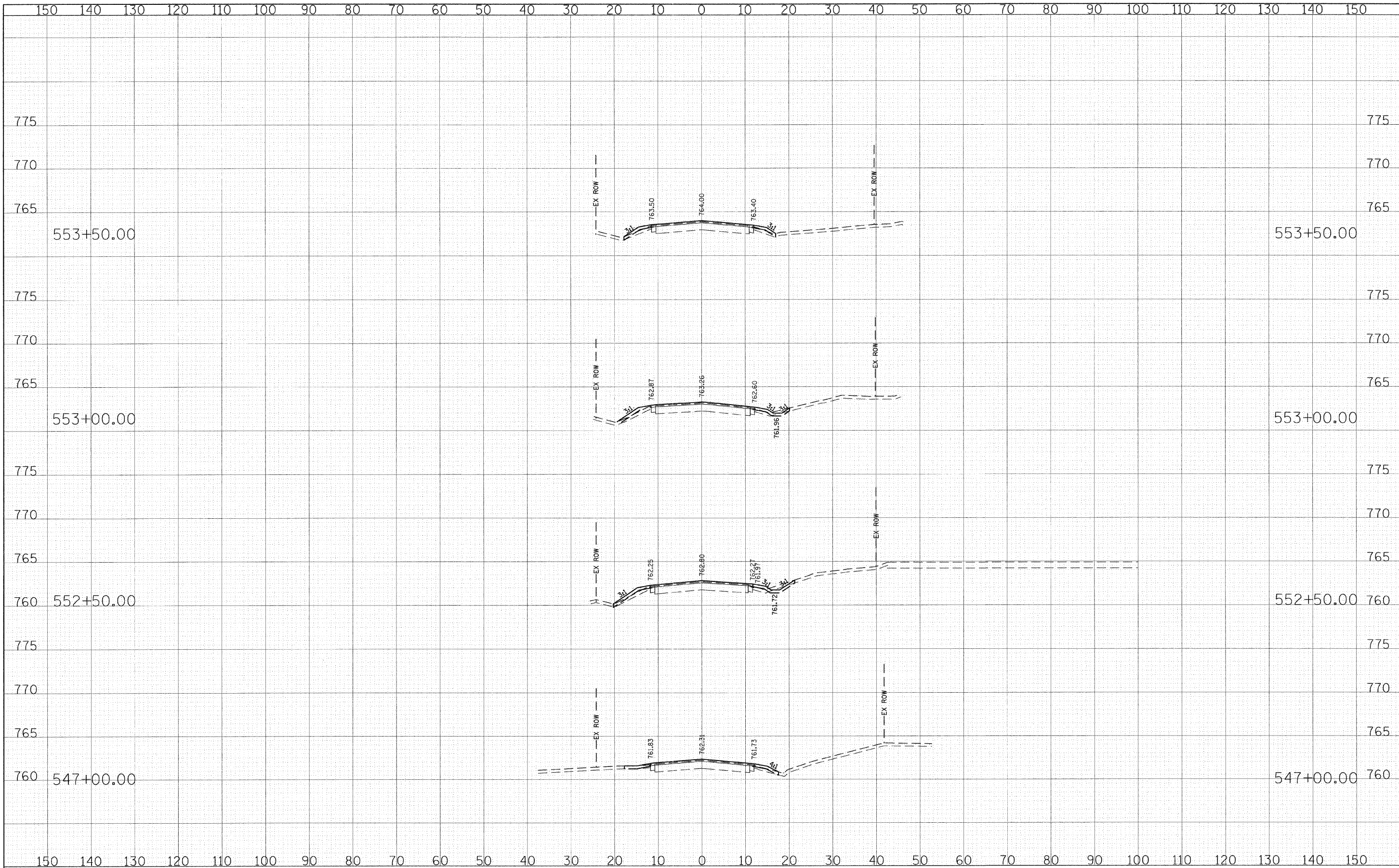











FINAL SURVEY	SURVEYED	DATE
NOTE BOOK	PLOTTED	BY
NO.	TEMPLATE	
	AREAS CHECKED	

ORIGINAL SURVEY	SURVEYED	DATE
NOTE BOOK	PLOTTED	BY
NO.	TEMPLATE	
	AREAS CHECKED	

