

Drawing file: W:\Projects\60011046 - Division Street IEP\DOT MARKINGS.dwg Nov 10, 2011 - 10:29am

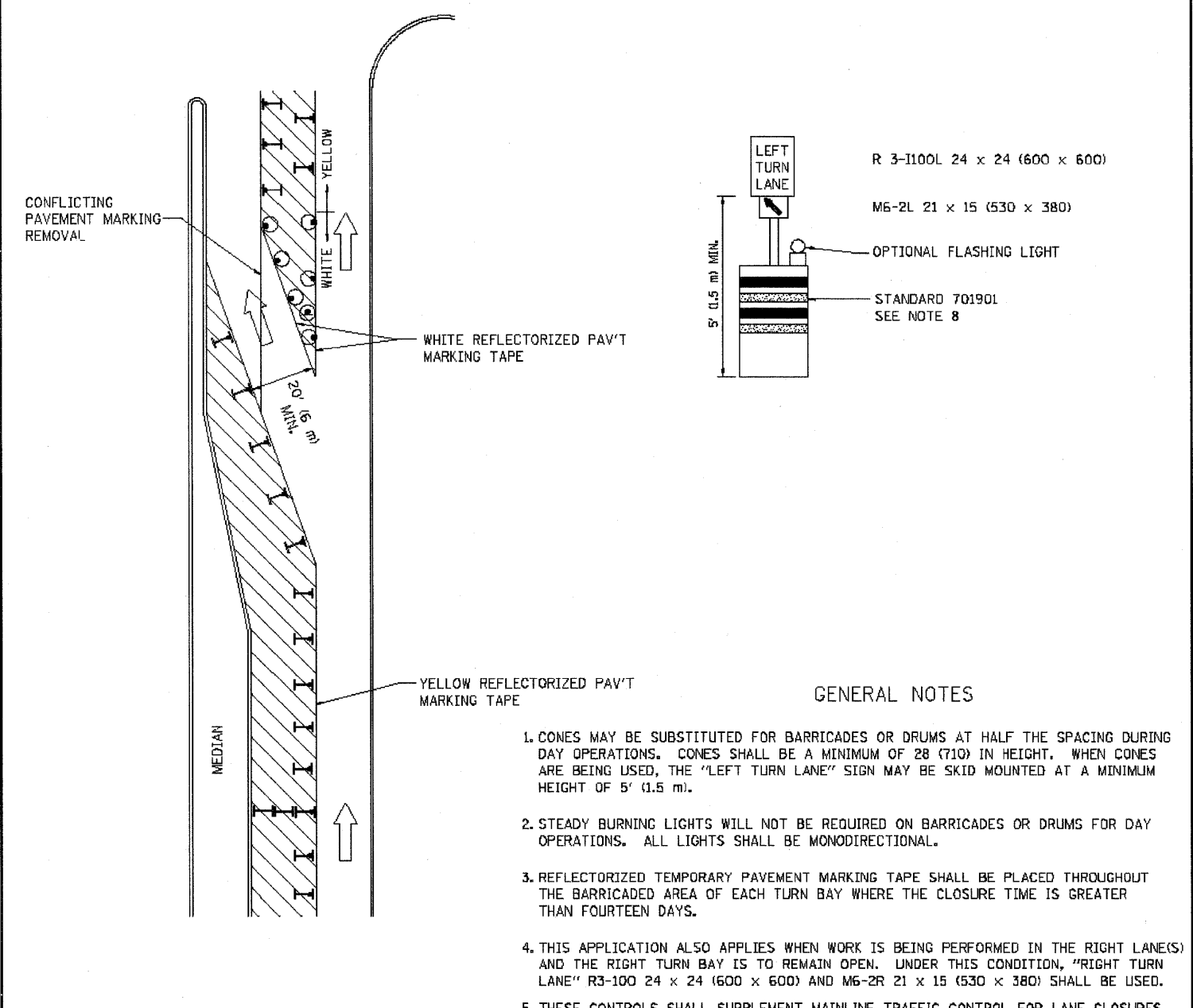

**GENERAL NOTES**

1. CONES MAY BE SUBSTITUTED FOR BARRICADES OR DRUMS AT HALF THE SPACING DURING DAY OPERATIONS. CONES SHALL BE A MINIMUM OF 28 (710) IN HEIGHT. WHEN CONES ARE BEING USED, THE "LEFT TURN LANE" SIGN MAY BE SKID MOUNTED AT A MINIMUM HEIGHT OF 5' (1.5 m).
2. STEADY BURNING LIGHTS WILL NOT BE REQUIRED ON BARRICADES OR DRUMS FOR DAY OPERATIONS. ALL LIGHTS SHALL BE MONODIRECTIONAL.
3. REFLECTORIZED TEMPORARY PAVEMENT MARKING TAPE SHALL BE PLACED THROUGHOUT THE BARRICADED AREA OF EACH TURN BAY WHERE THE CLOSURE TIME IS GREATER THAN FOURTEEN DAYS.
4. THIS APPLICATION ALSO APPLIES WHEN WORK IS BEING PERFORMED IN THE RIGHT LANE(S) AND THE RIGHT TURN BAY IS TO REMAIN OPEN. UNDER THIS CONDITION, "RIGHT TURN LANE" R3-100 24 x 24 (600 x 600) AND M6-2R 21 x 15 (530 x 380) SHALL BE USED.
5. THESE CONTROLS SHALL SUPPLEMENT MAINLINE TRAFFIC CONTROL FOR LANE CLOSURES.
6. LONGITUDINAL DIMENSIONS MAY BE ADJUSTED TO FIT FIELD CONDITIONS.
7. FORM OPER 725 IS REQUIRED.
8. IF A DRUM OR TYPE II BARRICADE WITH AN ATTACHED SIGN PANEL WHICH MEETS NCHRP 350 REQUIREMENTS IS NOT AVAILABLE, THE SIGNS SHALL BE MOUNTED, ABOVE THE BARRICADES, ON SEPARATE SIGNS SUPPORTS THAT MEET NCHR 350 PREQUIREMENTS.
9. TRAFFIC CONTROL AND PROTECTION AT TURN BAYS (TO REMAIN OPEN TO TRAFFIC) SHALL BE INCLUDED IN THE COST SPECIFIED TRAFFIC CONTROL STANDARDS OR ITEMS.

All dimensions are in inches (millimeters) unless otherwise shown.

**LEGEND**

- WORK AREA
- LANE OPEN TO TRAFFIC
- TYPE I OR II BARRICADE WITH STEADY BURN LIGHT
- DRUM WITH STEADY BURN LIGHT
- DRUM WITH SIGN (WITH OPTIONAL FLASHING LIGHT) SEE DETAIL
- TYPE I OR II CHECK BARRICADE WITH FLASHING LIGHT

|   |                                 |                                 |                            |   |  |              |                |  |              |           |
|---|---------------------------------|---------------------------------|----------------------------|---|--|--------------|----------------|--|--------------|-----------|
| FILE NAME =                               | USER NAME = drsvrakcagn         | REVISED - T. RAMMACHER 09-08-94 | REVISED - R. BORO 09-14-09 | <b>STATE OF ILLINOIS<br/>DEPARTMENT OF TRANSPORTATION</b> | <b>TRAFFIC CONTROL AND PROTECTION AT TURN BAYS<br/>(TO REMAIN OPEN TO TRAFFIC)</b> | F.A. RTE. =  | SECTION        | COUNTY   | TOTAL SHEETS | SHEET NO. |
| ar\pwwork\VP\DOT\DRIVAKOSGN\010831614.dgn | REVISED - A. HOUSEH 11-07-95    | REVISED -                       | REVISED -                  |   |  | 1026         | 10-00116-00-SW | COOK   | 40           | 40        |
| PLOT SCALE = 49.9999' / IN                | REVISED - A. HOUSEH 10-12-96    | REVISED -                       | REVISED -                  |   |  | <b>TC-14</b> |                | CONTRACT NO. 63654   |              |           |
| PLOT DATE = 9/14/2009                     | REVISED - T. RAMMACHER 01-06-00 | REVISED -                       | REVISED -                  | SCALE: NONE   | SHEET NO. 1 OF 1 SHEETS  | STA.         | TO STA.        | FED. ROAD DIST. NO. 1 (ILLINOIS) FED. AID PROJECT M-TE-00D1(825) |              |           |
| E.H.E. PROJECT NO. 600-11-04602           |                                 |                                 |                            |   |  |              |                |  |              |           |