

1-20-2012 LETTING ITEM 032

STATE OF ILLINOIS
DEPARTMENT OF TRANSPORTATION
DIVISION OF HIGHWAYS

PLANS FOR PROPOSED FEDERAL AID HIGHWAY

CARY COMMUNITY TRAIL LANDSCAPING
THREE OAKS ROAD AND SOUTH RAWSON BRIDGE ROAD
CARY PARK DISTRICT
McHENRY COUNTY

SECTION NO. 06-P4001-01-BT
PROJECT NO. TE-00D1(839)
JOB NUMBER C-91-178-11
COMMUNITY TRAIL LANDSCAPING
OCTOBER 21, 2011

SECTION	COUNTY	TOTAL SHEETS	SHEET NO.
06-P4001-01-BT	McHENRY	7	1
FED. ROAD DIST. NO. 1 ILLINOIS		CONTRACT NO. 63656	

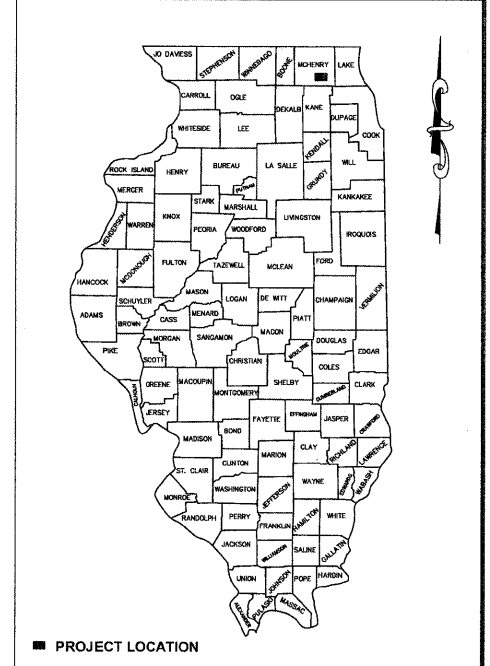

INDEX OF SHEETS

DESCRIPTION	SHEET NO.
TITLE SHEET	1
SUMMARY OF QUANTITIES	2
GENERAL NOTES AND HIGHWAY STANDARDS	3
OVERALL EXISTING CONDITIONS	4
LANDSCAPING PLAN	5-6
DETAILS	7

LEGEND

EXISTING	PROPOSED
PROPERTY LINE	PROPOSED EASEMENT
EASEMENT LINE	EXISTING BIKE TRAIL
EXISTING CONTOUR	EXISTING SIDEWALK
EXISTING SPOT ELEVATION	SILT FENCE
EXISTING FIRE HYDRANT	PROPOSED SIGN
EXISTING MANHOLE	PROPOSED TREE/SHRUB
EXISTING CATCH BASIN	
EXISTING GAS LINE	
EXISTING POWER LINE	
EXISTING UTILITY POLE	
EXISTING TREE	
EXISTING TREE LINE	
EXISTING FENCE	
EXISTING LIGHT POLE	
EXISTING SIGN	

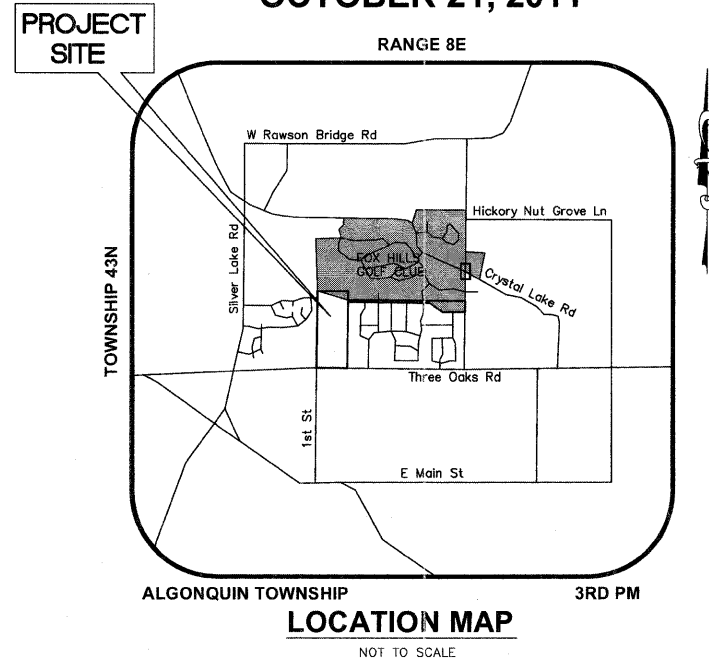

GROSS LENGTH OF PROJECT CORRIDOR= 9,557 LINEAL FEET (1.81 MILES)
NET LENGTH OF PROJECT CORRIDOR= 9,557 LINEAL FEET (1.81 MILES)

PEDESTRIAN TRAFFIC DATA FOR EXISTING TRAIL

POSTED: 20 MPH
DESIGN: 20 MPH
ADT: 100 PEDESTRIAN USERS PER DAY
FUNCTIONAL CLASSIFICATION: SHARED USE PATH
(THIS PROJECT INCLUDES ONLY LANDSCAPE IMPROVEMENTS FOR RECENTLY COMPLETED TRAIL PROJECT IDOT CONTRACT 63333)

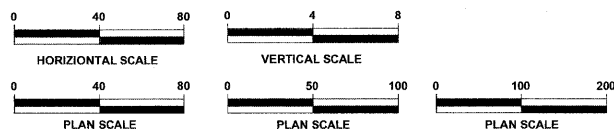

FULL SIZE PLANS HAVE BEEN PREPARED USING STANDARD ENGINEERING SCALES. REDUCED SIZED PLANS WILL NOT CONFORM TO STANDARD SCALES.

CONTRACT NO. 63656



Kimley-Horn
and Associates, Inc.

© 2011 KIMLEY-HORN & ASSOCIATES, INC.
205 WEST WACKER DRIVE, SUITE 2125
CHICAGO, ILLINOIS 60605-1418
Tel. No. (312) 726-9445
Fax No. (312) 726-9449

STATE OF ILLINOIS
DEPARTMENT OF TRANSPORTATION
DIVISION OF HIGHWAYS

APPROVED October 20th 2011
J. Riva
DIRECTOR OF PLANNING AND DEVELOPMENT, CARY PARK DISTRICT

PASSED November 9 2011
CHH CHRISTOPHER HOLT
DISTRICT 1 ENGINEER OF LOCAL ROADS AND STREETS

RELEASING FOR BID BASED ON LIMITED REVIEW NOVEMBER 9, 2011
Diana M. O'Keefe DE
DEPUTY DIRECTOR OF HIGHWAYS, REGION ONE ENGINEER

John W. Hart III 10/21/11
ENGINEER DATE

JOHN W. HART III
ILLINOIS REGISTRATION No. 062-061331
EXPIRATION DATE: 11/30/2011
Date of Signature: 10/21/11
Date of Expiration: 11-30-11



J.U.L.I.E
JOINT UTILITY LOCATION INFORMATION FOR EXCAVATION
8-1-1 OR 1-800-892-0123

PRINTED BY THE AUTHORITY OF THE STATE OF ILLINOIS

PROGRAM AND OFFICE ENGINEER: CHARLES F. RIDDLE, P.E. 847-705-4406 SCHAMBURG, IL

This document, together with the contracts and design presented herein, is intended only for the specific purpose and client for which it was prepared. Reuse or modification of any part of this document without the written authorization and approval of Kimley-Horn and Associates, Inc. shall be without liability to Kimley-Horn and Associates, Inc.

SUMMARY OF QUANTITIES

PAY CODE	ITEM DESCRIPTION	UNIT	TOTAL (0031)
25000115	SEEDING, CLASS 1B	ACRE	0.25
67100100	MOBILIZATION	L SUM	1.00
A2002920	TREE, CELTIS OCCIDENTALIS (COMMON HACKBERRY), 2-1/2" CALIPER, BALLED AND BURLAPPED	EACH	10.00
A2005020	TREE, GYMNOCLADUS DIOICUS (KENTUCKY COFFEETREE), 2-1/2" CALIPER, BALLED AND BURLAPPED	EACH	8.00
A2005116	TREE, JUGLANS NIGRA (BLACK WALNUT), 2" CALIPER, BALLED AND BURLAPPED	EACH	2.00
A2006720	TREE, QUERCUS MACROCARPA (BUR OAK), 2-1/2" CALIPER, BALLED AND BURLAPPED	EACH	25.00
A2007120	TREE, QUERCUS RUBRA (RED OAK), 2-1/2" CALIPER, BALLED AND BURLAPPED	EACH	4.00
B2001116	TREE, CERCIS CANADENSIS (EASTERN REDBUD), 2" CALIPER, TREE FORM, BALLED AND BURLAPPED	EACH	8.00
B2001766	TREE, CRATAEGUS CRUSGALLI INERMIS CRUZAM (CRUSA DER THORNLESS COCKSPUR HAWTHORN), 6' HEIGHT, SHRUB FORM, BALLED AND BURLAPPED	EACH	6.00
B2000866	TREE, AMELANCHIER X GRANDIFLORA COLE'S SELECT (COLE'S SELECT SERVICEBERRY), 6' HEIGHT, SHRUB FORM, BALLED AND BURLAPPED	EACH	2.00
C2002036	SHRUB, CORYLUS AMERICANA (AMERICAN FILBERT), 3' HEIGHT, BALLED AND BURLAPPED	EACH	30.00
C2003424	SHRUB, HYDRANGEA ARBORESCENS ANNABELLE (ANNABELLE SMOOTH HYDRANGEA), 2' HEIGHT, BALLED AND BURLAPPED	EACH	18.00
C2012036	SHRUB, VIBURNUM DENTATUM SYNNESTVEDT (ARROWWOOD VIBURNUM 'CHICAGO LUSTRE'), 3' HEIGHT, BALLED AND BURLAPPED	EACH	29.00
C2005018	SHRUB, POTENTILLA FRUTICOSA GOLDFINGER (GOLDFINGER BUSH CINQUEFOIL), 18" HEIGHT BALLED AND BURLAPPED	EACH	12.00
D2000184	EVERGREEN, ABIES CONCOLOR (WHITE FIR), 7' HEIGHT, BALLED AND BURLAPPED	EACH	5.00
D2003836	EVERGREEN, THUJA OCCIDENTALIS 'TECHNY' (TECHNY ARBORVITAE), 3' HEIGHT CONTAINER	EACH	3.00
K1005481	SHREDDED BARK MULCH (3" DEPTH)	SQ YD	250.00
25200200	SUPPLEMENTAL WATERING	UNIT	1.00

This document, together with the concepts and designs presented herein, is intended only for the specific purpose and site for which it was prepared. Review or and improper reliance on this document without written authorization and adaptation by Kinney-Horn and Associates, Inc. shall be without liability to Kinney-Horn and Associates, Inc. Drawing name: C:\Users\jwh\Desktop\Drawings\06-P4001-01-BT.dwg Date: 10/21/2011 12:13pm by jwh



1-800-892-0123

DESIGNED - JWH	REVISED	STATE OF ILLINOIS DEPARTMENT OF TRANSPORTATION	CARY PARK DISTRICT CARY TRAIL LANDSCAPING	SUMMARY OF QUANTITIES	SECTION	COUNTY	TOTAL SHEETS	SHEET NO.
DRAWN - JKM	REVISED				06-P4001-01-BT	MCHENRY	7	2
CHECKED - JWH	REVISED				FED. ROAD DIST. NO. 1	ILLINOIS	CONTRACT NO. 63856	
DATE - 10/21/2011	REVISED							

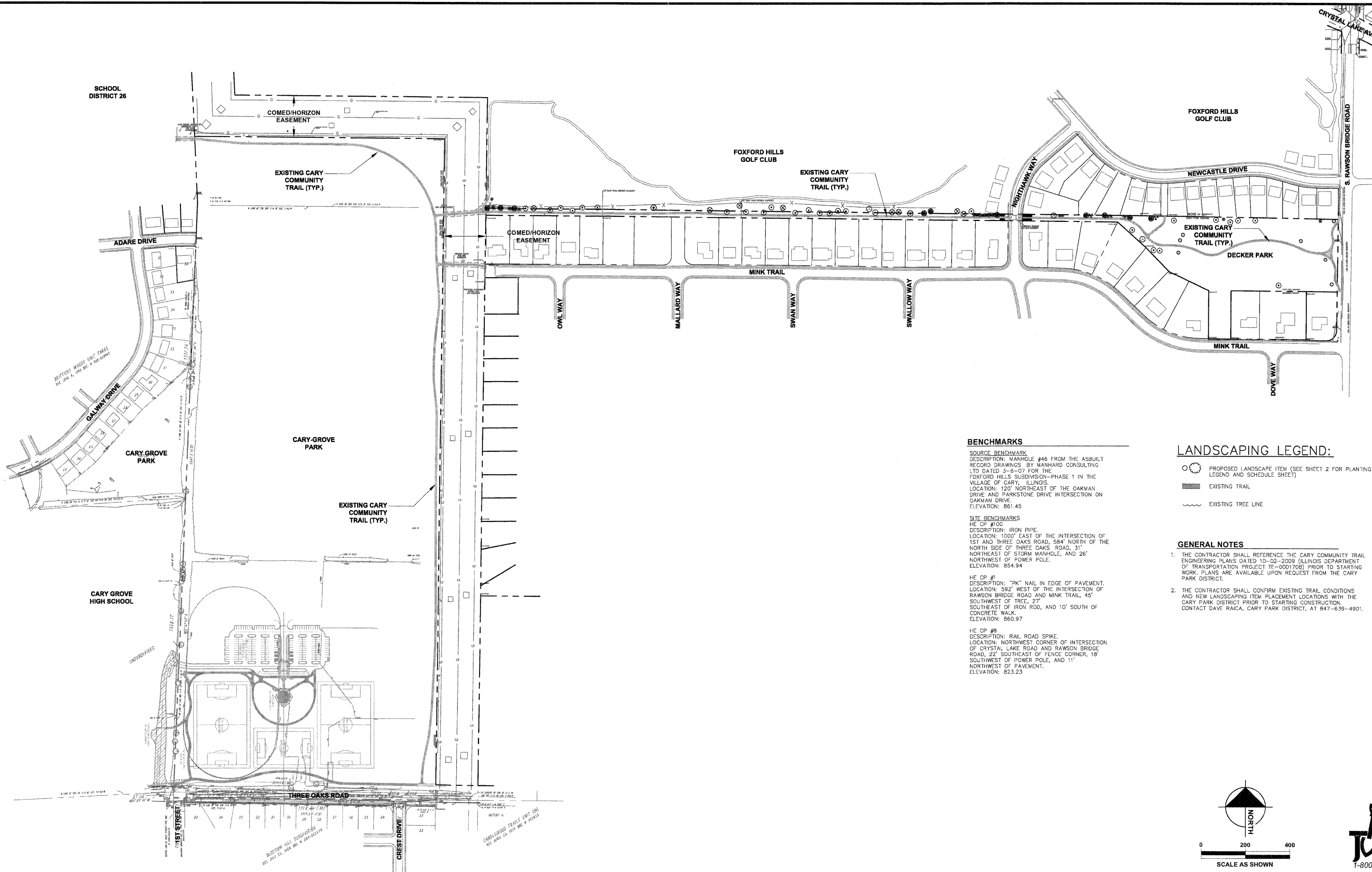

BENCHMARKS

SOURCE BENCHMARK
 DESCRIPTION: MANHOLE #46 FROM THE ASBUILT RECORD DRAWINGS BY MANHARD CONSULTING LTD DATED 3-6-07 FOR THE FOXFORD HILLS SUBDIVISION-PHASE 1 IN THE VILLAGE OF CARY, ILLINOIS.
 LOCATION: 120' NORTHEAST OF THE OAKMAN DRIVE AND PARKSTONE DRIVE INTERSECTION ON OAKMAN DRIVE.
 ELEVATION: 861.45

SITE BENCHMARKS
 HE CP #100
 DESCRIPTION: IRON PIPE.
 LOCATION: 1000' EAST OF THE INTERSECTION OF 1ST AND THREE OAKS ROAD, 584' NORTH OF THE NORTH SIDE OF THREE OAKS ROAD, 31' NORTHEAST OF STORM MANHOLE, AND 26' NORTHWEST OF POWER POLE.
 ELEVATION: 854.94

HE CP #1
 DESCRIPTION: "PK" NAIL IN EDGE OF PAVEMENT.
 LOCATION: 592' WEST OF THE INTERSECTION OF RAWSON BRIDGE ROAD AND MINK TRAIL, 45' SOUTHWEST OF TREE, 27' SOUTHWEST OF IRON ROD, AND 10' SOUTH OF CONCRETE WALK.
 ELEVATION: 860.97

HE CP #5
 DESCRIPTION: RAIL ROAD SPIKE.
 LOCATION: NORTHWEST CORNER OF INTERSECTION OF CRYSTAL LAKE ROAD AND RAWSON BRIDGE ROAD, 22' SOUTHWEST OF FENCE CORNER, 18' SOUTHWEST OF POWER POLE, AND 11' NORTHWEST OF PAVEMENT.
 ELEVATION: 823.23

LANDSCAPING LEGEND:

- PROPOSED LANDSCAPE ITEM (SEE SHEET 2 FOR PLANTING LEGEND AND SCHEDULE SHEET)
- EXISTING TRAIL
- EXISTING TREE LINE

GENERAL NOTES

1. THE CONTRACTOR SHALL REFERENCE THE CARY COMMUNITY TRAIL ENGINEERING PLANS DATED 10-02-2009 (ILLINOIS DEPARTMENT OF TRANSPORTATION PROJECT TE-0001708) PRIOR TO STARTING WORK. PLANS ARE AVAILABLE UPON REQUEST FROM THE CARY PARK DISTRICT.
2. THE CONTRACTOR SHALL CONFIRM EXISTING TRAIL CONDITIONS AND NEW LANDSCAPING ITEM PLACEMENT LOCATIONS WITH THE CARY PARK DISTRICT PRIOR TO STARTING CONSTRUCTION. CONTACT DAVE RAICA, CARY PARK DISTRICT, AT 847-639-4901.

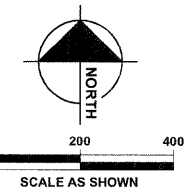

This document, together with the concepts and designs presented herein, is intended only for the specific purpose and client for which it was prepared. Reuse of any part of this document for any other project without the written consent of the engineer is strictly prohibited. The engineer and its staff shall not be held responsible for any errors or omissions in this document.

DESIGNED - JWH	REVISED
DRAWN - JKM	REVISED
CHECKED - JWH	REVISED
DATE - 10/21/2011	REVISED

STATE OF ILLINOIS
DEPARTMENT OF TRANSPORTATION

CARY PARK DISTRICT
CARY TRAIL LANDSCAPING

OVERALL
EXISTING CONDITIONS

SECTION	COUNTY	TOTAL SHEETS	SHEET NO.
06-P4001-01-BT	MCHENRY	7	4
FED. ROAD DIST. NO. 1	ILLINOIS	CONTRACT NO. 63656	

FOXFORD HILLS GOLF CLUB
(OWNED AND OPERATED BY CARY PARK DISTRICT)

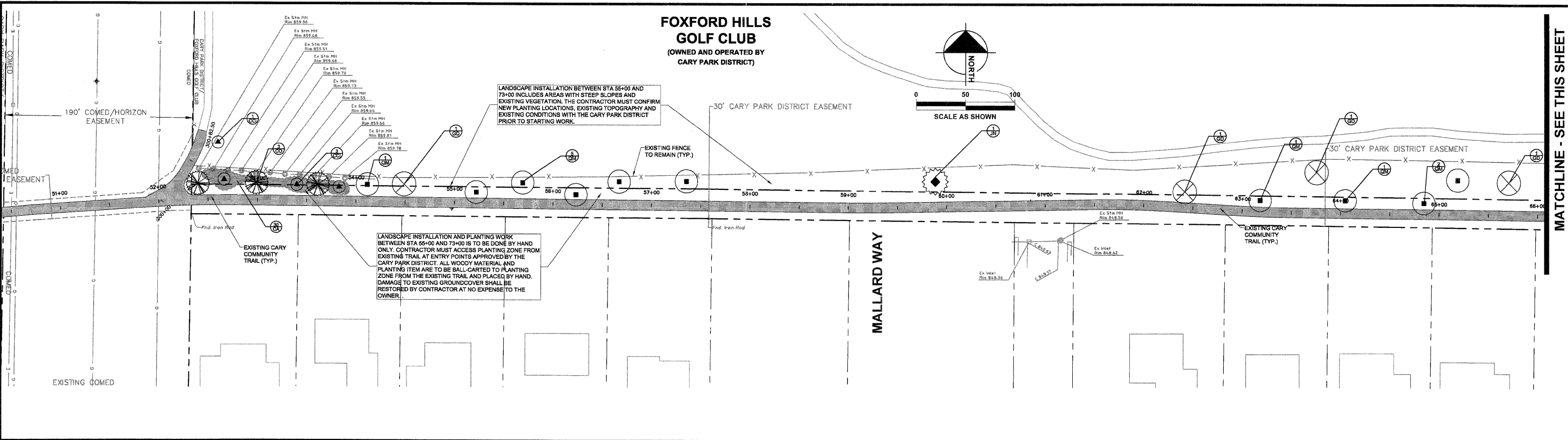

MATCHLINE - SEE THIS SHEET

FOXFORD HILLS GOLF CLUB
(OWNED AND OPERATED BY CARY PARK DISTRICT)

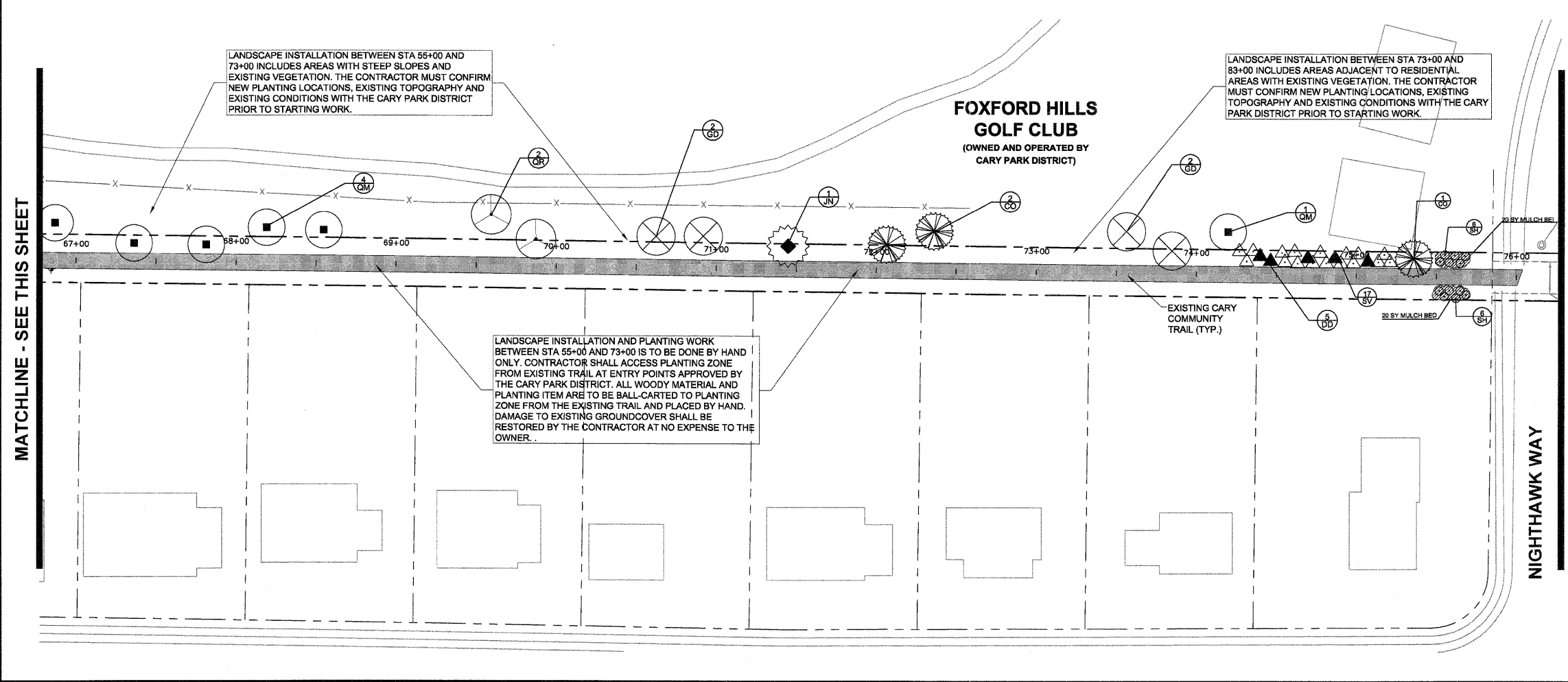

MATCHLINE - SEE THIS SHEET

MATCHLINE - SEE SHEET 5

LANDSCAPING LEGEND:

- PROPOSED LANDSCAPE ITEM (SEE SHEET 2 FOR PLANTING LEGEND AND SCHEDULE SHEET)
- EXISTING TRAIL
- EXISTING TREE LINE

GENERAL NOTES

1. THE CONTRACTOR SHALL REFERENCE THE CARY COMMUNITY TRAIL ENGINEERING PLANS DATED 10-02-2009 (ILLINOIS DEPARTMENT OF TRANSPORTATION PROJECT 1E-0001708) PRIOR TO STARTING WORK. PLANS ARE AVAILABLE UPON REQUEST FROM THE CARY PARK DISTRICT.
2. THE CONTRACTOR SHALL CONFIRM EXISTING TRAIL CONDITIONS AND NEW LANDSCAPING ITEM PLACEMENT LOCATIONS WITH THE CARY PARK DISTRICT PRIOR TO STARTING CONSTRUCTION. CONTACT DAVE RAICA, CARY PARK DISTRICT, AT 847-839-4901

BENCHMARKS

- SOURCE BENCHMARK**
DESCRIPTION: MANHOLE #46 FROM THE ASBUILT RECORD DRAWINGS BY MANHARD CONSULTING LTD DATED 3-6-07 FOR THE FOXFORD HILLS SUBDIVISION-PHASE 1 IN THE VILLAGE OF CARY, ILLINOIS.
LOCATION: 120' NORTHEAST OF THE OAKMAN DRIVE AND PARKSTONE DRIVE INTERSECTION ON OAKMAN DRIVE.
ELEVATION: 861.45
- HE CP #1**
DESCRIPTION: "PK" NAIL IN EDGE OF PAVEMENT.
LOCATION: 592' WEST OF THE INTERSECTION OF RAWSON BRIDGE ROAD AND MINK TRAIL, 45' SOUTHWEST OF TREE, 27' SOUTHEAST OF IRON ROD, AND 10' SOUTH OF CONCRETE WALK.
ELEVATION: 860.97
- HE CP #8**
DESCRIPTION: RAIL ROAD SPIKE.
LOCATION: NORTHWEST CORNER OF INTERSECTION OF CRYSTAL LAKE ROAD AND RAWSON BRIDGE ROAD, 22' SOUTHEAST OF FENCE CORNER, 18' SOUTHWEST OF POWER POLE, AND 11' NORTHWEST OF PAVEMENT.
ELEVATION: 823.23
- SITE BENCHMARKS**
HE CP #100
DESCRIPTION: IRON PIPE.
LOCATION: 1000' EAST OF THE INTERSECTION OF 1ST AND THREE OAKS ROAD, 584' NORTH OF THE NORTH SIDE OF THREE OAKS ROAD, 31' NORTHEAST OF STORM MANHOLE, AND 26' NORTHWEST OF POWER POLE.
ELEVATION: 854.94

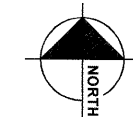

This document, together with the concepts and designs presented herein, is intended only for the specific purpose and client for which it was prepared. Reuse of any part of this document for any other project without the written consent of the engineer is prohibited. U.S.G. 04-01-2011

DESIGNED - JWH	REVISED
DRAWN - JKM	REVISED
CHECKED - JWH	REVISED
DATE - 10/21/2011	REVISED

**STATE OF ILLINOIS
DEPARTMENT OF TRANSPORTATION**

**CARY PARK DISTRICT
CARY TRAIL LANDSCAPING**

LANDSCAPE PLAN
STA. 50+00 TO STA. 66+50
STA. 66+50 TO STA. 76+50

SECTION	COUNTY	TOTAL SHEETS	SHEET NO.
06-P4001-01-BT	MCHENRY	7	5
FED. ROAD DIST. NO. 1	ILLINOIS	CONTRACT NO. 63856	

MATCHLINE - SEE SHEET 6

This document, together with the concepts and designs presented herein, is intended only for the specific purpose and client for which it was prepared. Reuse of any information contained herein for any other project without the written consent of the engineer is prohibited. The engineer and its staff shall not be held responsible for any errors or omissions in this document. The engineer and its staff shall not be held responsible for any damages, including consequential damages, arising from the use of this document. The engineer and its staff shall not be held responsible for any claims, damages, losses, or expenses, including reasonable attorneys' fees, arising from the use of this document. The engineer and its staff shall not be held responsible for any claims, damages, losses, or expenses, including reasonable attorneys' fees, arising from the use of this document.

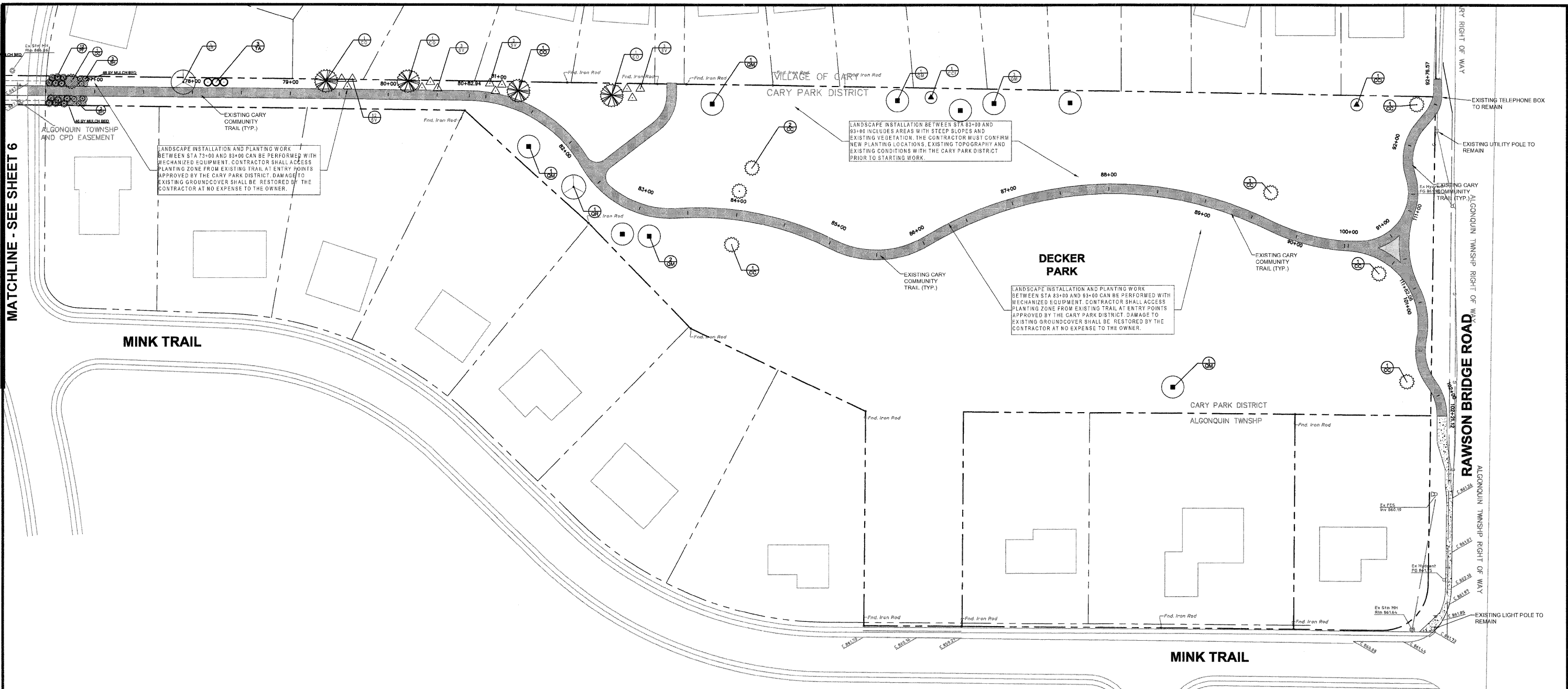

BENCHMARKS

SOURCE BENCHMARK
 DESCRIPTION: MANHOLE #46 FROM THE ASBUILT RECORD DRAWINGS BY MANHARD CONSULTING LTD DATED 3-6-07 FOR THE FOXFORD HILLS SUBDIVISION-PHASE 1 IN THE VILLAGE OF CARY, ILLINOIS.
 LOCATION: 120' NORTHEAST OF THE OAKMAN DRIVE AND PARKSTONE DRIVE INTERSECTION ON OAKMAN DRIVE.
 ELEVATION: 861.45

SITE BENCHMARKS
 HE CP #100
 DESCRIPTION: IRON PIPE.
 LOCATION: 1000' EAST OF THE INTERSECTION OF 1ST AND THREE OAKS ROAD, 584' NORTH OF THE NORTH SIDE OF THREE OAKS ROAD, 31' NORTHEAST OF STORM MANHOLE, AND 26' NORTHWEST OF POWER POLE.
 ELEVATION: 854.94

HE CP #1
 DESCRIPTION: "PK" NAIL IN EDGE OF PAVEMENT.
 LOCATION: 592' WEST OF THE INTERSECTION OF RAWSON BRIDGE ROAD AND MINK TRAIL, 45' SOUTHWEST OF TREE, 27' SOUTHEAST OF IRON ROD, AND 10' SOUTH OF CONCRETE WALK.
 ELEVATION: 860.97

HE CP #6
 DESCRIPTION: RAIL ROAD SPIKE.
 LOCATION: NORTHWEST CORNER OF INTERSECTION OF CRYSTAL LAKE ROAD AND RAWSON BRIDGE ROAD, 22' SOUTHEAST OF FENCE CORNER, 18' SOUTHWEST OF POWER POLE, AND 11' NORTHWEST OF PAVEMENT.
 ELEVATION: 823.23

LANDSCAPING LEGEND:

- PROPOSED LANDSCAPE ITEM (SEE SHEET 2 FOR PLANTING LEGEND AND SCHEDULE SHEET)
- EXISTING TRAIL
- EXISTING TREE LINE

GENERAL NOTES

1. THE CONTRACTOR SHALL REFERENCE THE CARY COMMUNITY TRAIL ENGINEERING PLANS DATED 10-02-2009 (ILLINOIS DEPARTMENT OF TRANSPORTATION PROJECT TE-00D1708) PRIOR TO STARTING WORK. PLANS ARE AVAILABLE UPON REQUEST FROM THE CARY PARK DISTRICT.
2. THE CONTRACTOR SHALL CONFIRM EXISTING TRAIL CONDITIONS AND NEW LANDSCAPING ITEM PLACEMENT LOCATIONS WITH THE CARY PARK DISTRICT PRIOR TO STARTING CONSTRUCTION. CONTACT DAVE RAICA, CARY PARK DISTRICT, AT 847-639-4901.

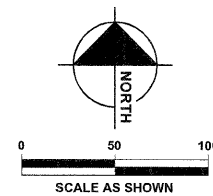
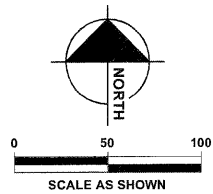

DESIGNED - JWH	REVISED
DRAWN - JKM	REVISED
CHECKED - JWH	REVISED
DATE - 10/21/2011	REVISED

**STATE OF ILLINOIS
DEPARTMENT OF TRANSPORTATION**

**CARY PARK DISTRICT
CARY TRAIL LANDSCAPING**

**LANDSCAPE PLAN: STA. 76+00 TO 92+76.57
STA. 100+00 TO 102+21.12
STA. 111+00 TO 111+82.06**

SECTION	COUNTY	TOTAL SHEETS	SHEET NO.
06-P4001-01-BT	MCHENRY	7	6
FED. ROAD DIST. NO. 1	ILLINOIS	CONTRACT NO. 63656	

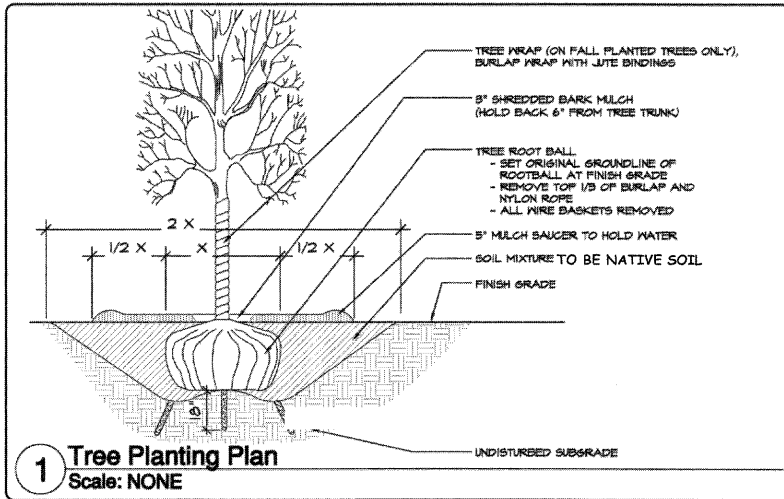

Cary Park District
255 Briarcliff Rd
Cary, Illinois 60013
(847) 639-4901

Construction Detail 11-01

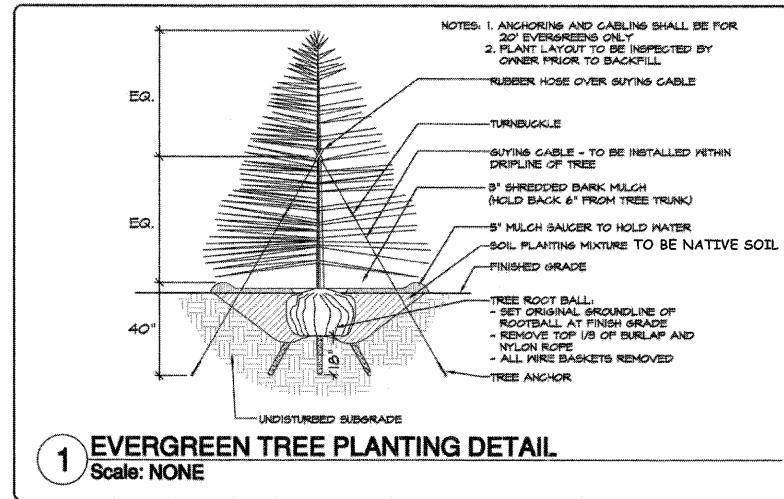

Cary Park District
255 Briarcliff Rd
Cary, Illinois 60013
(847) 639-4901

Construction Detail 11-02

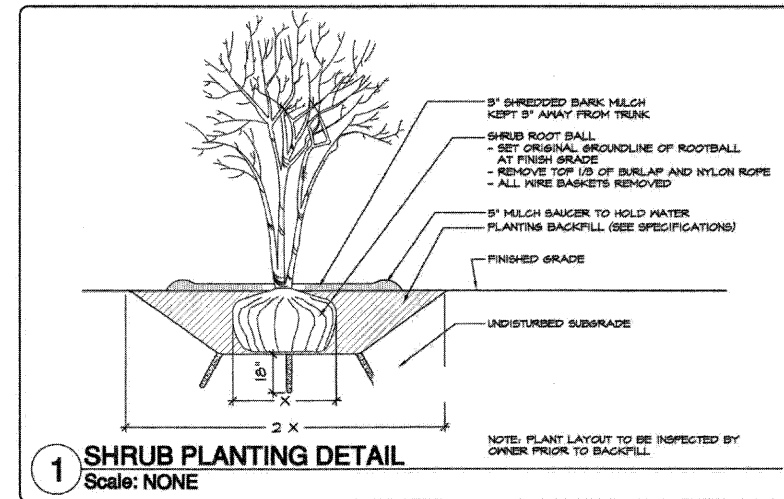

Cary Park District
255 Briarcliff Rd
Cary, Illinois 60013
(847) 639-4901

Construction Detail 11-04

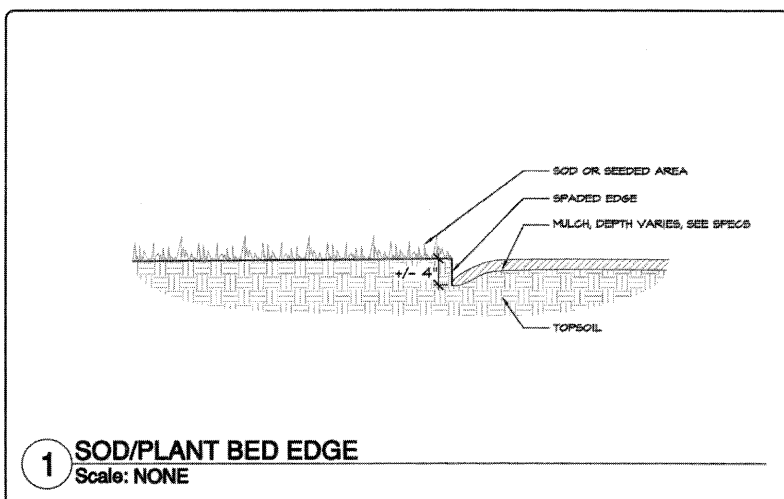

Cary Park District
255 Briarcliff Rd
Cary, Illinois 60013
(847) 639-4901

Construction Detail 11-05

This document, together with the concepts and designs presented herein, is intended only for the specific purpose and client for which it was prepared. Reuse or modification of this document without the written consent of the author is strictly prohibited. © 2011 J. J. & Associates, Inc.

DESIGNED — JWH	REVISED
DRAWN — JKM	REVISED
CHECKED — JWH	REVISED
DATE — 10/21/2011	REVISED

**STATE OF ILLINOIS
DEPARTMENT OF TRANSPORTATION**

**CARY PARK DISTRICT
CARY TRAIL LANDSCAPING**

DETAILS

SECTION	COUNTY	TOTAL SHEETS	SHEET NO.
06-P4001-01-BT	MCHENRY	7	7
FED. ROAD DIST. NO. 1	ILLINOIS	CONTRACT NO. 63856	



1-800-892-0123