

F.A.U. RTE.	SECTION	COUNTY	TOTAL SHEETS	SHEET NO.
0082	11-00149-00-RS	WILL	30	1

CONTRACT NO. 63659

INDEX OF SHEETS

SHEET NO.	DESCRIPTION
1	TITLE
2	GENERAL NOTES, STANDARDS
3-3A	SUMMARY OF QUANTITIES
4-5	TYPICAL SECTIONS
6-11	PROPOSED ROADWAY PLANS
12-17	PAVEMENT MARKING PLANS
18-29	DISTRICT ONE DETAILS
30	CITY OF NAPERVILLE VALVE VAULT DETAIL
30A	PAVEMENT CORE MEASUREMENTS

STATE OF ILLINOIS
DEPARTMENT OF TRANSPORTATION
DIVISION OF HIGHWAYS

**PLANS FOR PROPOSED
FEDERAL AID HIGHWAY**

FAU ROUTE 0082 (BOOK ROAD)
111TH STREET TO 87TH STREET
RESURFACING
SECTION 11-00149-00-RS
PROJECT NO. M-9003(831)
CITY OF NAPERVILLE
WILL COUNTY
JOB NO: C-91-576-11

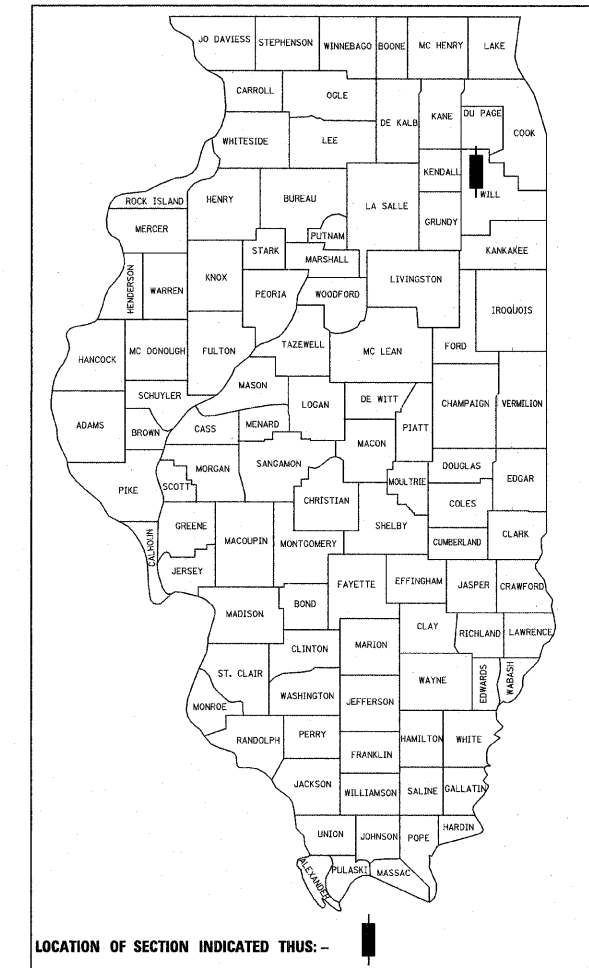

DESIGN DESIGNATION

24500 (32) MINOR ARTERIAL 4.3 (FD-20)
ADT (2030) ADT = 24,000

TRAFFIC DATA

FROM 111-TH STREET TO CONAN DOYLE ROAD:
ADT (2006 /2007) = 15,600
FROM CONAN DOYLE ROAD TO 87-TH STREET:
ADT (2006 /2007) = 21,500
POSTED SPEED = 40 MPH

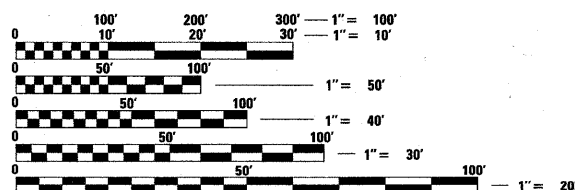

FULL SIZE PLANS HAVE BEEN PREPARED USING STANDARD ENGINEERING SCALES. REDUCED SIZED PLANS WILL NOT CONFORM TO STANDARD SCALES. IN MAKING MEASUREMENTS ON REDUCED PLANS, THE ABOVE SCALES MAY BE USED.

J.U.L.I.E.
JOINT UTILITY LOCATION INFORMATION FOR EXCAVATION
1-800-892-0123 OR 811

CONTRACT NO. 63659

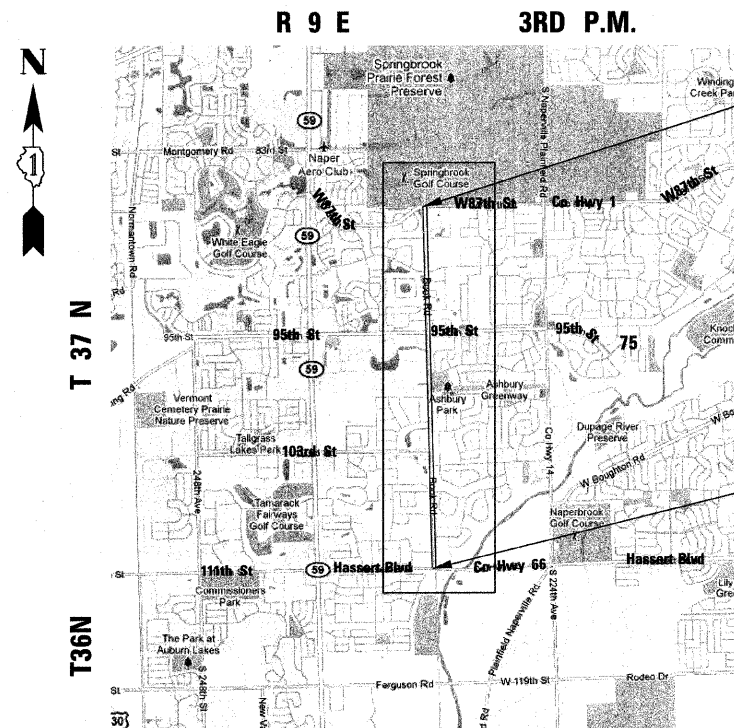

LOCATION MAP
NOT TO SCALE

GROSS LENGTH = 16,192.30 FT (3.07 MILES)
NET LENGTH = 16,132.29 FT
(60.01 FT OMISSION AT 95TH STREET)

PROJECT ENDS
STATION 172 + 22.30

PROJECT BEGINS
STATION 10 + 30.00



DATE: 10/18/11
Express 11/30/11

STATE OF ILLINOIS
DEPARTMENT OF TRANSPORTATION
DIVISION OF HIGHWAYS

Approved October 12 20 11
William J. Tranchesi
CITY OF NAPERVILLE, CITY ENGINEER

Passed November 1 20 11
Chad Chamberlaine
DISTRICT 1 ENGINEER OF LOCAL ROADS AND STREETS

Releasing for Bid
Based on Limited
Review NOVEMBER 2, 20 11
Diane M. O'Keefe
DEPUTY DIRECTOR OF HIGHWAYS, REGION 1 ENGINEER

PRINTED BY THE AUTHORITY
OF THE STATE OF ILLINOIS

PLANS PREPARED BY:

URS 100 S. WACKER DR., SUITE 500 TEL (312)-939-1000
CHICAGO IL, 60606 FAX (312)-939-4198

PROGRAM AND OFFICE ENGINEER: CHARLES F. RIDDLE, P.E. 847-705-4406 SCHAUMBURG, IL