

NOTES:

- TYPE III BARRICADES SHALL BE POSITIONED AS SHOWN IN IDOT HIGHWAY STANDARD 702001 AND AS NOTED FOR SEQUENCE OF CONSTRUCTION.
 - ALL SIGNS SHALL BE POST MOUNTED AS THE CLOSURE TIME EXCEEDS FOUR DAYS.
 - LONGITUDINAL DIMENSIONS MAY BE ADJUSTED SLIGHTLY TO FIT FIELD CONDITIONS.
 - ALL WARNING SIGNS SHALL HAVE MINIMUM DIMENSIONS OF 36" X 36" AND HAVE BLACK LETTERING ON AN ORANGE HIGH INTENSITY REFLECTORIZED BACKGROUND.
 - DURING HOURS OF DARKNESS, FLASHING LIGHTS SHALL BE USED ON EACH APPROACH. THESE SHALL BE PLACED ON ALL TYPE III BARRICADES (2 EACH) AND INSTALLED ABOVE THE FIRST TWO ADVANCE SIGNS AS DETAILED BELOW - SEE SIGNS 1 AND 2.
 - BARRICADES SHALL BE PLACED ACROSS SIDEWALKS AND AT THE FACE OF CURB, EXCEPT WHEN OTHERWISE DIRECTED BY THE ENGINEER OR SHOWN DIFFERENTLY ON THE DETAILED CONSTRUCTION PLANS.
 - ALL SIGNS SHALL BE IN ACCORDANCE WITH THE ILLINOIS SUPPLEMENT TO THE MANUAL ON UNIFORM TRAFFIC CONTROL DEVICES, ADOPTED MARCH, 1990.
 - SEE SPECIAL PROVISIONS FOR TRAFFIC CONTROL PLAN AND NOTE 12.
 - ALL CONFLICTING EXISTING SIGNS SHALL BE REMOVED OR COVERED WHILE DETOUR IS IN EFFECT.
 - ALL UNBALLASTED TYPE I AND TYPE II BARRICADES SHALL HAVE TWO SANDBAGS ON THE BOTTOM RAIL.
 - THE TRAFFIC CONTROL PLAN SHALL BE IN ACCORDANCE WITH THE APPLICABLE SECTIONS OF THE STANDARD SPECIFICATIONS, THE SUPPLEMENTAL SPECIFICATIONS, THE "ILLINOIS MANUAL ON UNIFORM TRAFFIC CONTROL DEVICES FOR STREETS AND HIGHWAYS", ANY SPECIAL DETAILS AND HIGHWAY STANDARDS CONTAINED IN THE PLANS, THE TRAFFIC SPECIFICATIONS AND THE SPECIAL PROVISIONS.
- SPECIAL ATTENTION IS CALLED TO ARTICLES 107.09, 107.14 AND SECTION 701 OF THE STANDARD SPECIFICATIONS AND THE SPECIAL PROVISIONS FOR MAINTENANCE OF ROADWAYS RELATING TO TRAFFIC CONTROL.
- THE CONTRACTOR SHALL CONTACT THE DISTRICT ONE BUREAU OF TRAFFIC AT LEAST 72 HOURS IN ADVANCE OF BEGINNING WORK.
- THE LUMP SUM COST FOR TRAFFIC CONTROL AND PROTECTION (SPECIAL) SHALL INCLUDE ALL WORK, EQUIPMENT AND LABOR NECESSARY TO INSTALL AND MAINTAIN THE TRAFFIC PROTECTION AND DETOUR ROUTES SIGNED IN ACCORDANCE WITH THIS DRAWING AND AS DIRECTED BY THE ENGINEER FOR THE PROJECT DURATION.
 - TYPE III BARRICADES TO BE STAGGERED BY 40 TO 60 FEET FOR CONSTRUCTION ACCESS. EACH BARRICADE SHALL HAVE TWO AMBER FLASHING LIGHTS AND ONE FLAG. BARRICADES WILL HAVE TO BE MOVED TO ACCOMMODATE SEQUENCE OF CONSTRUCTION.

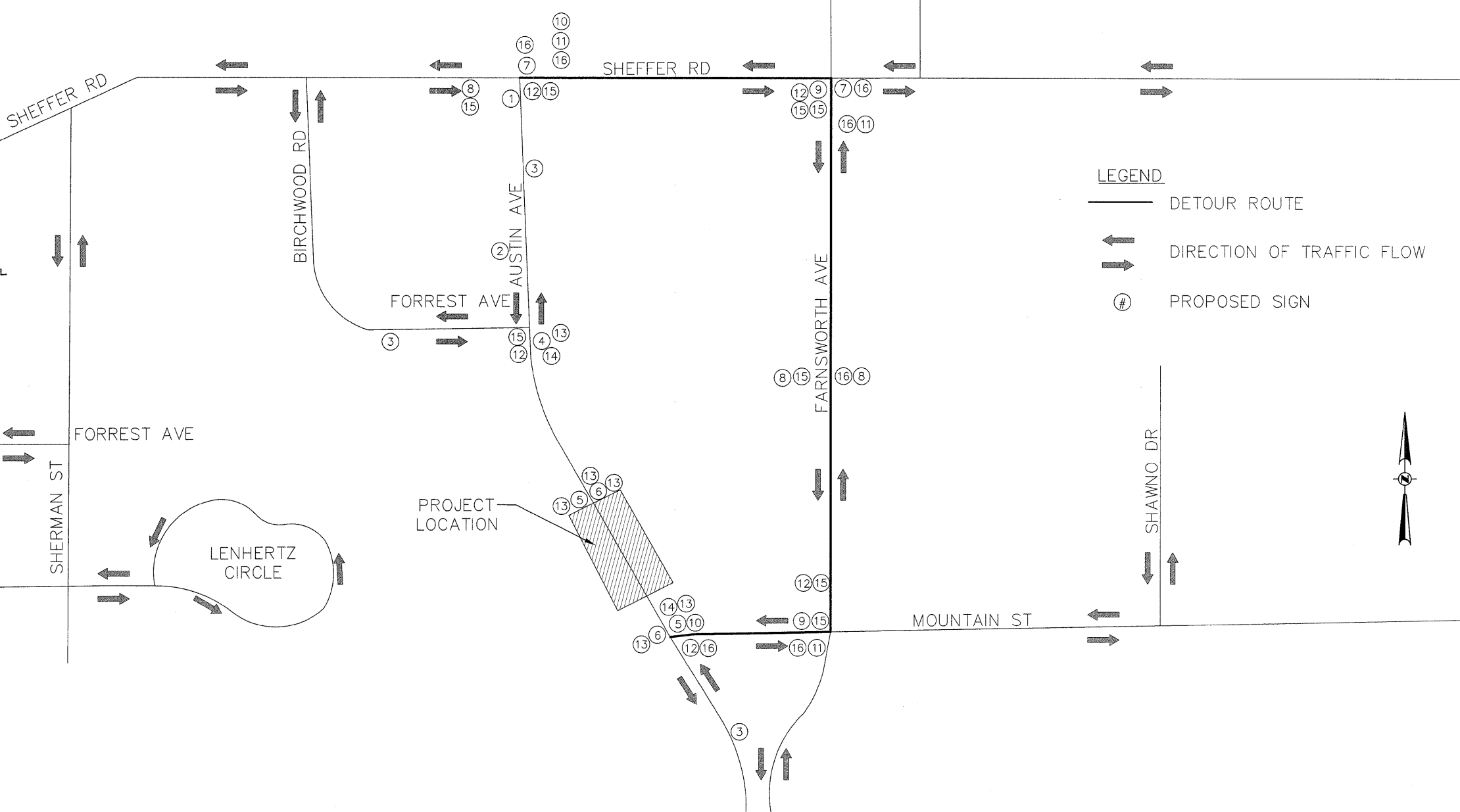

LEGEND

- DETOUR ROUTE
- ← DIRECTION OF TRAFFIC FLOW
- # PROPOSED SIGN

SIGN LEGEND

<p>1 W20-1(0) (48"x48") W/ AMBER FLASHING LIGHT ROAD CLOSED 0.2 MILE AHEAD W17-1 100 (VAR. x 6") AUSTIN AVE. (1 REQUIRED)</p>	<p>2 W20-3(0) (48"x48") W/ AMBER FLASHING LIGHT ROAD CLOSED 0.1 MILE AHEAD W17-1 100 (VAR. x 6") AUSTIN AVE. (1 REQUIRED)</p>	<p>3 W20-2(0) (48"x48") W/ AMBER FLASHING LIGHT DETOUR AHEAD W17-1 100 (VAR. x 6") AUSTIN AVE. (3 REQUIRED)</p>	<p>4 R11-3 (60"x30") W/ AMBER FLASHING LIGHT BRIDGE OUT AHEAD LOCAL TRAFFIC ONLY (1 REQUIRED)</p>	<p>5 R11-3a (48"x30") W/ AMBER FLASHING LIGHT BRIDGE OUT (2 REQUIRED)</p>	<p>6 R11-2 (48"x30") W/ AMBER FLASHING LIGHT ROAD CLOSED (2 REQUIRED)</p>	<p>7 W17-1 101 (VAR. x 12") AUSTIN AVE. BRIDGE M4-9(L) (30"x24") DETOUR ← (2 REQUIRED)</p>	<p>8 W17-1 101 (VAR. x 12") AUSTIN AVE. BRIDGE M4-9 (30"x24") DETOUR ↑ (3 REQUIRED)</p>	<p>9 W17-1 101 (VAR. x 12") AUSTIN AVE. BRIDGE M4-9(R) (30"x24") DETOUR → (2 REQUIRED)</p>	<p>10 M4-6 (24"x12") END W17-1 101 (24"x24") AUSTIN AVE. BRIDGE M4-8 (24"x12") DETOUR (2 REQUIRED)</p>	<p>11 W17-1 101 (VAR. x 12") AUSTIN AVE. BRIDGE M4-9(L) (30"x24") DETOUR ← M6-2(L) (30"x30") (4 REQUIRED)</p>	<p>12 W17-1 101 (VAR. x 12") AUSTIN AVE. BRIDGE M4-9(R) (30"x24") DETOUR → M6-2(R) (30"x30") (4 REQUIRED)</p>
<p>13 TYPE III BARRICADES WITH TWO AMBER FLASHING LIGHTS EACH AND ONE FLAG (ACROSS SIDEWALK AND STREET AT ENDS OF CONSTRUCTION AREA)</p>											
<p>14 R11-3 (60"x36") AUSTIN AVE BRIDGE CLOSED APRIL 1, 2012 (2 REQUIRED) SIGN TO BE POSTED 21 DAYS PRIOR TO CLOSURE - VARY DATE AS REQUIRED. REMOVE WHEN BRIDGE IS CLOSED.</p>											
<p>15 M3-2 (24"x12") SOUTH (BLACK ON WHITE) (7 REQUIRED)</p>											
<p>16 M3-4 (24"x12") NORTH (BLACK ON WHITE) (7 REQUIRED)</p>											

SIGNS 15 AND 16 TO BE AT THE TOP OF MOST SIGN IN ANY ARRAY.

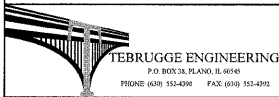

DESIGNED - JJT	REVISED -
DRAWN - ASK	REVISED -
CHECKED - JJT	REVISED -
DATE - 10/7/2011	REVISED -

STATE OF ILLINOIS
DEPARTMENT OF TRANSPORTATION

TRAFFIC CONTROL
AUSTIN AVE OVER INDIAN CREEK

SCALE: NONE SHEET NO. 1 OF 1 STA. 11+83.56 TO STA. 13+88.72

F.A.P. RTE.	SECTION	COUNTY	TOTAL SHEETS	SHEET NO.
	03-01130-00-BR	KANE	33	12
D-91-352-04		CONTRACT NO. 63660		
FED. ROAD DIST. NO. -		ILLINOIS FED. AID PROJECT		