

I-90 INSIDE SHOULDER WARPING				
STATION	EOS ELEVATION AT BARRIER	SHOULDER CROSS SLOPE	LONGITUDINAL EOS SLOPE	DESCRIPTION
LOCATION 1 - EB & WB SHOULDERS				
65+88.00	774.56	0.04	-0.0035	BEGIN WARPING
66+00.00	774.51	0.0417		
66+44.25	774.36	0.05		LOW POINT
67+00.00	774.55	0.0409		
67+10.00	774.59	0.04	0.0035	END WARPING
LOCATION 2 - EB & WB SHOULDERS				
80+00.00	780.96	0.04	0.0046	BEGIN WARPING
80+73.05	781.29	0.02		HIGH POINT
81+00.00	781.17	0.0296		
81+55.00	780.93	0.04	-0.0044	END WARPING
LOCATION 3 - EB & WB SHOULDERS				
91+90.00	777.62	0.04	-0.0035	BEGIN WARPING
92+00.00	777.58	0.0409		
92+50.95	777.41	0.05		LOW POINT
93+00.00	777.58	0.04		
93+10.00	777.61	0.04	0.0035	END WARPING
LOCATION 4 - WB SHOULDERS				
119+35.00	785.75	0.04	0.0037	BEGIN WARPING
120+00.00	785.99	0.0313		
120+42.03	786.15	0.02		HIGH POINT
121+00.00	785.93	0.0348		
121+45.00	785.76	0.04	-0.0037	END WARPING
LOCATION 4 - WB SHOULDERS				
119+35.00	785.75	0.04	0.0037	BEGIN WARPING
120+42.03	786.14	0.02		HIGH POINT
121+00.00	785.92	0.0348		
121+45.00	785.75	0.04	-0.0038	END WARPING

JIM HEIDENREICH

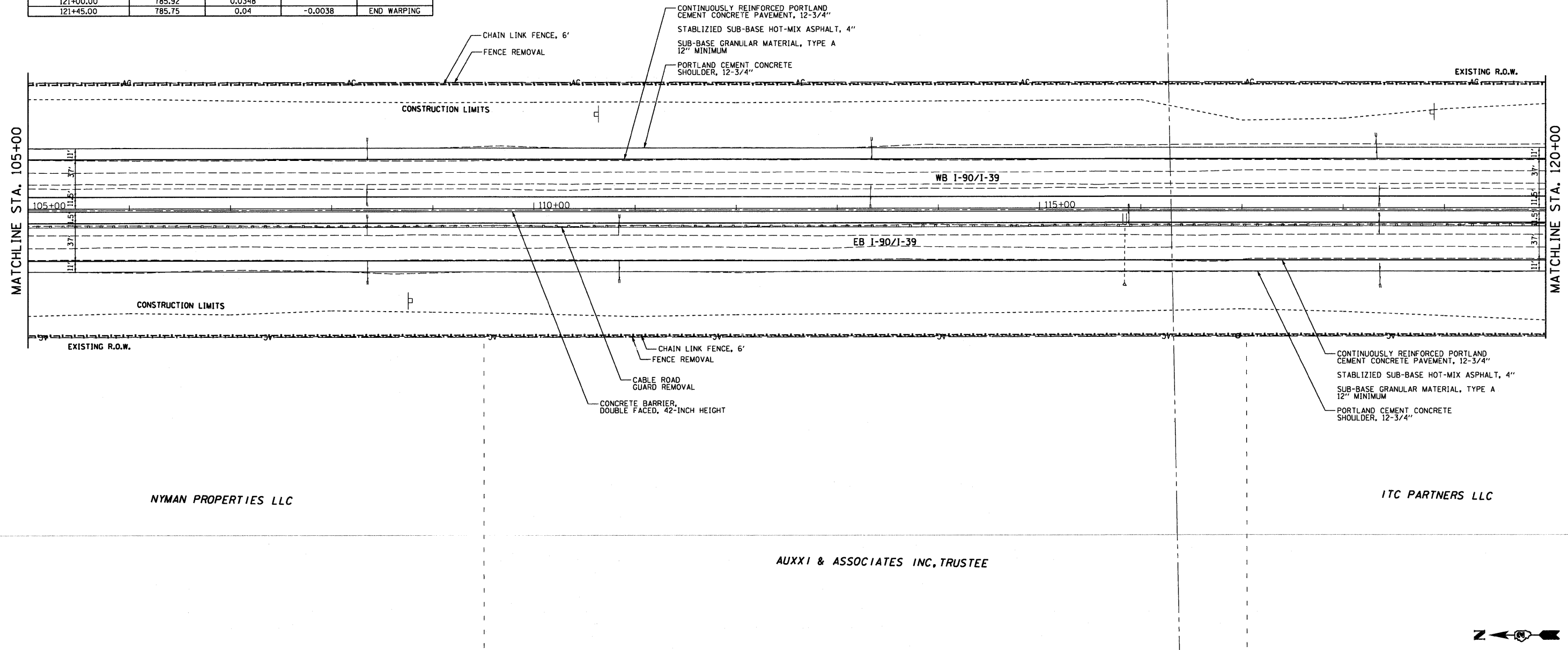

NYMAN PROPERTIES LLC

ITC PARTNERS LLC

AUXI & ASSOCIATES INC, TRUSTEE

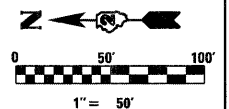

USER NAME = .USERNAME_
 FILE NAME = #FILE#
 PLOT SCALE = 50.0000' / IN.
 PLOT DATE = 10/19/2011

DESIGNED -
 DRAWN - BSL
 CHECKED - PDS
 DATE - 10-21-2011

REVISED -
 REVISED -
 REVISED -
 REVISED -

STATE OF ILLINOIS
 DEPARTMENT OF TRANSPORTATION

PLAN SHEETS - I-90

SCALE: N/A SHEET NO. OF SHEETS STA. 105+00 TO STA. 120+00

F.A. RTE.	SECTION	COUNTY	TOTAL SHEETS	SHEET NO.
90	(X2-1) R	WINNEBAGO	510	86
CONTRACT NO. 64C29				
ILLINOIS FED. AID PROJECT				