

PLAN	SURVEYED	BY	DATE
	PLOTTED		
	NOTED		
	NO. _____		
	CAD FILE NAME		

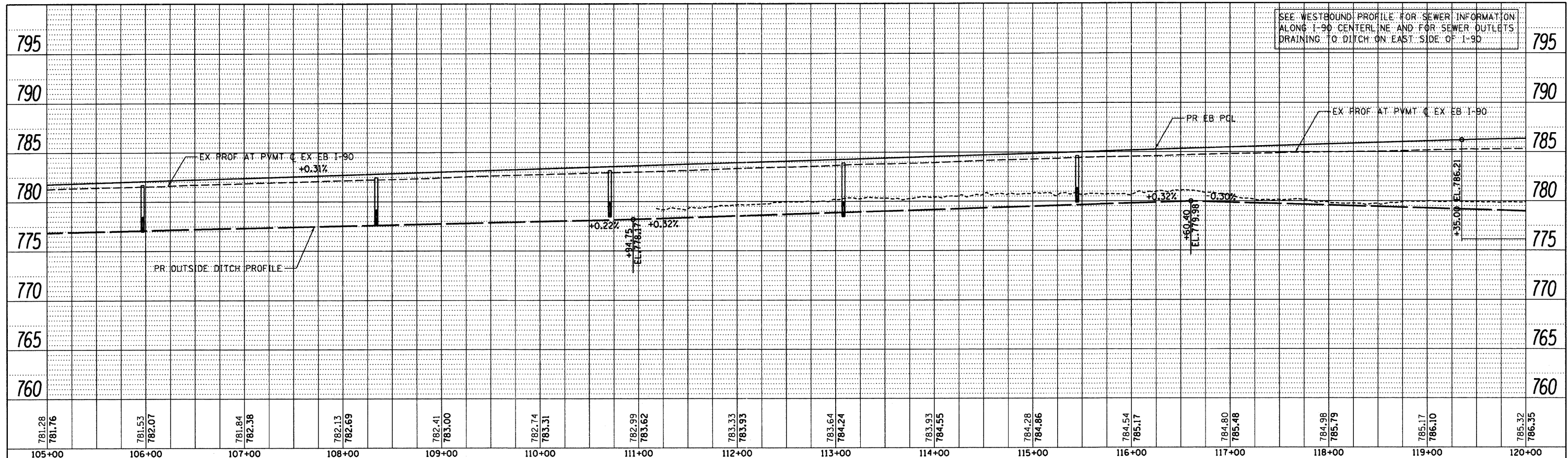

EASTBOUND PROFILE

WESTBOUND PROFILE

PROFILE	SURVEYED	BY	DATE
	PLOTTED		
	NOTED		
	NO. _____		
	CAD FILE NAME		

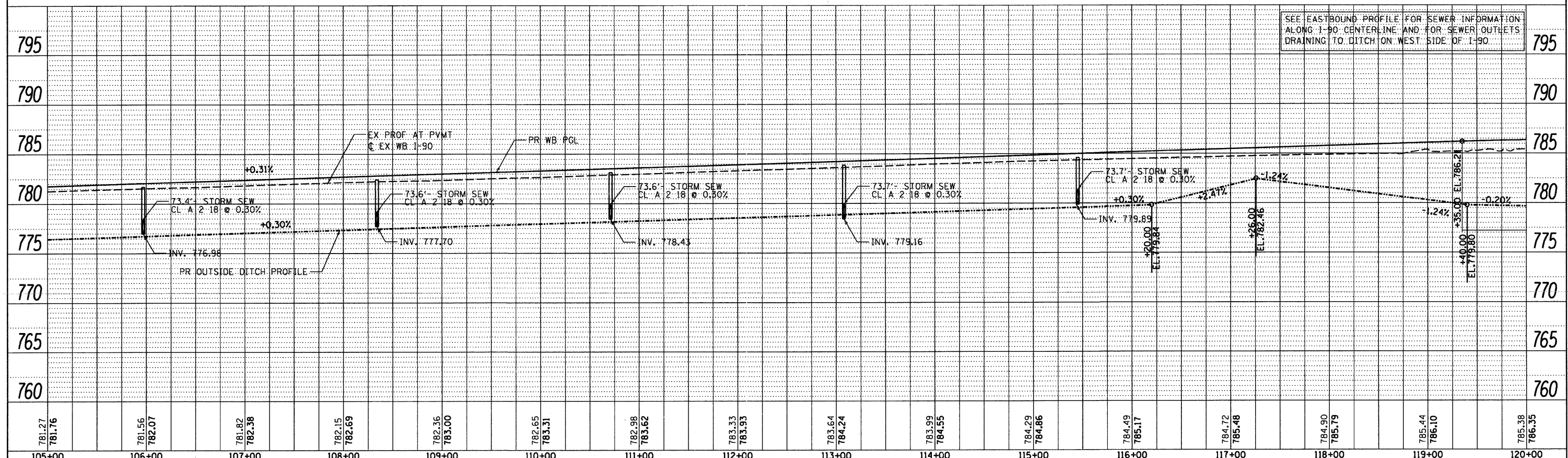

781.28 781.76	781.53 782.07	781.84 782.38	782.13 782.69	782.41 783.00	782.74 783.31	782.99 783.62	783.33 783.93	783.64 784.24	783.93 784.55	784.28 784.86	784.54 785.17	784.80 785.48	784.98 785.79	785.17 786.10	785.32 786.35
105+00	106+00	107+00	108+00	109+00	110+00	111+00	112+00	113+00	114+00	115+00	116+00	117+00	118+00	119+00	120+00

McClure LOCHNER
Engineering Associates, Inc.
1000 N. Lincoln Hwy., Chicago, IL 60642
RVA
REGISTERED PROFESSIONAL ENGINEER
No. 001234567
OEI
QUICK ENGINEERING INC.

USER NAME = .USERNAME_	DESIGNED -	REVISED -
	DRAWN - BSL	REVISED -
PLOT SCALE = 50.0000' / IN.	CHECKED - PDS	REVISED -
PLOT DATE = 10/19/2011	DATE - 10-21-2011	REVISED -

STATE OF ILLINOIS
DEPARTMENT OF TRANSPORTATION

SCALE:	SHEET NO. OF SHEETS	STA. 105+00 TO STA. 120+00
--------	---------------------	----------------------------

F.A. RTE. 90	SECTION (X2-1) R	COUNTY WINNEBAGO	TOTAL SHEETS 510	SHEET NO. 97
CONTRACT NO. 64C29				
ILLINOIS FED. AID PROJECT				

SEE WESTBOUND PROFILE FOR SEWER INFORMATION ALONG I-90 CENTERLINE AND FOR SEWER OUTLETS DRAINING TO DITCH ON EAST SIDE OF I-90

SEE EASTBOUND PROFILE FOR SEWER INFORMATION ALONG I-90 CENTERLINE AND FOR SEWER OUTLETS DRAINING TO DITCH ON WEST SIDE OF I-90