

DATE	
BY	
REVISIONS	
NO.	
DESCRIPTION	
DATE	
BY	
REVISIONS	
NO.	
DESCRIPTION	
DATE	
BY	
REVISIONS	
NO.	
DESCRIPTION	
DATE	
BY	
REVISIONS	
NO.	
DESCRIPTION	

DATE	
BY	
REVISIONS	
NO.	
DESCRIPTION	
DATE	
BY	
REVISIONS	
NO.	
DESCRIPTION	
DATE	
BY	
REVISIONS	
NO.	
DESCRIPTION	

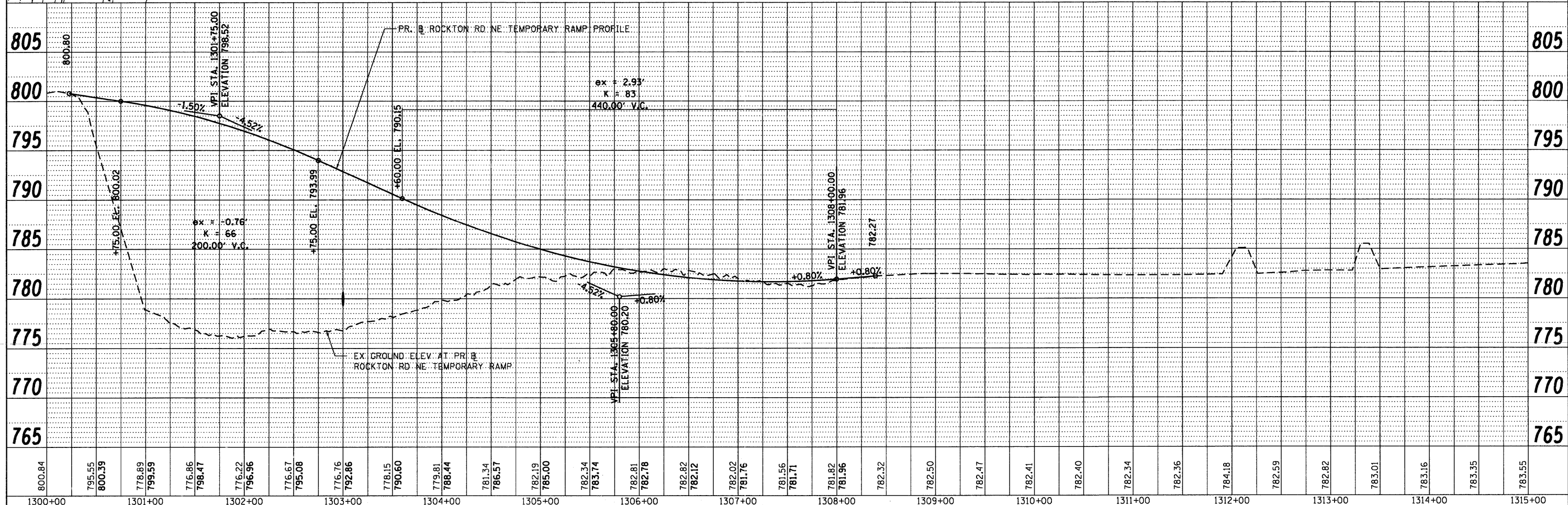
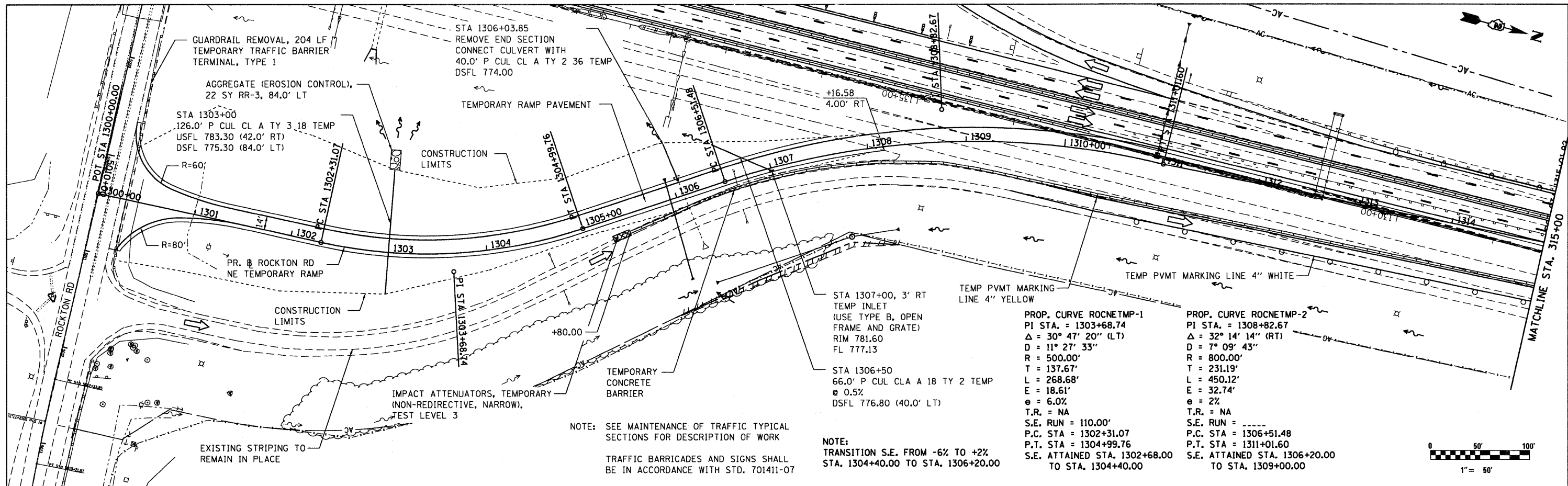

800.84	795.55	800.39	778.89	799.59	776.86	798.47	776.22	796.96	776.67	795.08	776.76	792.86	778.15	790.60	779.81	788.44	781.34	786.57	782.19	785.00	782.34	783.74	782.81	782.78	782.82	782.12	782.02	781.76	781.56	781.71	781.82	781.96	782.32	782.50	782.47	782.41	782.40	782.34	782.36	784.18	782.59	782.82	783.01	783.16	783.35	783.55
1300+00		1301+00		1302+00		1303+00		1304+00		1305+00		1306+00		1307+00		1308+00		1309+00		1310+00		1311+00		1312+00		1313+00		1314+00		1315+00																

**McClure LOCHNER**  
Engineering Associates, Inc.

**RWA**  
ROADWAY ENGINEERING

**OPI**  
ORIGIN ENGINEERING, INC.

USER NAME = .JUSERNAME.  
FILE NAME = sht.plnprf\_ramp.stglAdgn  
PLOT SCALE = 50.00000' / in.  
PLOT DATE = 10/19/2011

DESIGNED - MM  
DRAWN - MS  
CHECKED - MM  
DATE - 10/21/2011

REVISED -  
REVISED -  
REVISED -  
REVISED -

**STATE OF ILLINOIS  
DEPARTMENT OF TRANSPORTATION**

**PLAN AND PROFILE - STAGE 1A**  
**ROCKTON RD NE TEMPORARY ENTRANCE RAMP**

SCALE: 1"=50' SHEET NO. 1 OF 1 SHEETS STA. 1300+00 TO STA. 1315+00

F.A.I. RTE. 90	SECTION (X2-1R)	COUNTY WINNEBAGO	TOTAL SHEETS 510	SHEET NO. 108
CONTRACT NO. 64C29			ILLINOIS FED. AID PROJECT	