

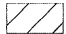



LEGEND

-  WORK ZONE
-  TEMPORARY PAVEMENT
-  TEMPORARY CONCRETE BARRIER
-  DIRECTION OF TRAFFIC
-  DRUMS WITH BI-DIRECTIONAL STEADY BURN LIGHTS @ 50' CENTERS, 25' CENTERS ALONG TAPERS
-  IMPACT ATTENUATOR, TEMPORARY
-  VERTICAL PANEL
-  TYPE III BARRICADE WITH FLASHING LIGHTS

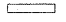
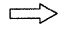

USER NAME = .USERNAME.	DESIGNED - CGC	REVISED -
DRAWN - CGC	REVISED -	REVISED -
CHECKED - AM	REVISED -	REVISED -
DATE - 10/14/2011	REVISED -	REVISED -

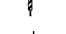
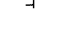
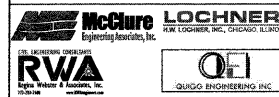
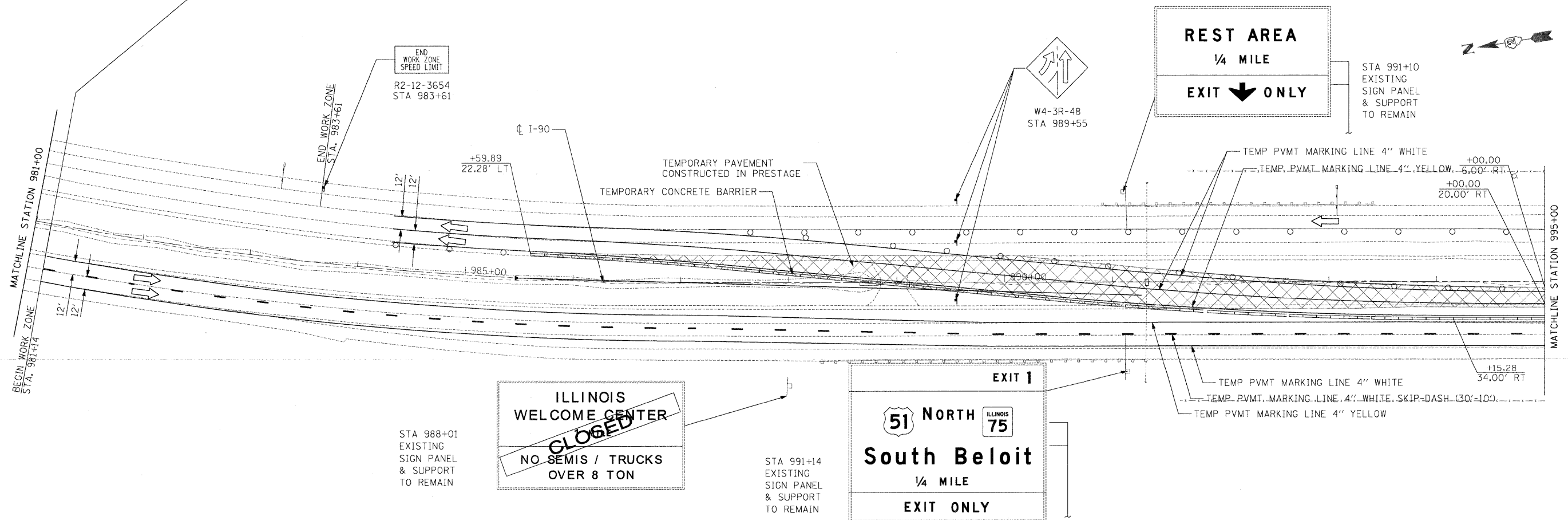
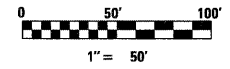
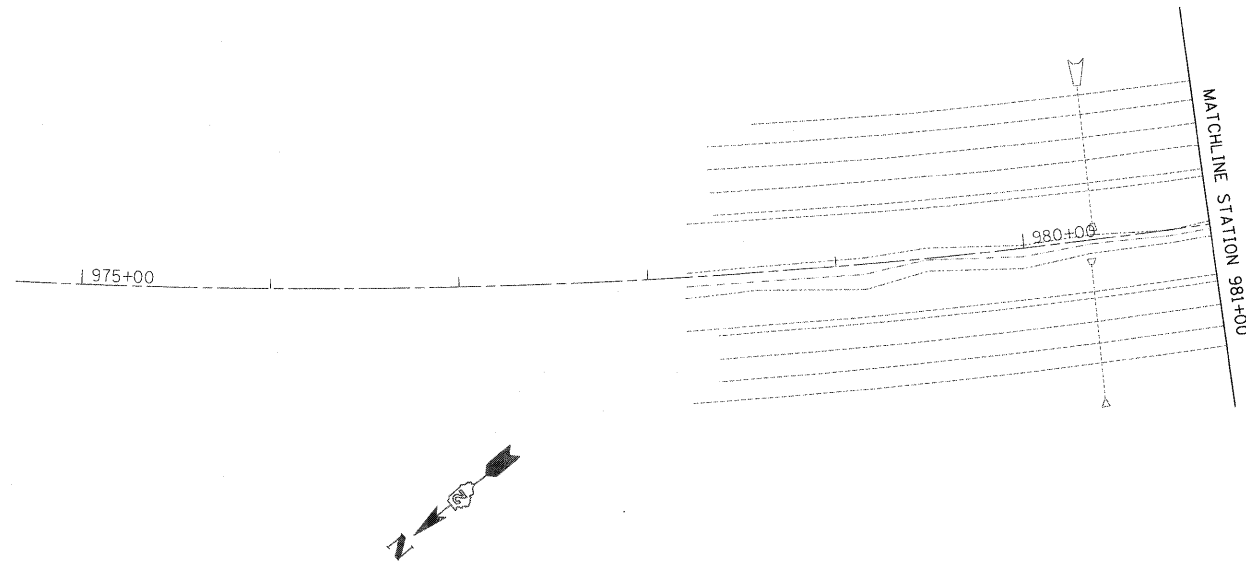
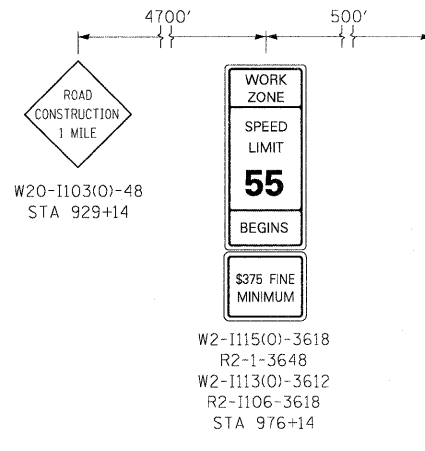
**STATE OF ILLINOIS
DEPARTMENT OF TRANSPORTATION**

MOT I-90 STAGE 1A

SCALE: 1"=50' SHEET NO. OF SHEETS STA. 981+00 TO STA. 995+00

F.A.I. RTE.	SECTION	COUNTY	TOTAL SHEETS	SHEET NO.
90	(X2-1)R	WINNEBAGO	510	144
CONTRACT NO. 64C29			ILLINOIS FED. AID PROJECT	