

- LEGEND**
- WORK ZONE
  - TEMPORARY PAVEMENT
  - TEMPORARY CONCRETE BARRIER
  - DIRECTION OF TRAFFIC
  - DRUMS WITH BI-DIRECTIONAL STEADY BURN LIGHTS @ 50' CENTERS, 25' CENTERS ALONG TAPERS
  - IMPACT ATTENUATOR, TEMPORARY
  - VERTICAL PANEL
  - TYPE III BARRICADE WITH FLASHING LIGHTS

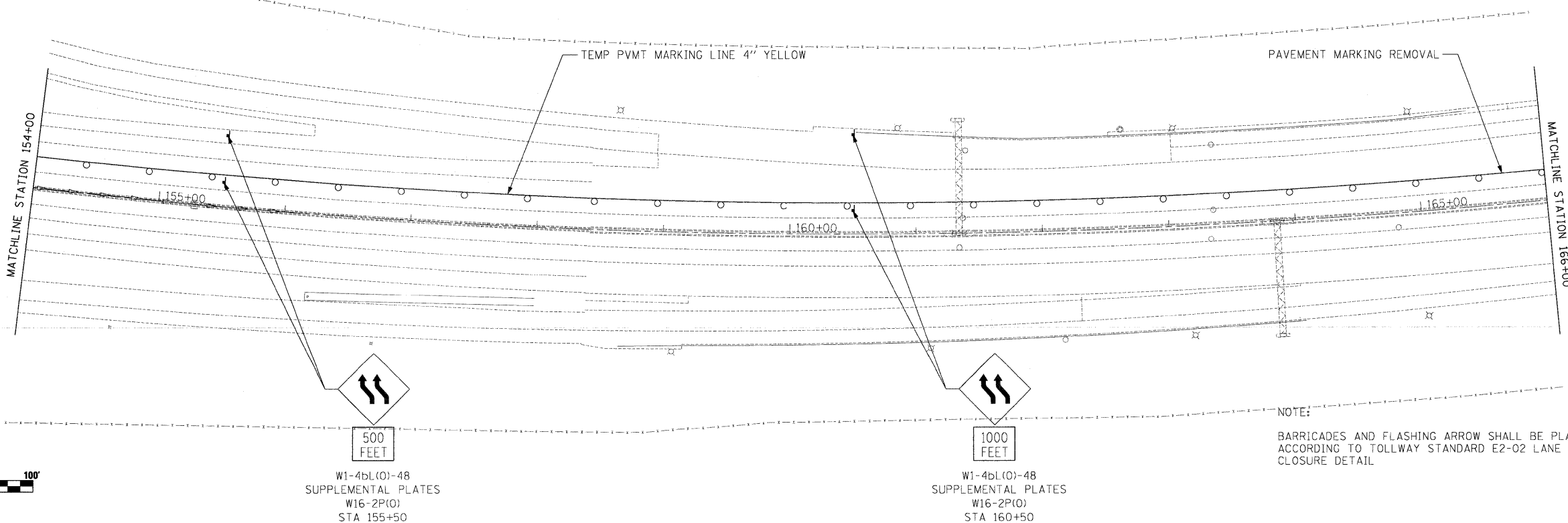

NOTE:  
BARRICADES AND FLASHING ARROW SHALL BE PLACED ACCORDING TO TOLLWAY STANDARD E2-02 LANE CLOSURE DETAIL

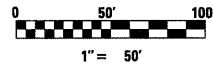

W1-4bL(O)-48  
SUPPLEMENTAL PLATES  
W16-2P(O)  
STA 155+50

W1-4bL(O)-48  
SUPPLEMENTAL PLATES  
W16-2P(O)  
STA 160+50



USER NAME = .USERNAME.	DESIGNED - CGC	REVISED -
PLOT SCALE = 50,0000' / IN.	DRAWN - CGC	REVISED -
PLOT DATE = 10/19/2011	CHECKED - AM	REVISED -
	DATE - 10/14/2011	REVISED -

**STATE OF ILLINOIS  
DEPARTMENT OF TRANSPORTATION**

**MOT I-90 STAGE 1B**

SCALE: 1"=50' SHEET NO. OF SHEETS STA. 144+00 TO STA. 166+00

F.A.I. RTE.	SECTION	COUNTY	TOTAL SHEETS	SHEET NO.
90	(X2-1)R	WINNEBAGO	510	167
CONTRACT NO. 64C29			ILLINOIS FED. AID PROJECT	