



DRAINAGE STRUCTURE SCHEDULE

NO.	LOCATION		TYPE	RIM ELEV LT	RIM ELEV RT	INVERT ELEVATION			
	STATION	OFFSET				(IN)	(IN)	(IN)	(OUT)
94	125+40	0.0	DR STR T4 W/2 T20F&G	784.67	784.59				779.88
95	127+77	0.0	DR STR T4 W/2 T20F&G	783.96	783.85	779.08			778.54
96	130+14	0.0	DR STR T4 W/2 T20F&G	783.25	783.10	777.83			777.83
97	132+51	0.0	DR STR T4 SPL W/2 T20F&G	782.55	782.36	777.13			776.38
98	132+51	118.6 RT	PRC FLAR END SEC 24	-	-				775.23

LEGEND

- DRAINAGE STRUCTURES
- STORM SEWERS

UNDERDRAIN CONNECTION NOTE:

CONTRACTOR SHALL CONNECT THE PROPOSED PIPE UNDERDRAIN (OF DIAMETER SPECIFIED) TO THE PROPOSED INLET AT AN ELEVATION OF 2.50' BELOW THE RIM ELEVATION OF THE INLET BEING CONNECTED TO. THIS WORK SHALL BE IN ACCORDANCE WITH SECTION 601 OF THE STATE STANDARDS AND STATE STANDARD 601001-04 AND SHALL BE INCLUDED IN THE PAY ITEM PIPE UNDERDRAINS OF THE DIAMETER SPECIFIED OR THE KIND OF MATERIAL AND DIAMETER SPECIFIED.

SCHROEDER BELOIT LLC

STORM SEWERS SCHEDULE

SEWER (NO.)	TYPE	SIZE	LENGTH	SLOPE
		(INCH)	(FEET)	(%)
55	STORM SEW CL A 2	18	234.0	0.34%
56	STORM SEW CL A 2	24	234.0	0.30%
57	STORM SEW CL A 2	24	233.5	0.30%
58	STORM SEW CL A 2	24	109.0	1.00%

JIM HEIDENREICH

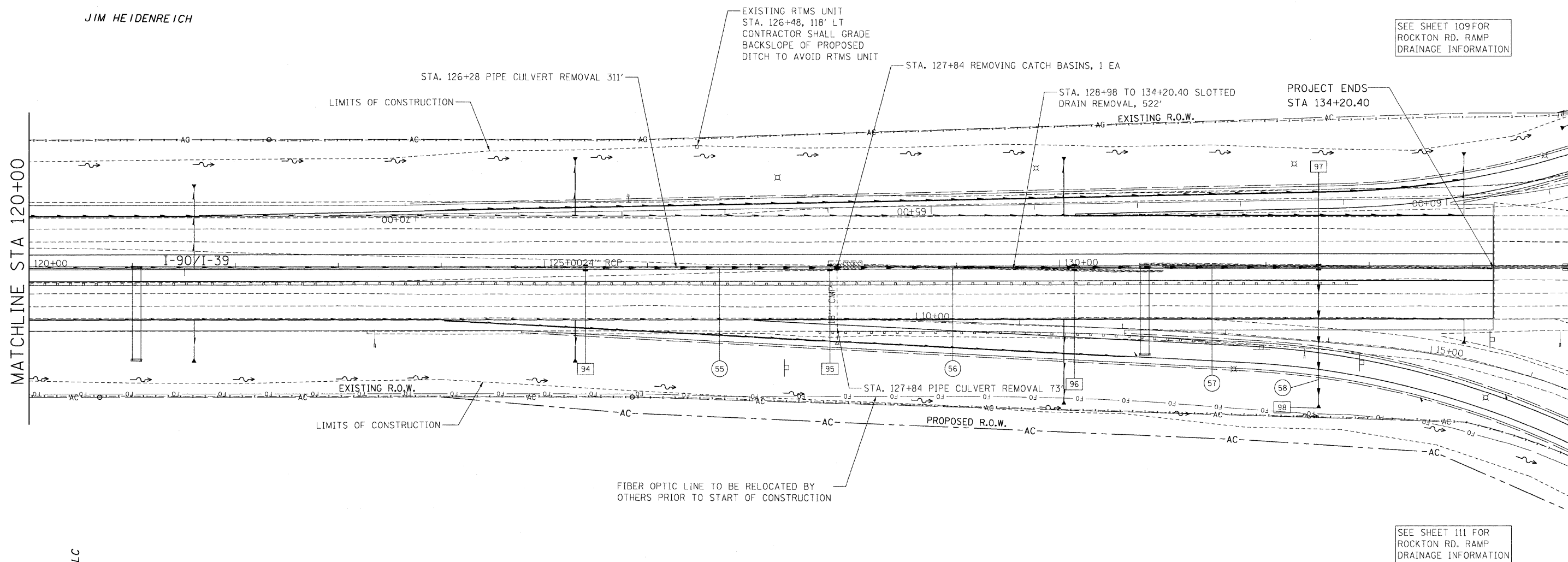

SEE SHEET 109 FOR ROCKTON RD. RAMP DRAINAGE INFORMATION

SEE SHEET 111 FOR ROCKTON RD. RAMP DRAINAGE INFORMATION

AUXI & ASSOCIATES INC , TRUSTEE

ITC PARTNERS LLC



**McClure LOCHNER**  
Engineering Associates, Inc.  
CHICAGO, ILLINOIS

**RWA**  
REGISTERED PROFESSIONAL ENGINEER  
ILLINOIS

USER NAME = .USERNAME.	DESIGNED - DA	REVISED -
PLOT SCALE = 50.0000' / IN.	DRAWN - DA	REVISED -
PLOT DATE = 10/19/2011	CHECKED - AM	REVISED -
	DATE - 10/14/2011	REVISED -

**STATE OF ILLINOIS**  
**DEPARTMENT OF TRANSPORTATION**

**I-90 DRAINAGE PLANS**

SCALE: SHEET NO. OF SHEETS STA. 120+00 TO STA. 135+00

F.A.I. RTE.	SECTION	COUNTY	TOTAL SHEETS	SHEET NO.
90	(X2-1)R	WINNEBAGO	510	239
CONTRACT NO. 64C29			ILLINOIS FED. AID PROJECT	