

DATE	
BY	
FINAL SURVEY	SURVEYED
NOTE BOOK	PLOTTED
NO.	REPLATE
	AREAS CHECKED

DATE	
BY	
ORIGINAL SURVEY	SURVEYED
NOTE BOOK	PLOTTED
NO.	REPLATE
	AREAS CHECKED

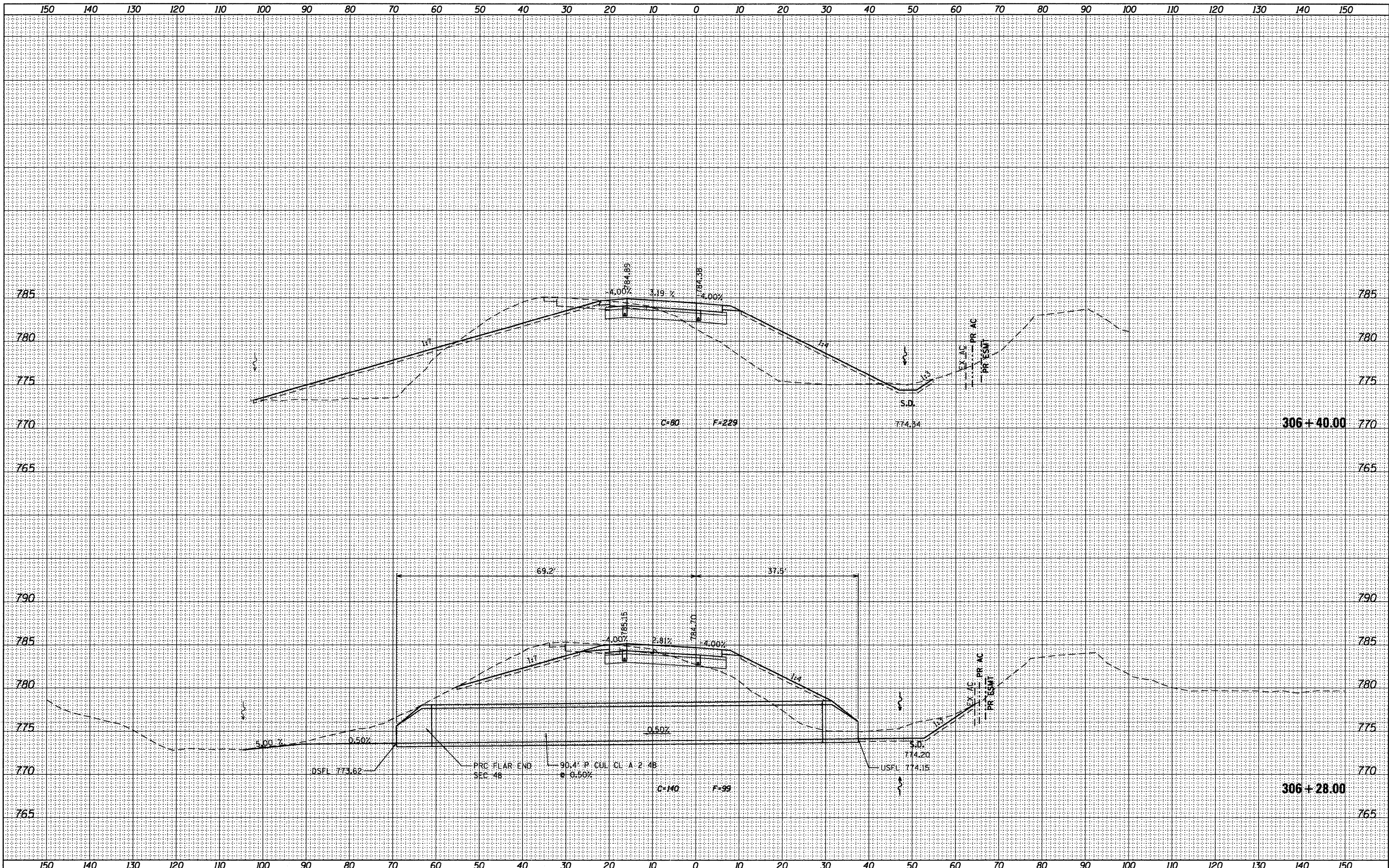

McClure LOCHNER
Engineering Associates, Inc.
REGISTERED PROFESSIONAL ENGINEERS
ILLINOIS

RVA
REGISTERED PROFESSIONAL ARCHITECTS
ILLINOIS

QUIG ENGINEERING, INC.

USER NAME = USERNAME	DESIGNED - MM	REVISED -
FILE NAME = D206606-shr-xshtrneramp.dgn	DRAWN - MS	REVISED -
PLOT SCALE = 10.0000' / in.	CHECKED - MM	REVISED -
PLOT DATE = 10/19/2011	DATE - 10/21/2011	REVISED -

**STATE OF ILLINOIS
DEPARTMENT OF TRANSPORTATION**

SCALE: H: 1"=10'	
V: 1"=5'	
SHEET NO. 4 OF 8 SHEETS	STA. 306+28.00 TO STA. 306+40.00

**CROSS SECTIONS
ROCKTON RD NE RAMP**

F.A.I. RTE. 90	SECTION (X2-1)R	COUNTY WINNEBAGO	TOTAL SHEETS 510	SHEET NO. 484
CONTRACT NO. 64C29				
ILLINOIS FED. AID PROJECT				