

DATE \_\_\_\_\_  
 BY \_\_\_\_\_  
 SURVEYED \_\_\_\_\_  
 PLOTTED \_\_\_\_\_  
 NOTE BOOK \_\_\_\_\_  
 AREAS CHECKED \_\_\_\_\_  
 NO. \_\_\_\_\_

DATE \_\_\_\_\_  
 BY \_\_\_\_\_  
 SURVEYED \_\_\_\_\_  
 PLOTTED \_\_\_\_\_  
 NOTE BOOK \_\_\_\_\_  
 AREAS CHECKED \_\_\_\_\_  
 NO. \_\_\_\_\_

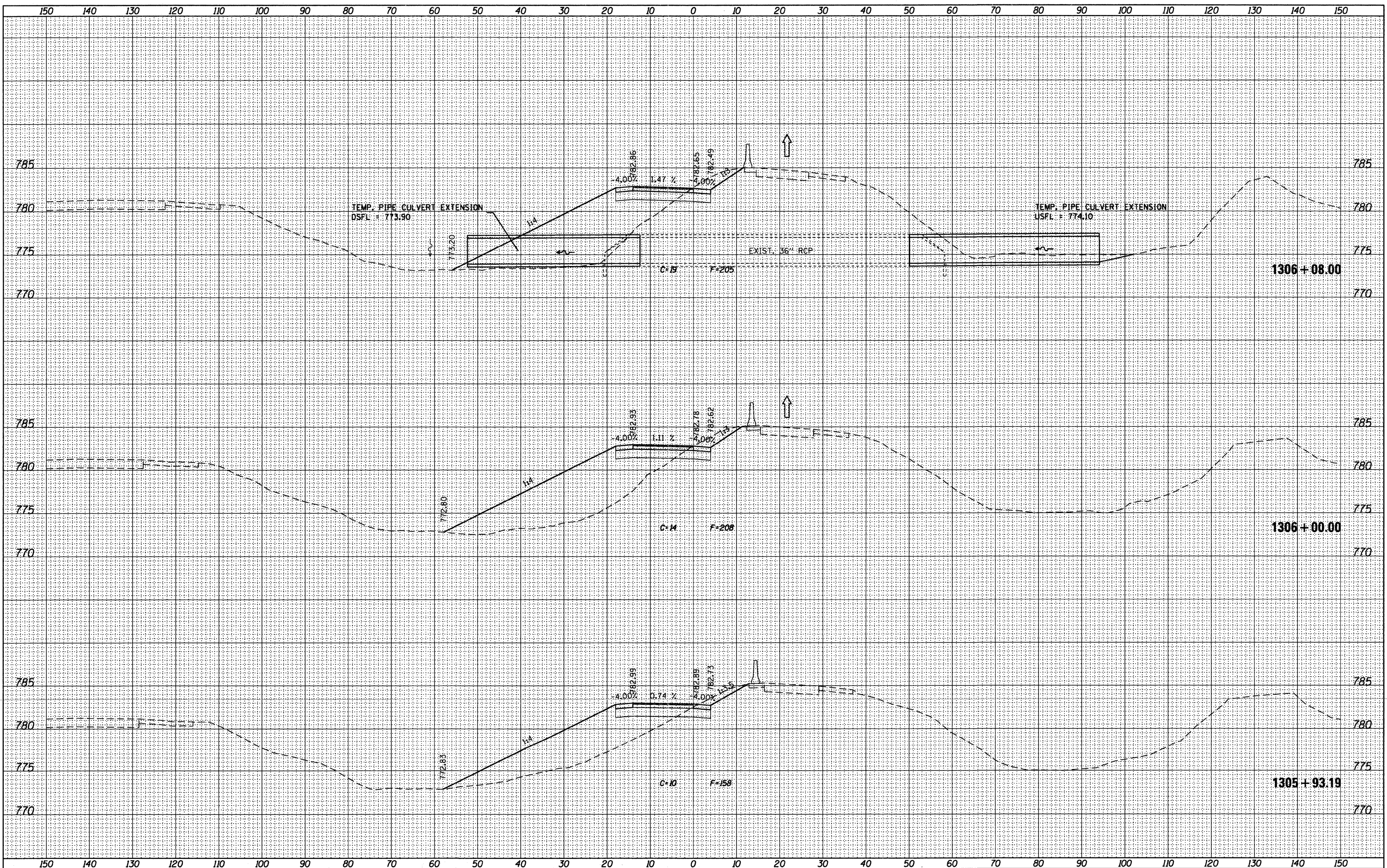

**McClure LOCHNER**  
 Engineering Associates, Inc.  
 1100 W. LOCHNER, CHICAGO, ILLINOIS

**RVA**  
 REGINA V. ANDERSON, INC.

**QUIGGS ENGINEERING INC.**

USER NAME = .\USERNAME_	DESIGNED - MM	REVISED -
FILE NAME = sht:\xeshtrieramp-stg1a.dgn	DRAWN - MS	REVISED -
PLOT SCALE = 10.0000' / 1" =	CHECKED - MM	REVISED -
PLOT DATE = 10/19/2011	DATE - 10/21/2011	REVISED -

**STATE OF ILLINOIS  
 DEPARTMENT OF TRANSPORTATION**

**CROSS SECTIONS**

**ROCKTON RD NE RAMP - STAGE 1A**

SCALE: H<sub>1</sub> 1"=10'  
 V<sub>1</sub> 1"=5'

SHEET NO. 4 OF 5 SHEETS STA. 1305+93.19 TO STA. 1306+08.00

F.A.I. RTE. 90	SECTION (X2-1)R	COUNTY WINNEBAGO	TOTAL SHEETS 510	SHEET NO. 492
CONTRACT NO. 64C29			ILLINOIS FED. AID PROJECT	