

DATE	
BY	
ORIGINAL SURVEY	
PLOTTED	
TEMPLATE	
NOTE BOOK	
AREAS CHECKED	
NO.	

DATE	
BY	
ORIGINAL SURVEY	
PLOTTED	
TEMPLATE	
NOTE BOOK	
AREAS CHECKED	
NO.	

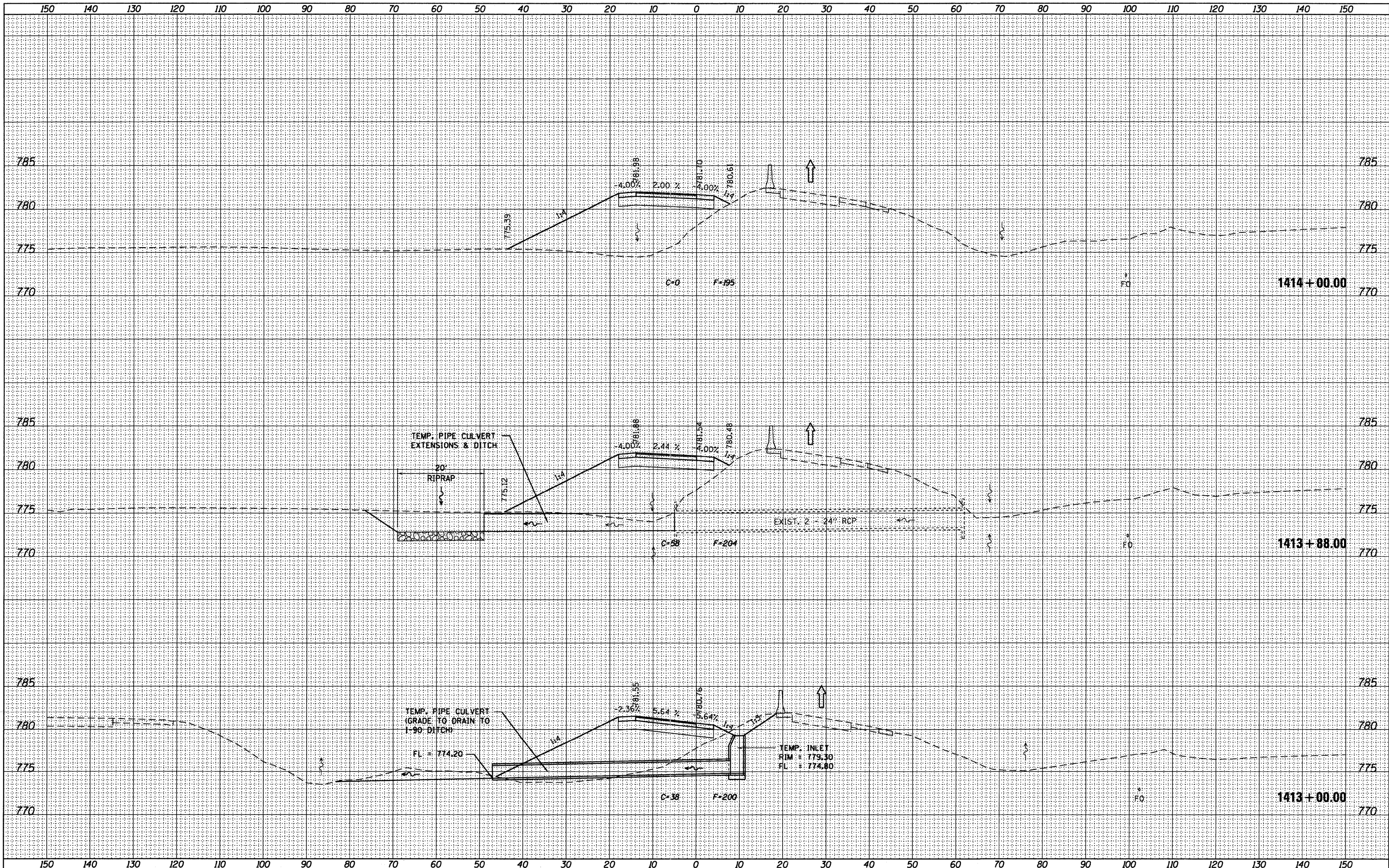

McClure LOCHNER
Engineering Associates, Inc.
CHICAGO, ILLINOIS

RVA
REGISTERED PROFESSIONAL ENGINEER
STATE OF ILLINOIS

GUIDO ENGINEERING INC.

USER NAME = .USERNAME.	DESIGNED - MM	REVISED -
FILE NAME = sht-xshtnramp-stg2pre.dgn	DRAWN - MS	REVISED -
PLOT SCALE = 10.0000' / 1" =	CHECKED - MM	REVISED -
PLOT DATE = 10/19/2011	DATE - 10/21/2011	REVISED -

**STATE OF ILLINOIS
DEPARTMENT OF TRANSPORTATION**

CROSS SECTIONS
ROCKTON RD NW RAMP - STAGE 2 PRE-STAGE

SCALE: H: 1"=10'
V: 1"=5'

SHEET NO. 2 OF 4 SHEETS STA. 1413+00.00 TO STA. 1414+00.00

F.A.I. RTE.	SECTION	COUNTY	TOTAL SHEETS	SHEET NO.
90	(X2-1R)	WINNEBAGO	510	501
			CONTRACT NO. 64C29	
ILLINOIS FED. AID PROJECT				