

PLAN	SURVEYED	BY	DATE
	PLOTTED		
	CHECKED		
	REVISIONS		
	RI. OF WAY CHECKED		
	CADD FILE NAME		
	NO.		

PROFILE	SURVEYED	BY	DATE
	PLOTTED		
	CHECKED		
	REVISIONS		
	STRUCTURE NOTATIONS CHKD		
	NO.		

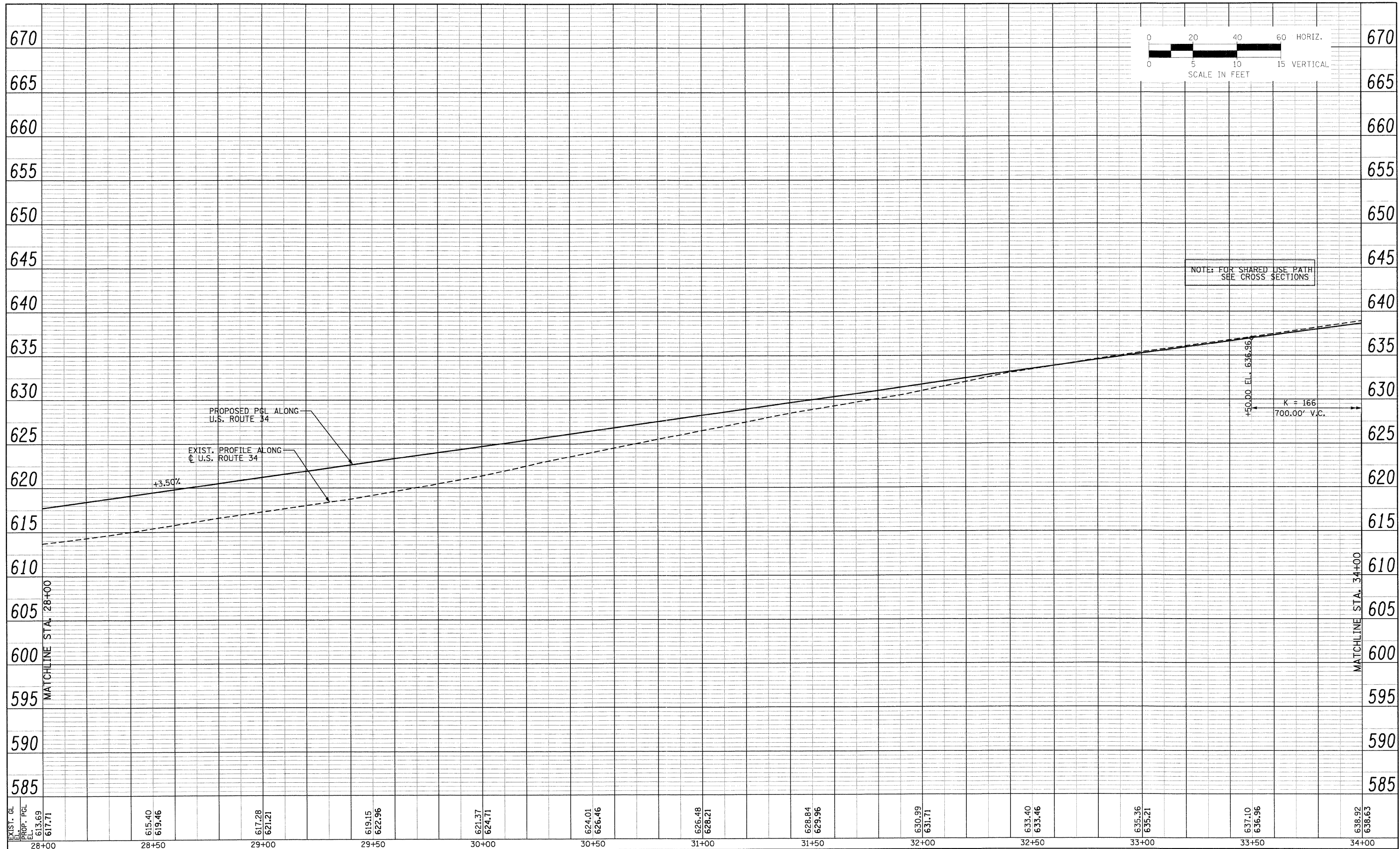

EXIST. GL EL. PROP. PGL EL.	613.69 617.71	615.40 619.46	617.28 621.21	619.15 622.96	621.37 624.71	624.01 626.46	626.48 628.21	628.84 629.96	630.99 631.71	633.40 633.46	635.36 635.21	637.10 636.96	638.92 638.63
	28+00	28+50	29+00	29+50	30+00	30+50	31+00	31+50	32+00	32+50	33+00	33+50	34+00

871E1.6

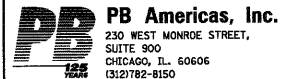

FILE NAME = D366785-shr-5prof.dgn
PLOT SCALE = 20
PLOT DATE = 19-AUG-2011 08:14

DESIGNED - MMS
DRAWN - MMS
CHECKED - KJB
DATE - 08-18-2011

REVISED -
REVISED -
REVISED -
REVISED -

**STATE OF ILLINOIS
DEPARTMENT OF TRANSPORTATION**

U.S. 34 PLAN & PROFILE

SCALE: 1"=20' Horiz PNP - 5B OF 27 STA. 28+00 TO STA. 34+00

F.A.P. RTE.	SECTION	COUNTY	TOTAL SHEETS	SHEET NO.
591	13R-2;14R-1 & BR-1(1);15R-1	KENDALL	429	65
FINAL SUBMITTAL			CONTRACT NO. 66985	
(ILLINOIS) FED. AID PROJECT				