

DATE	
BY	
PLAN	REVIEWED
	ALIGNED
	CHECKED
	DATE
	FILE NAME
	NO.

DATE	
BY	
PROFILE	REVIEWED
	GRADES
	CHECKED
	STRUCTURE
	NOTATIONS
	CHRD
	NO.

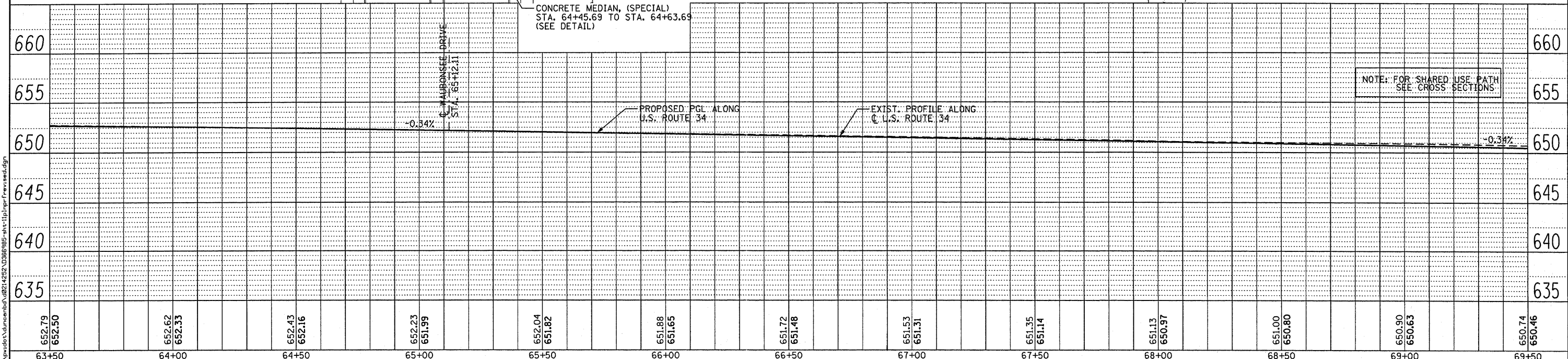
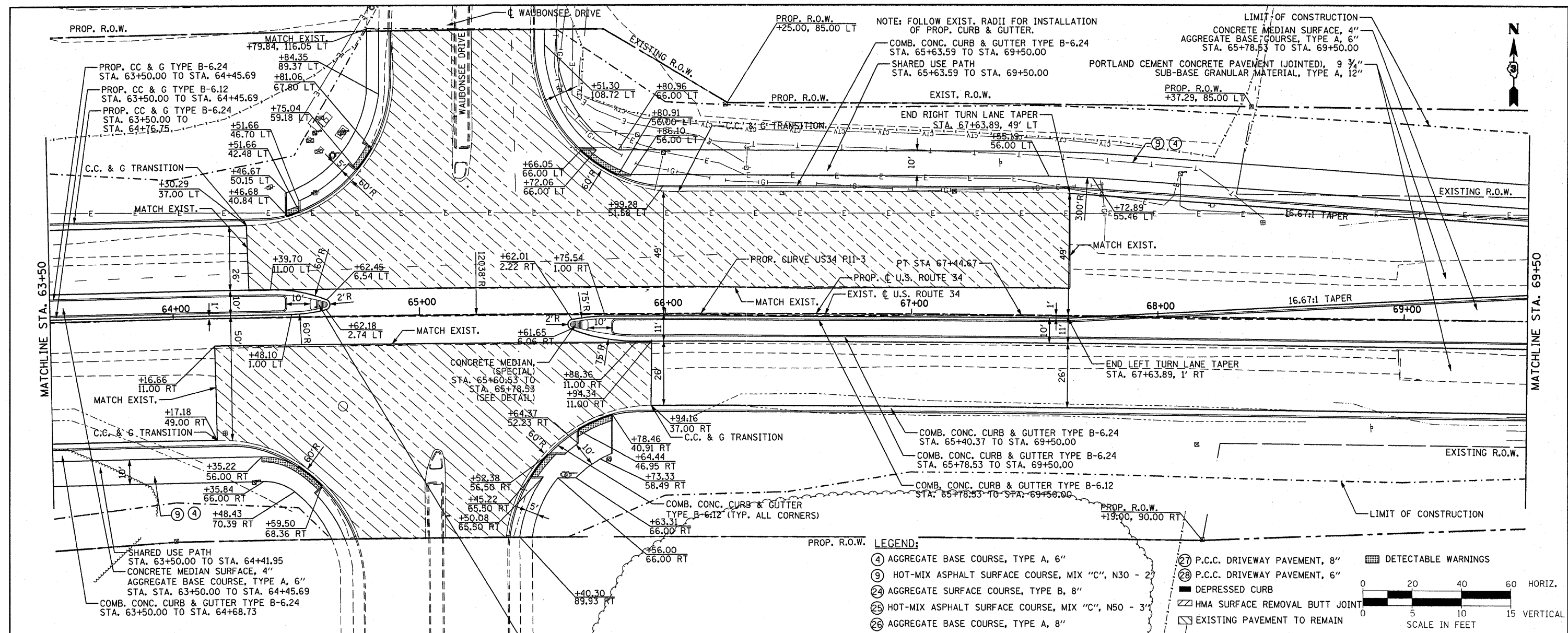

63+50	64+00	64+50	65+00	65+50	66+00	66+50	67+00	67+50	68+00	68+50	69+00	69+50													
652.79	652.50	652.62	652.33	652.43	652.16	652.23	651.99	652.04	651.82	651.88	651.65	651.72	651.48	651.53	651.31	651.35	651.14	651.13	650.97	651.00	650.80	650.90	650.63	650.74	650.46

PB Americas, Inc.
 230 WEST MONROE STREET,
 SUITE 900
 CHICAGO, IL 60606
 (312)782-8150

FILE NAME = duncanbd	DESIGNED - MMS	REVISED - BDD 09/27/2011
PLOT SCALE = 28,0000' / in.	DRAWN - MMS	REVISED -
PLOT DATE = 9/27/2011	CHECKED - KJB	REVISED -
	DATE - 08-18-2011	REVISED -

STATE OF ILLINOIS
DEPARTMENT OF TRANSPORTATION

U.S. 34 PLAN & PROFILE

SCALE: 1"=20' HORIZ PNP - 11 OF 27 STA. 63+50 TO STA. 69+50

F.A.P. RTE.	SECTION	COUNTY	TOTAL SHEETS	SHEET NO.
591	13R-2;14R-1 & BR-1(1);15R-1	KENDALL	429	72
	FINAL SUBMITTAL	CONTRACT NO. 66985		
	ILLINOIS FED. AID PROJECT			