

LEGEND:

- ④ AGGREGATE BASE COURSE, TYPE A, 6"
- ⑨ HOT-MIX ASPHALT SURFACE COURSE, MIX "C", N30 - 2"
- ②④ AGGREGATE SURFACE COURSE, TYPE B, 8"
- ②⑤ HOT-MIX ASPHALT SURFACE COURSE, MIX "C", N50 - 3"
- ②⑥ AGGREGATE BASE COURSE, TYPE A, 8"
- ②⑦ P.C.C. DRIVEWAY PAVEMENT, 8"
- ②⑧ P.C.C. DRIVEWAY PAVEMENT, 6"
- DEPRESSED CURB
- ▨ HMA SURFACE REMOVAL BUTT JOINT
- ▨ DETECTABLE WARNINGS

DATE	
BY	
PLAN	
SURVEYED	
PLOTTED	
NOTED	
REVISIONS	
NO.	
DATE	
BY	
PROFILE	
SURVEYED	
PLOTTED	
NOTED	
REVISIONS	
NO.	
DATE	
BY	

DATE	
BY	
PROFILE	
SURVEYED	
PLOTTED	
NOTED	
REVISIONS	
NO.	
DATE	
BY	

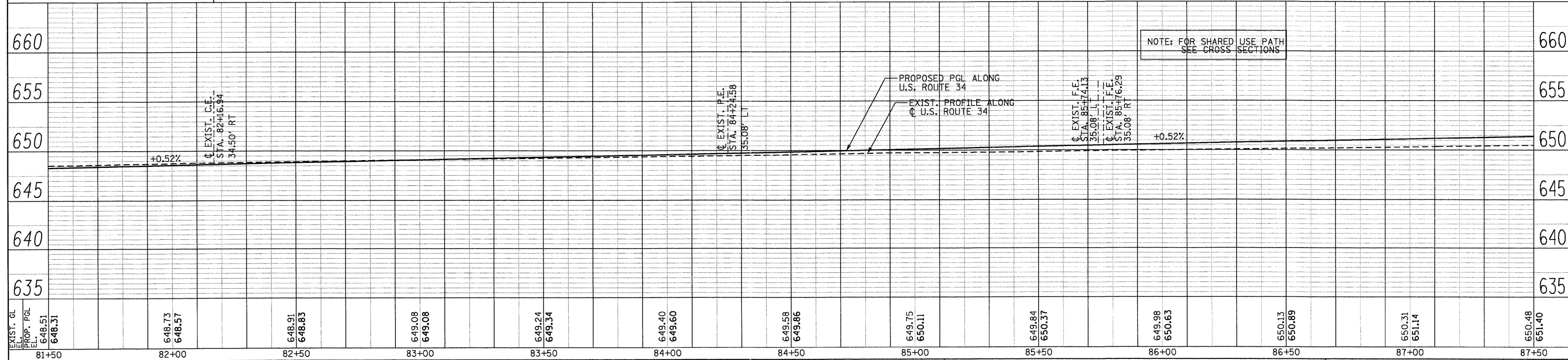
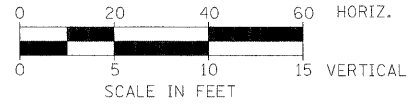
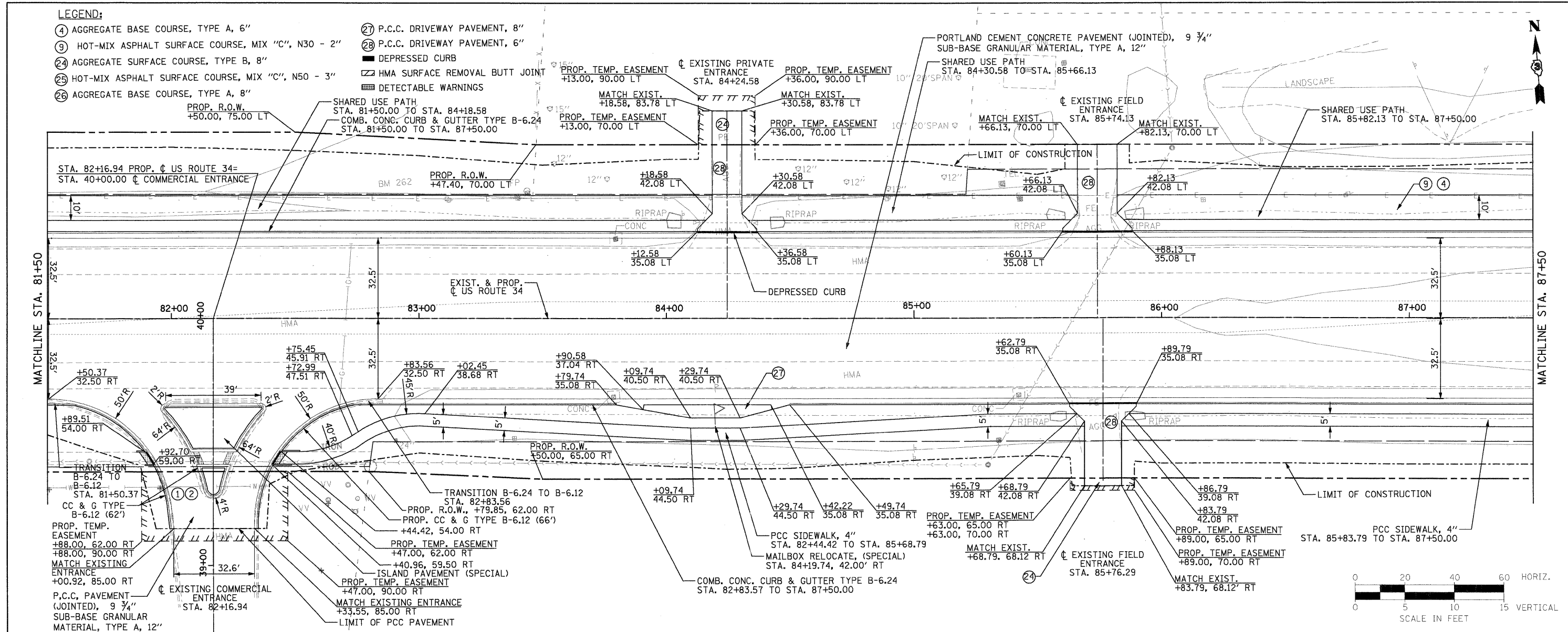

PB Americas, Inc.
 230 WEST MONROE STREET,
 SUITE 900
 CHICAGO, IL 60606
 (312)782-8150

FILE NAME = D366985-sht-14planpr.dgn	DESIGNED - MMS	REVISED -
PLOT SCALE = 20'	DRAWN - MMS	REVISED -
PLOT DATE = 19-AUG-2011 08:15	CHECKED - KJB	REVISED -
	DATE - 08-18-2011	REVISED -

**STATE OF ILLINOIS
 DEPARTMENT OF TRANSPORTATION**

U.S. 34 PLAN & PROFILE
 SCALE: 1"=20' Horiz PNP - 14 OF 27 STA. 81+50 TO STA. 87+50

F.A.P. RTE.	SECTION	COUNTY	TOTAL SHEETS	SHEET NO.
591	13R-214R-1 & BR-1015R-1	KENDALL	429	75
FINAL SUBMITTAL			CONTRACT NO. 66985	
ILLINOIS FED. AID PROJECT				