

PLAN	SURVEYED	DATE
	PLOTTED	
	NOTED	
	CHECKED	
	BY	
	NO.	

PROFILE	SURVEYED	DATE
	PLOTTED	
	NOTED	
	CHECKED	
	BY	
	NO.	

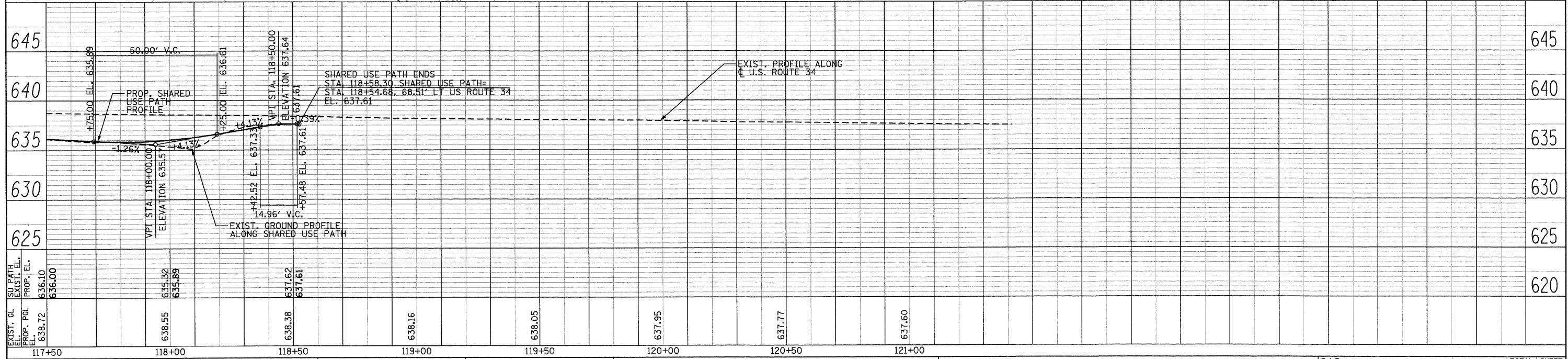
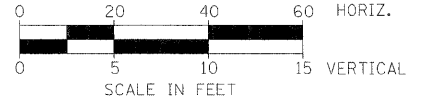
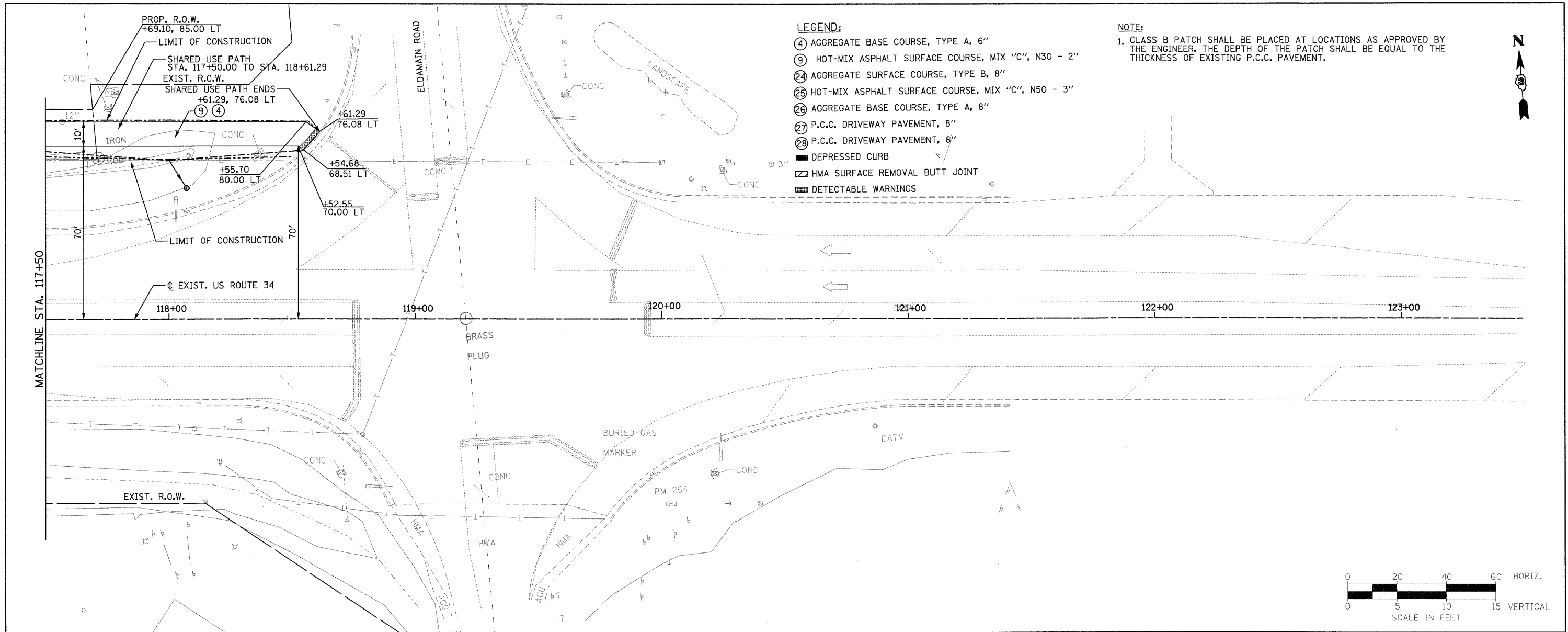

**PB Americas, Inc.**  
230 WEST MONROE STREET,  
SUITE 900  
CHICAGO, IL 60606  
(312)782-8150

FILE NAME = 0366989-shr-20p1nprf.dgn  
DESIGNED - MMS  
DRAWN - MMS  
CHECKED - KJB  
DATE - 08-18-2011

REVISED -  
REVISED -  
REVISED -  
REVISED -

**STATE OF ILLINOIS  
DEPARTMENT OF TRANSPORTATION**

**U.S. 34 PLAN & PROFILE**  
SCALE: 1"=20' Horiz  
PNP - 20 OF 27  
STA. 117+50 TO STA. END

F.A.P. RTE.	SECTION	COUNTY	TOTAL SHEETS	SHEET NO.
591	13R-214R-1 & BR-1(0)15R-1	KENDALL	429	81
FINAL SUBMITTAL			CONTRACT NO. 66985	
ILLINOIS FED. AID PROJECT				