

PLAN	SURVEYED	BY	DATE
	PLOTTED		
	NOTED		
	REVISIONS		
	NO. OF REVISIONS		
	DATE		
	BY		
	DATE		

PROFILE	SURVEYED	BY	DATE
	PLOTTED		
	NOTED		
	REVISIONS		
	NO. OF REVISIONS		
	DATE		
	BY		
	DATE		

**LEGEND:**

- ⑧ HOT-MIX ASPHALT SURFACE COURSE, MIX "C", N50 - 1 1/2"
- ⑩ HOT-MIX ASPHALT BINDER COURSE, IL-19.0, N50 - 2 1/4"
- ③ SUB BASE GRANULAR MATERIAL, TYPE A 8"
- ⑫ HOT-MIX ASPHALT SURFACE COURSE, MIX "C", N50 - 3"
- ⑫ AGGREGATE BASE COURSE, TYPE A, 8"
- ⑫ AGGREGATE SURFACE COURSE, TYPE B, 8"
- ⑭ PORTLAND CEMENT CONCRETE SIDEWALK, 4"
- DEPRESSED CURB
- ▨ HMA SURFACE REMOVAL BUTT JOINT

**LEGEND:**

- ▨ HMA SURFACE REMOVAL BUTT JOINT

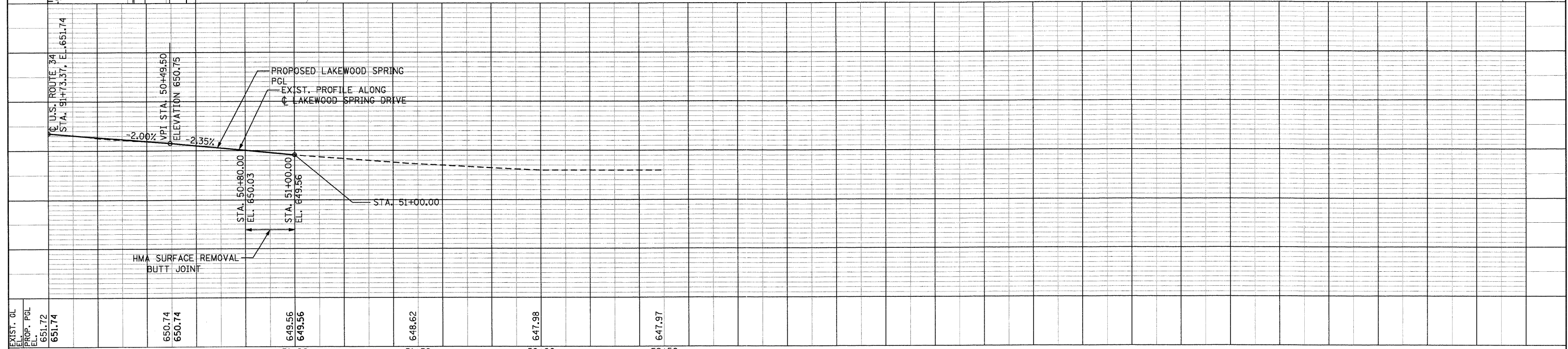
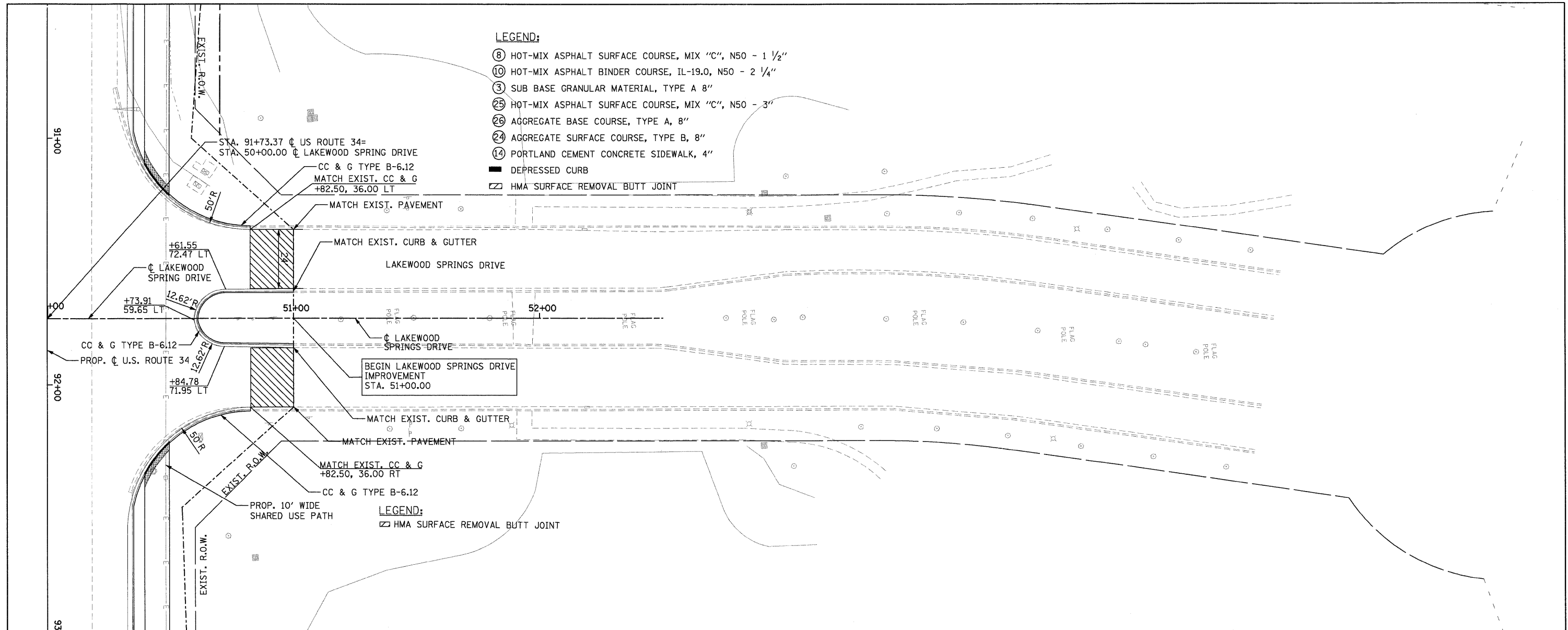

<b>PR</b> PB Americas, Inc. 230 WEST MONROE STREET, SUITE 900 CHICAGO, IL 60606 (312)782-8150	FILE NAME = D366985-ah-25p1npr.dgn DESIGNED - MMS DRAWN - MMS CHECKED - KJB DATE - 08-18-2011	REVISED - REVISED - REVISED - REVISED -	<b>STATE OF ILLINOIS</b> <b>DEPARTMENT OF TRANSPORTATION</b>	<b>CROSS ROAD PLAN &amp; PROFILE</b> <b>LAKEWOOD SPRINGS DRIVE</b>		F.A.P. RTE. 591 SECTION 13R-214R-1 & BR-1(1)15R-1 COUNTY KENDALL TOTAL SHEETS 429 SHEET NO. 86
	PLOT SCALE = 20 PLOT DATE = 19-AUG-2011 08:15	SCALE: 1"=20' Horiz PNP - 25 OF 27 STA. TO STA.		FINAL SUBMITTAL CONTRACT NO. 66985 ILLINOIS FED. AID PROJECT		