

**NOTES:**

1. TEMPORARY PAVEMENT SHALL BE CONSTRUCTED AT THE END OF STAGE I CONSTRUCTION TO MATCH NEW WB PAVEMENT SURFACE FOR STAGE II TRAFFIC.
2. HMA SURFACE REMOVAL SHALL BE DONE DURING NIGHT TIME AT THE END OF STAGE I CONSTRUCTION FOR EXISTING PAVEMENT SURFACE TO MATCH NEW WB PAVEMENT SURFACE AND TO MAKE SUITABLE FOR STAGE II TRAFFIC.
3. LAKEWOOD SPRINGS DRIVE TO BE CONSTRUCTED AS PART OF US34 STAGE I
4. ONE LANE EACH DIRECTION TO REMAIN OPEN AT ALL TIMES.
5. LAKEWOOD STAGE 1: CONSTRUCT NB AND SB OUTSIDE LANES  
LAKEWOOD STAGE 2: CONSTRUCT NB AND SB INSIDE LANES
6. LANE SHIFT TO FOLLOW STND 701701

**LEGEND**

- ① TEMP PVMT MARKING, LINE 4" (WHITE)
- ② TEMP PVMT MARKING, LINE 4" (YELLOW)
- ③ TEMP PVMT MARKING, LINE 4" (DOUBLE YELLOW)
- ④ TEMP PVMT MARKING, LINE 12" (YELLOW)
- ⑤ TEMP PVMT MARKING, LINE 8" (WHITE)
- ⑥ TEMP PVMT MARKING, LINE 8" (2' DASH-6' SKIP WHITE)
- ⑦ TEMP PVMT MARKING, LINE 24" (WHITE)
- ⊞ WORK ZONE
- ⬆ TRAFFIC FLOW ARROW
- TEMPORARY CONCRETE BARRIER
- ⊕ SIGN
- BARRICADE TYPE II OR DRUM WITH STEADY BURN MONODIRECTIONAL LIGHT @ 50' C-C ON TAPER AND 100' C-C ON TANGENT OR AS SHOWN ON THE PLAN
- ⊞ BARRICADE TYPE III WITH FLASHING MONODIRECTIONAL LIGHTS
- ➡ ARROW BOARD
- IMPACT ATTENUATORS, TEMPORARY (SEVERE USE, NARROW), TEST LEVEL 3
- ⊞ TEMPORARY PAVEMENT (HMA BINDER IL-19mm) 9"
- ⊞ PAVEMENT PATCHES

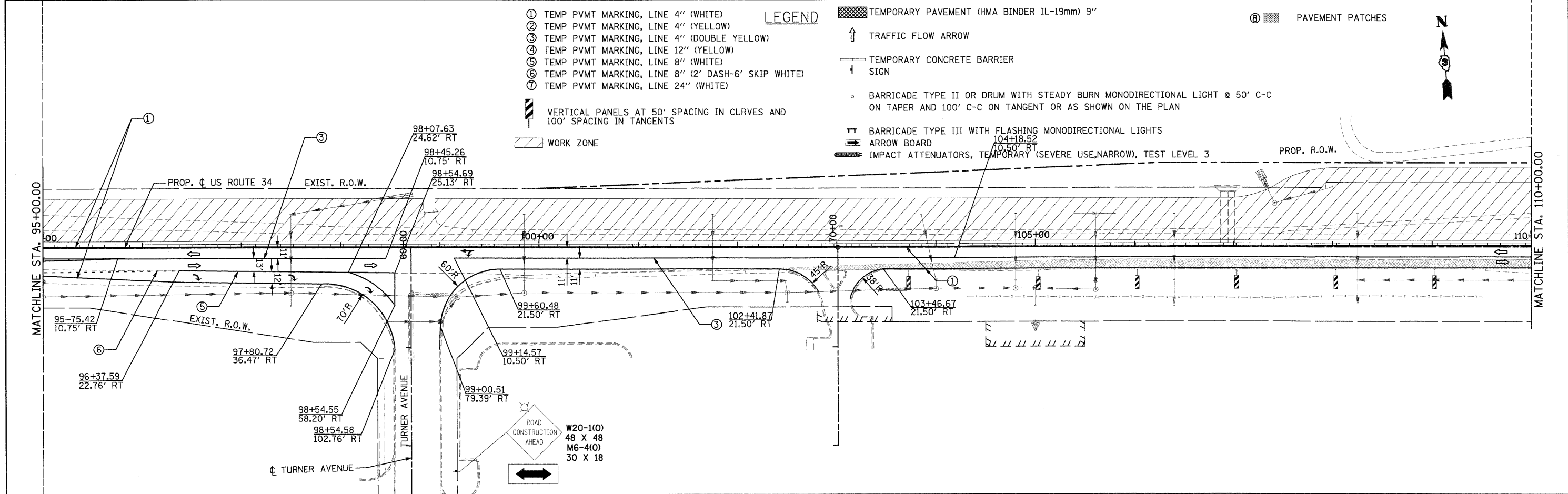

PB Americas, Inc. 230 WEST MONROE STREET, SUITE 900 CHICAGO, IL 60606 (312)782-8150	FILE NAME = 0365985-mot104.dgn PLOT SCALE = 50 PLOT DATE = 19-AUG-2011 08:16	DESIGNED - DM DRAWN - MMS CHECKED - KJB DATE - 08-18-2011	REVISED - REVISED - REVISED - REVISED -	<b>STATE OF ILLINOIS</b> <b>DEPARTMENT OF TRANSPORTATION</b>	<b>SUGGESTED MAINTENANCE OF TRAFFIC</b> <b>US ROUTE 34 - STAGE I</b> SCALE: 1" = 50' MOT - 15 OF 66 STA. 80+00 TO STA. 110+00	F.A.P. RTE. 591 SECTION 13R-2;14R-1 & BR-1(1);15R-1 COUNTY KENDALL TOTAL SHEETS 429 SHEET NO. 103 FINAL SUBMITTAL CONTRACT NO. 66985 ILLINOIS FED. AID PROJECT
---	--	--	--	---	---	---