

- NOTES:**
1. CONCRETE BATCH PLANT TO BE CONSTRUCTED AS PART OF US34 STAGE II.
  2. SOUTH HALF TO BE CONSTRUCTED FIRST.
  3. BATCH PLANT ACCESS TO REMAIN OPEN ALL THE TIMES.

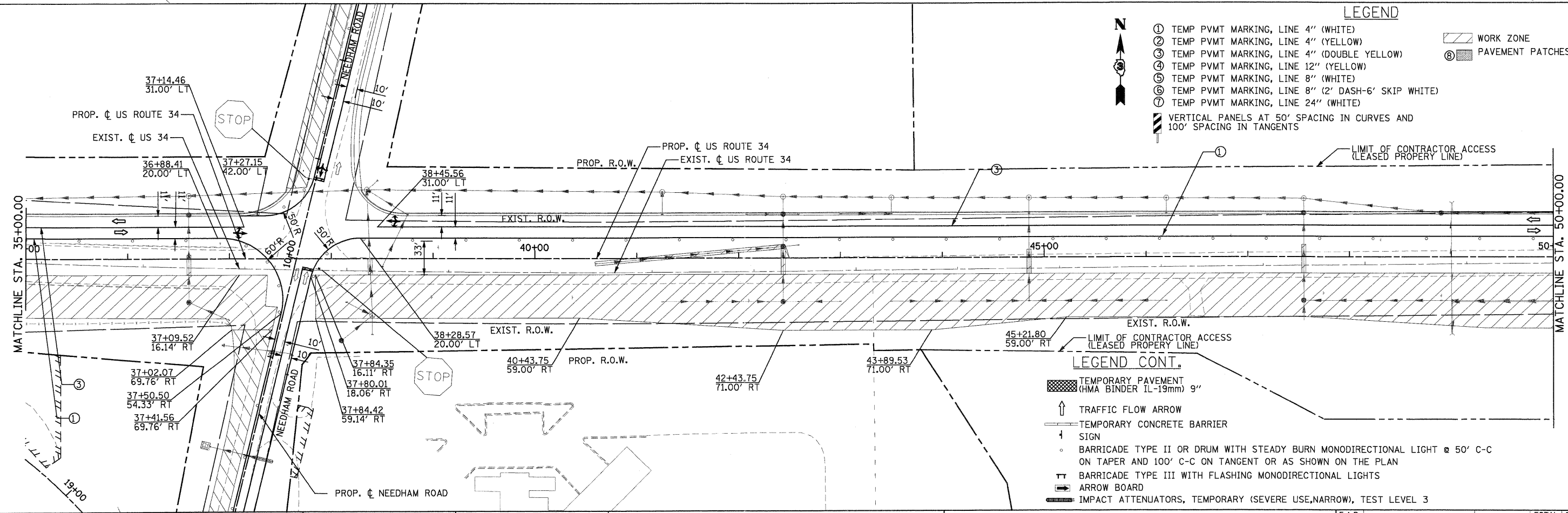

**LEGEND**

- ① TEMP PVMT MARKING, LINE 4" (WHITE)
- ② TEMP PVMT MARKING, LINE 4" (YELLOW)
- ③ TEMP PVMT MARKING, LINE 4" (DOUBLE YELLOW)
- ④ TEMP PVMT MARKING, LINE 12" (YELLOW)
- ⑤ TEMP PVMT MARKING, LINE 8" (WHITE)
- ⑥ TEMP PVMT MARKING, LINE 8" (2' DASH-6' SKIP WHITE)
- ⑦ TEMP PVMT MARKING, LINE 24" (WHITE)
- ⊥ VERTICAL PANELS AT 50' SPACING IN CURVES AND 100' SPACING IN TANGENTS
- ▨ WORK ZONE
- ⊗ PAVEMENT PATCHES

**LEGEND CONT.**

- ▨ TEMPORARY PAVEMENT (HMA BINDER IL-19mm) 9"
- ↑ TRAFFIC FLOW ARROW
- TEMPORARY CONCRETE BARRIER
- ⊥ SIGN
- BARRICADE TYPE II OR DRUM WITH STEADY BURN MONODIRECTIONAL LIGHT @ 50' C-C ON TAPER AND 100' C-C ON TANGENT OR AS SHOWN ON THE PLAN
- ⊥ BARRICADE TYPE III WITH FLASHING MONODIRECTIONAL LIGHTS
- ARROW BOARD
- ▬ IMPACT ATTENUATORS, TEMPORARY (SEVERE USE, NARROW), TEST LEVEL 3

**PB Americas, Inc.**  
 230 WEST MONROE STREET,  
 SUITE 900  
 CHICAGO, IL 60606  
 (312)782-8150

FILE NAME = 0366985-mot1102.dgn  
 PLOT SCALE = 50  
 PLOT DATE = 19-AUG-2011 09:17

DESIGNED - DM  
 DRAWN - MMS  
 CHECKED - KJB  
 DATE - 08-18-2011

REVISED -  
 REVISED -  
 REVISED -  
 REVISED -

**STATE OF ILLINOIS  
 DEPARTMENT OF TRANSPORTATION**

**SUGGESTED MAINTENANCE OF TRAFFIC  
 US ROUTE 34 - STAGE II**

SCALE: 1" = 50'  
 MOT - 18 OF 66  
 STA. 20+00 TO STA. 50+00

F.A.P. RTE.	SECTION	COUNTY	TOTAL SHEETS	SHEET NO.
591	13R-214R-1 & BR-1(D)15R-1	KENDALL	429	106
FINAL SUBMITTAL			CONTRACT NO. 66985	
ILLINOIS FED. AID PROJECT				