

ORIGINAL SURVEY NO. _____
 SURVEYED PLOTTED _____
 NOTE BOOK TEMPLATE _____
 AREAS CHECKED _____
 BY _____ DATE _____
 FINAL SURVEY NO. _____
 SURVEYED PLOTTED _____
 NOTE BOOK TEMPLATE _____
 AREAS CHECKED _____
 BY _____ DATE _____

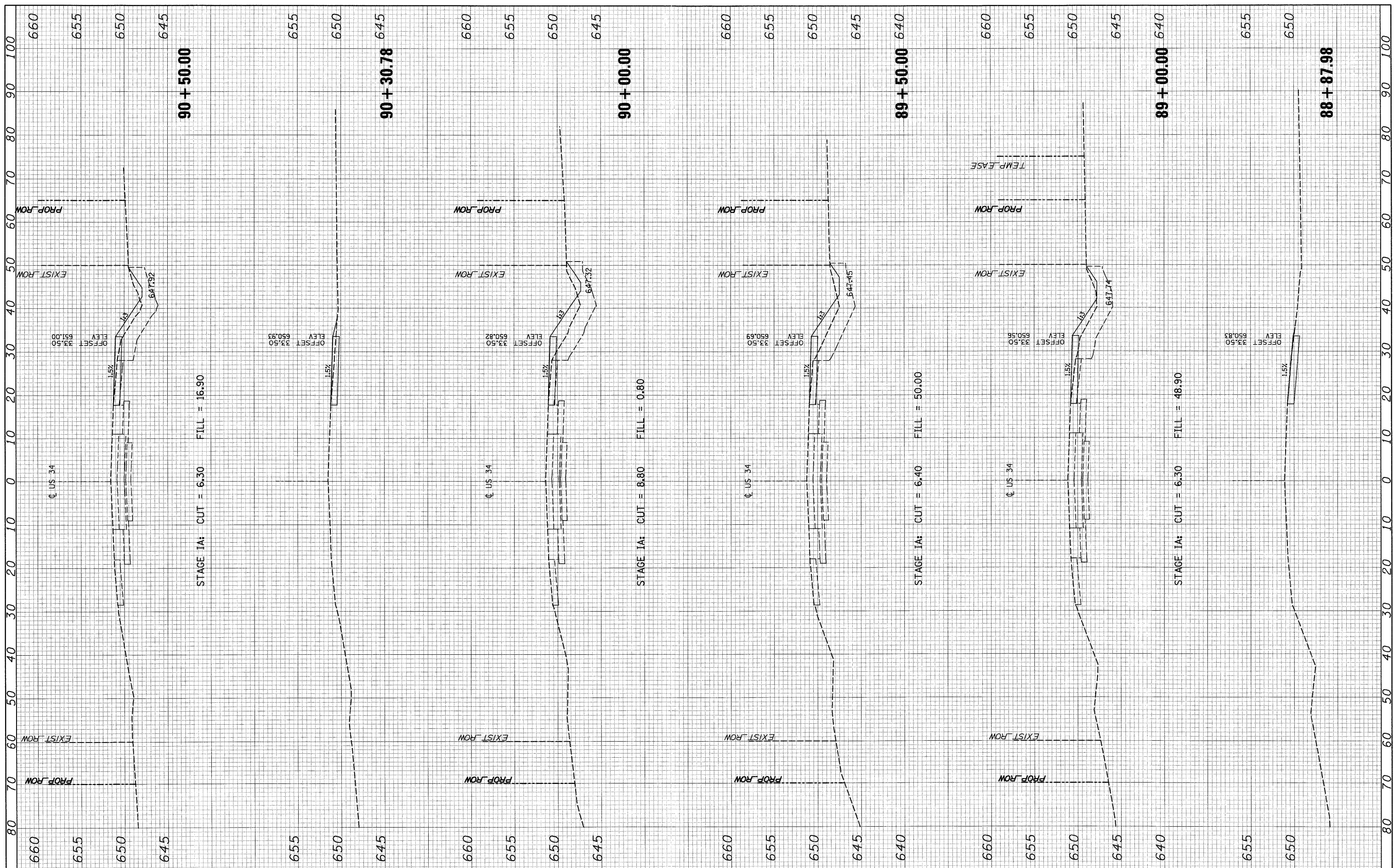

FILE NAME =	USER NAME = US34XSEC-MOTstageIA-Sheets	DESIGNED - MMS	REVISED -	STATE OF ILLINOIS DEPARTMENT OF TRANSPORTATION	SUGGESTED MAINTENANCE OF TRAFFIC US ROUTE 34 - STAGE IA - CROSS SECTIONS			F.A.P. RTE. 591	SECTION 13R-2;14R-1 & BR-1(0);15R-1	COUNTY KENDALL	TOTAL SHEETS 429	SHEET NO. 142
#FILE#	PLOT SCALE =	DRAWN - MMS	REVISED -		SCALE:	MOT 54 OF 66 SHEETS	STA. 88+87.98	TO STA. 90+50.00	FINAL SUBMITTAL ILLINOIS FED. AID PROJECT		CONTRACT NO. 66985	
	PLOT DATE = 19-AUG-2011 09:17	CHECKED - KJB	REVISED -									
		DATE - 08-18-2011	REVISED -									