

LEGEND:

- 1 STRUCTURE NUMBER
- 1 PIPE NUMBER
- ~ PROPOSED DITCH
- PROPOSED CATCH BASIN
- PROPOSED INLET
- PROPOSED MANHOLE
- PROPOSED STORM SEWER
- EXISTING CATCH BASIN
- EXISTING INLET
- EXISTING MANHOLE
- EXISTING STORM SEWER

STA. 98+71.01 PROP. C US ROUTE 34=
 STA. 60+00.00 C TURNER DRIVE

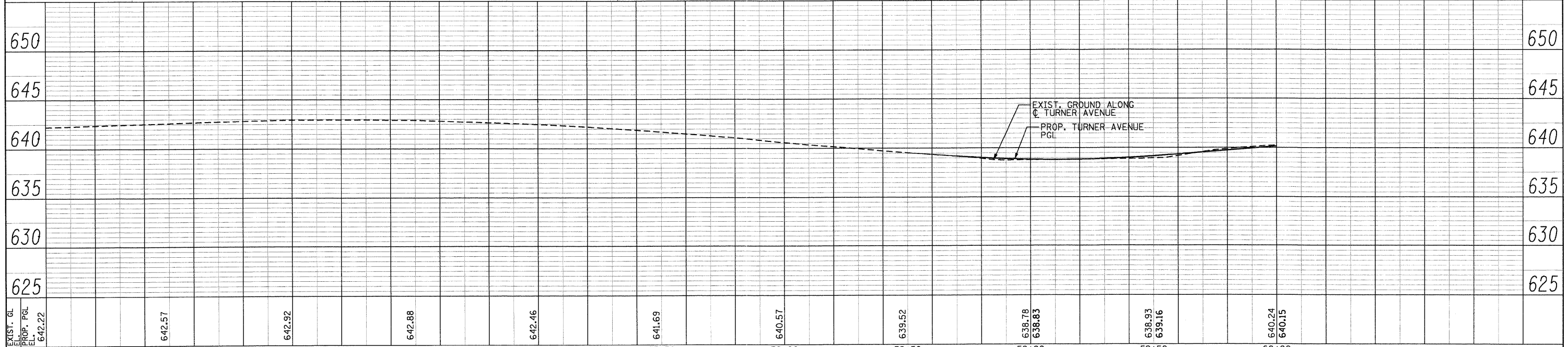
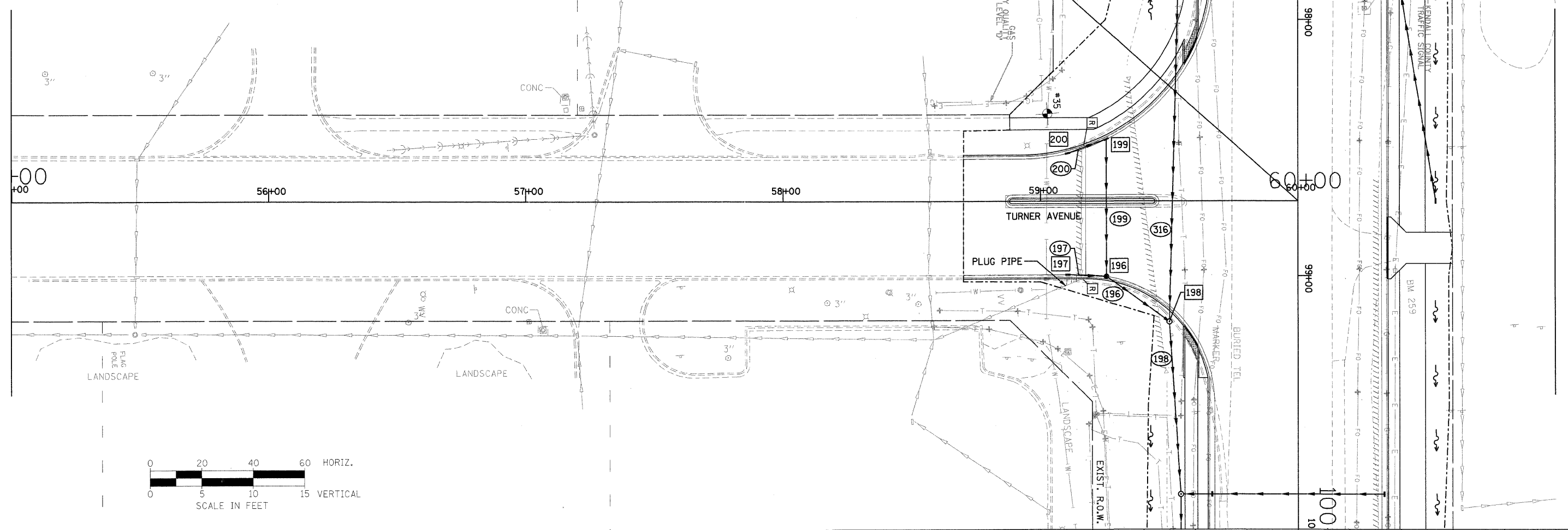

	55+00	55+50	56+00	56+50	57+00	57+50	58+00	58+50	59+00	59+50	60+00	
EXIST. G.L. E.L.												
PROP. P.G.L. E.L.												
E.L.	642.22	642.57	642.92	642.88	642.46	641.69	640.57	639.52	638.78 638.83	638.93 639.16	640.24 640.15	

PLAN	SURVEYED	BY	DATE
	ALIGNED		
	CHECKED		
	RT. OF WAY		
	CHECKED		
	NO.		
	CADD FILE NAME		

PROFILE	SURVEYED	BY	DATE
	PLOTTED		
	CHECKED		
	BY		
	NOTED		
	NO.		
	STRUCTURE NOTATIONS CHK'D		

PB Americas, Inc.
 230 WEST MONROE STREET,
 SUITE 900
 CHICAGO, IL 60606
 (312)782-8150

FILE NAME = 0386985-shr-26drain.dgn	DESIGNED - RJD	REVISED -
	DRAWN - RJD	REVISED -
PLOT SCALE =	CHECKED - PMK	REVISED -
PLOT DATE = 19-AUG-2011 09:22	DATE - 08-18-2011	REVISED -

**STATE OF ILLINOIS
 DEPARTMENT OF TRANSPORTATION**

**DRAINAGE PLAN & PROFILE
 TURNER DRIVE**

SCALE: AS SHOWN DRNG - 25 OF 28 STA. TO STA.

F.A.P. RTE.	SECTION	COUNTY	TOTAL SHEETS	SHEET NO.
591	13R-2;14R-1 & BR-1(1);15R-1	KENDALL	429	188
FINAL SUBMITTAL			CONTRACT NO. 66985	
ILLINOIS FED. AID PROJECT				